

THIS DRAWING IS UNPUBLISHED. RELEASED FOR PUBLICATION  
 © COPYRIGHT - By - ALL RIGHTS RESERVED.

REVISIONS					
P	LTR	DESCRIPTION	DATE	DWN	APVD
V3		REVISED PER ECO-14-008433	05JUN2014	NK	MZ
W		REVISED PER ECR-16-016563	07DEC2016	RS	MZ

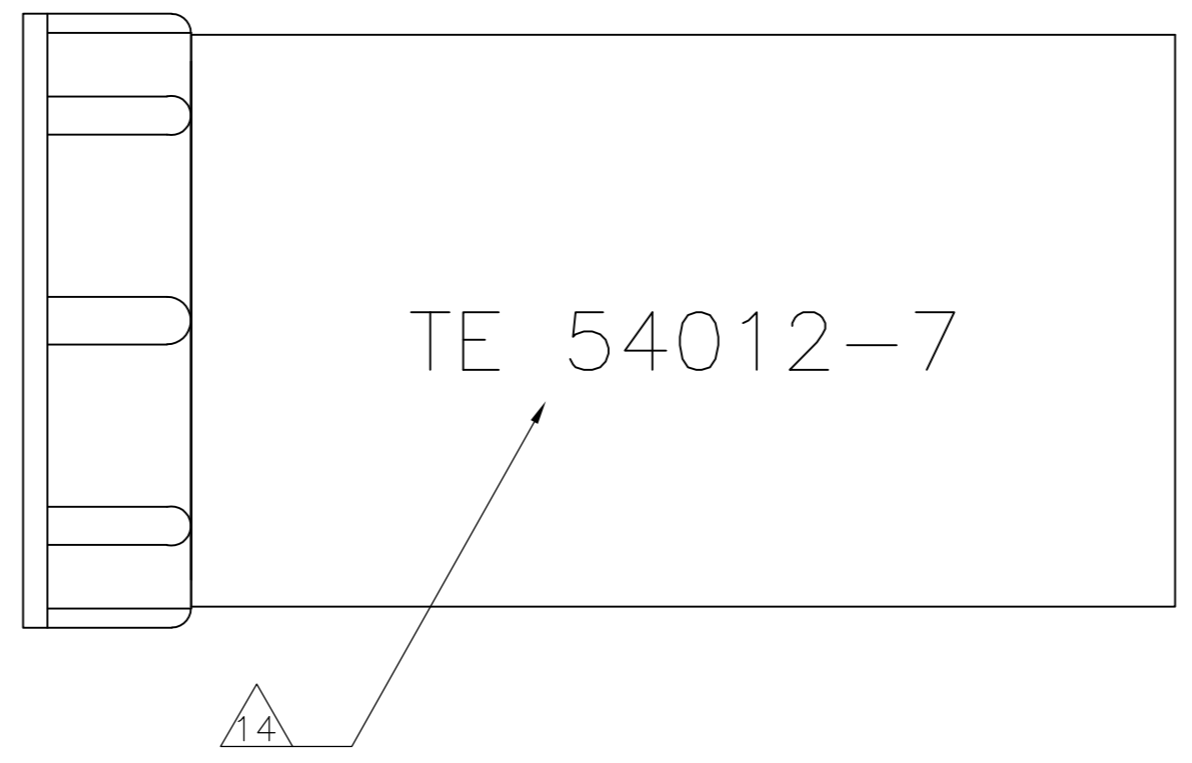
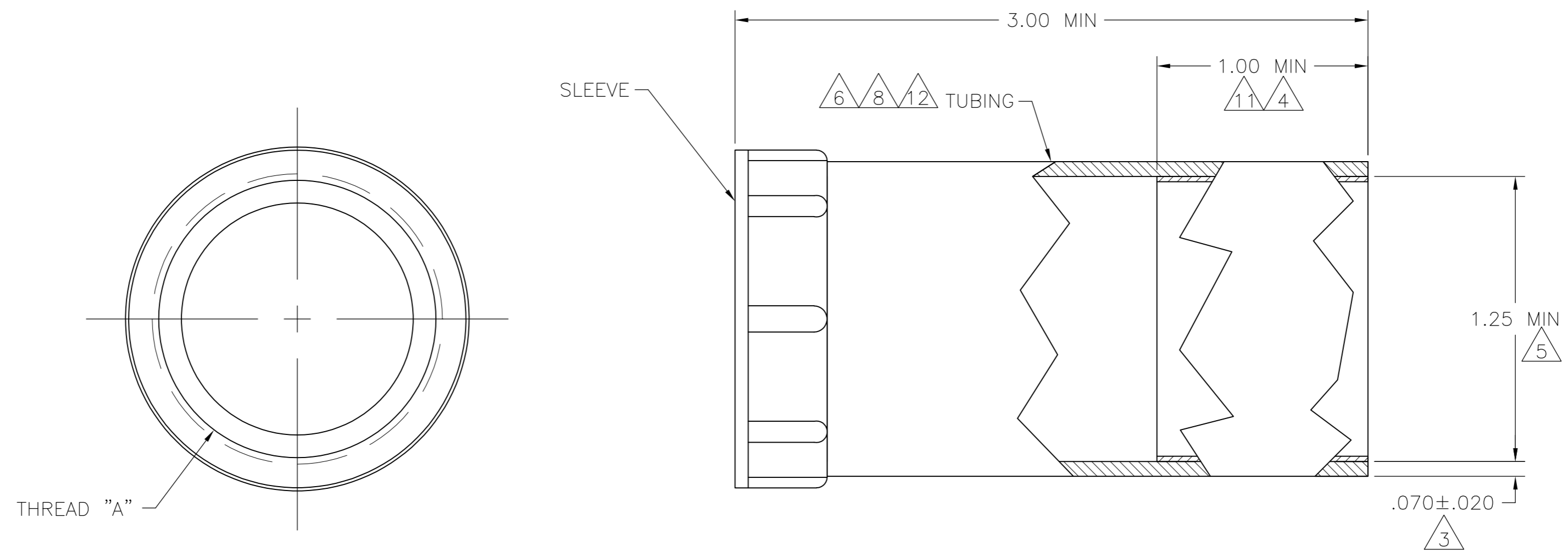

- 1 POLYOLEFIN, BLACK.
- 2 NYLON, BLACK.
- 3 NOMINAL WALL THICKNESS, EXPANDED.
- 4 LENGTH OF SEALANT.
- 5 EXPANDED INSIDE DIAMETER.
- 6 12.70[.500] MAXIMUM RECOVERED INSIDE DIAMETER.
- 7 ASSEMBLY WILL PASS 0.0703 KG PER SQ CENTIMETER [ONE POUND PER SQ IN.] WATER PRESSURE TEST.
- 8 121°C [250°F] SHRINK TEMPERATURE.
- 9 -55°C TO 110°C [-67°F TO 230°F] OPERATING TEMPERATURE.
- 10 THIS PART WILL ACCOMODATE  $\phi 13.97 - \phi 31.75$  [ $\phi .550 - \phi 1.250$ ] CABLE RANGE.
- 11 NO SEALANT APPLIED.
- 12 ACTUAL SHAPE MAY VARY DUE TO PROCESS VARIANCE.
- 13 OBSOLETE PARTS.
- 14 SEE P/N CHART FOR MARKING. WHITE CHARACTERS .15 MIN HIGH AND LOCATED ON THE OUTSIDE SURFACE OF THE TUBING.
- 15 PRELIMINARY PART - NOT FOR PRODUCTION

MARKING	THREAD "A"	PART NUMBER
13	1 3/8-18 UNEF-2B	54012-7
11 13	1 7/16-18 UNEF-2B	54012-6
11 13	1 3/8-18 UNEF-2B	54012-5
	1 7/16-18 UNEF-2B	54012-4
13	1 3/16-18 UNEF-2B	54012-3
	1 3/8-18 UNEF-2B	54012-1

THIS DRAWING IS A CONTROLLED DOCUMENT.

DWN C.REIFSNYDER 10 APR 96		NAME	STRAIN RELIEF ASSY, SHELL SIZE 23, CPC
CHK R.STONE 15 APR 95		SIZE	A2
APVD T.A.WETZEL 03 MAY 96		CAGE CODE	00779
PRODUCT SPEC		DRAWING NO	C=54012
APPLICATION SPEC	RESTRICTED TO		
WEIGHT		SCALE	2:1
CUSTOMER DRAWING		SHEET	1 of 1
		REV	W