

TECHNICAL DATA

ADAPTION - TEMPERATURE RANGE: -25°C / +90°C
 BEARING - TEMPERATURE RANGE: -40°C / +90°C

MATERIAL: PA
 INSERT: V0
 FLAMMABILITY ACC. UL94: BRASS NICKEL PLATED AND GOLD-PLATED
 CONTACTS:

ELECTRICAL DATA
 CURRENT VOLTAGE: 250V
 RATED CURRENT $T_u=40^\circ\text{C}$: 4A

MOUNTING HOLE
 Montagebohrung

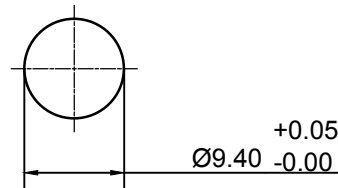

ENG.-NO.: 0912-040A0-0200A

Technische Daten

Einsatz - Temperaturbereich: -25°C / +90°C
 Lager - Temperaturbereich: -40°C / +90°C

Werkstoffe: PA
 Kontaktträger: V0
 Brennbarkeit gem. UL94: Messing vernickelt und goldbeschichtet
 Kontakte:

Elektrische Daten
 Betriebsspannung: 250V
 Bemessungsstrom $T_u=40^\circ\text{C}$: 4A

DESCRIPTION EC NO: IPG2013-0501 DRWN: BBRAUCH 2011/01/27 CHKD: APOHL APPR: APOHL 2013/02/11	QUALITY SYMBOLS ▽ = 0 ▽ = 0	GENERAL TOLERANCES (UNLESS SPECIFIED)		DIMENSION STYLE MM ONLY	SCALE 2:1	DESIGN UNITS METRIC	THIRD ANGLE PROJECTION	
		mm	INCH	DRAWN BY BBRAUCH	DATE 2011/01/27	INS M12 MA 4P AC REC PA BK UNSH SOL SOLDER TERMINATION		
4 PLACES ±---		±---		CHECKED BY	DATE			
3 PLACES ±---		±---		APOHL	2013/01/25	DOCUMENT NO. SD-120070-255 SHEET NO. 1 OF 1		
2 PLACES ±0.05		±---		APPROVED BY DATE				
1 PLACE ±0.3		±---		APOHL 2013/02/11		SIZE A3		
0 PLACE ±0.5		±---		ANGULAR ± 1°				
A		REV		MATERIAL NO. 1200705227				