

- Standard Sixteenth Brick Footprint (DOSA)
- 36-75VDC Input
- 3.3V 25A - 12V 6.5A Nominal Outputs
- Through Hole Mounting
- Low 12.7mm Profile
- 1500VDC Basic Isolation

iSA Series

75 - 82.5W

Sixteenth Brick Converter

iSA Features and Benefits

Features

- High operating efficiency (up to 90%)
- Constant switching frequency
- 44% smaller than eighth brick

Benefits

- Reduced system heating
- Easier system filtering
- Optimization of board space

Specifications

ITEMS	MODEL	iSA480		
		3.3	5	12
Nominal Output Voltage	VDC	3.3	5	12
Input Voltage Range	VDC	36 to 75		
Input Current (max)	A	4		
Output Voltage Tolerance	VDC	3.20-3.40	4.85-5.15	11.58-12.42
Ripple & Noise (max) (pk to pk)	mV	100		200
Line Regulation (max)	mV	7	10	24
Load Regulation (max)	mV	8	10	24
Overload Protection	%	Inception- 130-147% of rated output; Short circuit auto recovery		
Overvoltage Protection	VDC	3.75-4.65	5.7-6.7	13.6-15.7
Remote Sense	-	Yes		
Remote On/Off	-	Negative Logic		
Temperature (operating)	°C	-40°C to +125°C		
Temperature (storage)	°C	-55°C to +125°C		
Humidity (operating)	-	20 - 95% RH Non condensing		
Humidity (storage)	-	10 - 95% RH Non condensing		
Cooling	-	Convection or forced air		
I/O Isolation Voltage	VDC	1500		
Vibration (non operating)	-	5 to 50Hz @ 0.5g (4.9m/s ²), and 50 to 500Hz @ 1.5g (14.7m/s ²) per Bellcore TR-EOP-000063-5.4.4		
Shock	-	196.1m/s ²		
Safety Agency Approvals	-	IEC/UL/CSA/EN62368-1, 60950-1, CE Mark		
Weight (max)	g	30.4		
Size	mm	33 x 22.9 x 12.7		
Warranty	yrs	3		

Model Selector

Model	Voltage (V)	Adjust Range (V)	Max. Curr. (A)	Max. Output Power (W)	Efficiency at Full Load (%)
iSA48007A120V-001-R	12	10.8 - 13.2	6.5	78	90
iSA48015A050V-001-R	5	4.5 - 5.5	15	75	90
iSA48025A033V-001-R	3.3	2.97 - 3.63	25	82.5	88

Preferred

NB other configurations on request

Recommended Hole Pattern

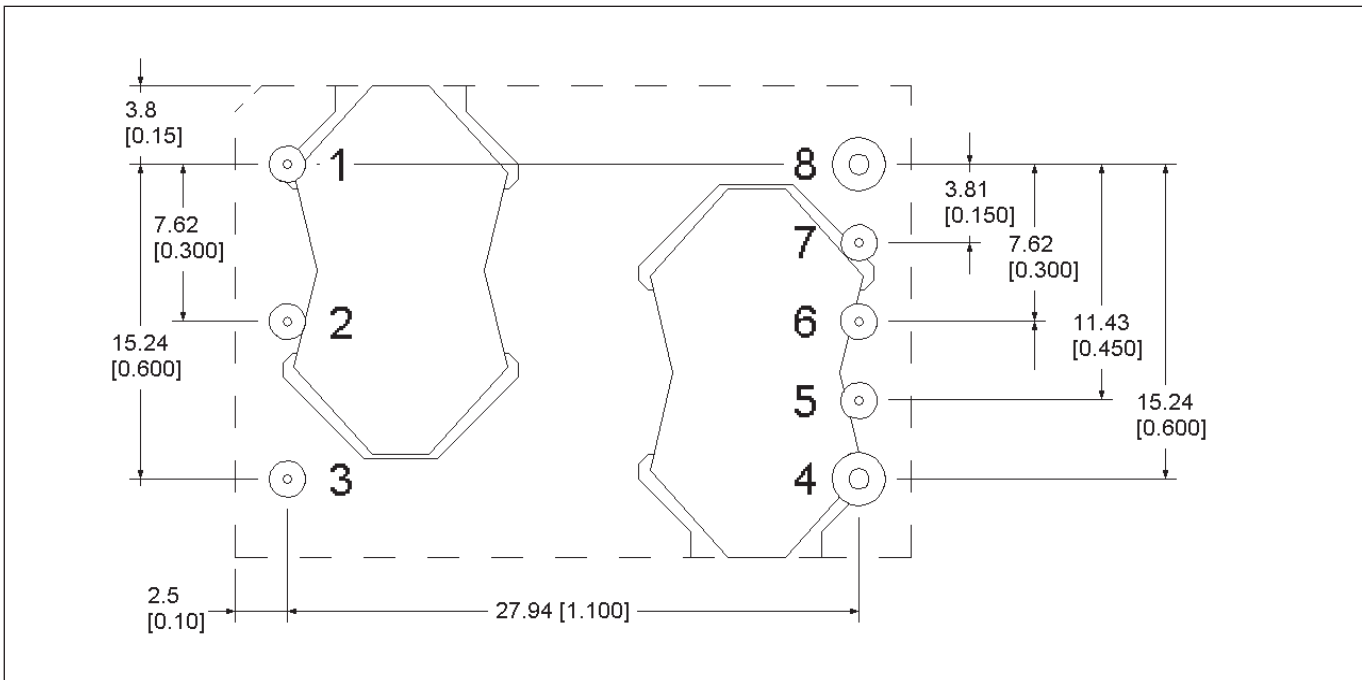

Feature Set

Feature Set	Positive Logic On / Off	Negative Logic On / Off	0.110" Pin Len.	0.180" Pin Len.	0.145" Pin Len.	Latching OVP
01		X			X	

PIN Assignments

Pin	Function
1	Vin (+)
2	On / Off
3	Vin (-)
4	Vout (-)
5	Sense (-)
6	Trim
7	Sense (+)
8	Vout (+)



TDK-Lambda France SAS

Tel: +33 1 60 12 71 65
tlf.fr.powersolutions@tdk.com
www.emea.lambda.tdk.com/fr



Italy Sales Office

Tel: +39 02 61 29 38 63
tlf.it.powersolutions@tdk.com
www.emea.lambda.tdk.com/it



Netherlands

tlf.nl.powersolutions@tdk.com
www.emea.lambda.tdk.com/nl



TDK-Lambda Germany GmbH

Tel: +49 7841 666 0
tlg.powersolutions@tdk.com
www.emea.lambda.tdk.com/de



Austria Sales Office

Tel: +43 2256 655 84
tlg.at.powersolutions@tdk.com
www.emea.lambda.tdk.com/at



Switzerland Sales Office

Tel: +41 44 850 53 53
tlg.ch.powersolutions@tdk.com
www.emea.lambda.tdk.com/ch



Nordic Sales Office

Tel: +45 8853 8086
tlg.dk.powersolutions@tdk.com
www.emea.lambda.tdk.com/dk



TDK-Lambda UK Ltd.

Tel: +44 (0) 12 71 85 66 66
tlu.powersolutions@tdk.com
www.emea.lambda.tdk.com/uk



TDK-Lambda Ltd.

Tel: +9 723 902 4333
tli.powersolutions@tdk.com
www.emea.lambda.tdk.com/il-en



TDK-Lambda Americas

Tel: +1 800-LAMBDA-4 or 1-800-526-2324
tla.powersolutions@tdk.com
www.us.lambda.tdk.com



TDK Electronics do Brasil Ltda

Tel: +55 11 3289-9599
sales.br@tdk-electronics.tdk.com
www.tdk-electronics.tdk.com/en



TDK-Lambda Corporation

Tel: +81-3-6778-1113
www.jp.lambda.tdk.com



TDK-Lambda (China) Electronics Co. Ltd.

Tel: +86 21 6485-0777
tlc.powersolutions@tdk.com
www.lambda.tdk.com.cn



TDK-Lambda Singapore Pte Ltd.

Tel: +65 6251 7211
tfs.marketing@tdk.com
www.sg.lambda.tdk.com



TDK India Private Limited, Power Supply Division

Tel: +91 80 4039-0660
mathew.philip@tdk.com
www.sg.lambda.tdk.com

