

RoHS COMPLIANT

<b>ENTER DESCRIPTION</b> IEC NO: 2012-0253 DRAWN: VITTHAR 2012/02/14 CHKD: APPR: KPRASAD REV: 2012/02/15	<b>QUALITY SYMBOLS</b> ▽=0 ▽=0	<b>GENERAL TOLERANCES (UNLESS SPECIFIED)</b>	<b>DIMENSION STYLE</b> MM ONLY	<b>SCALE</b> 1:1	<b>DESIGN UNITS</b> METRIC	<b>THIRD ANGLE PROJECTION</b>	
	4 PLACES ± --- ± --- 3 PLACES ± --- ± --- 2 PLACES ± 0.1 ± --- 1 PLACE ± 0.2 ± --- ANGULAR ± 1°	DRAWN BY: DKUMAR CHECKED BY: KPRASAD APPROVED BY: GJLOWE DATE: 20/12/2005	DATE: 20/12/2005	TITLE: CMC HEADER T3 INTERFACE - BK & BR 96/72 AND 96/96	MATERIAL NO.	DOCUMENT NO.	SHEET NO.
	DRAFT WHERE APPLICABLE MUST REMAIN WITHIN DIMENSIONS	SEE TABLE	SD-36638-001	1 OF 3	THIS DRAWING CONTAINS INFORMATION THAT IS PROPRIETARY TO MOLEX INCORPORATED AND SHOULD NOT BE USED WITHOUT WRITTEN PERMISSION		
	MOLEX INCORPORATED						

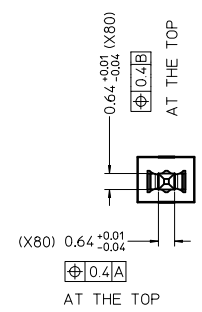

DETAIL 1  
SCALE 10:1

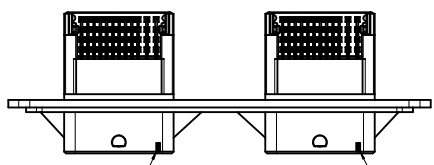
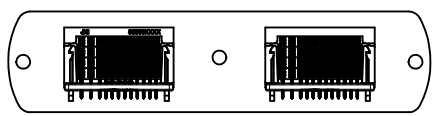
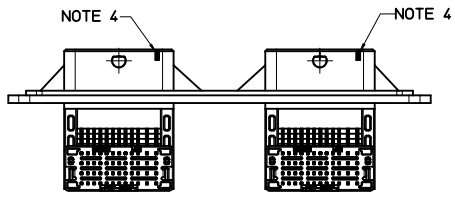
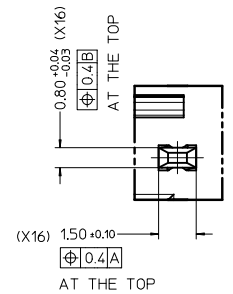

DETAIL 2  
SCALE 10:1

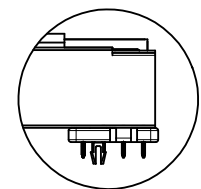

96/96 OR 96/72 CMC HEADER  
WITH PCB SNAP LOCKING

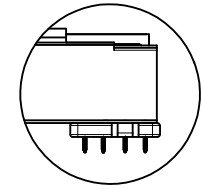

96/96 OR 96/72 CMC HEADER  
WITHOUT PCB SNAP LOCKING

36638-0012	CMC HEADER, T3-BR & BN, WITH PCB SNAP LOCK, 96/96	BROWN	BLACK	L1 & M1 L2 & M2 L3 & M3 L4 & M4	A1 TO H1, J1 & K1 A2 TO H2, J2 & K2 A3 TO H3, J3 & K3 A4 TO H4, J4 & K4	D
36638-0011	CMC HEADER, T3-BR & BN, W/O PCB SNAP LOCK, 96/96			C		
36638-0010	CMC HEADER, T3-BR & BN, WITH PCB SNAP LOCK, 96/72	BROWN	BLACK	L2 & M2 L3 & M3 L4 & M4	A2 TO H2, J2 & K2 A3 TO H3, J3 & K3 A4 TO H4, J4 & K4	B
36638-0001	CMC HEADER, T3-BR & BN, W/O PCB SNAP LOCK, 96/72			A		
MOLEX PART NO.	PART DISCRPTION	LEFT MODULE	RIGHT MODULE	1.5 PIN	0.64 PIN	PCB LAYOUT TO BE REFERRED
		COLOUR CODE		CAVITIES TO BE USED		

5	GRID PLATE WITH PCB LOCK	PBT 30% GLASS FILLED	BLACK	0	2	0	2	0
4	GRID PLATE W/O PCB LOCK		BLACK	2	0	2	0	2
3	HOUSING		BLACK	1	1	1	1	1
2	PIN 1.50	CuZn30	NICKEL UNDERCOAT: 1.3µM TO 2.2µM	12	12	16	16	12
1	PIN 0.64	CuZn30	MATTE TIN OVERCOAT: 4µM TO 5µM	60	60	80	80	60
SL.NO	DESIGNATION	MATERIAL	FINISH	BOM QUANTITY				
				36638-0001	36638-0010	36638-0011	36638-0012	36638-0010E

- NOTE:
1. PAINT BROWN PAINT(RoHS COMPLIANT) AT THE SPECIFIED AREA OF LEFT MODULE ON BOTH SIDES
  2. AREA FOR JXI AND MOLEX PART NUMBER REPRESENTATION.
  3. AREA FOR PLASTIC MATERIAL >PBT-30%GF< DESCRIPTION.
  4. PAINT WITH WHITE COLOR (RoHS COMPLIANT) AT SPECIFIED FOUR AREAS
  5. PART TO MEET SOLDERABILITY SPEC SMES-152
  6. PACKAGING SPECIFICATION: PK-36638-001
  7. FOR PART # 36638-0001 REFER PACKAGING SPEC:PK-36638-004

RoHS COMPLIANT

<b>ENTER DESCRIPTION</b> IEC NO: 2012-0253 DRAWN: VITARRAR 2012/02/14 CHKD: APPR: KPRASAD 2012/02/15	QUALITY SYMBOLS	GENERAL TOLERANCES (UNLESS SPECIFIED)		DIMENSION STYLE		SCALE	DESIGN UNITS	THIRD ANGLE PROJECTION
	▽=0	mm	INCH	MM ONLY		1:1	METRIC	
	▽=0	4 PLACES ± --- ± ---	3 PLACES ± --- ± ---	DRAWN BY	DATE	TITLE		
		2 PLACES ± 0.1 ± ---	1 PLACE ± 0.2 ± ---	DKUMAR	20/12/2005	CMC HEADER T3 INTERFACE - BK & BR 96/72 AND 96/96		
	ANGULAR ± 1°		CHECKED BY	DATE	MOLEX INCORPORATED			
	DRAFT WHERE APPLICABLE MUST REMAIN WITHIN DIMENSIONS		APPROVED BY	DATE	DOCUMENT NO.		SHEET NO.	
	SEE TABLE		GJLOWE	20/12/2005	SD-36638-001		2 OF 3	
	THIS DRAWING CONTAINS INFORMATION THAT IS PROPRIETARY TO MOLEX INCORPORATED AND SHOULD NOT BE USED WITHOUT WRITTEN PERMISSION							

**PCB LAYOUT: A**

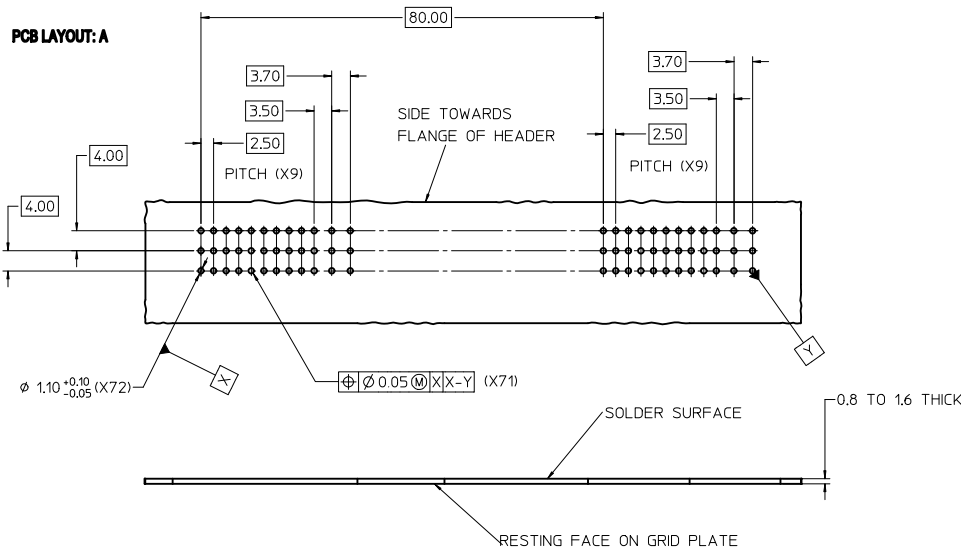

**PCB LAYOUT: B**

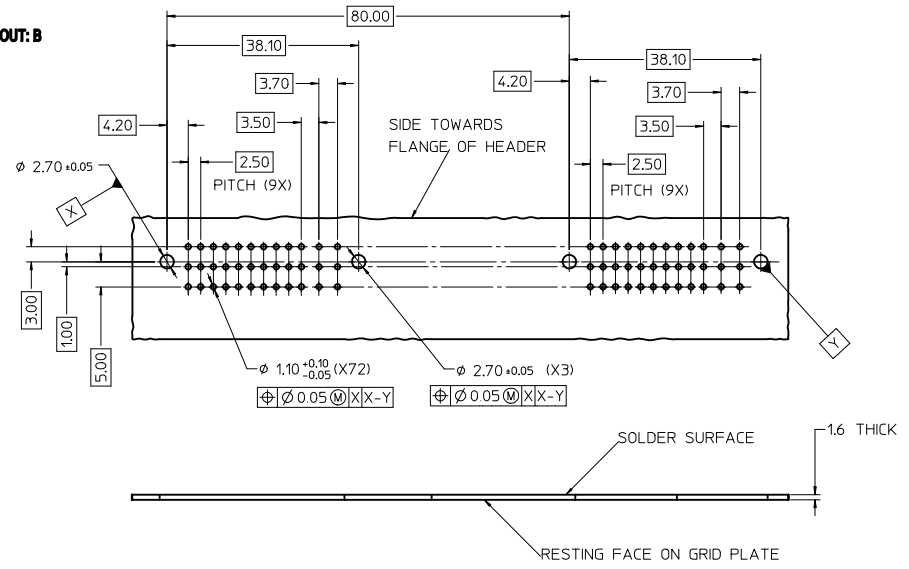

**PCB LAYOUT: C**

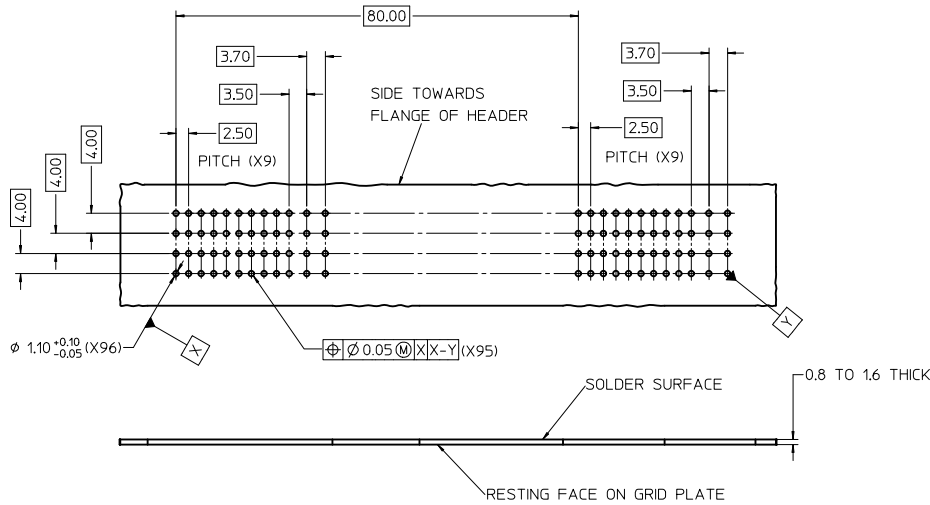

**PCB LAYOUT: D**

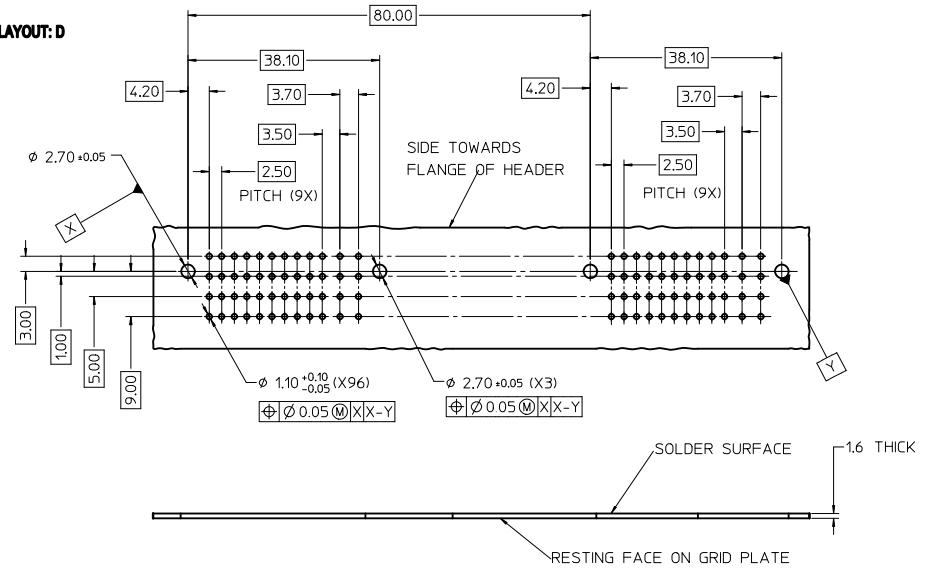

RoHS COMPLIANT

<b>ENTER DESCRIPTION</b> EC NO: 2012-0253 DRAWN BY: DRW:NVITARRAR CHKD: APPR:KPRASAD 2012/02/15	QUALITY SYMBOLS $\nabla=0$ $\nabla=0$	GENERAL TOLERANCES (UNLESS SPECIFIED) mm INCH 4 PLACES ± --- ± --- 3 PLACES ± --- ± --- 2 PLACES ± 0.1 ± --- 1 PLACE ± 0.2 ± --- ANGULAR ± 1 °	DIMENSION STYLE MM ONLY	SCALE 2:1	DESIGN UNITS METRIC	THIRD ANGLE PROJECTION
	DRAFT WHERE APPLICABLE MUST REMAIN WITHIN DIMENSIONS	SEE TABLE	DIMENSION STYLE MM ONLY	SCALE 2:1	DESIGN UNITS METRIC	TITLE CMC HEADER T3 INTERFACE - BK & BR 96/72 AND 96/96
	MATERIAL NO.	SEE TABLE	DIMENSION STYLE MM ONLY	SCALE 2:1	DESIGN UNITS METRIC	TITLE CMC HEADER T3 INTERFACE - BK & BR 96/72 AND 96/96
	DOCUMENT NO.	SEE TABLE	DIMENSION STYLE MM ONLY	SCALE 2:1	DESIGN UNITS METRIC	TITLE CMC HEADER T3 INTERFACE - BK & BR 96/72 AND 96/96

MOLEX INCORPORATED  
 SD-36638-001  
 SHEET NO. 3 OF 3

THIS DRAWING CONTAINS INFORMATION THAT IS PROPRIETARY TO MOLEX INCORPORATED AND SHOULD NOT BE USED WITHOUT WRITTEN PERMISSION

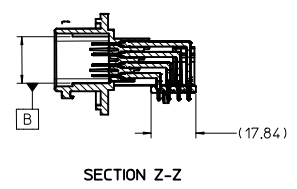
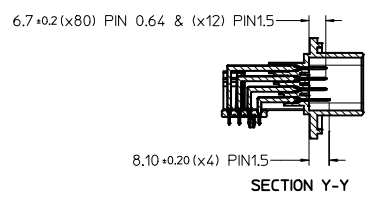
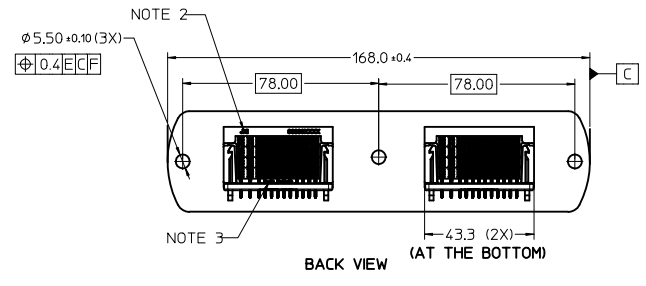
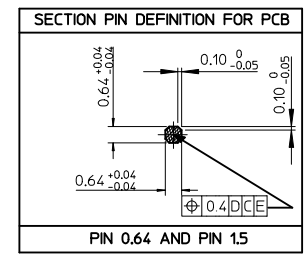
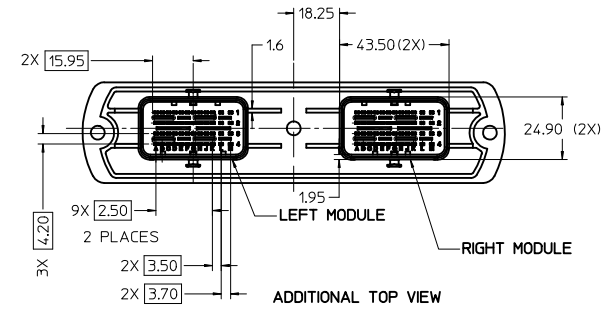
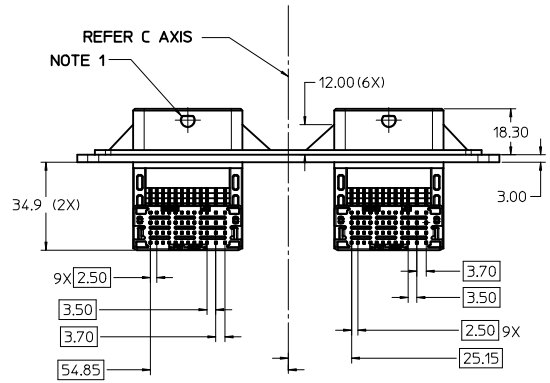
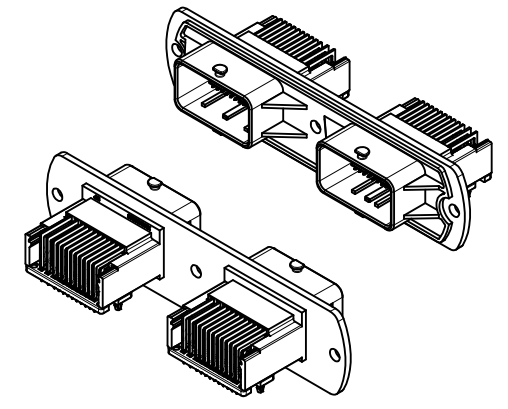
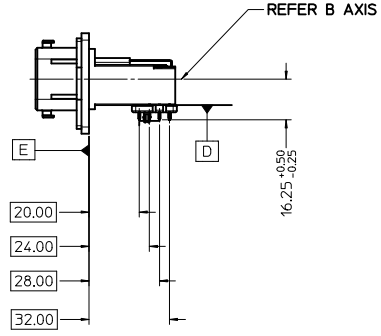
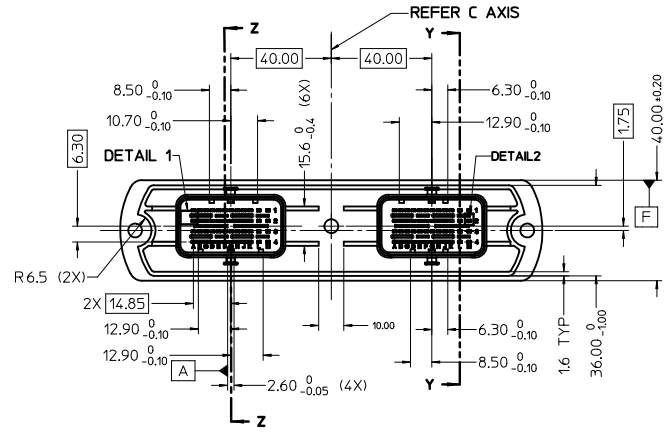

RoHS COMPLIANT

<b>ENTER DESCRIPTION</b> IEC NO: 2012-0253 DRAWN: VITTHAR 2012/02/14 CHKD: APPR: KPRASAD REV:	<b>QUALITY SYMBOLS</b> ▽=0 ▽=0	<b>GENERAL TOLERANCES (UNLESS SPECIFIED)</b> <table border="1"> <tr> <th></th> <th>mm</th> <th>INCH</th> </tr> <tr> <td>4 PLACES</td> <td>± 0.1</td> <td>± 0.004</td> </tr> <tr> <td>3 PLACES</td> <td>± 0.15</td> <td>± 0.006</td> </tr> <tr> <td>2 PLACES</td> <td>± 0.2</td> <td>± 0.008</td> </tr> <tr> <td>1 PLACE</td> <td>± 0.3</td> <td>± 0.012</td> </tr> </table>		mm	INCH	4 PLACES	± 0.1	± 0.004	3 PLACES	± 0.15	± 0.006	2 PLACES	± 0.2	± 0.008	1 PLACE	± 0.3	± 0.012	<b>DIMENSION STYLE</b> MM ONLY	<b>SCALE</b> 1:1	<b>DESIGN UNITS</b> METRIC	<b>THIRD ANGLE PROJECTION</b>
		mm	INCH																		
	4 PLACES	± 0.1	± 0.004																		
	3 PLACES	± 0.15	± 0.006																		
2 PLACES	± 0.2	± 0.008																			
1 PLACE	± 0.3	± 0.012																			
<b>DRAFT WHERE APPLICABLE MUST REMAIN WITHIN DIMENSIONS</b>	<b>SEE TABLE</b>	<b>MATERIAL NO.</b> SD-36638-001	<b>DOCUMENT NO.</b> SD-36638-001	<b>SHEET NO.</b> 1 OF 3	<b>CMC HEADER T3 INTERFACE - BK &amp; BR 96/72 AND 96/96</b> <b>MOLEX INCORPORATED</b>																
THIS DRAWING CONTAINS INFORMATION THAT IS PROPRIETARY TO MOLEX INCORPORATED AND SHOULD NOT BE USED WITHOUT WRITTEN PERMISSION																					

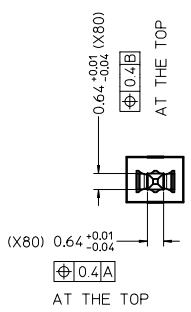
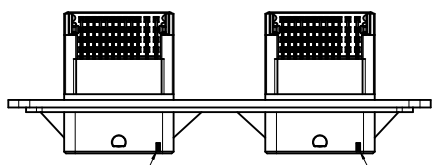
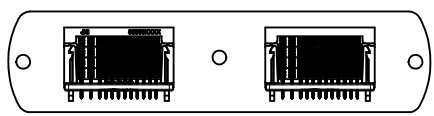
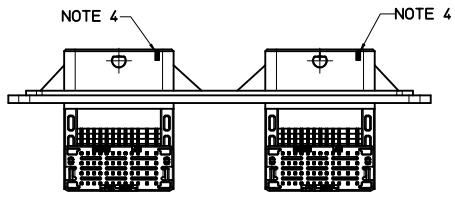

DETAIL 1  
SCALE 10:1

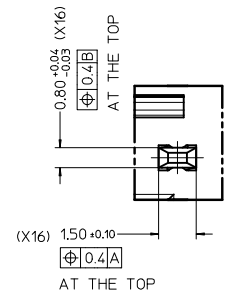

DETAIL 2  
SCALE 10:1

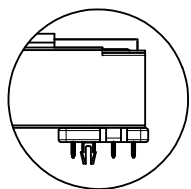

96/96 OR 96/72 CMC HEADER  
WITH PCB SNAP LOCKING

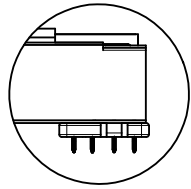

96/96 OR 96/72 CMC HEADER  
WITHOUT PCB SNAP LOCKING

36638-0012	CMC HEADER, T3-BR & BN, WITH PCB SNAP LOCK, 96/96	BROWN	BLACK	L1 & M1 L2 & M2 L3 & M3 L4 & M4	A1 TO H1, J1 & K1 A2 TO H2, J2 & K2 A3 TO H3, J3 & K3 A4 TO H4, J4 & K4	D
36638-0011	CMC HEADER, T3-BR & BN, W/O PCB SNAP LOCK, 96/96			C		
36638-0010	CMC HEADER, T3-BR & BN, WITH PCB SNAP LOCK, 96/72	BROWN	BLACK	L2 & M2 L3 & M3 L4 & M4	A2 TO H2, J2 & K2 A3 TO H3, J3 & K3 A4 TO H4, J4 & K4	B
36638-0001	CMC HEADER, T3-BR & BN, W/O PCB SNAP LOCK, 96/72			A		
MOLEX PART NO.	PART DISCRPTION	LEFT MODULE	RIGHT MODULE	1.5 PIN	0.64 PIN	PCB LAYOUT TO BE REFERRED
		COLOUR CODE	CAVITIES TO BE USED			

5	GRID PLATE WITH PCB LOCK	PBT 30% GLASS FILLED	BLACK	0	2	0	2	0
4	GRID PLATE W/O PCB LOCK		BLACK	2	0	2	0	2
3	HOUSING		BLACK	1	1	1	1	1
2	PIN 1.50	CuZn30	NICKEL UNDERCOAT: 1.3µM TO 2.2µM	12	12	16	16	12
1	PIN 0.64	CuZn30	MATTE TIN OVERCOAT: 4µM TO 5µM	60	60	80	80	60
SL.NO	DESIGNATION	MATERIAL	FINISH	BOM QUANTITY				
				36638-0001	36638-0010	36638-0011	36638-0012	36638-0010E

NOTE:

1. PAINT BROWN PAINT[RoHS COMPLIANT] AT THE SPECIFIED AREA OF LEFT MODULE ON BOTH SIDES
2. AREA FOR JX1 AND MOLEX PART NUMBER REPRESENTATION.
3. AREA FOR PLASTIC MATERIAL >PBT-30%GF< DESCRIPTION.
4. PAINT WITH WHITE COLOR [RoHS COMPLIANT] AT SPECIFIED FOUR AREAS
5. PART TO MEET SOLDERABILITY SPEC SMES-152
6. PACKAGING SPECIFICATION: PK-36638-001
7. FOR PART # 36638-0001 REFER PACKAGING SPEC:PK-36638-004

RoHS COMPLIANT

<b>ENTER DESCRIPTION</b> IEC NO: 2012-0253 DRAWN: VITARRAR 2012/02/14 CHKD: APPR: KPRASAD 2012/02/15	<b>QUALITY SYMBOLS</b> ▽=0 ▽=0	<b>GENERAL TOLERANCES (UNLESS SPECIFIED)</b> <table border="1"> <tr> <th></th> <th>mm</th> <th>INCH</th> </tr> <tr> <td>4 PLACES</td> <td>± 0.1</td> <td>± 0.004</td> </tr> <tr> <td>3 PLACES</td> <td>± 0.15</td> <td>± 0.006</td> </tr> <tr> <td>2 PLACES</td> <td>± 0.2</td> <td>± 0.008</td> </tr> <tr> <td>1 PLACE</td> <td>± 0.25</td> <td>± 0.010</td> </tr> </table>		mm	INCH	4 PLACES	± 0.1	± 0.004	3 PLACES	± 0.15	± 0.006	2 PLACES	± 0.2	± 0.008	1 PLACE	± 0.25	± 0.010	<b>DIMENSION STYLE</b> MM ONLY	<b>SCALE</b> 1:1	<b>DESIGN UNITS</b> METRIC	THIRD ANGLE PROJECTION
		mm	INCH																		
	4 PLACES	± 0.1	± 0.004																		
	3 PLACES	± 0.15	± 0.006																		
2 PLACES	± 0.2	± 0.008																			
1 PLACE	± 0.25	± 0.010																			
<b>DESCRIPTION</b> T3 INTERFACE - BK & BR 96/72 AND 96/96	<b>DRAWN BY</b> DKUMAR 20/12/2005	<b>CHECKED BY</b> KPRASAD 20/12/2005	<b>APPROVED BY</b> GJLOWE 20/12/2005	<b>MATERIAL NO.</b> SEE TABLE	<b>DOCUMENT NO.</b> SD-36638-001	<b>SHEET NO.</b> 2 OF 3															
<b>DRAFT WHERE APPLICABLE MUST REMAIN WITHIN DIMENSIONS</b>	<b>SIZE</b> A1	THIS DRAWING CONTAINS INFORMATION THAT IS PROPRIETARY TO MOLEX INCORPORATED AND SHOULD NOT BE USED WITHOUT WRITTEN PERMISSION																			

**PCB LAYOUT: A**

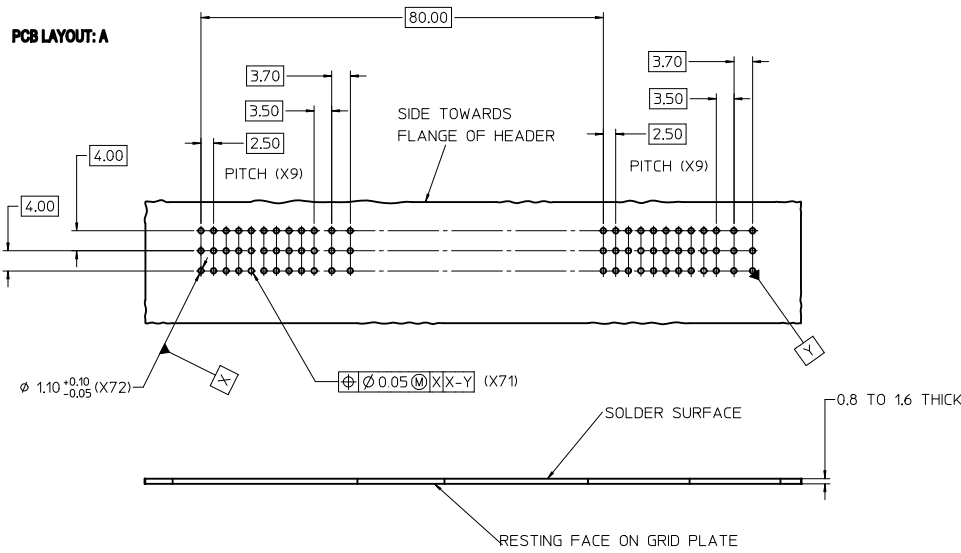

**PCB LAYOUT: B**

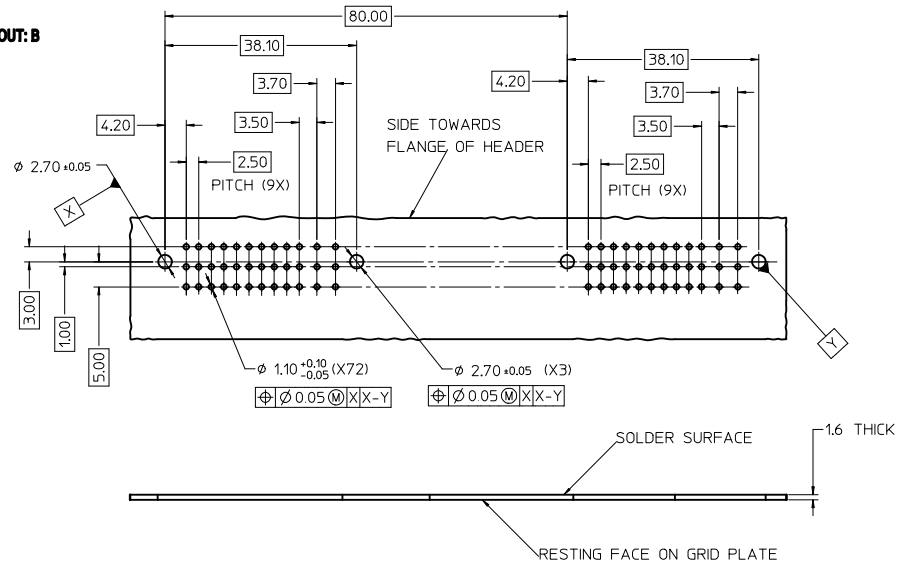

**PCB LAYOUT: C**

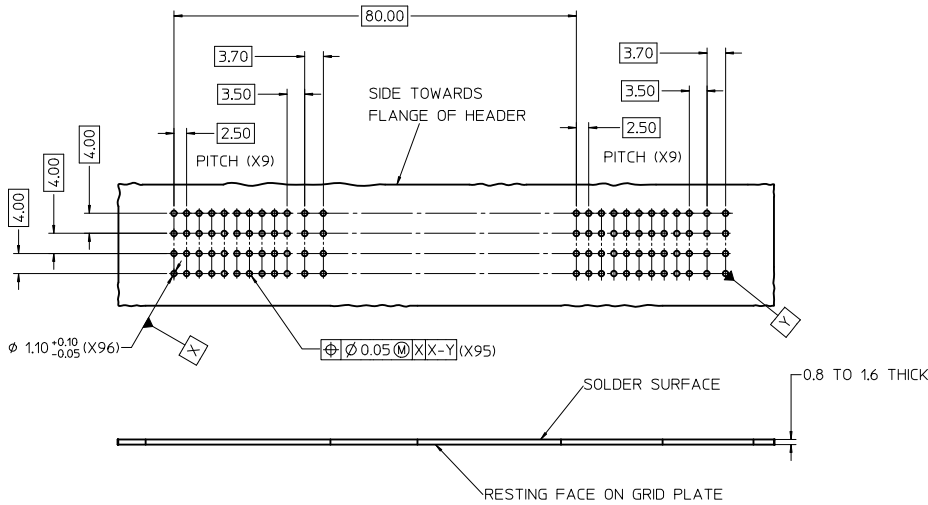

**PCB LAYOUT: D**

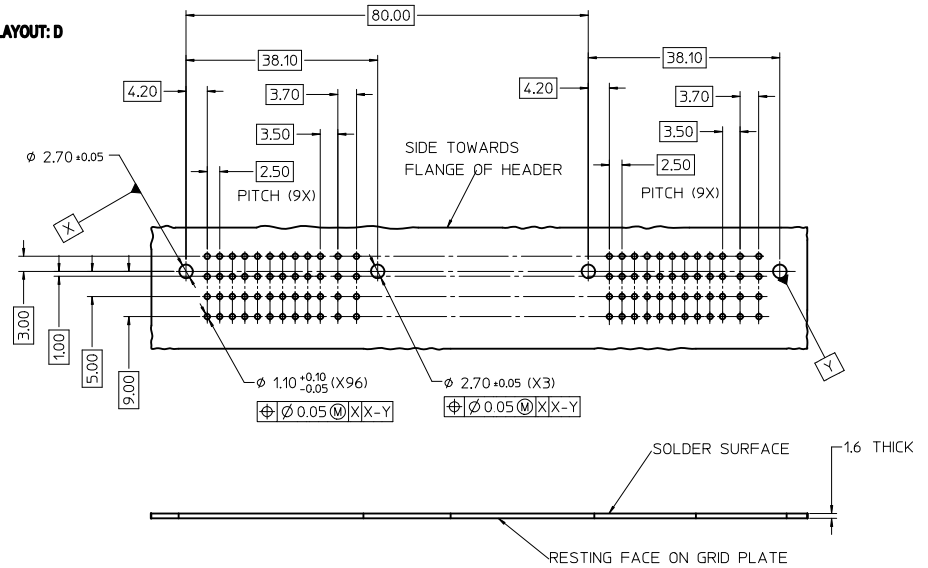

RoHS COMPLIANT

<b>ENTER DESCRIPTION</b> EC NO: 2012-0253 DRAWN BY: ARKAR CHKD: KPRASAD APPR: KPRASAD DATE: 2012/02/15	QUALITY SYMBOLS ▽=0 ▽=0	GENERAL TOLERANCES (UNLESS SPECIFIED) mm INCH 4 PLACES ± --- ± --- 3 PLACES ± --- ± --- 2 PLACES ± 0.1 ± --- 1 PLACE ± 0.2 ± --- ANGULAR ± 1 °	DIMENSION STYLE MM ONLY	SCALE 2:1	DESIGN UNITS METRIC	THIRD ANGLE PROJECTION	
	DRAWN BY: DKUMAR DATE: 20/12/2005	CHECKED BY: KPRASAD DATE: 20/12/2005	APPROVED BY: GJLOWE DATE: 20/12/2005	MATERIAL NO. SEE TABLE	DOCUMENT NO. SD-36638-001	TITLE CMC HEADER T3 INTERFACE - BK & BR 96/72 AND 96/96	SHEET NO. 3 OF 3
	MOLEX INCORPORATED						
	THIS DRAWING CONTAINS INFORMATION THAT IS PROPRIETARY TO MOLEX INCORPORATED AND SHOULD NOT BE USED WITHOUT WRITTEN PERMISSION						