

DIMENSIONS

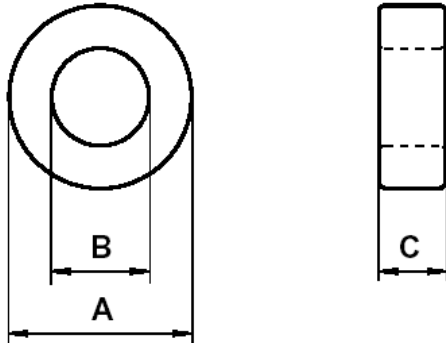

(mm)	Uncoated Nominal:	Coated Min:	Coated Max:
O.D. (A)	29	28.6	29.9
I.D. (B)	19	18.11	19.39
Ht. (C)	7.3	7.34	8.06

Eff. Parameters		
A _e mm ²	l _e mm	V _e mm ³
36	73.2	2632

INDUCTANCE

A _L value (nH/T ²)	Test conditions	
3170 ± 20%	10 kHz	0.5 mT (For N = 1, use 3.3 mA), 25°C
≥ 0.9 x A _L @ 10 kHz	200 kHz	

ELECTRICAL LOSSES

tan δ / μ _i	Test conditions
≤ 12 · 10 ⁻⁶	100 kHz, 0.5 mT, 25°C

COATING

Epoxy rated for 200°C continuous operation.
Voltage breakdown rating 2000 V _{DC} Min Wire-to-Wire.

NOTE

Spec. Modifications	Previous	Revised
2006.10.20	Bare Nom Ht = 7.5 LF: General J material Breakdown voltage > 1,000 V	Bare Nom Ht = 7.3 LF: Detail as indicated Breakdown voltage > 2,000 V _{DC}