

REV.	ECN NO.	DESCRIPTION	SIGN	DATE
C1	N/A	INITIAL DRAWING	Hary	2020/05/18

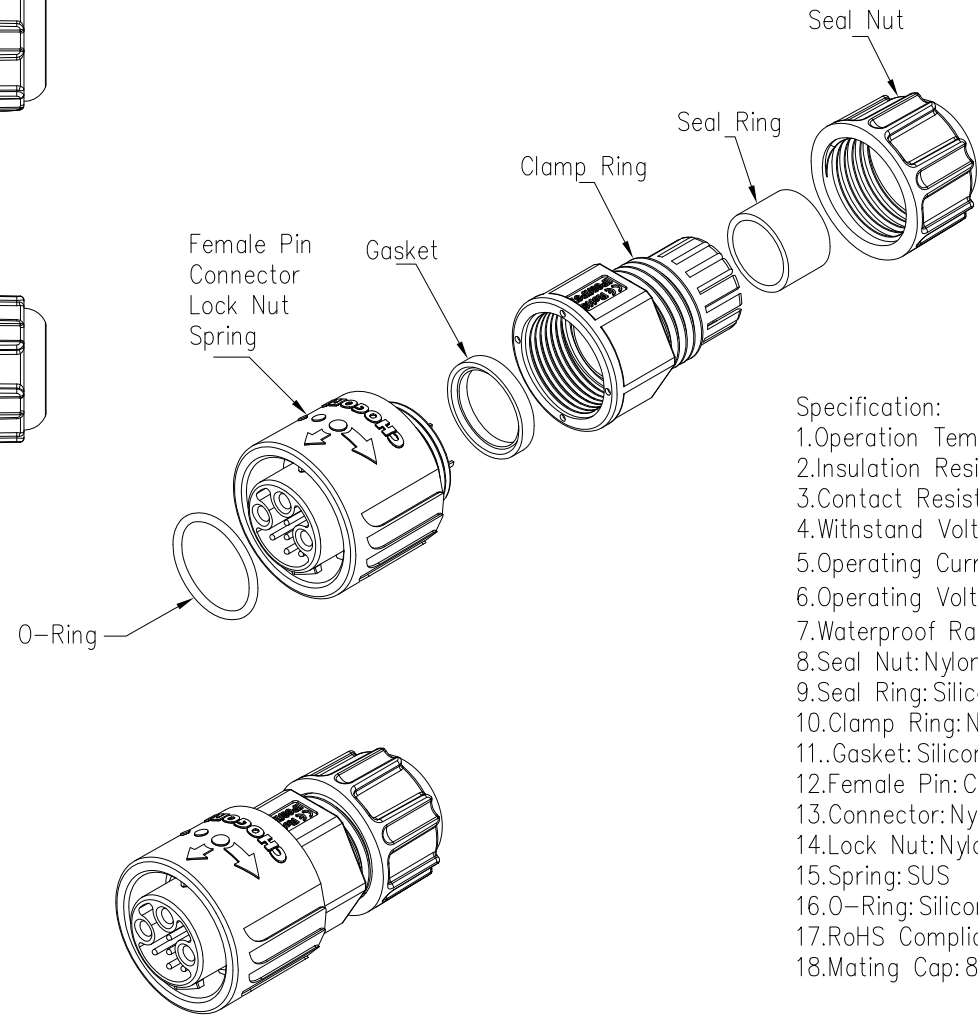

- Specification:
- 1.Operation Temperature: -45°C~105°C.
 - 2.Insulation Resistance:100MΩ at DC500V.
 - 3.Contact Resistance:<10mΩ.
 - 4.Withstand Voltage: 1500V AC
 - 5.Operating Current:15A/2A
 - 6.Operating Voltage:AC 125V/30V
 - 7.Waterproof Rate:IP67 (Mated)
 - 8.Seal Nut:Nylon, Black
 - 9.Seal Ring:Silicon, Black.
 - 10.Clamp Ring:Nylon, Black
 - 11..Gasket:Silicon, Red
 - 12.Female Pin:Copper Alloy, Gold Plated
 - 13.Connector:Nylon+GF, Black
 - 14.Lock Nut:Nylon, Orange
 - 15.Spring:SUS
 - 16.O-Ring:Silicon, Red
 - 17.RoHS Compliant.
 - 18.Mating Cap:804-00007-00

23XXX231-XX Cable Range OD
 01 OD: φ3.5mm~φ6.5mm
 02 OD: φ6.5mm~φ9.5mm
 Pin Number

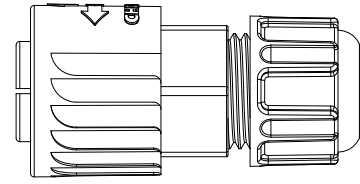
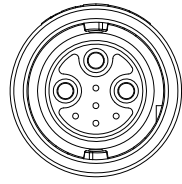
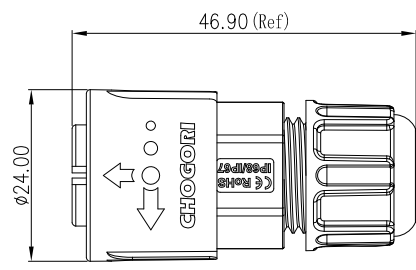
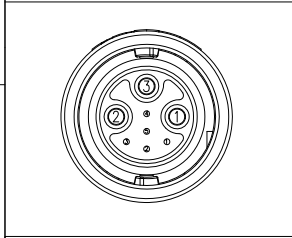

(3+5) Pin

P/N: 23305231-XX

Pin Assignments
Front View

UNIT:mm	
TOLERANCE	
.X	±0.25
.XX	±0.15
.XXX	±0.05
ANGLES	±1°

DESCRIPTION		Middle Series Push Lock Male Plug With Female Pin	
SCALE:	1:1	SHEET	1 OF 1
REV.	C1	SIZE	A4
		* :Inspection Item	



PART NO	23305231-XX	DRAWN BY	Hary	DATE	2020/05/18
DWG NO		CHECKED BY	Mo	DATE	2020/05/18
CUSTOMER		APPROVED BY	Panson	DATE	2020/05/18

THIS INFORMATION IS CONFIDENTIAL AND IS DISCLOSED TO YOU ON CONDITION THAT NO FURTHER DISCLOSURE IS MADE BY YOU TO OTHER THAN CHOGORI PERSONNEL WITHOUT AUTHORIZATION FROM CHOGORI CORP.