

| MATERIAL NUMBER | ENG. NO. | MATERIAL NUMBER TAPE MOUNTED | ENG. NO. | STUD SIZE | "S" ±.005 | "W" MAX | "C" MIN | "L" MAX |
|-----------------|-----------|------------------------------|---------------|-----------|-------------|-------------|-------------|--------------|
| ----- B1 ----- | ----- | ----- | ----- | 04 | .119 (3.02) | .322 (8.18) | .285 (7.24) | .885 (22.48) |
| 190730083 | BB-837-06 | 190730084 | BB-837-06T | 06 | .146 (3.71) | | | |
| 190730085 | BB-837-08 | 190730086 | BB-837-08T | 08 | .173 (4.39) | | | |
| 190730087 | BB-837-10 | 190730088 | B1 BB-837-10T | 10 | .198 (5.03) | .352 (8.94) | .310 (7.87) | .936 (23.77) |
| ----- B1 ----- | ----- | ----- | B1 ----- | 06 | .146 (3.71) | | | |
| 190730094 | BB-839-08 | 190730096 | BB-839-08T | 08 | .173 (4.39) | | | |
| 190730097 | BB-839-10 | 190730099 | BB-839-10T | 10 | .198 (5.03) | | | |

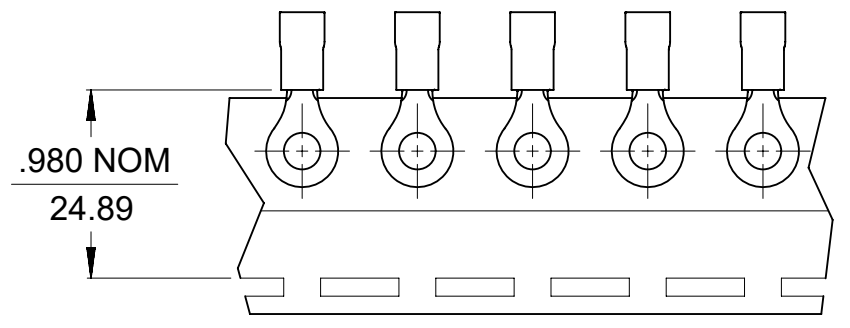
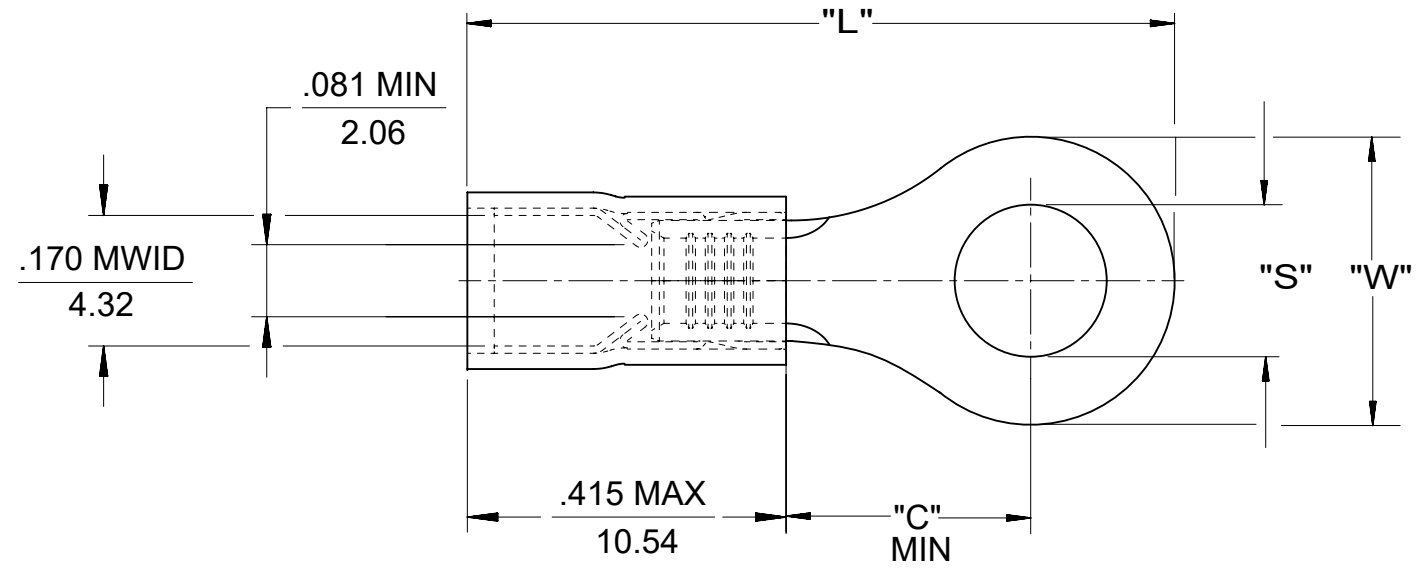

NOTE(S):

1. MATERIAL THICKNESS: COPPER .031 (0.79) REF
PLATING: ELECTROPLATE TIN
2. FERRULE: TIN-PLATED BRASS
3. INSULATION: BLUE NYLON
4. MWID = MAXIMUM WIRE INSULATION DIA.
5. WIRE SIZE: 16-14 AWG
1.0-2.5 MM²

| | | | | | | | | | |
|---|---|------------------------|---|--------|-----------------|----------------|--------------|--|--|
| THIS DRAWING CONTAINS INFORMATION THAT IS PROPRIETARY TO MOLEX ELECTRONIC TECHNOLOGIES, LLC AND SHOULD NOT BE USED WITHOUT WRITTEN PERMISSION | | | | | | | | | |
| FUNCTIONAL SYMBOLS | THIS DRAWING CONTAINS INFORMATION THAT IS PROPRIETARY TO MOLEX ELECTRONIC TECHNOLOGIES, LLC AND SHOULD NOT BE USED WITHOUT WRITTEN PERMISSION | SCALE | CURRENT REV DESC: ENG PN ERROR: BB-837-10T WAS BB-823-10T. RMV OBSO PN'S: 190730081, -0302, -0093. | | | | | | |
| | INCH/MM | 4:1 | | | | | | | |
| DIVISIONAL SYMBOLS | GENERAL TOLERANCES (UNLESS SPECIFIED) | | | | | | | | |
| | 4 PLACES | ± | MM | INCH | | | | | |
| | 3 PLACES | ± | ± | 0.005 | | | | | |
| | 2 PLACES | ± | 0.13 | ± | 0.01 | | | | |
| | 1 PLACE | ± | 0.25 | ± | | | | | |
| 0 PLACES | ± | | | | | | | | |
| ANGULAR TOL | | ± | 1.0° | | | | | | |
| DRAFT WHERE APPLICABLE MUST REMAIN WITHIN DIMENSIONS | | THIRD ANGLE PROJECTION | DRAWING | SERIES | MATERIAL NUMBER | CUSTOMER | SHEET NUMBER | | |
| | | | B-SIZE | 19073 | SEE CHART | GENERAL MARKET | 1 OF 1 | | |

molex

RING TONGUE TERMINAL
AVIKRIMP, 800-SERIES 16-14 AWG

PRODUCT CUSTOMER DRAWING

DOCUMENT NUMBER: SD-19073-006
DOC TYPE: PSD
DOC PART: 001
REVISION: B1