

10 9 8 7 6 5 4 3 2 1

NOTES :

I- MATERIAL:

-HOUSING: POLYAMIDE FIBER GLASS FILLED
UL 94-V0 COLOR BLACK.

-TERMINAL: PHOSPHOR BRONZE .

PLATING:

POST PLATE 0.00127-0.00152/.000050-.000060 GOLD
IN CONTACT AREA.
0.00190/.000075 MIN PURE TIN IN TAIL AREA
BOTH OVER 0.00127/.000050 MIN NICKEL OVERALL.

- 2- JACK FOR MATING WITH FCC 68 PLUGS
90075 MOLEX SERIES.
- 3- PCB THICKNESS : 1.57 / .062
- 4- PRODUCT SPECIFICATION PS-95002
- 5- APPLICATION SPECIFICATION AS-95001
- 6- PACKAGING SPECIFICATION PK-95002

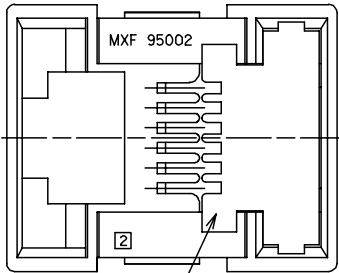

CAP

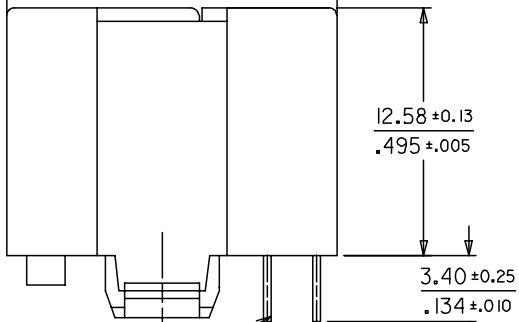
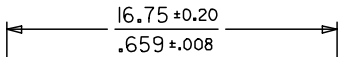

TERMINAL

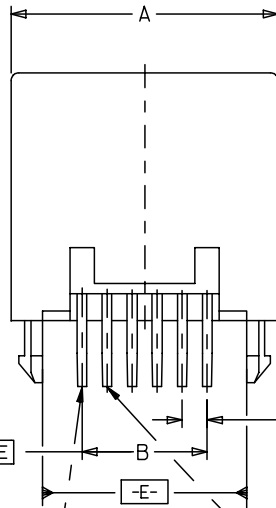
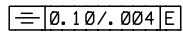

CIRCUIT I
(6-CIRCUIT)

CIRCUIT I
(4-CIRCUIT)

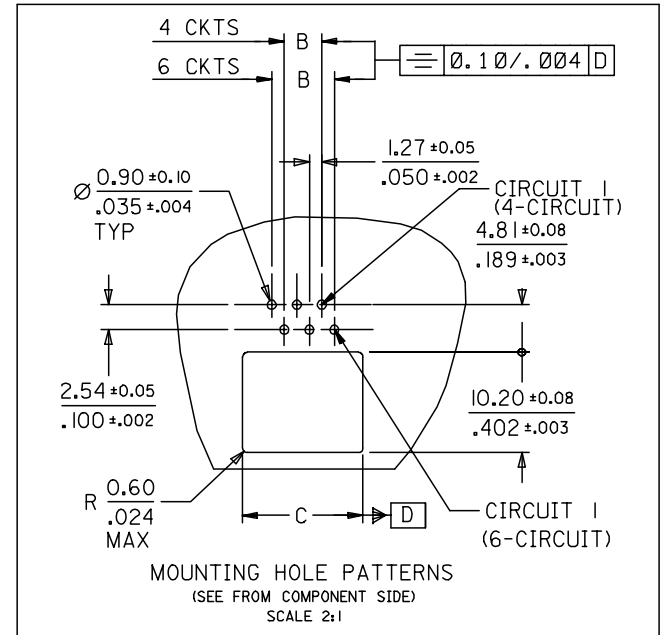

MOUNTING HOLE PATTERNS
(SEE FROM COMPONENT SIDE)
SCALE 2:1

P/N	HOUSING SIZE	CKTS	DIM		
			A ±0.13	B $\begin{matrix} +0.05 \\ -0.10 \\ \pm.002 \\ \pm.004 \end{matrix}$	C $\begin{matrix} \pm 0.08 \\ \pm.003 \end{matrix}$
95002-2447	POS 4	4 CKTS	11.50	3.81	10.20
			.453	.150	.402
95002-2647	POS 6	4 CKTS	13.55	3.81	12.20
			.533	.150	.480
95002-2667	POS 6	6 CKTS	13.55	6.35	12.20
			.533	.250	.480

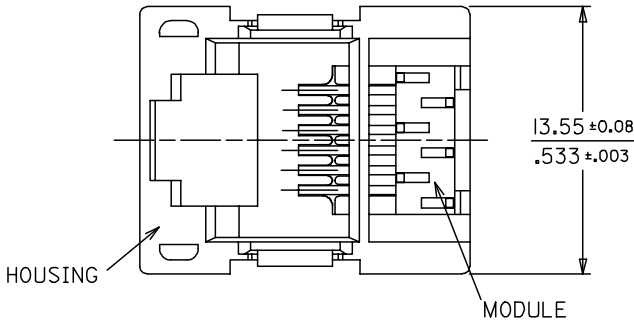

HOUSING

MODULE

ENTER DESCRIPTION EC NO: MG2005-0107 DRAWN:KNOLLER 2004/09/22 CHKD:FCARABET 2004/09/22 APPR:KNOLLER 2004/09/24	QUALITY SYMBOLS ▽=0 ▽=0	GENERAL TOLERANCES (UNLESS SPECIFIED) <table border="1"> <thead> <tr> <th></th> <th>mm</th> <th>INCH</th> </tr> </thead> <tbody> <tr> <td>4 PLACES</td> <td>± ---</td> <td>± ---</td> </tr> <tr> <td>3 PLACES</td> <td>± ---</td> <td>± .006</td> </tr> <tr> <td>2 PLACES</td> <td>± 0.15</td> <td>± .010</td> </tr> <tr> <td>1 PLACE</td> <td>± 0.25</td> <td>± ---</td> </tr> </tbody> </table> ANGULAR ± .5 °		mm	INCH	4 PLACES	± ---	± ---	3 PLACES	± ---	± .006	2 PLACES	± 0.15	± .010	1 PLACE	± 0.25	± ---	DIMENSION STYLE MM/IN	SCALE 4:1	DESIGN UNITS METRIC	THIRD ANGLE PROJECTION
				mm	INCH																
4 PLACES	± ---	± ---																			
3 PLACES	± ---	± .006																			
2 PLACES	± 0.15	± .010																			
1 PLACE	± 0.25	± ---																			
DRAFT WHERE APPLICABLE MUST REMAIN WITHIN DIMENSIONS	DRAWN BY ER	DATE 99/02/25	TITLE BOTTOM ENTRY LOW PROFILE MODULAR JACK WITH CAP (THROUGH HOLE VERSION)	MOLEX INCORPORATED	DOCUMENT NO. SD-95002-002	SHEET NO. 1 OF 1															

9 8 7 6 5 4 3 2 1