

REV.	ECN NO.	DATE	SIGN	DESCRIPTION
B	LEN-0C0115	2009/11/23	Ivan	Change 前導角 View

ALTW
DCC. DEPT.
CONFIDENTIAL
2012-05-29
ISSUED

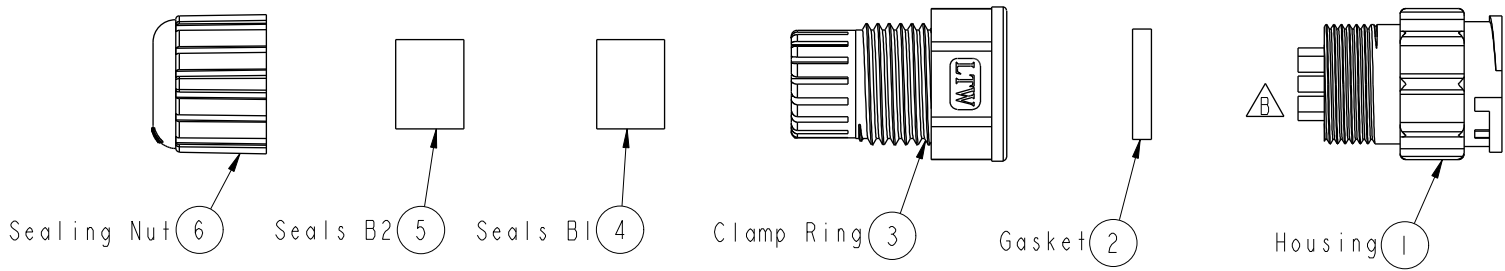

ALTW
CONFIDENTIAL
2012-02-10
R&D DEPT.

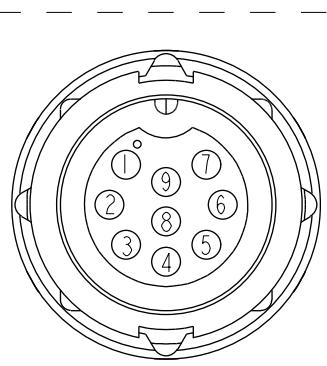

Pin Assignments
Front View

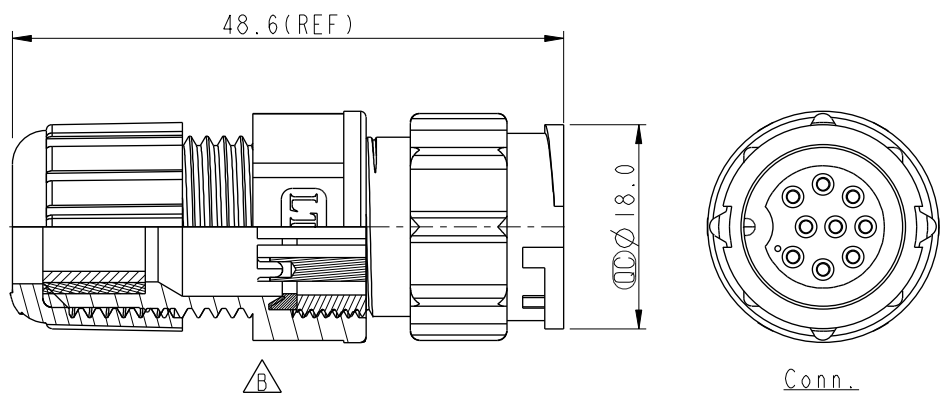

Conn.

- Note:
- * ⌀ Important Dimension To Check.
 - * Waterproof Rate: IP67
 - * Housing: Nylon+GF, Black
 - * Female Pin: Copper Alloy, Gold Plated
 - * Gasket: Silicon, Black
 - * Seals: EPDM, Black
 - * Clamp Ring: Nylon, Black
 - * Sealing Nut: Nylon, Black
 - * Seal B1 for Cable OD: $\text{⌀}7.6\text{mm}-\text{⌀}9.6\text{mm}$
 - * Seal B2 for Cable OD: $\text{⌀}4.0\text{mm}-\text{⌀}7.6\text{mm}$
 - * One Set Unassembled in One PE Bag

UNIT:mm		TITLE Middle, Assy Lock 9Pin M Conn F Pin			ITEM NO CD-09BMFA-LL7001		DRAWN BY SamChang		DATE 2012-04-12			
		SCALE 1:1			SIZE A4		DWG NO CD-09BMFA-LL7001		CHECKED BY Jeffrey		DATE 2012-05-29	
		REV. B			WC-REV. A.2		CUSTOMER ALTW		APPROVED BY Lion		DATE 2012-05-29	
		TOLERANCE .X ±0.25 .XX ±0.1 .XXX ±0.05 ANGLES ±1°			SHEET 1 OF 1		<p>Amphenol LTW 安費諾亮泰企業股份有限公司</p>					
<p>QC: Inspection item</p>												

THIS DOCUMENT IS SUBJECT TO CHANGE WITHOUT NOTICE. IT IS CONFIDENTIAL AND A PROPERTY OF AMPHENOL LTW. DISCLOSURE TO THIRD PARTY HAS TO BE AUTHORIZED BY AMPHENOL LTW.