

P	LTR	DESCRIPTION	DATE	DWN	APVD
	A	INITIAL RELEASE	5JUL2017	L.Z	X.X

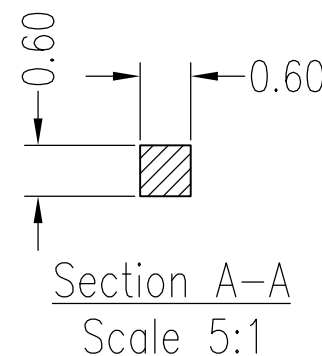
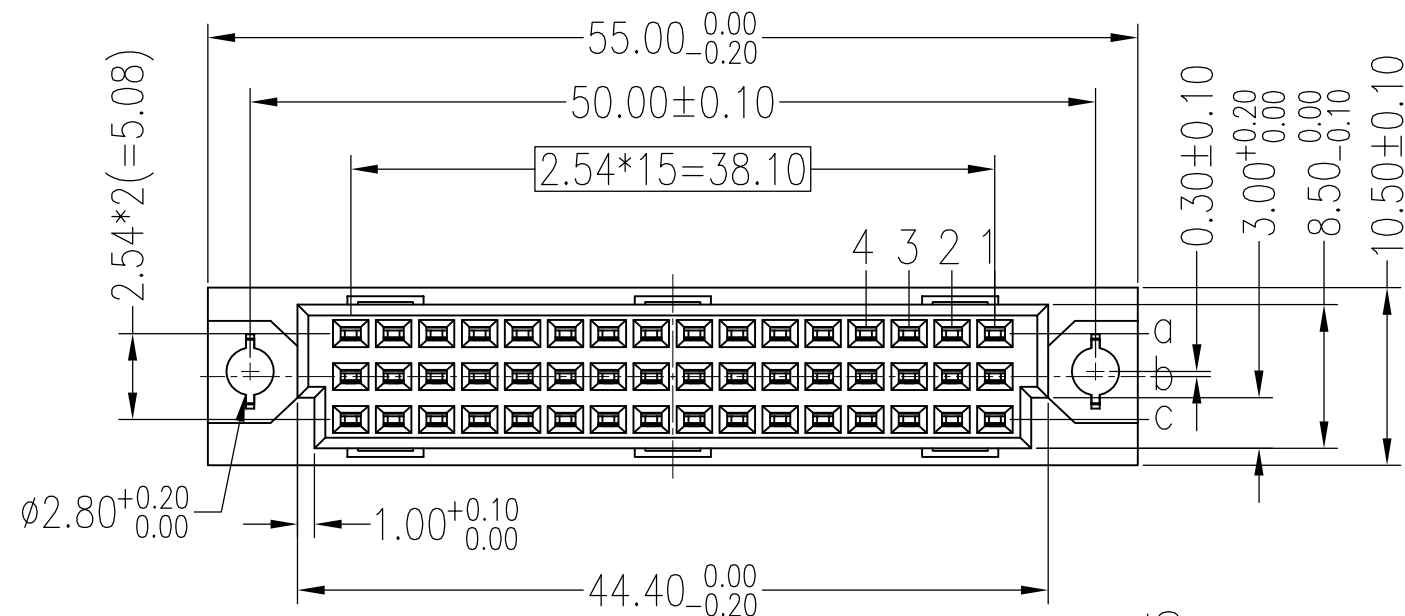

NOTES:

- 1,Current Rating: 2.0AMP
- 2,Contact Resistance: 20mΩ Max
- 3,Withstand Voltage: 1000V AC/DC
- 4,Insulation Resistance: 1000000MΩ Min. at 100V DC
- 5,Operation Temperature: -55°C to +105°C
- 6,Contact Material: Copper alloy
- 7,Contact Plating:
 - Ⓐ 50u" Nickel on underplating over all
 - Ⓑ 100u" Tin on solder area
 - Ⓒ 30u" Gold on Contact Area
 - Ⓓ 10u" Gold on Contact Area
 - Ⓔ 3u" Gold on Contact Area
- 8,Insulator: PBT, Grey white, UL94V-0

Recommended soldering process:

Wave Soldering, Peak temperature: 250°C, 5s

RECOMMENDED MATING TE PN: *-2271290-*

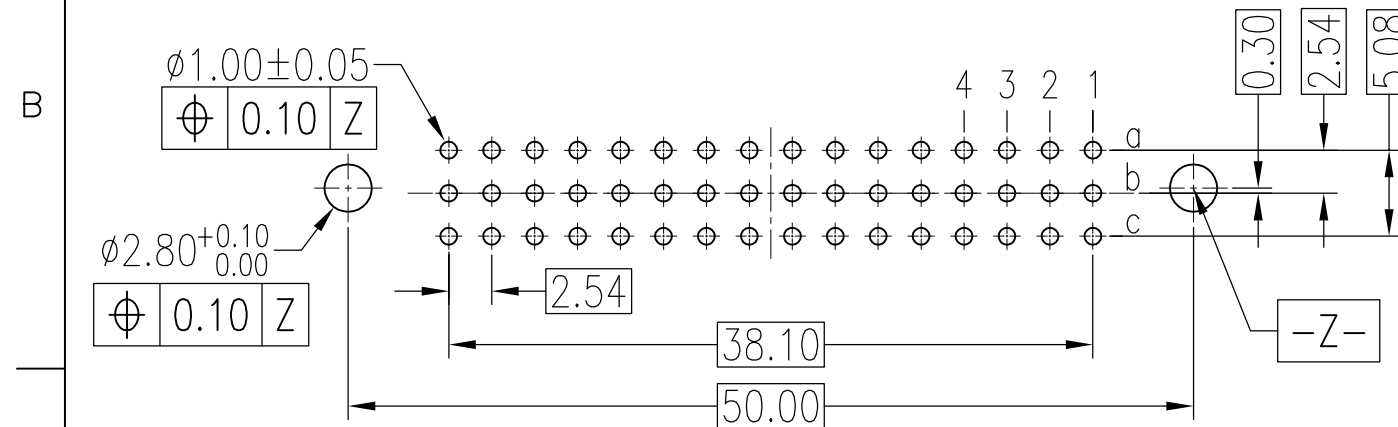
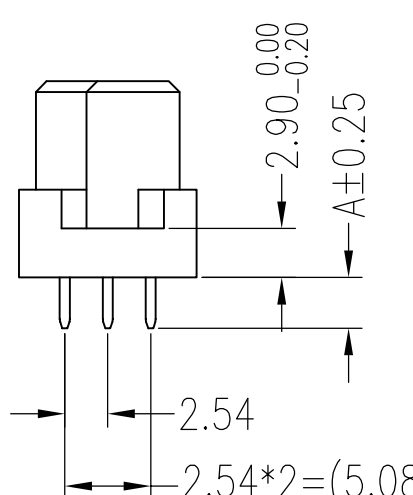
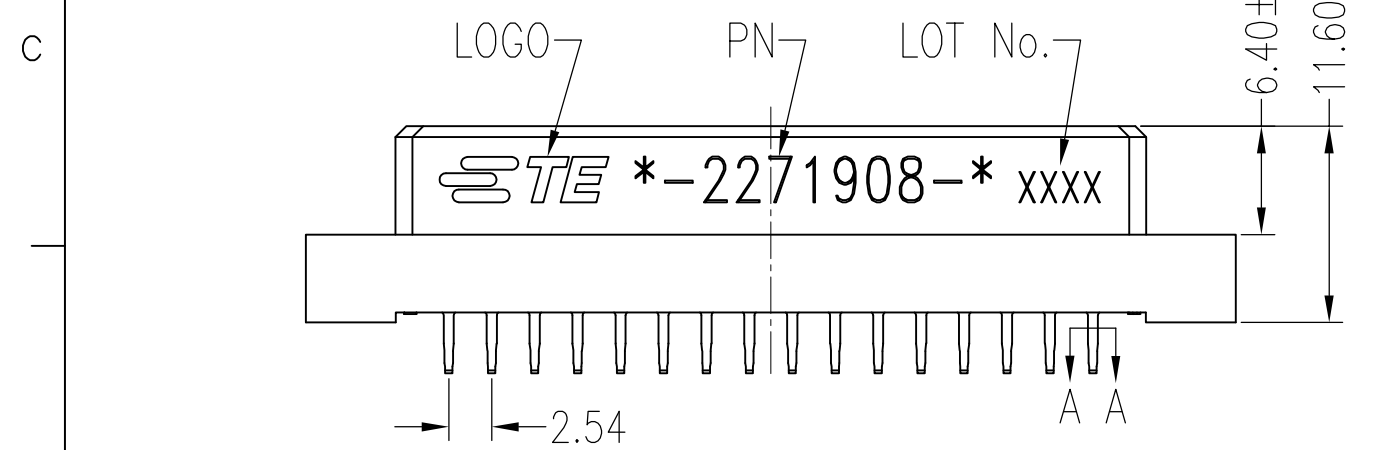

DIM.A	PLATING	ROWS (LOADED)	POS	PN
4.57	Ⓐ Ⓑ Ⓒ	a b c	48	8-2271908-2
	Ⓐ Ⓑ Ⓒ	a b c	48	8-2271908-1
	Ⓐ Ⓑ Ⓒ	a b c	48	8-2271908-0
	Ⓐ Ⓑ	a c	32	7-2271908-2
	Ⓐ Ⓑ	a c	32	7-2271908-1
	Ⓐ Ⓑ	a c	32	7-2271908-0
	Ⓐ Ⓑ Ⓒ	a b c	48	6-2271908-2
	Ⓐ Ⓑ Ⓒ	a b c	48	6-2271908-1
	Ⓐ Ⓑ Ⓒ	a b c	48	6-2271908-0
	Ⓐ Ⓑ	a c	32	5-2271908-2
	Ⓐ Ⓑ	a c	32	5-2271908-1
	Ⓐ Ⓑ	a c	32	5-2271908-0
	Ⓐ Ⓑ Ⓒ	a b c	48	4-2271908-2
	Ⓐ Ⓑ Ⓒ	a b c	48	4-2271908-1
	Ⓐ Ⓑ Ⓒ	a b c	48	4-2271908-0
	Ⓐ Ⓑ	a c	32	3-2271908-2
	Ⓐ Ⓑ	a c	32	3-2271908-1
	Ⓐ Ⓑ	a c	32	3-2271908-0
	Ⓐ Ⓑ Ⓒ	a b c	48	2-2271908-2
	Ⓐ Ⓑ Ⓒ	a b c	48	2-2271908-1
	Ⓐ Ⓑ Ⓒ	a b c	48	2-2271908-0
	Ⓐ Ⓑ	a c	32	1-2271908-2
	Ⓐ Ⓑ	a c	32	1-2271908-1
	Ⓐ Ⓑ	a c	32	1-2271908-0

RECOMMENDED P.C.B LAYOUT
(COMPONENT SIDE)

THIS DRAWING IS A CONTROLLED DOCUMENT.		DWN LEAR ZHANG 5JUL2017	TE Connectivity		
		CHK CHRIS WANG 5JUL2017			
DIMENSIONS: mm		APVD CHRIS WANG 5JUL2017	NAME DIN CONNECTOR, TYPE C 32 TO 48 PIN RECEPTACLE, VERTICAL		
		PRODUCT SPEC 108-137009	RESTRICTED TO		
TOLERANCES UNLESS OTHERWISE SPECIFIED:		APPLICATION SPEC	SIZE A3	CAGE CODE 00779	DRAWING NO C-2271908
0 PLC ± - 1 PLC ± 0.30 2 PLC ± 0.25 3 PLC ± - 4 PLC ± - ANGLES ± -		WEIGHT 0	SCALE 1:1		
MATERIAL -		FINISH -	SHEET 1 of 1		
		CUSTOMER DRAWING			REV A