

MATERIALS AND FINISHES

BODY PHOSPHOR BRONZE  
PLATED GOLD

CENTER CONTACT PHOSPHOR BRONZE  
PLATED GOLD

HOUSING PBT

CABLE  
1.13 CABLE OR EQUIVALENT

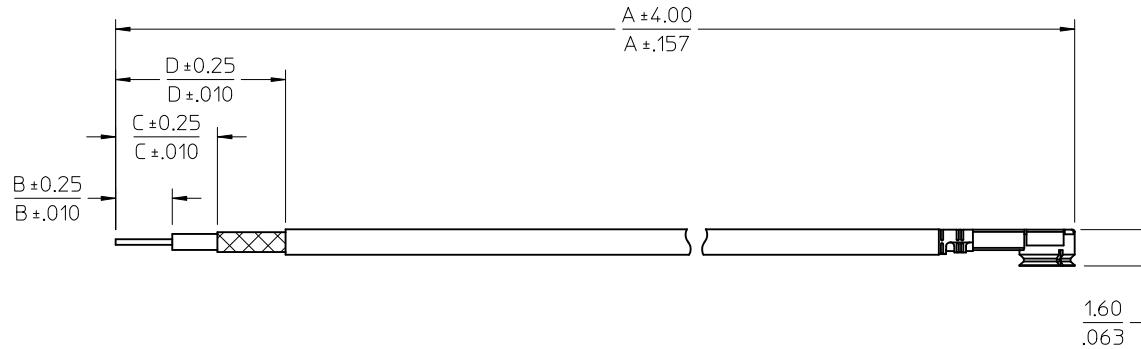
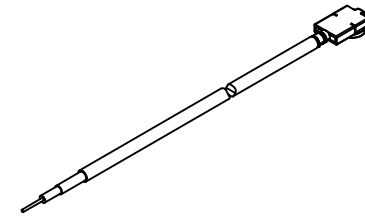

|   |            |                |                |                |                |
|---|------------|----------------|----------------|----------------|----------------|
| 5 | 73412-0254 | 122.00 / 4.803 | 2.00 / .078    | 4.00 / .157    | 7.00 / .275    |
| 4 | 73412-0253 | 50.80 / 2.00   | 2.00 / .078    | 3.80 / .149    | 6.80 / .267    |
| 3 | 73412-0252 | 180.00 / 7.086 | 2.00 / .078    | 3.30 / .129    | 5.80 / .228    |
| 2 | 73412-0251 | 162.00 / 6.377 | 2.00 / .078    | 4.00 / .157    | 7.00 / .275    |
| 1 | 73412-0250 | 102.00 / 4.015 | 2.00 / .078    | 4.00 / .157    | 7.00 / .275    |
|   | PART NO.   | DIM. A MM/INCH | DIM. B MM/INCH | DIM. C MM/INCH | DIM. D MM/INCH |

CHG:1)BODY PLATING  
CHANGE  
PLATED GOLD WAS  
PLATED TIN  
2)DIM. B,C,D. CHG  
EWR RF-11-E062  
EC NO: URF2011-0556  
DRWN:YCHENG 2011/03/03  
CHKD:  
APPR:MHUANG 2011/04/02

QUALITY SYMBOLS  
 = 0  
 = 0

GENERAL TOLERANCES (UNLESS SPECIFIED)

|          | mm     | INCH    |
|----------|--------|---------|
| 4 PLACES | ± .13  | ± .005  |
| 3 PLACES | ± .13  | ± .005  |
| 2 PLACES | ± 0.13 | ± .005  |
| 1 PLACE  | ± 0.25 | ± .010  |
| ANGULAR  | ± .5°  | ± .010° |

DRAFT WHERE APPLICABLE  
MUST REMAIN  
WITHIN DIMENSIONS

DIMENSION STYLE  
MM/IN

DRAWN BY JOHN DATE 2003/11/11  
 CHECKED BY JOHNSON DATE 2003/11/11  
 APPROVED BY MISEN DATE 2003/11/11

MATERIAL NO. SEE TABLE  
 SIZE C

SCALE DESIGN UNITS METRIC  
 THIRD ANGLE PROJECTION

TITLE  
MICRO COAXIAL CONNECTOR  
WITH 1.13 CABLE  
CA-UFL

MOLEX MOLEX INCORPORATED

DOCUMENT NO. SD-73412-025  
 SHEET NO. 1 OF 1

THIS DRAWING CONTAINS INFORMATION THAT IS PROPRIETARY TO MOLEX INCORPORATED AND SHOULD NOT BE USED WITHOUT WRITTEN PERMISSION