

Würth Elektronik eiSos GmbH & Co. KG

EMC & Inductive Solutions

Max-Eyth-Straße 1 · 74638 Waldenburg · Germany

Tel. +49 (0) 79 42 945-0 · Fax +49 (0) 79 42 945-400

eiSos@we-online.de · www.we-online.de



Product / Process Change Notification (PCN)

- Major change
 Minor change

<p>PCN #: PCN_MPC4_20191010_1</p> <p>Affected Series: WE-WR-MPC4 6490xxx13322; 6490xxx1822; 649xxxxxx22; 6490xxx21732; 649xxxx27222</p> <p>PCN Date: July 10, 2019</p> <p>Effective Date: October 10, 2019</p>	<p>Change Category:</p> <p><input type="checkbox"/> Equipment / Location <input type="checkbox"/> General Data <input checked="" type="checkbox"/> Material <input type="checkbox"/> Process <input type="checkbox"/> Product Design <input type="checkbox"/> Shipping / Packaging <input type="checkbox"/> Supplier <input type="checkbox"/> Software</p>
<p>Contact: Product Management</p> <p>Phone: +49 (0) 7942 - 945 5001</p> <p>Fax: +49 (0) 7942 - 945 5179</p> <p>E-Mail: pcn.eican@we-online.com</p>	<p>Data Sheet Change:</p> <p><input checked="" type="checkbox"/> Yes <input type="checkbox"/> No</p> <p>Attachment:</p> <p><input type="checkbox"/> Yes <input checked="" type="checkbox"/> No</p>

DESCRIPTION AND PURPOSE OF CHANGE:

Due to external influences, Würth Elektronik will change his plastic raw material supplier. The plastic material will still be PA66.

All products with date code 2019-07-01 or later, will be affected by this change.

There will be no change in function, quality or reliability of the product.

DETAIL OF CHANGE:

The plastic material will still be PA66. However the material behavior is slightly different during the production process and as Würth Elektronik will keep the current molds the parts tolerances dimensions will slightly change.

Due to raw plastic material supplier change Würth Elektronik is currently updating the UL certification related to the involved parts. The parts with date code after 2019-06-30 are not UL certified until the UL update. The UL should be updated by the end of November 2019. You will be informed when the certification will be up to date. Sorry for the inconvenience caused.

Please find on the following pages the parts dimensions and their recommended layout after change.

Würth Elektronik eiSos GmbH & Co. KG

EMC & Inductive Solutions

Max-Eyth-Straße 1 · 74638 Waldenburg · Germany

Tel. +49 (0) 79 42 945-0 · Fax +49 (0) 79 42 945-400

eiSos@we-online.de · www.we-online.de



649 0xx 211 22

Before

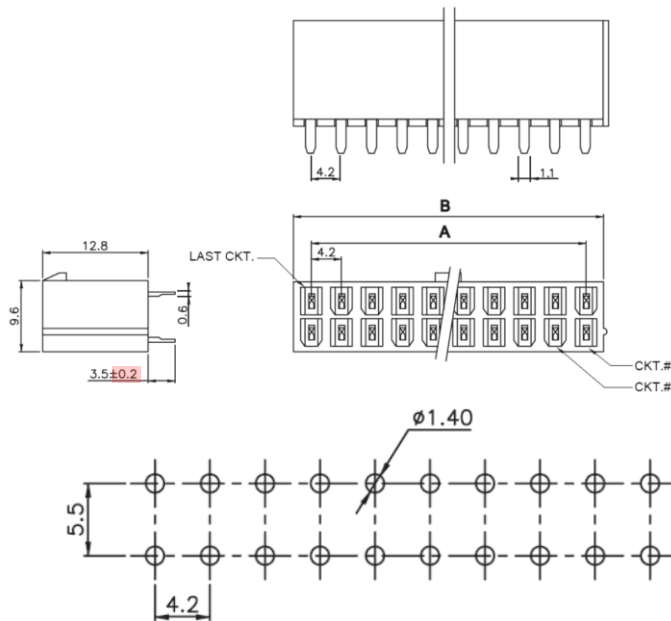

PCB LAYOUT - COMPONENT VIEW

GENERAL TOLERANCE

.X = +/- 0.2

.XX = +/- 0.15

After

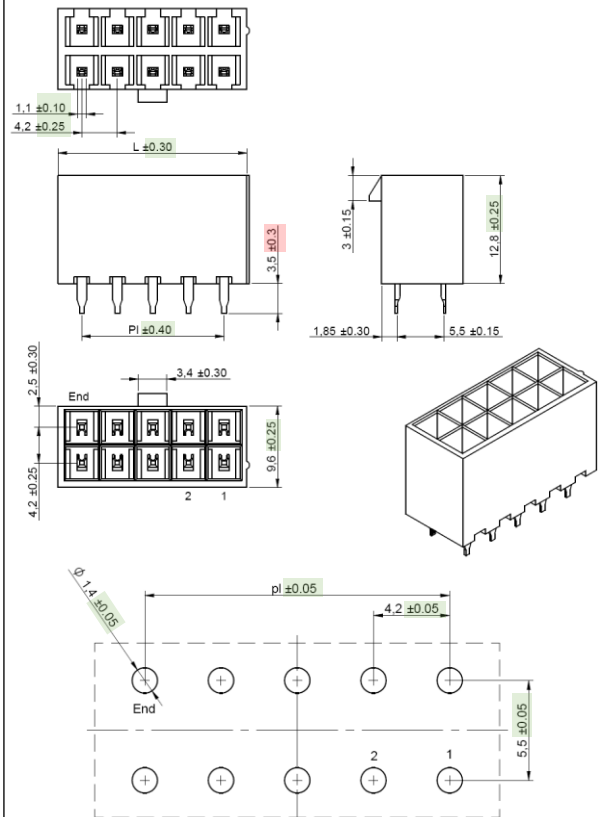

Würth Elektronik eiSos GmbH & Co. KG

EMC & Inductive Solutions

Max-Eyth-Straße 1 · 74638 Waldenburg · Germany

Tel. +49 (0) 79 42 945-0 · Fax +49 (0) 79 42 945-400

eiSos@we-online.de · www.we-online.de



649 0xx 221 732

Before

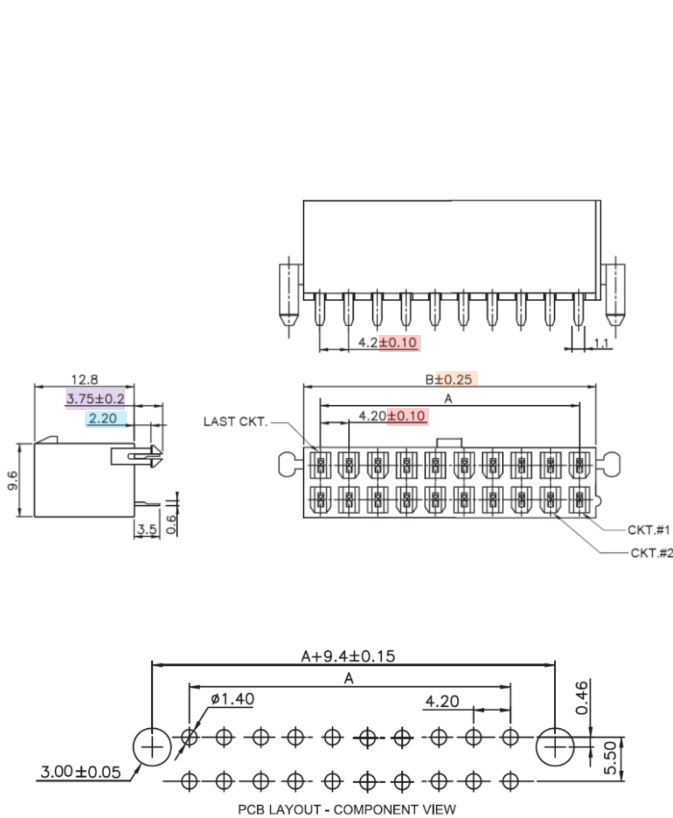

GENERAL TOLERANCE

.X = +/- 0.2

.XX = +/- 0.15

After

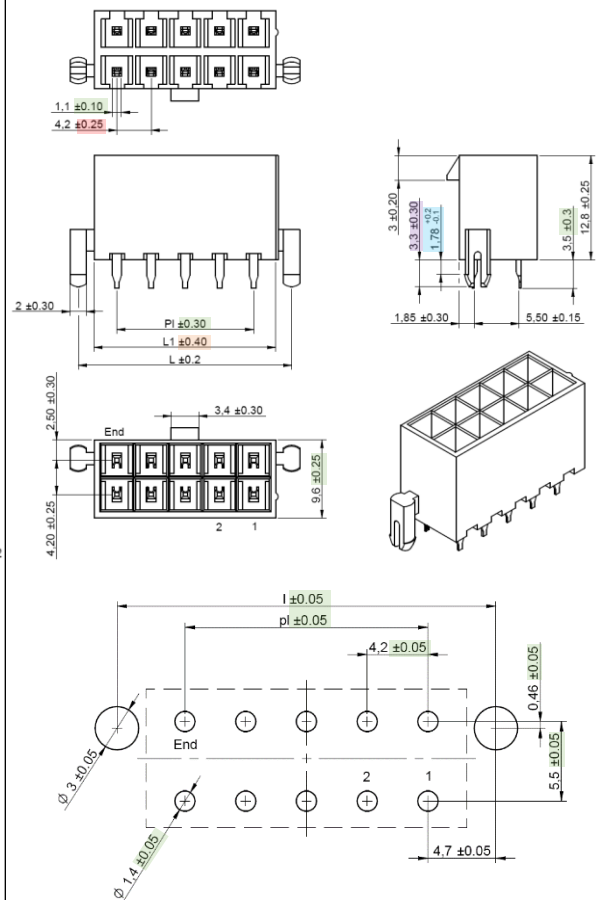

Würth Elektronik eiSos GmbH & Co. KG

EMC & Inductive Solutions

Max-Eyth-Straße 1 · 74638 Waldenburg · Germany

Tel. +49(0)79 42 945-0 · Fax +49(0)79 42 945-400

eiSos@we-online.de · www.we-online.de



649 0xx 295 22

Before

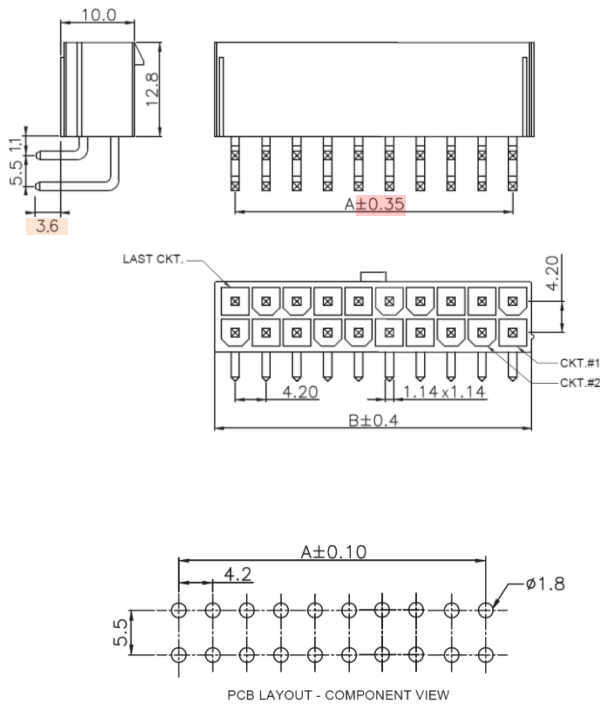

GENERAL TOLERANCE

.X = ± 0.2

.XX = ± 0.15

After

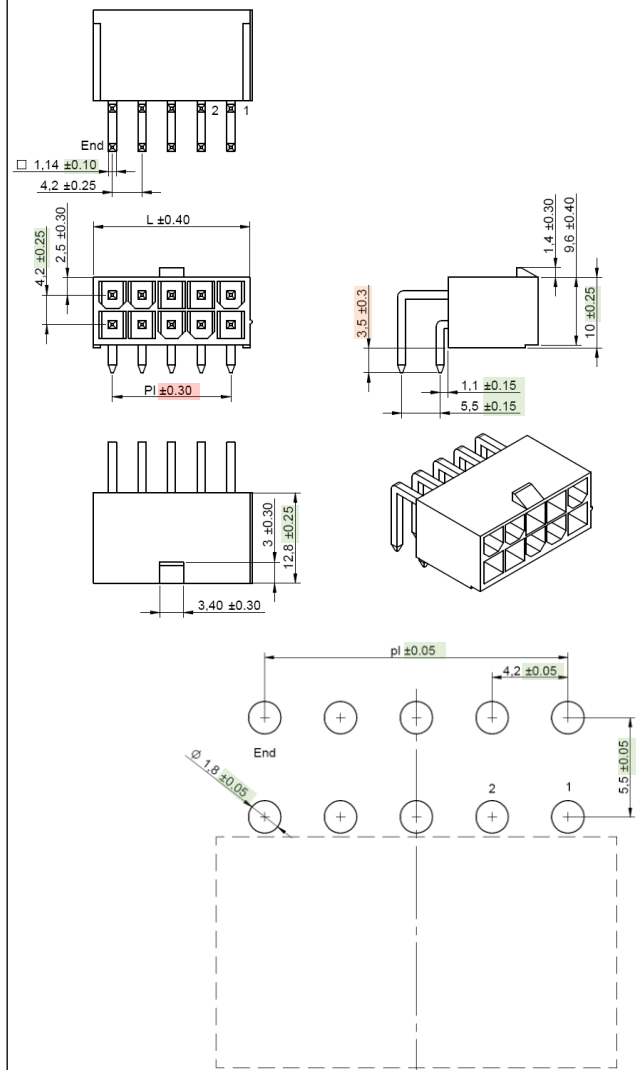

Würth Elektronik eiSos GmbH & Co. KG

EMC & Inductive Solutions

Max-Eyth-Straße 1 · 74638 Waldenburg · Germany

Tel. +49 (0) 79 42 945-0 · Fax +49 (0) 79 42 945-400

eiSos@we-online.de · www.we-online.de



649 0xx 227 222

Before

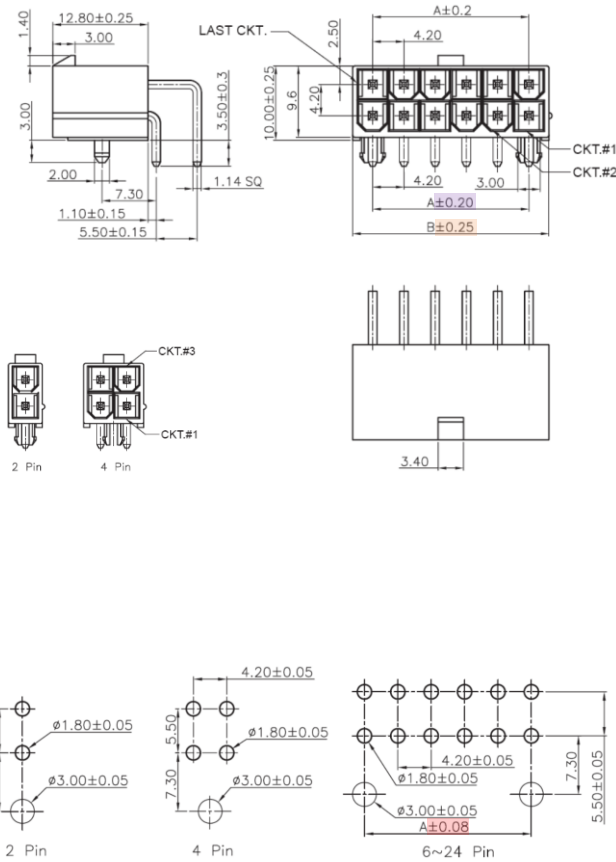

GENERAL TOLERANCE

.X = ± 0.2
 .XX = ± 0.15

After

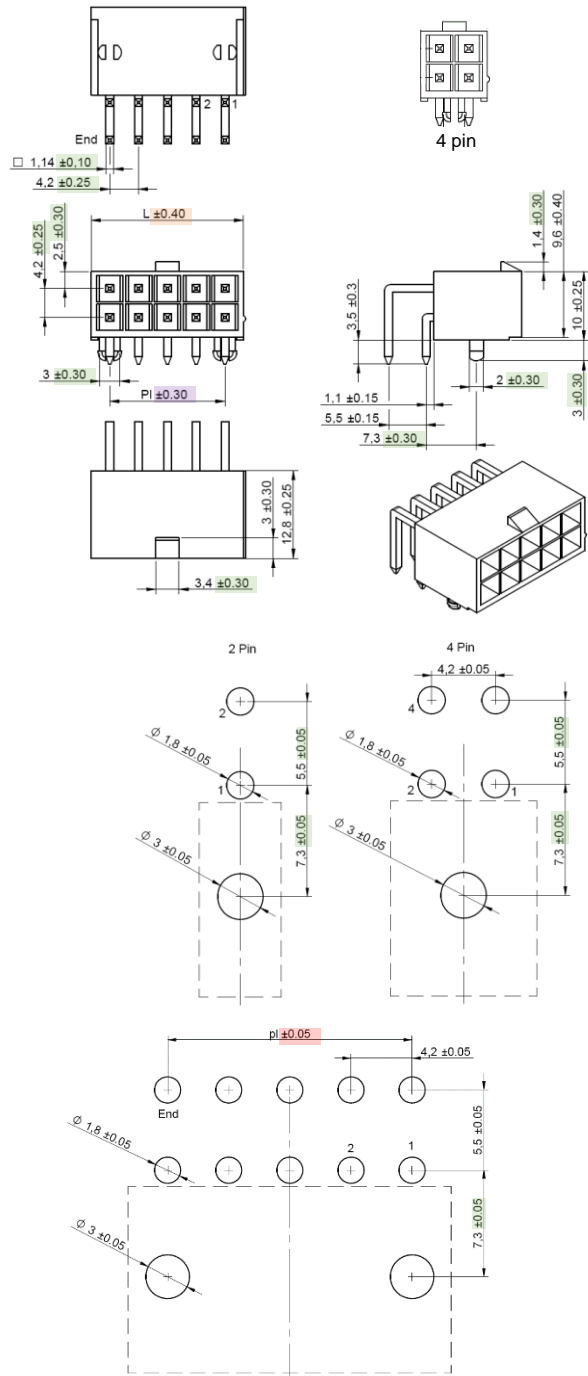

Würth Elektronik eiSos GmbH & Co. KG

EMC & Inductive Solutions

Max-Eyth-Straße 1 · 74638 Waldenburg · Germany

Tel. +49 (0) 79 42 945-0 · Fax +49 (0) 79 42 945-400

eiSos@we-online.de · www.we-online.de



649 0xx 113 322

Before

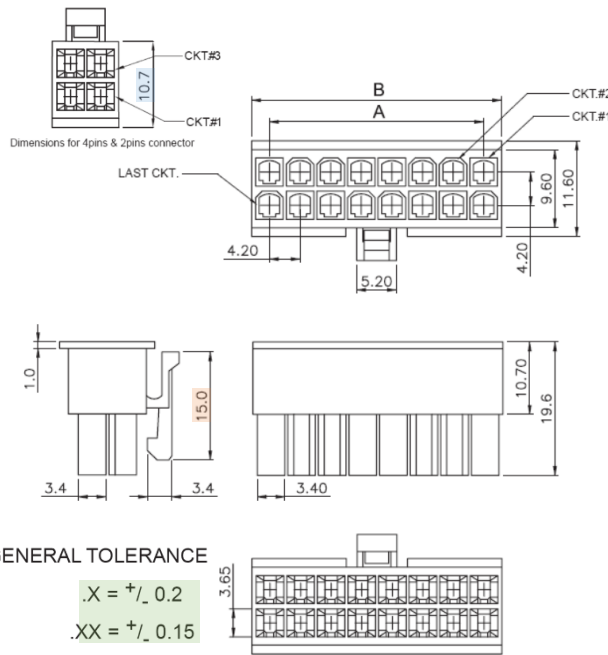

After

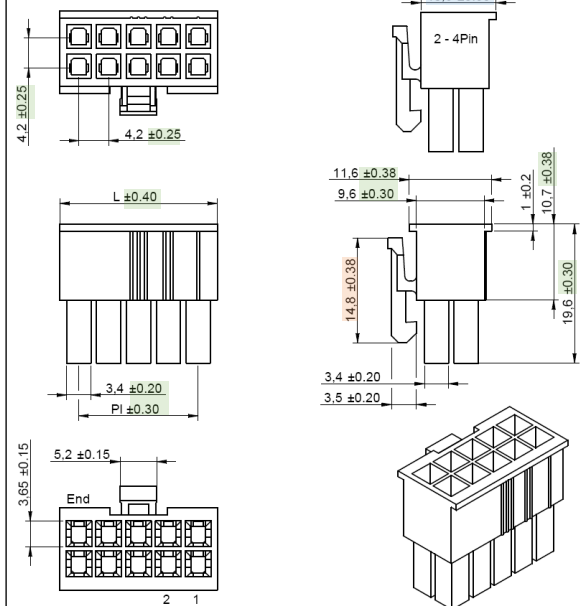

Würth Elektronik eiSos GmbH & Co. KG

EMC & Inductive Solutions

Max-Eyth-Straße 1 · 74638 Waldenburg · Germany

Tel. +49 (0) 79 42 945-0 · Fax +49 (0) 79 42 945-400

eiSos@we-online.de · www.we-online.de



649 0xx 111 22

Before

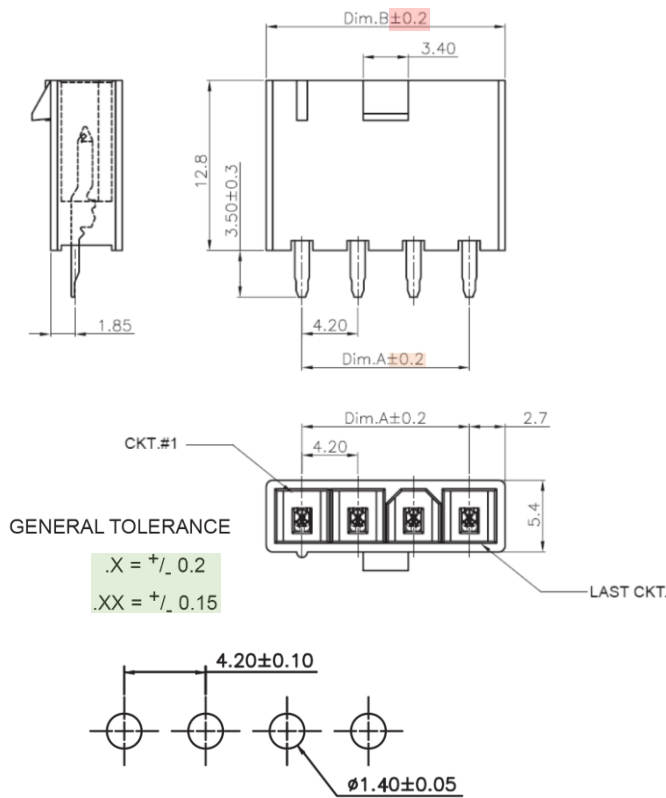

After

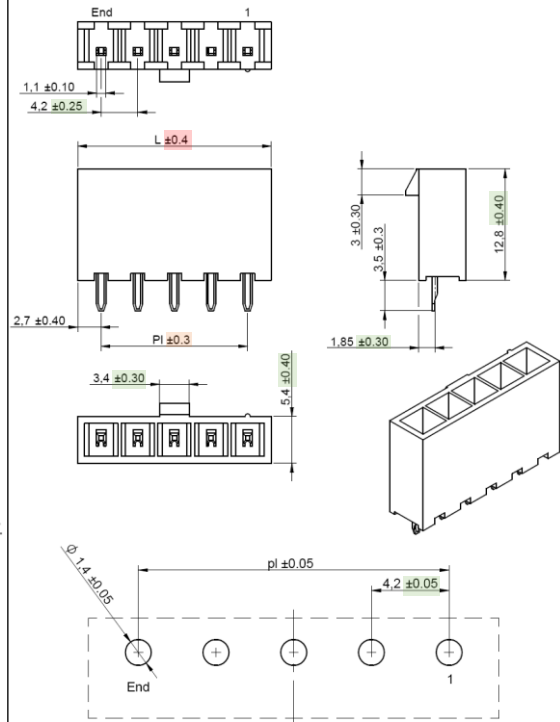

Würth Elektronik eiSos GmbH & Co. KG

EMC & Inductive Solutions

Max-Eyth-Straße 1 · 74638 Waldenburg · Germany

Tel. +49(0)79 42 945-0 · Fax +49(0)79 42 945-400

eiSos@we-online.de · www.we-online.de



649 0xx 121 732

Before

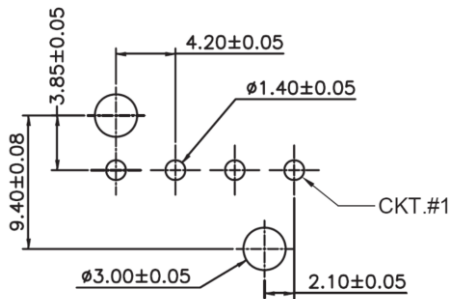
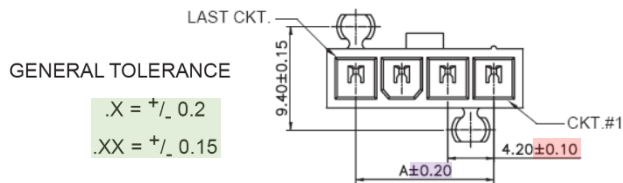
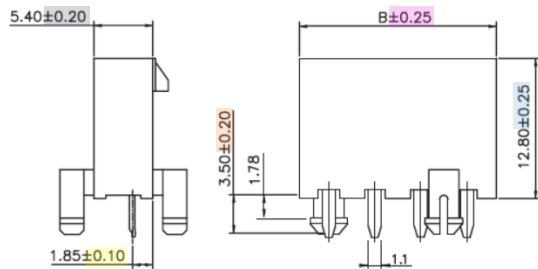

PCB LAYOUT - COMPONENT VIEW

After

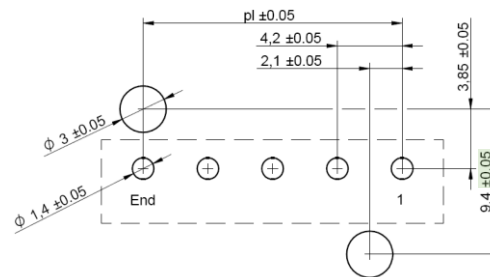
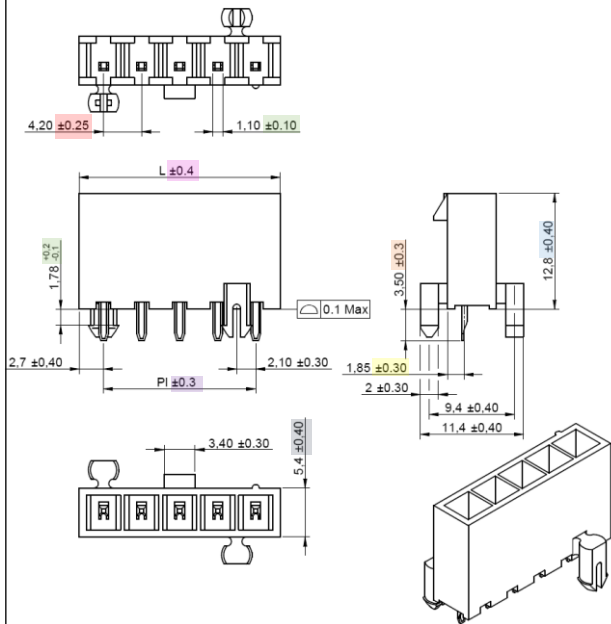

Würth Elektronik eiSos GmbH & Co. KG
 EMC & Inductive Solutions
 Max-Eyth-Straße 1 · 74638 Waldenburg · Germany
 Tel. +49 (0) 79 42 945-0 · Fax +49 (0) 79 42 945-400
 eiSos@we-online.de · www.we-online.de



649 0xx 195 22

Before

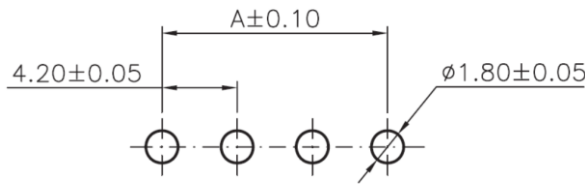
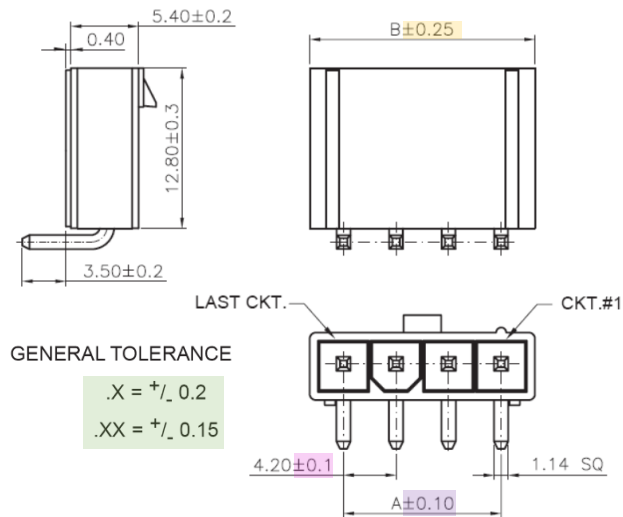

PCB LAYOUT - COMPONENT VIEW

After

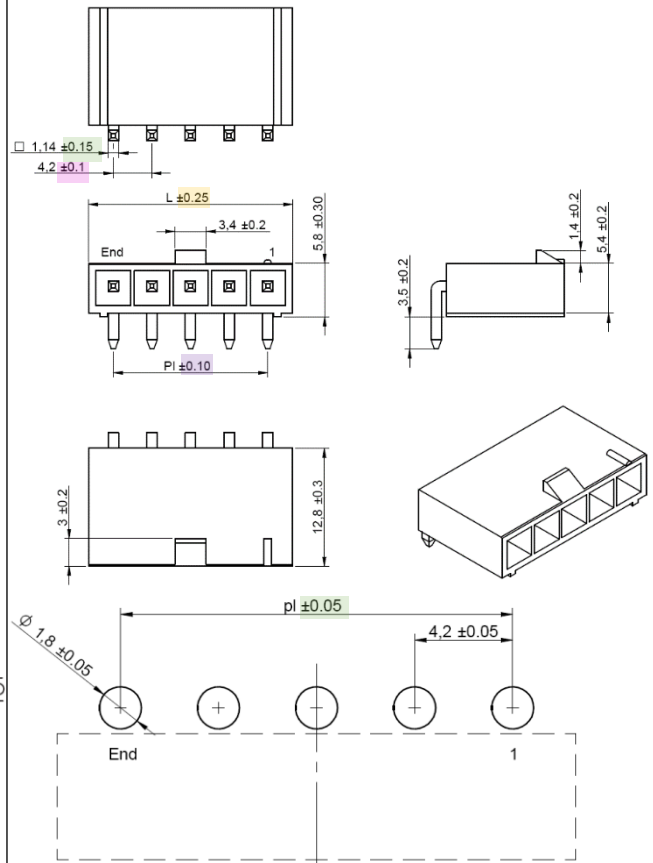

Würth Elektronik eiSos GmbH & Co. KG

EMC & Inductive Solutions

Max-Eyth-Straße 1 · 74638 Waldenburg · Germany

Tel. +49 (0) 79 42 945-0 · Fax +49 (0) 79 42 945-400

eiSos@we-online.de · www.we-online.de



649 0xx 127 222

Before

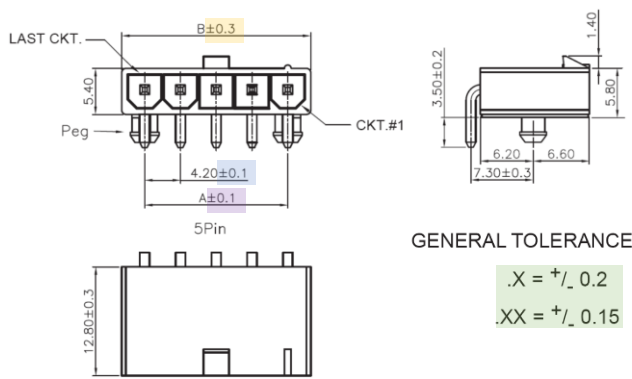

GENERAL TOLERANCE

.X = +/- 0.2

.XX = +/- 0.15

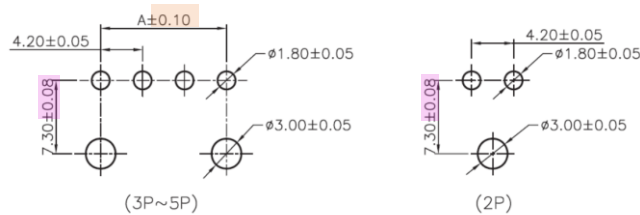

PCB LAYOUT - COMPONENT VIEW

After

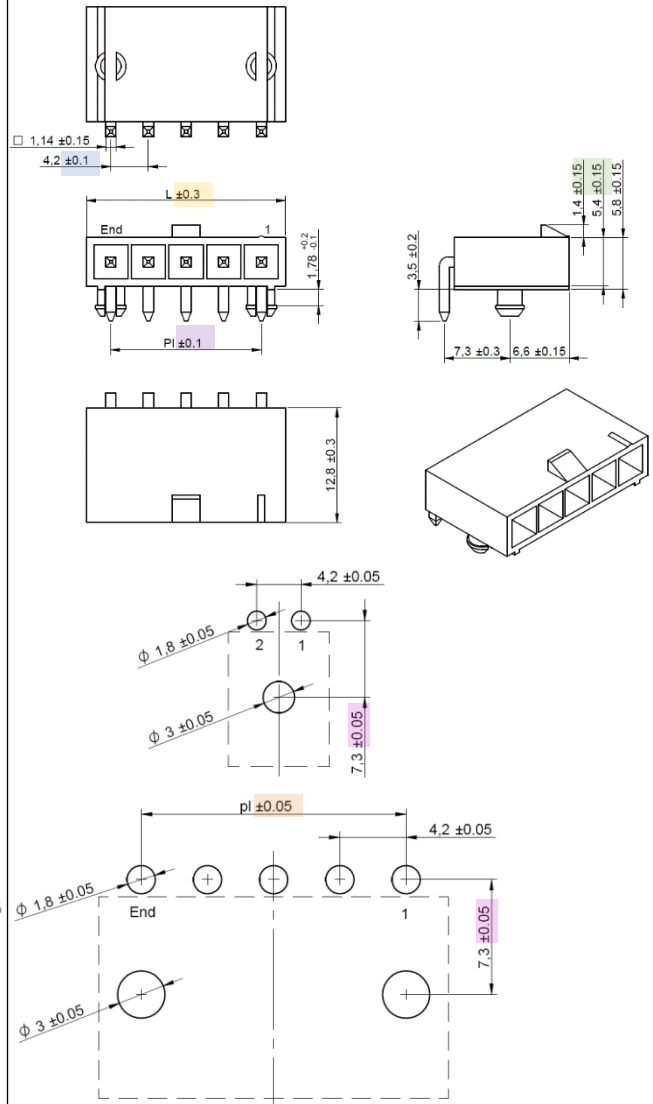

Würth Elektronik eiSos GmbH & Co. KG

EMC & Inductive Solutions

Max-Eyth-Straße 1 · 74638 Waldenburg · Germany

Tel. +49 (0) 79 42 945-0 · Fax +49 (0) 79 42 945-400

eiSos@we-online.de · www.we-online.de



649 0xx 110 22

Before

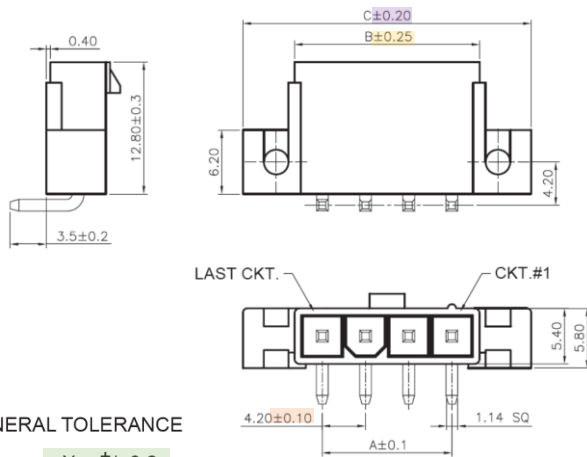

GENERAL TOLERANCE

- .X = +/-.0.2
- .XX = +/-.0.15

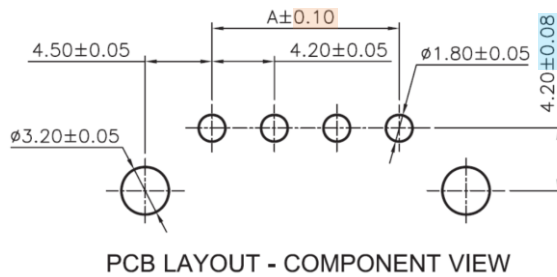

After

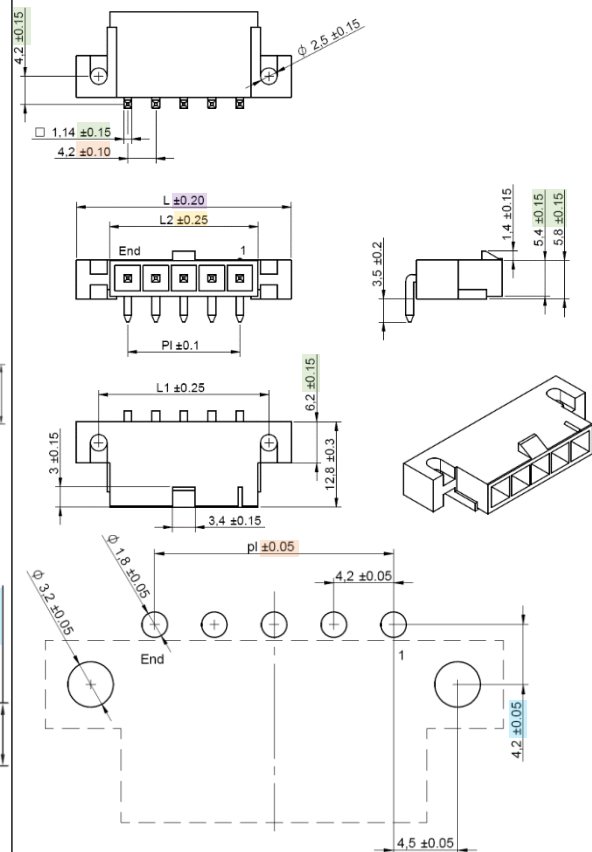

Würth Elektronik eiSos GmbH & Co. KG

EMC & Inductive Solutions

Max-Eyth-Straße 1 · 74638 Waldenburg · Germany

Tel. +49 (0) 79 42 945-0 · Fax +49 (0) 79 42 945-400

eiSos@we-online.de · www.we-online.de



649 0xx 118 22

Before

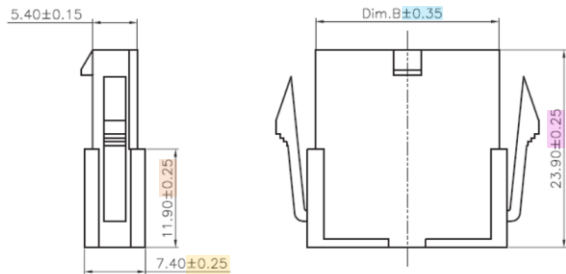

GENERAL TOLERANCE

.X = ± 0.2

.XX = ± 0.15

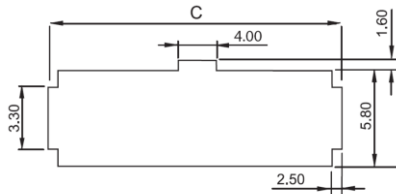
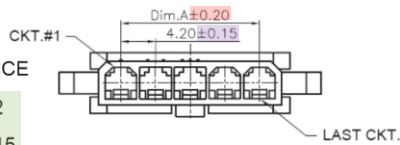

Recommended Panel Cut-out Thickness = 1.40 ± 0.40

After

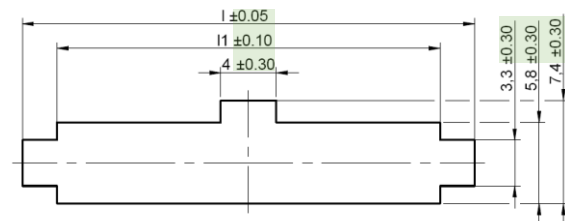
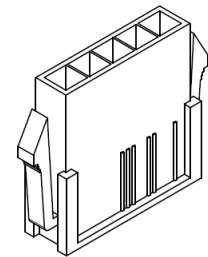
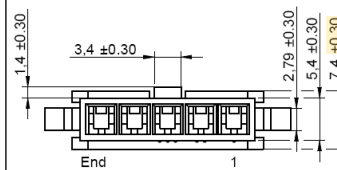
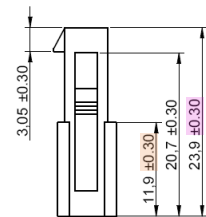
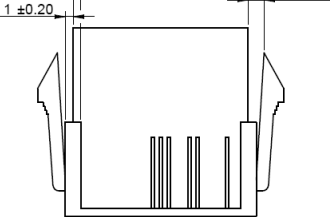
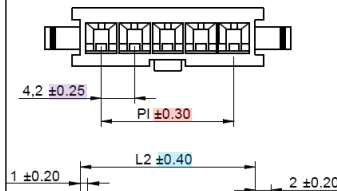

Panel cut: Thickness $1.4 - 2.54\text{mm}$

Würth Elektronik eiSos GmbH & Co. KG

EMC & Inductive Solutions

Max-Eyth-Straße 1 · 74638 Waldenburg · Germany

Tel. +49 (0) 79 42 945-0 · Fax +49 (0) 79 42 945-400

eiSos@we-online.de · www.we-online.de



649 0xx 013 322

Before

After

GENERAL TOLERANCE

.X = ± 0.2
.XX = ± 0.15

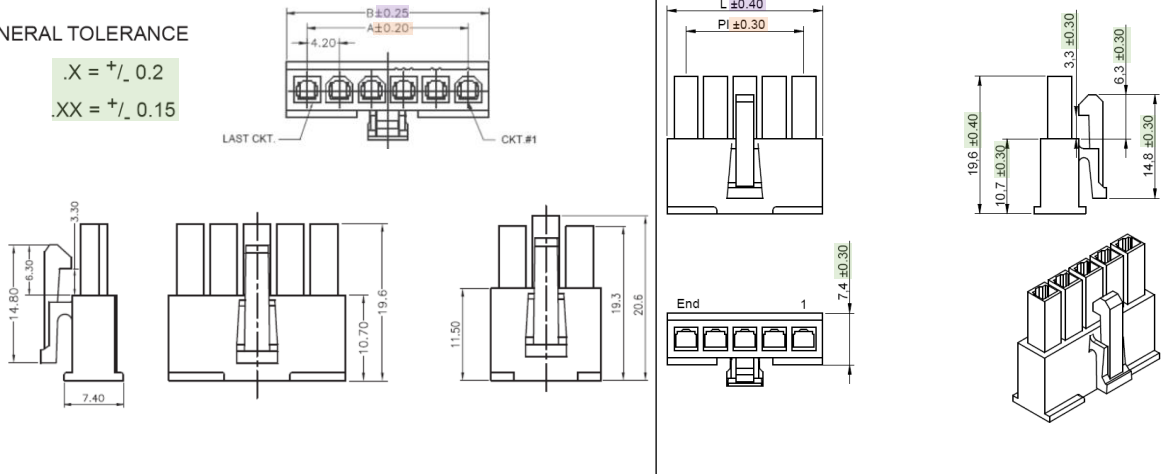

RELIABILITY / QUALIFICATION SUMMARY:

Product approval is according to the specification and is internally released by the Product Management Department.