

PT-01--24-01-22

PACKAGING VIEW LEAD STYLE SD -22

TABLE 2: SOCKET SPECIFICATION

LEAD STYLE	SERIES				
	-1 SS HSS SD	F <sub>I</sub> G	SL SDL	'B'	PIN LENGTH
-1A	SC-1W1-XX-2 (SL & SDL N/R)	1	N/A	N/A	.553 14.05
-1B	SC-1W1-XX-1 (SL & SDL N/R)	1	N/A	.038 [.97]	.703 17.86
-1C	SC-1W1-XX-3 (SL & SDL N/R)	1	N/A	.038 [.97]	.453 11.51
-2	SC-1P1-XX (SL & SDL N/R)	1	N/A	.038 [.97]	.300 7.62
-3	SC-1S1-XX (SL & SDL N/R)	1	N/A	.038 [.97]	.203 5.16
-4	SC-2S1-XX (SL & SDL N/R)	5,6	N/A	.038 [.97]	.290 7.37
-5	SC-2P1-XX (SS & HSS ONLY)	3	N/A	.038 [.97]	.703 17.86
-5A	SC-2P1-XX (SL & SDL N/R)	1	N/A	N/A	.703 17.86
-7	SC-1P3-XX (SL & SDL N/R)	1	N/A	N/A	.600 15.24
-8	SC-2P3-XX (SL & SDL N/R)	1	N/A	N/A	.542 13.77
-9	SC-2P2-XX (SL & SDL N/R)	1	N/A	N/A	.703 17.86
-10	N/A	2	SC-3P1-XX	.038 [.97]	.230 5.84
-11	N/A	2	SC-4P1-XX	.028 [.71]	.240 6.10
-12	N/A	2	SC-5P1-XX	.028 [.71]	.190 4.83
-13	SC-2P7-XX (SS ONLY)	2	N/A	.039 [.99]	.310 7.87
-14	SC-1M1-XX (N/A)	1	N/A	N/A	.205 5.21
-15	SC-1M2-XX (N/A)	2	N/A	.028 [.71]	.167 4.24
-17	SC-7P1-XX (N/A)	1	N/A	N/A	.443 11.25
-18	SC-6P1-XX (SL & SDL N/R)	1	N/A	.038 [.97]	.353 8.97
-19	N/A	2	SC-8P1-XX	.016 [.41]	.165 4.19
-20	SC-9P1-XX (N/A)	2	N/A	.028 [.71]	.190 4.83
-21A	EZ-1W1-XX-2 (SL & SDL N/R)	1	N/A	N/A	.553 14.05
-21B	EZ-1W1-XX-1 (SL & SDL N/R)	1	N/A	N/A	.703 17.86
-21C	EZ-1W1-XX-3 (SL & SDL N/R)	1	N/A	N/A	.453 11.51
-22	EZ-1P1-XX (SL & SDL N/R)	1	N/A	.030 [.76]	.300 7.62
-23	EZ-1S1-XX (SL & SDL N/R)	1	N/A	N/A	.203 5.16
-28	EZ-2P3-XX (SL & SDL N/R)	1	N/A	N/A	.542 13.77
-29	EZ-2P2-XX (SL & SDL N/R)	1	N/A	N/A	.703 17.86
-30	EZ-3P1-XX (SL & SDL ONLY)	2	N/A	.038 [.97]	.230 5.84
-31	EZ-4P1-XX (SL & SDL ONLY)	2	N/A	.028 [.71]	.240 6.10
-32	EZ-5P1-XX (SL & SDL ONLY)	2	N/A	.028 [.71]	.190 4.83
-34	EZ-1M1-XX (N/A)	1	N/A	N/A	.205 5.21
-37	EZ-7P1-XX (N/A)	1	N/A	N/A	.443 11.25
-38	EZ-6P1-XX (SL & SDL N/R)	1	N/A	N/A	.353 8.97
-39	EZ-8P1-XX (SL & SDL ONLY)	2	N/A	.016 [.41]	.165 4.19
-40	EZ-9P1-XX (N/A)	2	N/A	.028 [.71]	.190 4.83
-41	SC-6P1-XX (N/A)	9	N/A	.005 [.13]	.353 8.97

SEE NOTE 4  
SEE NOTE 3 & 4  
(SHEET 1)

SEE NOTE 6  
(SHEET 1)

NOT AVAILABLE  
IN -TT PLATING

DIMENSIONS ARE IN INCHES UNLESS OTHERWISE NOTED TOLERANCES ARE:  
 ONE PLACE DECIMALS ±.1[2.5] THREE PLACE DECIMALS ±.005 [.13]  
 TWO PLACE DECIMALS ±.01[.25] FOUR PLACE DECIMALS ±.0020[.05]  
 ANGLES ± 2°

TITLE: ASSEMBLY SOCKET STRIP  
 DWG NO: XSX-1XX-XX-XX-X-X  
 SHEET 2 OF 2

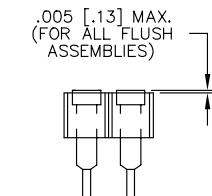

FIGURE 1  
(SEE NOTE 9 SHT.1)

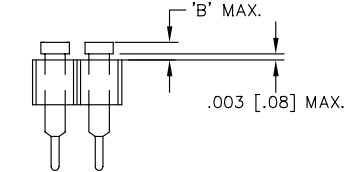

FIGURE 2

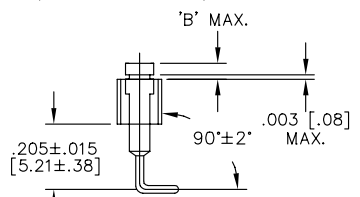
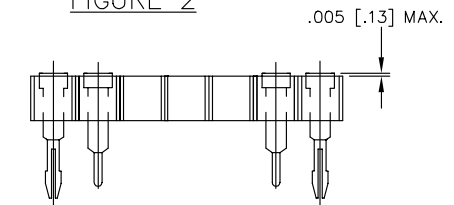
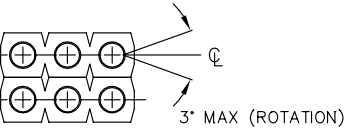
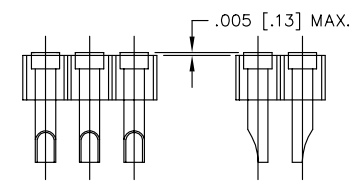

FIGURE 3  
(SEE NOTE 9 SHT.1)



OPTION -L: REPLACE BOTH END POS. (BOTH ROWS) AS SHOWN

FIGURE 4  
(SEE NOTE 9 SHT.1)



(TYP DOUBLE ROW SHOWN)

FIGURE 5  
(SEE NOTE 9 SHT.1)

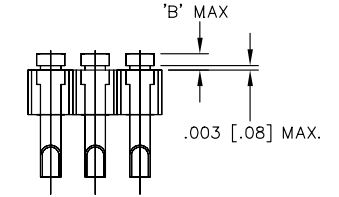

SAME AS FIG. 5 EXCEPT AS SHOWN (USED IN CSS CABLE)

FIGURE 6  
(SEE NOTE 9 SHT.1)

DELETED  
FIGURE 7

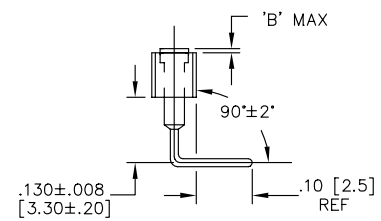

FIGURE 9  
(SEE NOTE 9 SHT.1)

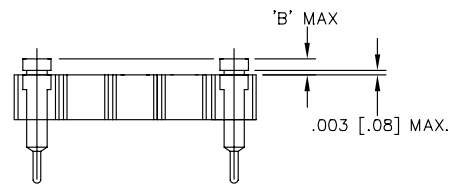

FIGURE 8  
OPTION -N  
(SEE NOTE 9 SHT.1)

"B" DIMENSION FOR OPTION -N = NON FLUSH

**PROPRIETARY NOTE**  
 THIS DOCUMENT CONTAINS INFORMATION CONFIDENTIAL AND PROPRIETARY TO SAMTEC INC. AND SHALL NOT BE REPRODUCED OR TRANSMITTED TO OTHER DOCUMENTS OR DISCLOSED TO OTHERS OR USED FOR ANY PURPOSE OTHER THAN THAT FOR WHICH IT WAS OBTAINED WITHOUT THE EXPRESSED WRITTEN CONSENT OF SAMTEC INC.

**samtec** F:\DWG\MISC\MKTG\XSX-MRTZ  
 520 PARK EAST BLVD. NEW ALBANY, INDIANA 47151-1147  
 PHONE (812) 944-6733 P.O. BOX 1147  
 CODE 55322  
 MADE BY: MARK CHILTON 11-28-88 XSX-1XX-XX-XX-X-X  
 SHEET 2 OF 2