

This document is the property of and embodies CONFIDENTIAL and PROPRIETARY information of AMOR. No part of the information shown on this document may be used in any way or disclosed to others without the written consent of AMOR. © 2019 AMOR

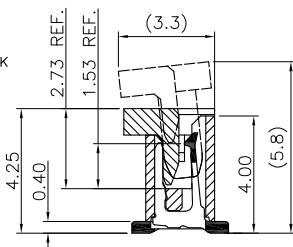

REV.	ECR/ECN No.	DESCRIPTION	DRAWN/DATE	CHECKED/DATE	APPROVED/DATE
C	/	Update the drawing	May 2020-08-07	Rain 2020-08-07	Leo.Liu 2020-08-07

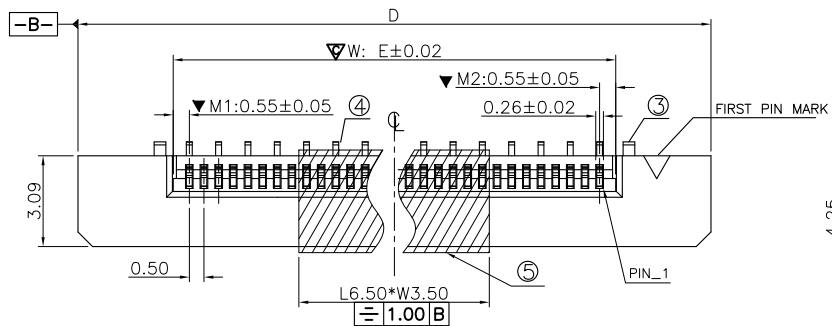

NO.	COMPONENTS	MATERIALS	SPECIFICATION:FINISH/COLOR	QTY.
1	SLIDER	GLASS FILLED PA9T, UL94V-0	BLACK	1
2	HOUSING	GLASS FILLED LCP, UL94V-0	NATURAL	1
3	ANCHOR-PLATE	BRASS, T=0.40mm	SURFACE PLATING:2~5 um Sn UNDER PLATING:1~3 um Ni	2
4	CONTACT	PHOSPHOR BRONZE, T=0.20mm	SURFACE PLATING:SEE "NOTE" UNDER PLATING:1~3 um Ni	N
5	MYLAR	T=0.10mm 耐高溫	YELLOW	1

NOTE:
 1.ALL MATERIAL MUST BE COMPLY WITH SS-00259/RoHS.
 2."▼" MARK IS IMPORTANT DIMENSIONS
 3."▽" MARK IS CPK AND X-R DIMENSION
 4.PART NO. LEGEND:
 F3**-A7*1-110**

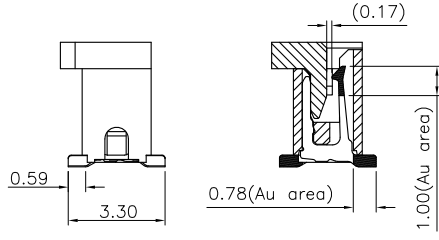
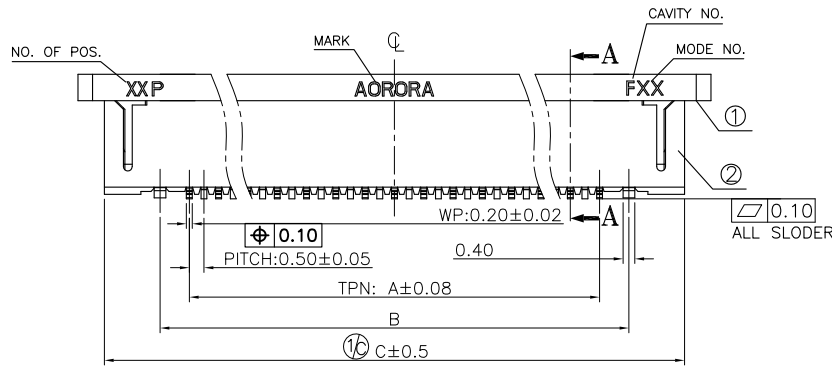

NO. OF POSITIONS
 7H:PHOSPHOR BRONZE
 0.05um MIN Au(Au Area)
 7A:PHOSPHOR BRONZE
 MATTER TIN
 1A:LCP NATURAL
 FA:LCP NATURAL
 1Z:WITH MYLAR(A TYPE)
 1W:NO MYLAR(A TYPE)

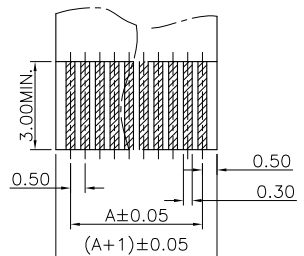
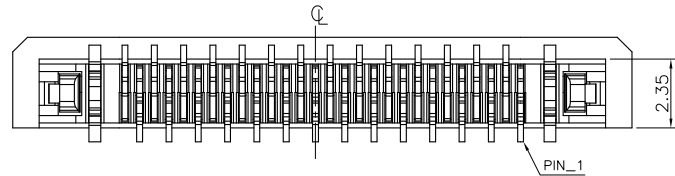

APPLICABLE FFC RECOMMENDED DIM.
 THICKNESS:0.30±0.03

DIMENSION LIST:

NO. OF POS.	A	B	C	D	E	NO. OF POS.	A	B	C	D	E
4	1.50	3.50	7.30	9.10	2.60	17	8.00	10.00	13.80	15.60	9.10
5	2.00	4.00	7.80	9.60	3.10	18	8.50	10.50	14.30	16.10	9.60
6	2.50	4.50	8.30	10.10	3.60	19	9.00	11.00	14.80	16.60	10.10
7	3.00	5.00	8.80	10.60	4.10	20	9.50	11.50	15.30	17.10	10.60
8	3.50	5.50	9.30	11.10	4.60	21	10.00	12.00	15.80	17.60	11.10
9	4.00	6.00	9.80	11.60	5.10	22	10.50	12.50	16.30	18.10	11.60
10	4.50	6.50	10.30	12.10	5.60	23	11.00	13.00	16.80	18.60	12.10
11	5.00	7.00	10.80	12.60	6.10	24	11.50	13.50	17.30	19.10	12.60
12	5.50	7.50	11.30	13.10	6.60	25	12.00	14.00	17.80	19.60	13.10
13	6.00	8.00	11.80	13.60	7.10	26	12.50	14.50	18.30	20.10	13.60
14	6.50	8.50	12.30	14.10	7.60	27	13.00	15.00	18.80	20.60	14.10
15	7.00	9.00	12.80	14.60	8.10	28	13.50	15.50	19.30	21.10	14.60
16	7.50	9.50	13.30	15.10	8.60	29	14.00	16.00	19.80	21.60	15.10

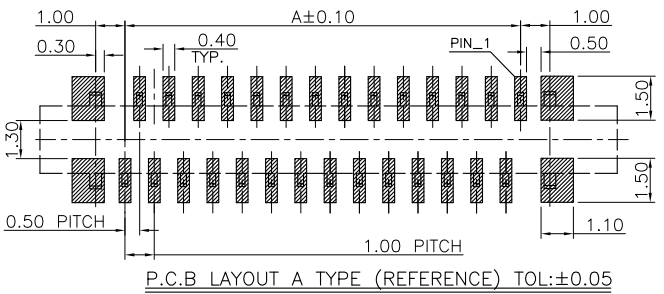

UNLESS OTHERWISE SPECIFIED TOLERANCES		ANGLE OF PROJECTION		 Amphenol Aorora Technology (Huizhou) Co.,Ltd	
X.	±0.30	X. '	± 5'		
X.X	±0.25	X.X '	± 4'	TITLE: Assembly Drawing For 0.50mm pitch 4-29PIN VERTICAL SMT A TYPE,SLIDER SERIES	
X.XX	±0.20	X.XX '	± 3'		
X.XXX	±0.15	X.XXX '	± 2'	PART NUMBER: F3**-A7*1-110**	
LINEAR DIMS		ANGLES DIMS			
DWG NO.:	A-S0136	DRAWN DATE		May 2018-08-28	SCALE: 4:1 UNIT: mm SHEET 1 OF 2
MATERIAL	SEE NOTES	DESIGN DATE		May 2018-08-28	
FINISHED	SEE NOTES	CHECKED DATE		Rain 2018-08-28	REV. C
		APPROVED DATE		Leo.Liu 2018-08-28	

1 | 2 | 3 | 4

1. PACKING INTO REEL:

LIST:

DIM	NO.	4~15	16~25	26~29
A		24.00	32.00	44.00
B		11.50	28.40	40.40
N		10	8	6
TOTAL(PCS)		12000	9600	7200

NOTES:

- MATERIAL:
 - CARRY TAPE:HIPS,T=0.35mm,CLEAR
 - REEL:HIPS,BLUE.
 - SHIM:PE,CLEAR.
- PRIMARY PACKING:1,200PCS/REEL.
- SECONDARY PACKING:"N"REELS/CARTON
("TOTAL"=N*1200/CARTON).
- PEELING RESISTANCE: 0.1N~0.7N(10~70gf);
PEELING ANGLE: 165°~180°;
PEELING SPEED: 300mm/minutes.

A

B

C

D

2:PACKING INTO OUTER BOX

A

B

C

D

This document is the property of and embodies CONFIDENTIAL and PROPRIETARY information of AOR. No part of the information shown on this document may be used in any way or disclosed to others without the written consent of AOR. © 2019 AOR

UNLESS OTHERWISE SPECIFIED TOLERANCES			ANGLE OF PROJECTION		Amphenol AORORA	
X.	±0.30	X. '	± 5'			Amphenol Aorora Technology (Huizhou) Co.,Ltd
X.X	±0.25	X.X '	± 4'			
X.XX	±0.20	X.XX '	± 3'	DOC TYP Customer Drw		TITLE:
X.XXX	±0.15	X.XXX '	± 2'	DRAWN DATE May 2018-08-28	DESIGN DATE May 2018-08-28	Assembly Drawing For 0.50mm pitch 4-29PIN VERTICAL SMT A TYPE,SLIDER SERIES
LINEAR DIMS		ANGLES DIMS		CHECKED DATE Rain 2018-08-28	SIZE A4	PART NUMBER:
DWG NO.: A-S0136		MATERIAL SEE NOTES		APPROVED DATE Leo.Liu 2018-08-28	SCALE 1:1	F3**-A7*1-110**
FINISHED SEE NOTES		REEL PART (EMPTY)		UNIT : mm		REV. C
LEADER PART (EMPTY)		COMPONENT SUPPLIER		SHEET 2 OF 2		

1 | 2 | 3 | 4

Aor-QR-0406-A