



**ANATECH ELECTRONICS INC**  
RF & Microwave Filters & Products

# 1230 MHz / 1585 MHz Ceramic Duplexer

**Part Number: AM1585-1230D1134**





Characteristics	Band 1	Band 2
<b>Passband:</b>	1190-1270 MHz	1545-1625 MHz
<b>Bandwidth:</b>	Fo +/- 40 MHz	Fo +/- 40 MHz
<b>Passband Return Loss:</b>	10 dB min	10 dB min
<b>Passband Insertion Loss:</b>	1.0 dB max	1.0 dB max
<b>Ripple in BW:</b>	0.2 dB	0.2 dB
<b>Input / Output Impedance:</b>	50 Ohms	50 Ohms
<b>Attenuation:</b>	10 dBc min @ 1030 MHz 10 dBc min @ 1530 MHz	10 dBc min @ 1400 MHz 10 dBc min @ 1800 MHz
<b>Isolation:</b>	15 dB min	15 dB min
<b>Power Handling:</b>	3 W	3 W

Mechanical	
<b>Mounting Method:</b>	SMT
<b>Dimensions:</b>	15 x 10 x 4 mm

Environmental	
<b>Operating Temperature:</b>	-20 to +70 deg.C
<b>Storage Temperature:</b>	-50 to +90 deg.C

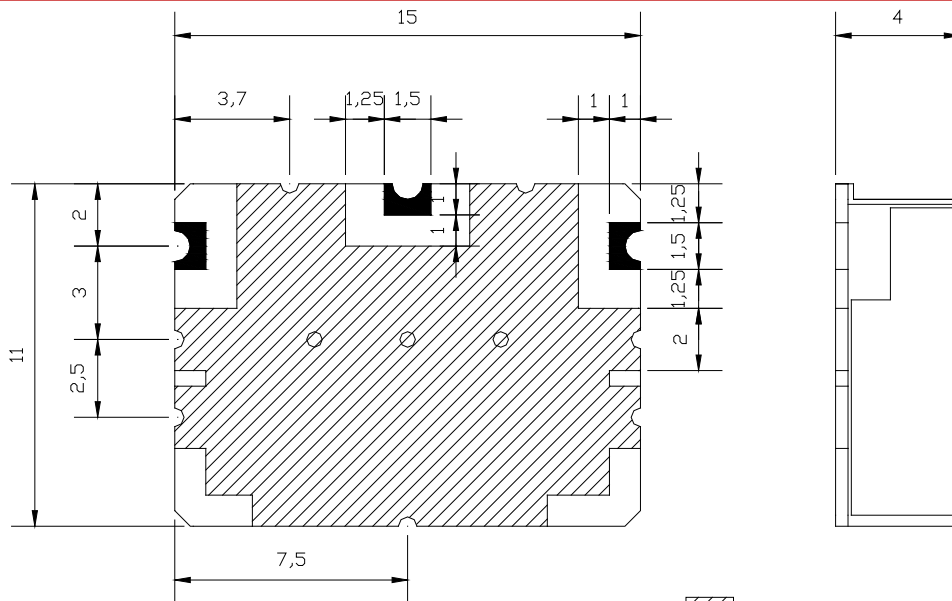
**This product is RoHs compliant.**

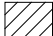

 GROUND  
 IN/OUT PORT  
 UNIT : mm  
 TOLERANCE : +/- 0.3

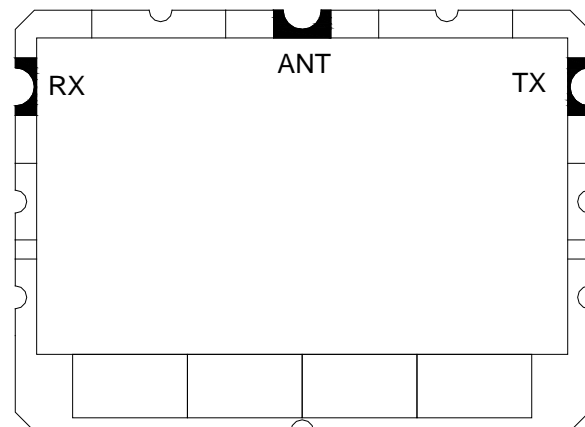



# 1230 MHz / 1585 MHz Ceramic Duplexer

## Part Number: AM1585-1230D1134

**ANATECH ELECTRONICS INC**  
RF & Microwave Filters & Products



### Response Plots:

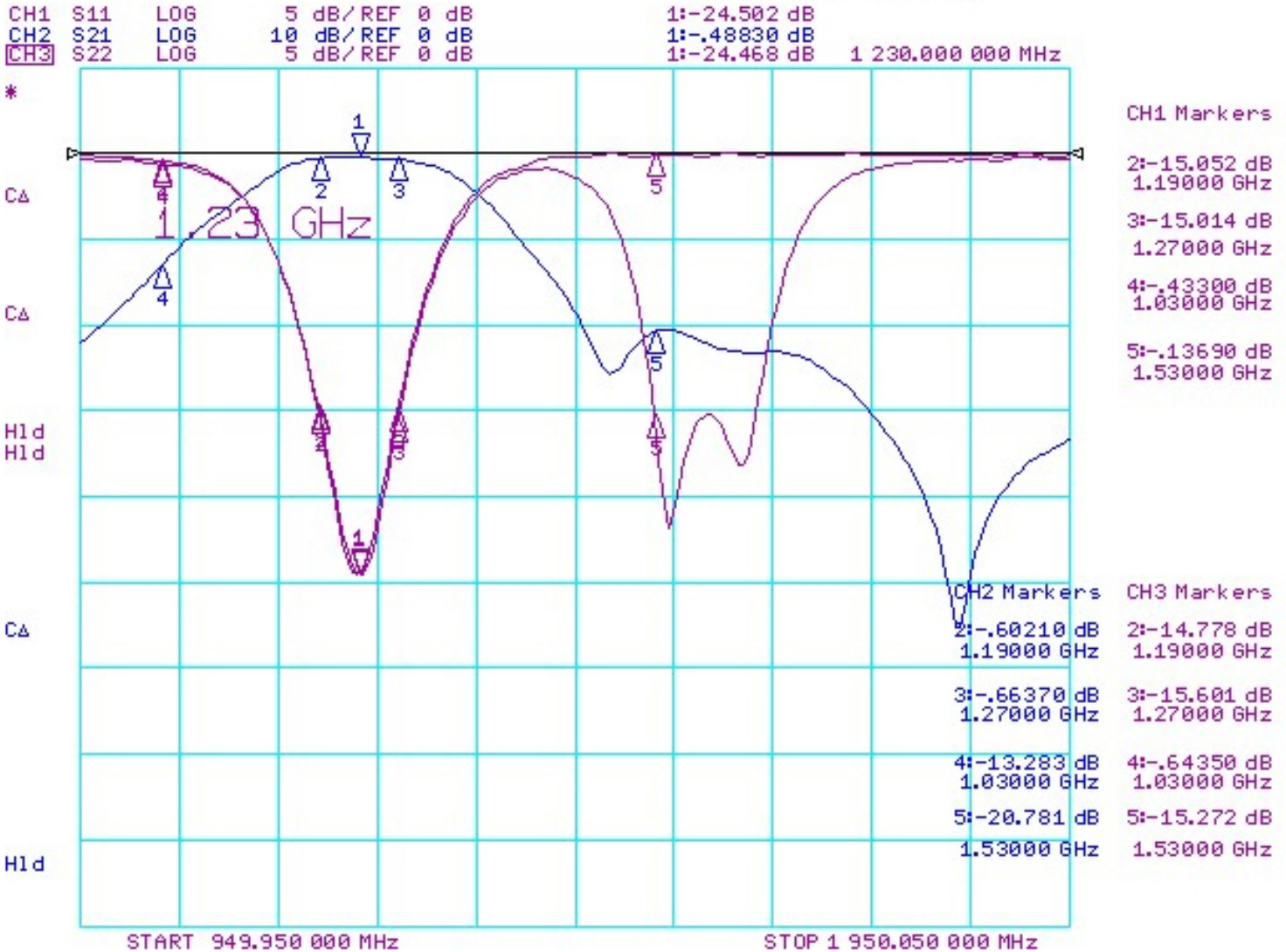



# 1230 MHz / 1585 MHz Ceramic Duplexer

## Part Number: AM1585-1230D1134

**ANATECH ELECTRONICS INC**  
RF & Microwave Filters & Products



### Response Plots:

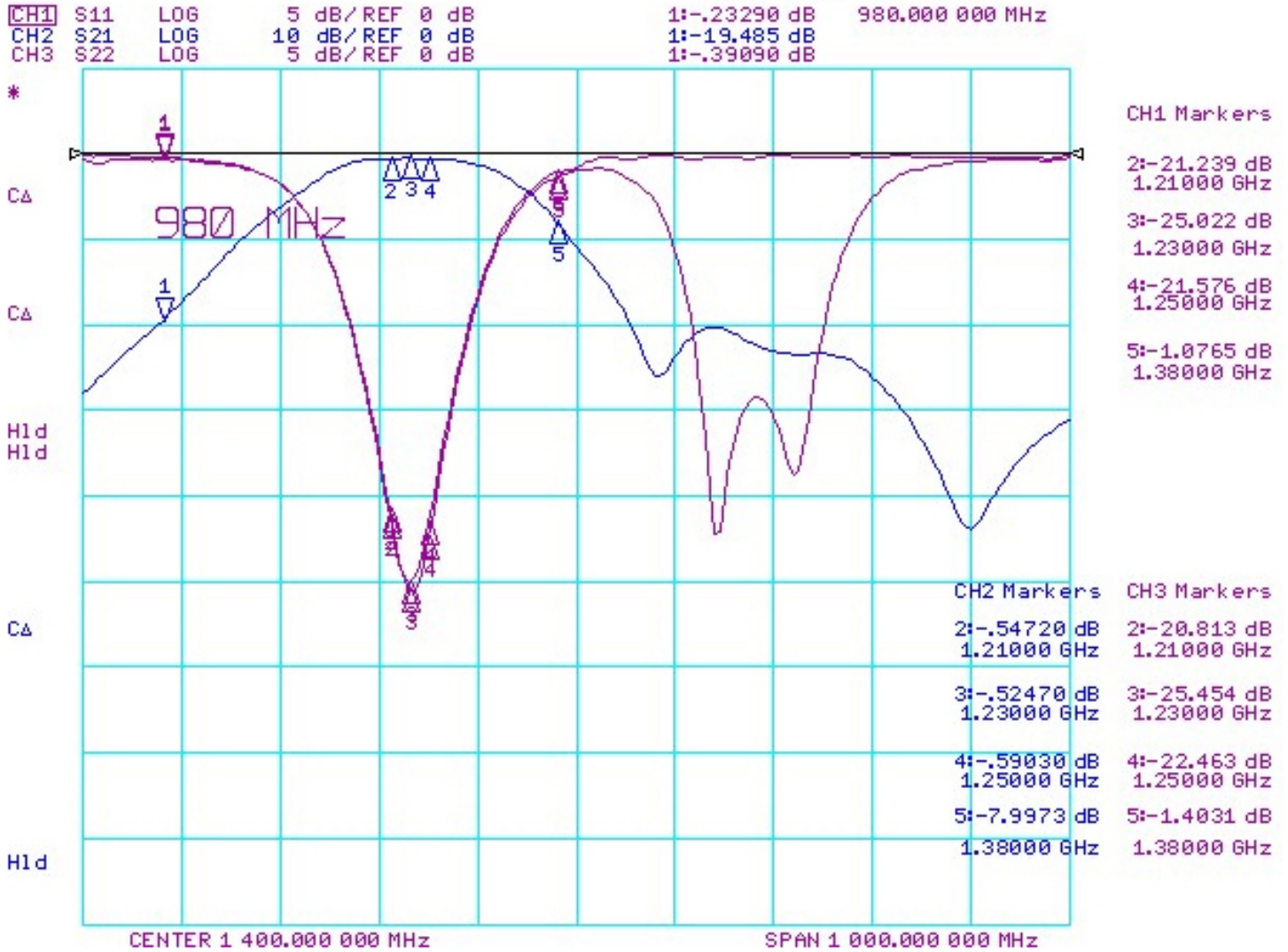



# 1230 MHz / 1585 MHz Ceramic Duplexer

## Part Number: AM1585-1230D1134

**ANATECH ELECTRONICS INC**  
RF & Microwave Filters & Products



### Response Plots:

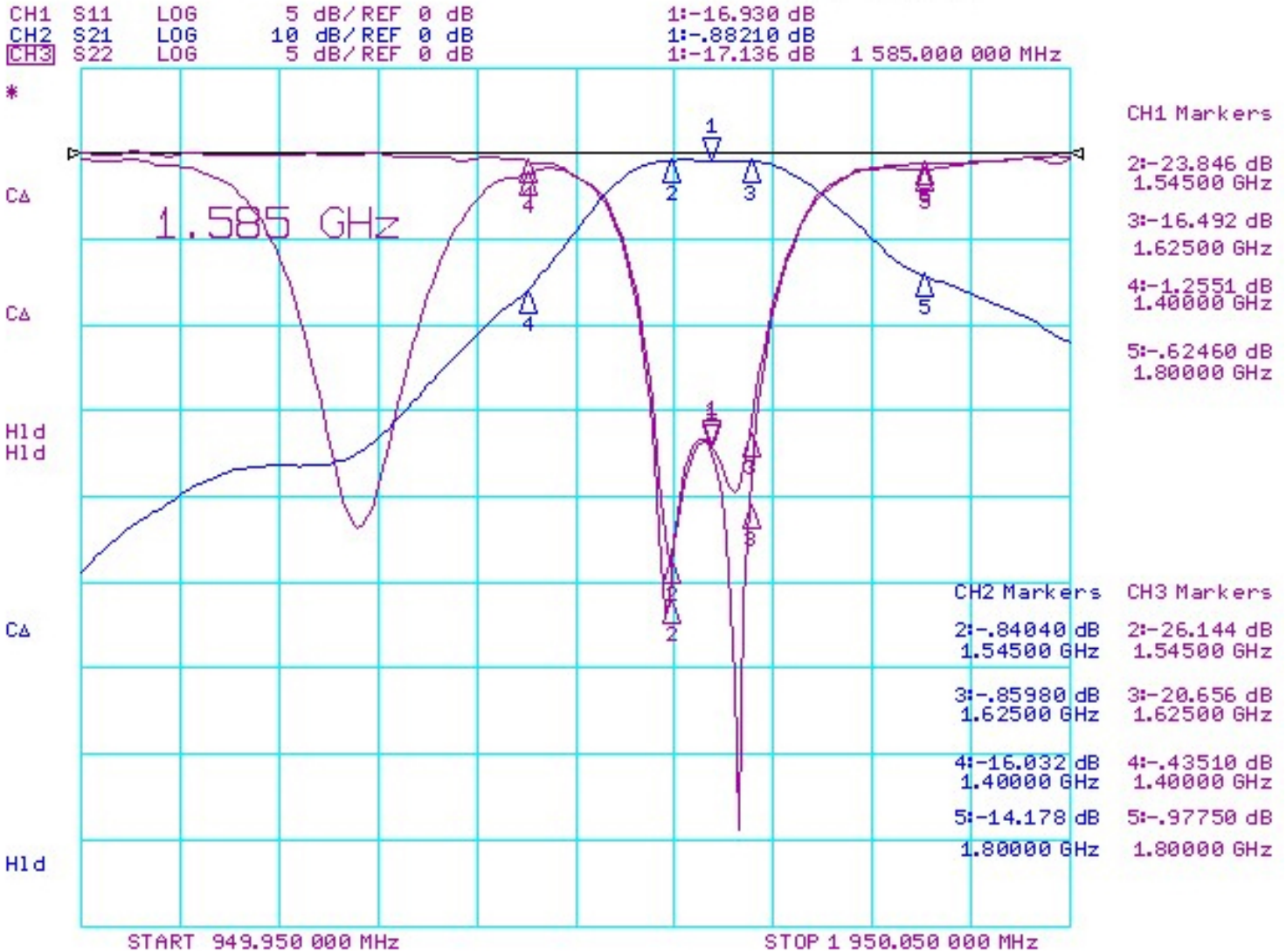



# 1230 MHz / 1585 MHz Ceramic Duplexer

## Part Number: AM1585-1230D1134

**ANATECH ELECTRONICS INC**  
RF & Microwave Filters & Products



### Response Plots:

