

F

E

D

C

B

A

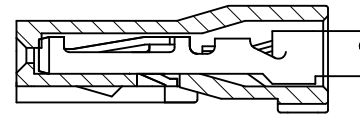
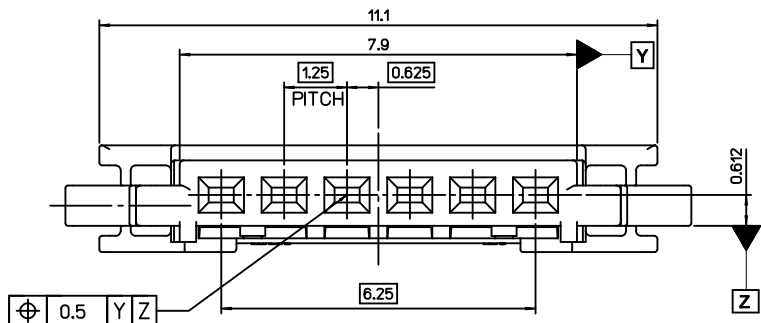

TERMINAL ASSEMBLY DRAWING
[REFERANCE]

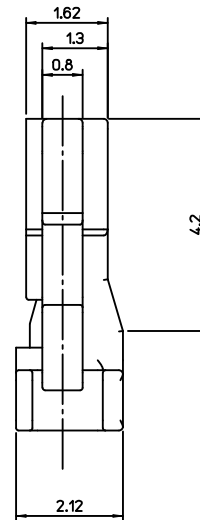
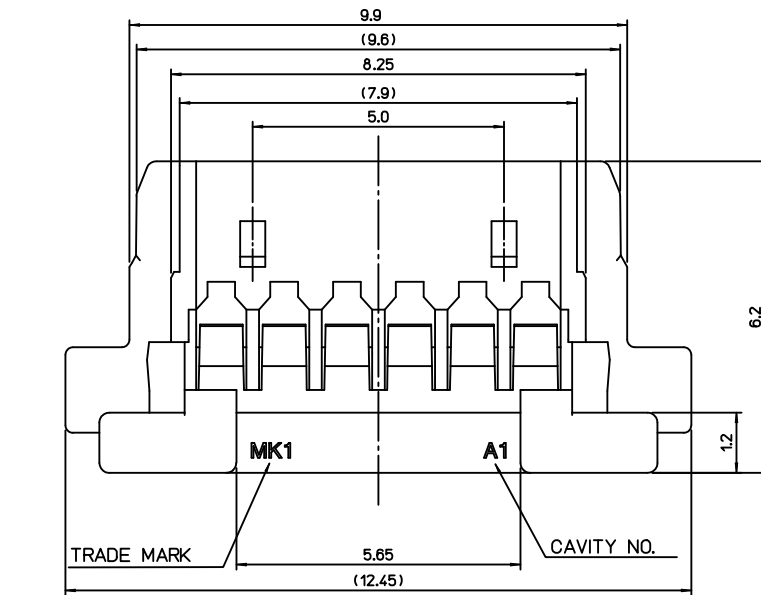
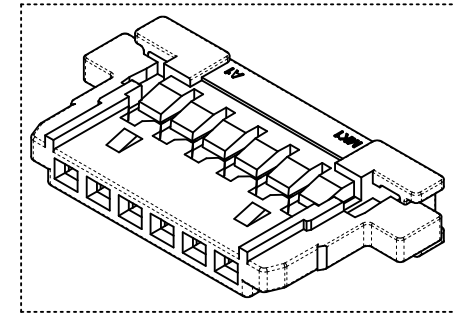

NOTES

1. MATED WITH : 104078-0610
2. MATERIALS
LIQUID CRYSTALPOLYMER (LCP,E130I)
GLASS FILLED,UL94V-0, NATURAL COLOR
3. APPLICABLE TERMINAL : 104505-8003

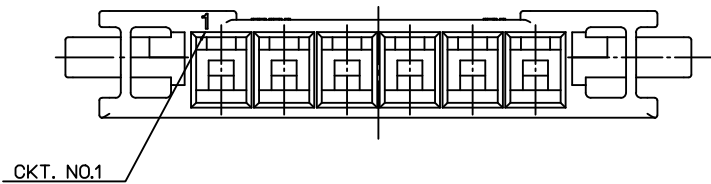

CKT. NO.1

NEW RELEASED
EC NO: KOR2011-0057
DRWN:CBCHIN 2010/12/02
CHKD:SH. CHU 2010/12/02
APPR:YUNSIKKIM 2010/12/02

QUALITY SYMBOLS	DESCRIPTION
▽=0	
▽=0	

GENERAL TOLERANCES (UNLESS SPECIFIED)	
	mm INCH
4 PLACES	± --- ± ---
3 PLACES	± 0.15 ± ---
2 PLACES	± 0.20 ± ---
1 PLACE	± 0.25 ± ---
ANGULAR ± 1 °	
DRAFT WHERE APPLICABLE MUST REMAIN WITHIN DIMENSIONS	

DIMENSION STYLE	
MM ONLY	
DRAWN BY	DATE
JB. JIN	2010/06/29
CHECKED BY	DATE
SH. CHU	2010/06/29
APPROVED BY	DATE
YSOO. KIM	2010/06/29
MATERIAL NO.	
1040770610	
SIZE	
A3	

SCALE	10:1
DESIGN UNITS	METRIC
TITLE	

ORDER NUMBER	104077-0610
THIRD ANGLE PROJECTION	
1.25 W-T-B CONN. HOUSING-6P JIG TYPE	
MOLEX INCORPORATED	
DOCUMENT NO.	SD-104077-002
SHEET NO.	1 OF 01