

PART NUMBER	REV	FIRST USED
680441-3	C	356462-1

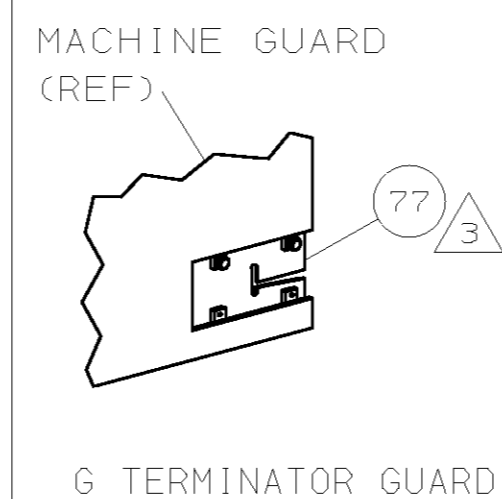

TERMINAL NAME: AMPLIVAR™ THRU SPLICE		41900			
PAD LTR	CRIMP HEIGHT	WIRE SIZE			
A	.086 ±.002 [2.18 ±0.05mm]	△			
B	NOT	USED			
C	NOT	USED			
D	NOT	USED			
CRIMP	SIZE	TYPE	RANGE		
WIRE	.140 [3.56mm]	F	6000 CMA		
INSUL	-	-	-		
WIRE STRIP LENGTH	TERM APPL SPEC	FEED	APPL INSTRUCTION	SET UP GAGE	LAYOUT
.234-.281	114-2009	.270	408-8039	458638-1	L1901

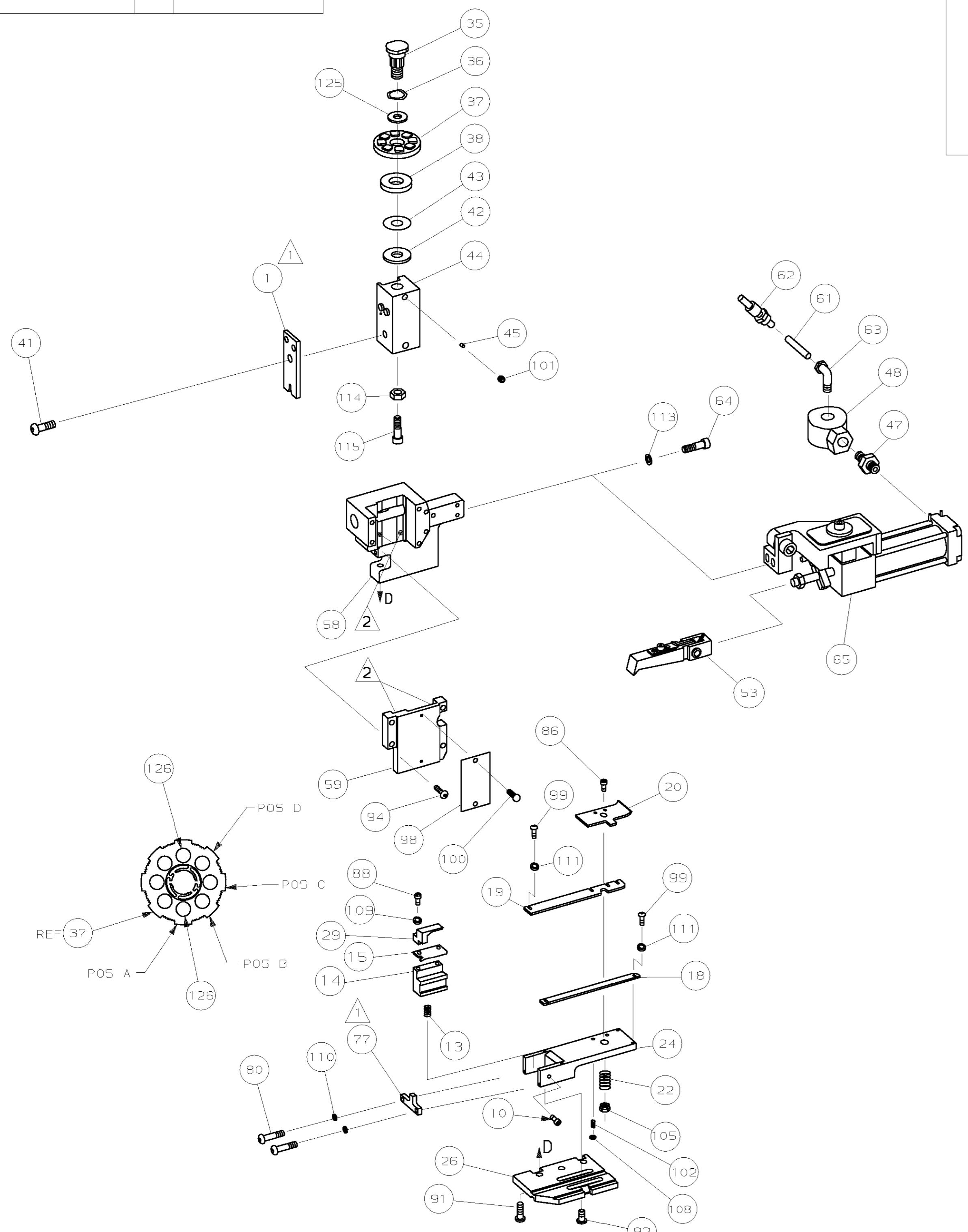

- △ 1 RECOMMENDED SPARE PARTS.
- △ 2 GREASE LIGHTLY.
- △ 3 GUARD MUST BE IN PLACE WHEN OPERATING APPLICATOR IN A BENCH MACHINE.
- △ 4 SEE DRAWING FOR COMPONENTS
- △ 5 (1) 1.5mm² STR & (1) 1.5mm² MAG

QTY	REV	U/M	DWG SIZE	PART NO	DESCRIPTION	ITEM NO
1	-	-	-	21001-7	SCR, SHC (1/4-20x1.25) DRAG	129
1	-	-	-	21001-7	SCR, SHC (1/4-20x1.25) DRAG	128
1	-	-	-	21001-7	SCR, SHC (1/4-20x1.25) DRAG	127
2	-	-	-	5-354778-7	PIN, WIRE DISC (.2780)A	126
1	-	-	-	986950-1	WASHER, FLAT PRECISION	125
1	-	-	-	217238-1	GENERAL INSTRUCTION PACKAGE	124
1	-	-	-	4088039	EF APPL INST 408-8039	123
1	-	-	-			122
1	-	-	-			121
1	-	-	-			120
1	-	-	-			119
1	-	-	-			118
1	-	-	-			117
1	-	-	-			116
1	-	-	-	21001-7	SCR, SHC (1/4-20x1.25) RAM	115
1	-	-	-	21019-1	NUT, HEX (1/4-20) RAM	114
2	-	-	-	21024-5	WASHER, LOCK (#10) AIR ASSY	113
1	-	-	-			112
4	-	-	-	21899-2	WASHER, FLAT (NO 6) STRIP GUIDE	111
4	-	-	-	21024-4	WASHER, LOCK (NO.8) SHEAR BL	110
2	-	-	-	21024-3	WASHER, LOCK (NO. 6)	109
2	-	-	-	21018-6	NUT, HEX (8-32) DRAG	108
1	-	-	-			107
1	-	-	-			106
1	-	-	-	21022-4	NUT, HEX SL (1/4-20) DRAG	105
1	-	-	-			104
1	-	-	-			103
2	-	-	-	5-21061-5	SCR, SKT SET CONE PT (8-32x.88)	102
1	-	-	-	21009-2	SCR, SKT SET (1/4-20x.25)RAM	101
2	-	-	-	21017-2	SCR, DRIVE (#2x.19) ID PLATE	100
4	-	-	-	1-21002-7	SCR, BHC (6-32x.38)	99
1	-	-	-	461264-1	PLATE, IDENTIFICATION	98
1	-	-	-			97
1	-	-	-			96
1	-	-	-			95
4	-	-	-	2-21002-9	SCR, BHC (10-32x.75) CAP	94
1	-	-	-	22733-8	SCR, BHC (8-32x.38 LW) ANVIL	93
4	-	-	-	3-21002-3	SCR, BHC (1/4-20x.50) ST GD PL	92
3	-	-	-	2-22733-8	SCR, BHC (1/4-20x.62) H5G	91
1	-	-	-			90
1	-	-	-			89
2	-	-	-	2-21000-0	SCR, SHC (6-32x.50) STR & SHEAR	88
1	-	-	-			87
1	-	-	-	21001-7	SCR, SHC (1/4-20x1.25) DRAG	86
1	-	-	-			85
1	-	-	-			84
1	-	-	-			83
1	-	-	-			82
1	-	-	-			81
2	-	-	-	2-21000-7	SCR, SHC (8-32x.50) ANVIL	80
1	-	-	-			79
1	-	-	-			78
1	-	-	-	1213015-1	GUARD ASSEMBLY	77
1	-	-	-			76
1	-	-	-			75
1	-	-	-			74
1	-	-	-			73
1	-	-	-			72
1	-	-	-			71
QTY	REV	U/M	DWG SIZE	PART NO	DESCRIPTION	ITEM NO
-3	-	-	-			

QTY	REV	U/M	DWG SIZE	PART NO	DESCRIPTION	ITEM NO
1	-	-	-	460277-1	AIR FEED ASSY (1 INCH)	70
1	-	-	-	3-21000-9	SCR, SHC (10-32x1.00) AIR ASSY	69
1	-	-	-	983427-6	ELBOW, SWIVEL 1/8 NPT - 1/4 T	68
1	-	-	-	23238-1	QUICK DISCONNECT	67
12.00	IN	A		27319-4	TUBING, POLY-FLO Ø.25	66
1	-	-	-			65
1	-	-	-	458408-1	CAP, RAM	60
1	-	-	-	458414-1	HOUSING	59
1	-	-	-			58
1	-	-	-			57
1	-	-	-			56
1	-	-	-			55
1	-	-	-			54
1	-	-	-	460680-1	FEED FINGER ASSY	53
1	-	-	-			52
1	-	-	-			51
1	-	-	-			50
1	-	-	-			49
1	-	-	-	22374-7	VALVE, QUICK EXHAUST	48
1	-	-	-	22304-1	NIPPLE, HEX 1/8 NPT	47
1	-	-	-			46
1	-	-	-	690191-1	PLUG, NYLON	45
1	-	-	-	458413-2	RAM	44
1	-	-	-	690125-1	WASHER, LAMINATED	43
1	-	-	-	690124-1	WASHER, RAM	42
1	-	-	-	7-21002-9	BOLT, CRIMPER (5/16-24x1.00)	41
1	-	-	-			40
1	-	-	-			39
1	-	-	-	690223-2	SPACER, INSULATION DISC	38
1	-	-	-	354777-1	WIRE DISC, PLASTIC	37
1	-	-	-	22480-5	WASHER, SPRING	36
1	-	-	-	690212-1	POST, RAM	35
1	-	-	-			34
1	-	-	-			33
1	-	-	-			32
1	-	-	-			31
1	-	-	-			30
1	-	-	-	458405-1	STRIPPER, REAR	29
1	-	-	-			28
1	-	-	-			27
1	-	-	-	458411-1	PLATE, BASE	26
1	-	-	-			25
1	-	-	-	458412-1	PLATE, STRIP GUIDE	24
1	-	-	-			23
1	-	-	-	2-22283-9	SPRING, DRAG	22
1	-	-	-			21
1	-	-	-	458403-1	DRAG, STOCK	20
1	-	-	-	458406-1	GUIDE, STRIP (REAR)	19
1	-	-	-	458404-1	GUIDE, STRIP (FRONT)	18
1	-	-	-			17
1	-	-	-			16
1	-	-	-	458410-4	SHEAR	15
1	-	-	-	458409-6	HOLDER, SHEAR	14
1	-	-	-	6-22282-8	SPRING, SHEAR RETURN	13
1	-	-	-			12
1	-	-	-			11
1	-	-	-	690461-4	SCREW, SHEAR STOP	10
1	-	-	-			9
1	-	-	-	462320-2	ANVIL	8
1	-	-	-			7
1	-	-	-			6
1	-	-	-			5
1	-	-	-			4
1	-	-	-			3
1	-	-	-			2
1	-	-	-	1-456411-7	CRIMPER, WIRE	1
QTY	REV	U/M	DWG SIZE	PART NO	DESCRIPTION	ITEM NO
-3	-	-	-			

THIS DRAWING IS A CONTROLLED DOCUMENT.

THIS DRAWING IS UNCLASSIFIED - RELEASED FOR PUBLICATION - FEBRUARY 2000 - BY AMP INCORPORATED. ALL RIGHTS RESERVED.

LOC A
DIST 66

REVISION OF EACH ASSY NO (WHEN BLANK, USE DWG REVISION)

QTY	REV	U/M	DWG SIZE	PART NO	DESCRIPTION	ITEM NO
-3	-	-	-			

REVISION RECORD

REV	DATE	DESCRIPTION
C	0150-0127-00	TE FEB00
B	0150-8182-97	TB 12-97
A	RELEASED	CE 7-97

DIMENSIONS IN INCHES. DO NOT SCALE PRINT. TOLERANCES UNLESS OTHERWISE SPECIFIED:
 2 PLC DEC ±.25
 3 PLC DEC ±.
 4 PLC DEC ±.
 REMOVE BURRS, BREAK SHARP EDGES R.015 MAX

DR 3-25-97 APP 3-25-97
 P.MCCARTY T.ELBIN
 CHK 3-25-97 REL -
 C.ERISMAN

AMP AMP Incorporated
 Harrisburg, PA 17105-3608

NAME: END FEED HDM APPLICATOR MACHINE REF: MINI APPL
 SCALE: 1 OF 1 SHEET: 1 OF 1 REV: C

CAGE CODE: 00779 CUSTOMER AND ASSEMBLY DRAWING 1 RESTRICTED TO