

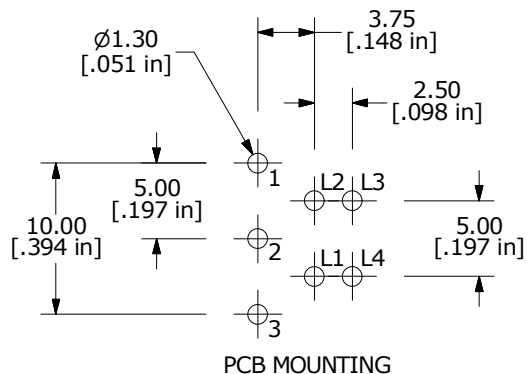

**SWITCH SCHEMATIC**  
(MOMENTARY)

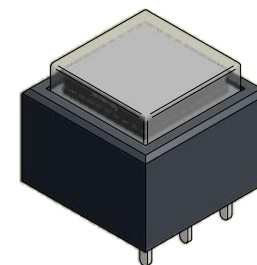

**PCB MOUNTING**

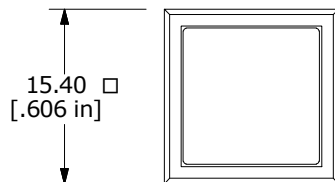
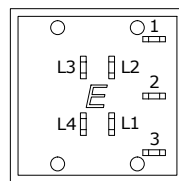
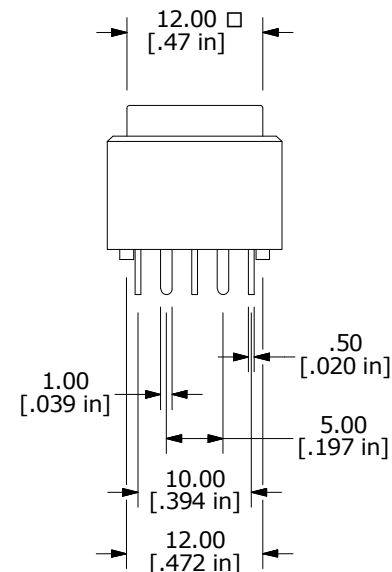
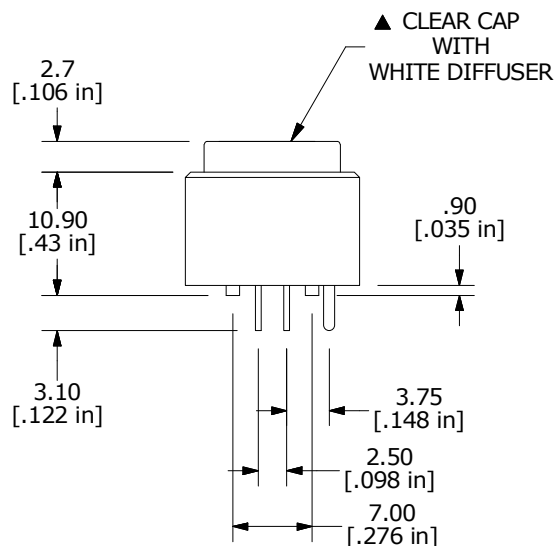

**NOTES:**

1. ALL DIMENSIONS IN MM
2. GENERAL TOLERANCE: X.X = ±0.4  
X.XX = ±0.25
3. TERM. NOS. FOR REFERENCE ONLY.
4. CONTACT RATING: 0.1A Max. @ 28VDC
- ▲ 5. CONTACT MATERIAL: GOLD
6. ELECTRICAL LIFE: 200,000 Typical
7. MECHANICAL LIFE: 1,000,000 CYCLES TYP.
8. OPERATING TEMP: -40°C to +85°C
9. OPERATING FORCE: 200 ± 100 gf
10. CONTACT RESISTANCE: 100 MILLI-OHM INITIAL TYP. MAX.
11. DIELECTRIC STRENGTH: 1000 VAC FOR 1 MINUTE
12. TRAVEL TO MAKE: 2.20mm ± 0.2
13. 2011/65/EU (ROHS) COMPLIANT
14. ▲ DENOTES CRITICAL PARAMETER
- ▲ 15. LED COLOR: RED: 1 CHIP, 2.1-2.5 VDC@20mA  
GRN: 1 CHIP, 3.2-4.0 VDC@20mA  
BLU: 1 CHIP, 3.1-3.8 VDC@20mA

C	22858	update Note 15	5/23/17	MW
B	22350	SHOW "E" ON BOTTOM VIEW	6/16/16	MW
A	21185	RELEASED FOR PRODUCTION	8/1/13	EBP
REV	PCR NO	DESCRIPTION	DATE	BY

THE INFORMATION CONTAINED IN THIS DOCUMENT IS PROPRIETARY TO E-SWITCH AND IS NOT TO BE COPIED OR TRANSFERRED



TITLE <b>ULP12OAP1RSFCL1RGB</b>				
SCALE	DATE	DR	DWG	REV
3:2	8/1/2013	EBP	B800064	C