

REVISIONS				
EC NO	DATE	REV	DESCRIPTION	CHANGER
NA	2015/11/23	A	INITIAL RELEASE	LUCY
CY16-5179	2016/03/19	B	UPDATE FLEXING TEST REQUIREMENT	LUCY
CY16-5923	2016/07/08	C	ADD MOLEX LOGO ON OUTER MOLD	LUCY

P1

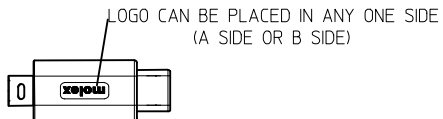
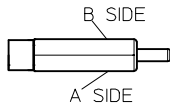
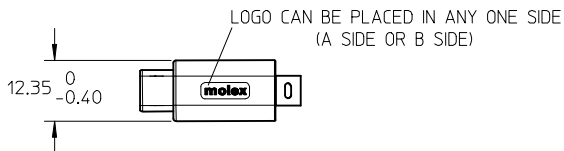
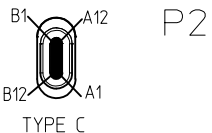
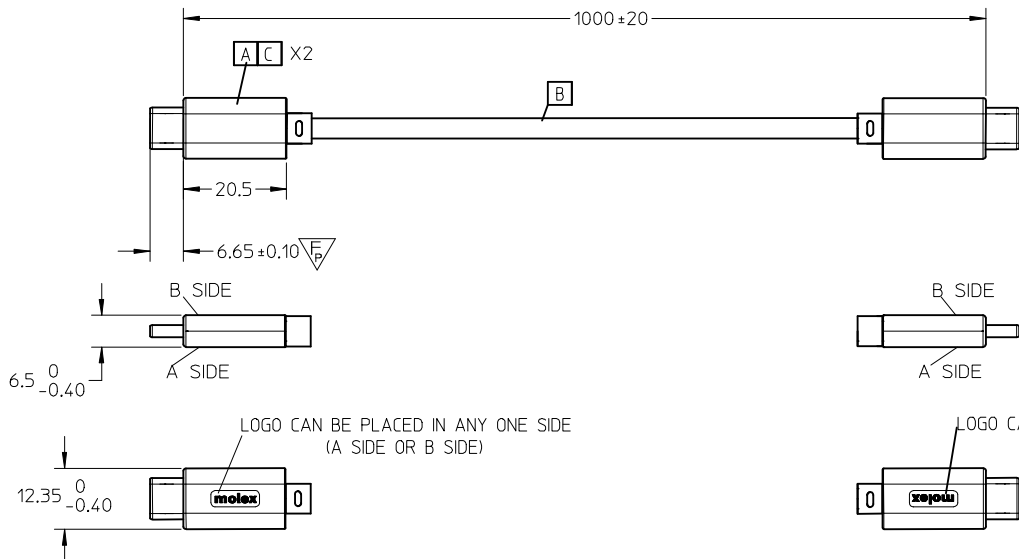
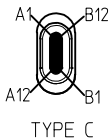

PIN ASSIGNMENTS				
Type C(P1)	SIGNAL NAME	WIRE COLOR	SIGNAL NAME	Type C(P2)
A1,B1,A12,B12	GND	BLACK	GND	A1,B1,A12,B12
A4,B4,A9,B9	VBUS	RED	VBUS	A4,B4,A9,B9
A5	CC	BLUE	CC	A5
B5	VCONN	-	VCONN	B5
A6	Dp1	GREEN	Dp1	A6
A7	Dn1	WHITE	Dn1	A7
SHELL	SHIELD	BRAID	SHIELD	SHELL

TABLE

3A, 500mV/Vbus, 250mV/GND
CURRENT/DROP VOLTAGE

C	extended tube back metal shell	2
B	(1P+1C)X28+4CX26;SHD,PVC,BK;4.2MM,UL2725	AR
A	PCBA,USB Type C to Type C, 2.0,3A	2
ITEM	DESCRIPTION	QTY.

ENTER DESCRIPTION EC NO: CPG2017-0065 DRWN:ZDG001 2016/07/14 CHKD:LUCY 2016/07/14 APPR:FNIE 2016/07/16	QUALITY SYMBOLS $\nabla_A=0$ $\nabla_G=0$ $\nabla_P=1$	GENERAL TOLERANCES (UNLESS SPECIFIED)		DIMENSION STYLE MM ONLY		SCALE ---	DESIGN UNITS METRIC	THIRD ANGLE PROJECTION	
		4 PLACES ± --- ± --- 3 PLACES ± --- ± --- 2 PLACES ± 0.25 ± --- 1 PLACE ± 0.5 ± --- 0 PLACE ± --- ± ---		DRAWN BY XJGU001	DATE 2015/12/03	TITLE USB TYPE C TO C 2.0, L=1M, 3A			
		ANGULAR ± --- °		CHECKED BY LUCY	DATE 2015/12/03	APPROVED BY FNIE 2015/12/04			
		DRAFT WHERE APPLICABLE MUST REMAIN WITHIN DIMENSIONS		MATERIAL NO. 687980002	DATE 2015/12/04				
SIZE A3		THIS DRAWING CONTAINS INFORMATION THAT IS PROPRIETARY TO MOLEX INCORPORATED AND SHOULD NOT BE USED WITHOUT WRITTEN PERMISSION				DOCUMENT NO. SD-68798-001	SHEET NO. 1 OF 2		

NOTE:

1. OVERMOLDING SPECIFICATION:

1.1 INNER MOLDING: PE RESIN

1.2 OUTER MOLDING: PVC BLACK RESIN

2. APPLICATION CONDITION

2.1 WORKING TEMPERATURE: -10°--- +50°

2.2 STORAGE TEMPERATURE: -20°--- +60°

3. MECHANICAL PERFORMACNE

3.1. CABLE ASSEMBLY CAN PASS FLEXING TEST, PER EIA364-41 CONDITION I WITH DIMENSION X=3.7 TIMES THE CABLE DIAMETER AND 100 CYCLES IN EACH OF TWO PLANES 120 DEGREE ARC.

3.2. CABLE SHOULD WITHSTAND A PULL FORCE 40N FOR ONE

MINUTE WITHOUT VISIBLE TERMINATION DAMAGE.PER EIA 364-38 METHOD A

3.3 CABLE SHOULD MEET 3.8.1.6 4-AXIS CONTINUITY TEST OF TYPE C STANDARD

4. ELECTRICAL PERFORMACNE

4.1 100% OPEN AND SHORT TEST

4.2 OTHER ELECTRICAL PERFORMANCE MEET USB TYPE C - TYPE C, USB 2.0

4.3 CURRENT RATING: SEE TABLE

5. THIS PRODUCT MUST MEET Molex QEHS-699000-301

6. PRODUCT SPECIFICATION PS-68798-0004

ENTER DESCRIPTION EC NO: CPG2017-0065 DRWN:ZDGG001 CHKD:LUCY APPR:FNIE	DESCRIPTION REV	QUALITY SYMBOLS	GENERAL TOLERANCES (UNLESS SPECIFIED)		DIMENSION STYLE MM ONLY		SCALE ---	DESIGN UNITS METRIC	THIRD ANGLE PROJECTION		
		$F_A=0$	mm	INCH	DRAWN BY	DATE	TITLE				
		$F_C=0$	4 PLACES ± --- ± ---		XJGU001	2015/12/03	USB TYPE C TO C 2.0, L=1M, 3A				
		$F_P=0$	3 PLACES ± --- ± ---		CHECKED BY	DATE	molex				
	2 PLACES ± 0.25 ± ---		LUCY	2015/12/03							
		1 PLACE ± 0.5 ± ---		APPROVED BY	DATE	DOCUMENT NO.					
		0 PLACE ± --- ± ---		FNIE	2015/12/04	SD-68798-001					
			ANGULAR ± --- °		MATERIAL NO.		SHEET NO.				
			DRAFT WHERE APPLICABLE MUST REMAIN WITHIN DIMENSIONS		687980002		2 OF 2				
					SIZE A3	THIS DRAWING CONTAINS INFORMATION THAT IS PROPRIETARY TO MOLEX INCORPORATED AND SHOULD NOT BE USED WITHOUT WRITTEN PERMISSION					

REVISIONS				
EC NO	DATE	REV	DESCRIPTION	CHANGER
NA	2015/11/23	A	INITIAL RELEASE	LUCY
CY16-5179	2016/03/19	B	UPDATE FLEXING TEST REQUIREMENT	LUCY
CY16-5923	2016/07/08	C	ADD MOLEX LOGO ON OUTER MOLD	LUCY

P1

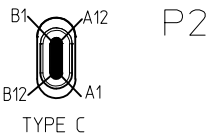
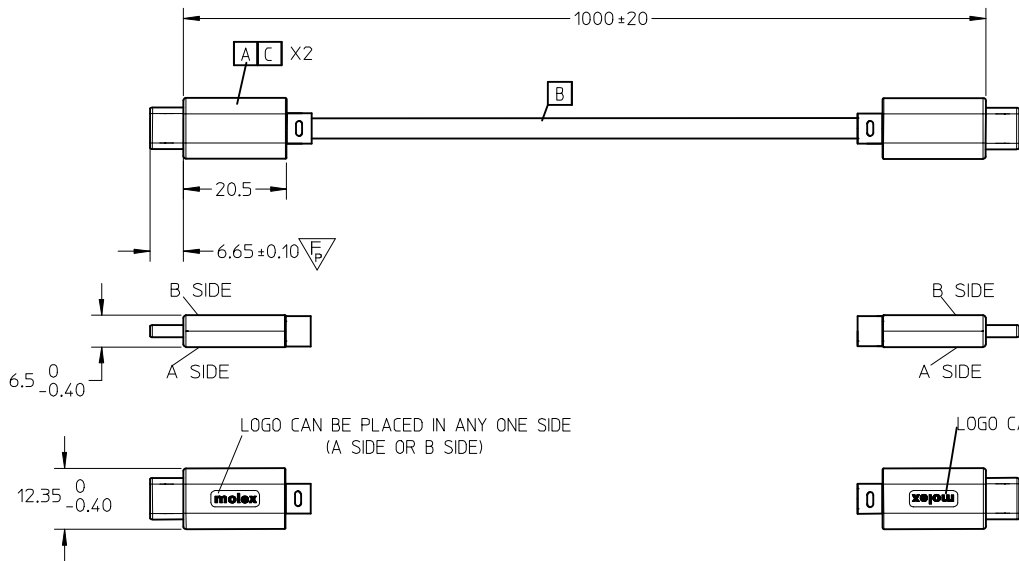
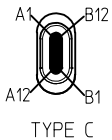

PIN ASSIGNMENTS				
Type C(P1)	SIGNAL NAME	WIRE COLOR	SIGNAL NAME	Type C(P2)
A1,B1,A12,B12	GND	BLACK	GND	A1,B1,A12,B12
A4,B4,A9,B9	VBUS	RED	VBUS	A4,B4,A9,B9
A5	CC	BLUE	CC	A5
B5	VCONN	-	VCONN	B5
A6	Dp1	GREEN	Dp1	A6
A7	Dn1	WHITE	Dn1	A7
SHELL	SHIELD	BRAID	SHIELD	SHELL

TABLE

3A, 500mV/Vbus, 250mV/GND
CURRENT/DROP VOLTAGE

C	extended tube back metal shell	2
B	(1P+1C)X28+4CX26;SHD;PVC;BK;4.2MM;UL2725	AR
A	PCBA,USB Type C to Type C, 2.0,3A	2
ITEM	DESCRIPTION	QTY.

ENTER DESCRIPTION EC NO: CPG2017-0065 DRWN:ZDG001 2016/07/14 CHKD:LUCY 2016/07/14 APPR:FNIE 2016/07/16	QUALITY SYMBOLS $F_A=0$ $F_G=0$ $F_P=1$	GENERAL TOLERANCES (UNLESS SPECIFIED)		DIMENSION STYLE MM ONLY		SCALE ---	DESIGN UNITS METRIC	THIRD ANGLE PROJECTION
		4 PLACES ± --- ± --- 3 PLACES ± --- ± --- 2 PLACES ± 0.25 ± --- 1 PLACE ± 0.5 ± --- 0 PLACE ± --- ± ---	mm INCH DRAWN BY XJGU001 DATE 2015/12/03	TITLE USB TYPE C TO C 2.0, L=1M, 3A				
		ANGULAR ± --- ° DRAFT WHERE APPLICABLE MUST REMAIN WITHIN DIMENSIONS	CHECKED BY LUCY DATE 2015/12/03	APPROVED BY FNIE DATE 2015/12/04				
		MATERIAL NO. 687980002	DOCUMENT NO. SD-68798-001		SHEET NO. 1 OF 2			

NOTE:

1. OVERMOLDING SPECIFICATION:

- 1.1 INNER MOLDING: PE RESIN
- 1.2 OUTER MOLDING: PVC BLACK RESIN

2. APPLICATION CONDITION

- 2.1 WORKING TEMPERATURE: -10°--- +50°
- 2.2 STORAGE TEMPERATURE: -20°--- +60°

3. MECHANICAL PERFORMACNE

- 3.1. CABLE ASSEMBLY CAN PASS FLEXING TEST, PER EIA364-41 CONDITION I WITH DIMENSION X=3.7 TIMES THE CABLE DIAMETER AND 100 CYCLES IN EACH OF TWO PLANES 120 DEGREE ARC.
- 3.2. CABLE SHOULD WITHSTAND A PULL FORCE 40N FOR ONE MINUTE WITHOUT VISIBLE TERMINATION DAMAGE.PER EIA 364-38 METHOD A
- 3.3 CABLE SHOULD MEET 3.8.1.6 4-AXIS CONTINUITY TEST OF TYPE C STANDARD

4. ELECTRICAL PERFORMACNE

- 4.1 100% OPEN AND SHORT TEST
- 4.2 OTHER ELECTRICAL PERFORMANCE MEET USB TYPE C - TYPE C, USB 2.0
- 4.3 CURRENT RATING: SEE TABLE

5. THIS PRODUCT MUST MEET Molex QEHS-699000-301

6. PRODUCT SPECIFICATION PS-68798-0004

ENTER DESCRIPTION EC NO: CPG2017-0065 DRWN:ZDGG001 CHKD:LUCY APPR:FNIE	2016/07/14 2016/07/14 2016/07/16	DESCRIPTION REV	QUALITY SYMBOLS	GENERAL TOLERANCES (UNLESS SPECIFIED)	DIMENSION STYLE	SCALE	DESIGN UNITS	THIRD ANGLE PROJECTION
	$\nabla_A=0$ $\nabla_C=0$ $\nabla_P=0$		mm INCH 4 PLACES ± --- ± --- 3 PLACES ± --- ± --- 2 PLACES ± 0.25 ± --- 1 PLACE ± 0.5 ± --- 0 PLACE ± --- ± ---	MM ONLY	---	METRIC	DRAWN BY: XJGU001 DATE: 2015/12/03 CHECKED BY: LUCY DATE: 2015/12/03 APPROVED BY: FNIE DATE: 2015/12/04	TITLE: USB TYPE C TO C 2.0, L=1M, 3A
	ANGULAR ± --- ° DRAFT WHERE APPLICABLE MUST REMAIN WITHIN DIMENSIONS		MATERIAL NO. 687980002 DOCUMENT NO. SD-68798-001	SHEET NO. 2 OF 2				
	C				SIZE A3	THIS DRAWING CONTAINS INFORMATION THAT IS PROPRIETARY TO MOLEX INCORPORATED AND SHOULD NOT BE USED WITHOUT WRITTEN PERMISSION		

