

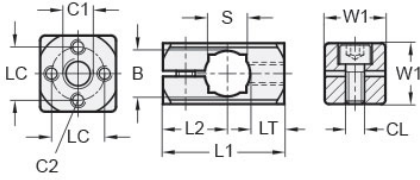

MT15-CSBC-M8-A

Ruland Sensor Bracket Clamp Connector, Thru Hole 15mm, Thread M8, L 40mm, Aluminum



Description

Ruland MT15-CSBC-M8-A is a sensor bracket clamp connector with a 15mm thru hole diameter, M8 center thread, M4 cross threads, 20mm width/height, and 40mm overall length. It is made with aluminum and has stainless steel cap screws. These clamp connectors are designed to fit with sensor brackets and mounting brackets with the same threading. Adjustable lever clamp kits with the same thread size can be attached to this clamp connector. The width/height of the bracket clamp must also be equal to the sleeve and stud length of the adjustable lever clamp kit. All bracket clamps from Ruland are RoHS3 and REACH compliant.

Product Specifications

Thru Hole Diameter B	15 mm	Thru Hole Tolerance	+0.11/-0 mm
Square Thru Hole S	12 mm	Center Thread C1	M8
Cross Thread C2	M4 x 4	Thread Depth LT	12 mm
Center To Center LC	14 mm	Edge To Center L2	20.5 mm
Width & Height W1	20 mm	Overall Length L1	40 mm
Clamp Screw CL	M6	Weight (lbs)	0.068300
Material Specification	Aluminum	Manufacturer	JW Winco/ Otto Ganter
UPC	634529245750	Country of Origin	Germany
Tariff Code	7609.00.0000	UNSPC	31162908