

- NOTES:
1. DIAMETER DIMENSION SHOWN FOR REFERENCE ONLY.
 2. CABLE HAS RODENT PROTECTION.
 3. FOR PART NUMBERS AND LENGTHS OTHER THAN THOSE SHOWN, CONTACT YOUR PANDUIT SALES PERSON.

TEMPERATURE		
STORAGE	OPERATION	INSTALLATION
-40° C TO 70° C		

00	02-05-14	SAT	WMA	TCB	RELEASED TO PRODUCTION			M02432CT-DS				
REV	DATE	BY	CHK	APR	DESCRIPTION			ECN				

TITLE				
SINGLE ARMOR SINGLE JACKET (SASJ) CENTRAL TUBE FIBER OPTIC CABLE				
CUSTOMER DRAWING				
ITEM REVISION NAME				PANDUIT
M02432CT/00				
DATASET FILE NAME				
M02432CT_DC/00A				PART NO.
UNLESS OTHERWISE SPECIFIED, DIMENSIONAL TOLERANCES ARE: IN (mm)				SEE TABLE
.x ±		.xxx ± .010 (0.3)		DRAWING NUMBER: M02432CT-DS
.xx ± .03 (0.8)		ANGLES ±		
		THIRD ANGLE PROJECTION		
DRAWN BY	DATE	CHK	SCALE	SIZE
SAT	02-05-14	WMA	NONE	SHT 1 OF 2 A

THIS COPY IS PROVIDED ON A RESTRICTED BASIS AND IS NOT TO BE USED IN ANY WAY DETRIMENTAL TO THE INTERESTS OF PANDUIT CORP.

PANDUIT P/N	DESCRIPTION	FIBER COUNT	DIAMETER "A"	DIAMETER "B"	TENSILE LOAD (INSTALLATION)	TENSILE LOAD (LONG TERM)	BEND RADIUS (INSTALLATION)	BEND RADIUS (LONG TERM)	COMPRESSIVE STRENGTH	ATTENUATION						
FPSN604	MULTIMODE 62.5/125 OM1 CENTRAL TUBE SINGLE ARMOR SINGLE JACKET OUTSIDE PLANT CABLE	4	8.5mm	2.8mm	1000 N	500 N	55mm	110mm	2000 N	3.5dB/km @ 850nm 1.0dB/km @ 1300nm						
FPSN606		6														
FPSN608		8														
FPSN612		12														
FPSN624		24														
FPSN504	MULTIMODE 50/125 OM2 CENTRAL TUBE SINGLE ARMOR SINGLE JACKET OUTSIDE PLANT CABLE	4		2.8mm						3.5mm	1000 N	500 N	55mm	110mm	2000 N	3.5dB/km @ 850nm 1.5dB/km @ 1300nm
FPSN506		6														
FPSN508		8														
FPSN512		12														
FPSN524		24														
FQSNX04	MULTIMODE 50/125 OM3 CENTRAL TUBE SINGLE ARMOR SINGLE JACKET OUTSIDE PLANT CABLE	4		2.8mm						3.5mm	1000 N	500 N	55mm	110mm	2000 N	3.0dB/km @ 850nm 1.0dB/km @ 1300nm
FQSNX06		6														
FQSNX08		8														
FQSNX12		12														
FQSNX24		24														
FQSNZ04	MULTIMODE 50/125 OM4 CENTRAL TUBE SINGLE ARMOR SINGLE JACKET OUTSIDE PLANT CABLE	4	2.8mm	3.5mm	1000 N	500 N	55mm	110mm	2000 N	3.0dB/km @ 850nm 1.0dB/km @ 1300nm						
FQSNZ06		6														
FQSNZ08		8														
FQSNZ12		12														
FQSNZ24		24														
FPSN904	SINGLEMODE 9/125 CENTRAL TUBE SINGLE ARMOR SINGLE JACKET OUTSIDE PLANT CABLE	4	2.8mm	3.5mm	1000 N	500 N	55mm	110mm	2000 N	0.4dB/km @ 1310nm 0.3dB/km @ 1550nm						
FPSN906		6														
FPSN908		8														
FPSN912		12														
FPSN924		24														

B

B

←

→

A

A

					TITLE SINGLE ARMOR SINGLE JACKET (SASJ) CENTRAL TUBE FIBER OPTIC CABLE CUSTOMER DRAWING							
					ITEM REVISION NAME M02432CT/00							
					DATASET FILE NAME M02432CT_DC/00A							
					UNLESS OTHERWISE SPECIFIED, DIMENSIONAL TOLERANCES ARE: IN (mm) .x ± .xxx ± .010 (0.3) .xx ± .03 (0.8) ANGLES ±							
					PART NO. SEE TABLE							
00 02-05-14 SAT WMA TCB RELEASED TO PRODUCTION					M02432CT-DS							
					DRAWING NUMBER: M02432CT-DS							
REV	DATE	BY	CHK	APR	DESCRIPTION	ECN	DRAWN BY SAT	DATE 02-05-14	CHK WMA	SCALE NONE	SHT 2 OF 2	SIZE A

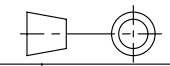

THIRD ANGLE PROJECTION