

92mm sq.

San Ace 92



General Specifications

- Material Frame: Plastics (Flammability: UL94V-0),
Impeller: Plastics (Flammability: UL94V-0)
- Expected Life Refer to specifications (L10:Survival rate:90% at 60°C ,
rated voltage, and continuously run in a free air state)
- Lead Wire ⊕red ⊖black (Sensor) yellow (Control) brown
- Storage Temperature -30°C to +70°C (Non-condensing)

92×92×25mm (Mass : 125g) **9GA** type **Low Power Consumption Fan**



Specifications

The following nos. **have PWM controls, pulse sensors, and ribs.** For ribless, append "1" to the model no.

| Model No. | Rated Voltage [V] | Operating Voltage Range [V] | PWM duty cycle※ [%] | Rated Current [A] | Rated Input [W] | Rated Speed [min ⁻¹] | Max. Airflow [m ³ /min] [CFM] | Max. Static Pressure [Pa] [inchH ₂ O] | SPL [dB(A)] | Operating Temperature [°C] | Expected Life [h] |
|--------------|-------------------|-----------------------------|---------------------|-------------------|-----------------|----------------------------------|--|--|-------------|----------------------------|-------------------|
| 9GA0912P4J03 | 12 | 10.2 to 13.8 | 100 | 0.39 | 4.68 | 5,000 | 2.20 77.7 | 105 0.42 | 43 | -20 to +70 | 60,000/60°C |
| | | | 0 | 0.06 | 0.72 | 1,500 | 0.66 23.3 | 9.5 0.04 | 14 | | |
| 9GA0912P4G03 | | | 100 | 0.28 | 3.36 | 4,400 | 1.93 68.2 | 81 0.33 | 39 | | |
| | | | 0 | 0.06 | 0.72 | 1,500 | 0.66 23.3 | 9.5 0.04 | 14 | | |
| 9GA0912P4S03 | | | 100 | 0.2 | 2.4 | 3,800 | 1.67 59.0 | 60.6 0.24 | 35 | | |
| | | | 0 | 0.06 | 0.72 | 1,500 | 0.66 23.3 | 9.5 0.04 | 14 | | |
| 9GA0924P4J03 | 24 | 20.4 to 27.6 | 100 | 0.2 | 4.80 | 5,000 | 2.20 77.7 | 105 0.42 | 43 | | |
| | | | 0 | 0.04 | 0.96 | 1,500 | 0.66 23.3 | 9.5 0.04 | 14 | | |
| 9GA0924P4G03 | | | 100 | 0.15 | 3.60 | 4,400 | 1.93 68.2 | 81 0.33 | 39 | | |
| | | | 0 | 0.04 | 0.96 | 1,500 | 0.66 23.3 | 9.5 0.04 | 14 | | |
| 9GA0924P4S03 | | | 100 | 0.12 | 2.88 | 3,800 | 1.67 59.0 | 60.6 0.24 | 35 | | |
| | | | 0 | 0.04 | 0.96 | 1,500 | 0.66 23.3 | 9.5 0.04 | 14 | | |

※PWM Frequency : 25kHz

Models without sensors or with pulse sensors (no PWM function) are available as options. Please refer to the index (p. 476).

Dimensions (unit: mm) (With ribs)

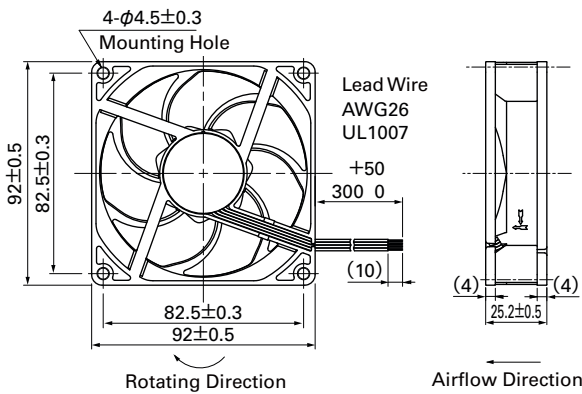

Reference Dimensions of Mounting Holes and Vent Opening (unit: mm)

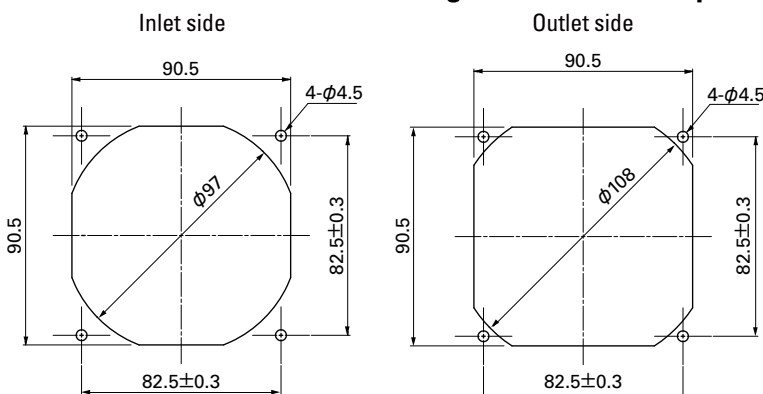

Options (unit: mm)

Finger Guards

Model : 109-099C Surface treatment : Nickel-chrome plating (silver) Color

Model : 109-099E Surface treatment : Nickel-chrome plating (silver) Color
: 109-099H : Cation electropainting (black)

Outlet side

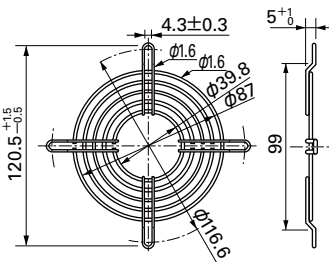

Mass : 22g

Inlet side, Outlet side

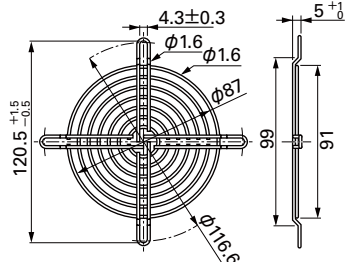

Mass : 29g

Resin Finger Guards

Model : 109-1001G

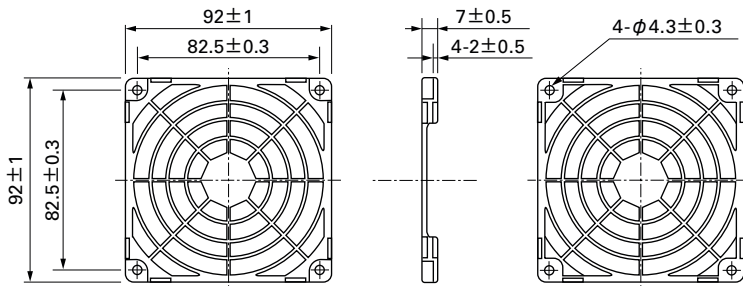

Mass : 12g

Resin Filter Kits

Model : 109-1001F13 (13PPI), 109-1001F20 (20PPI)
: 109-1001F30 (30PPI), 109-1001F40 (40PPI)

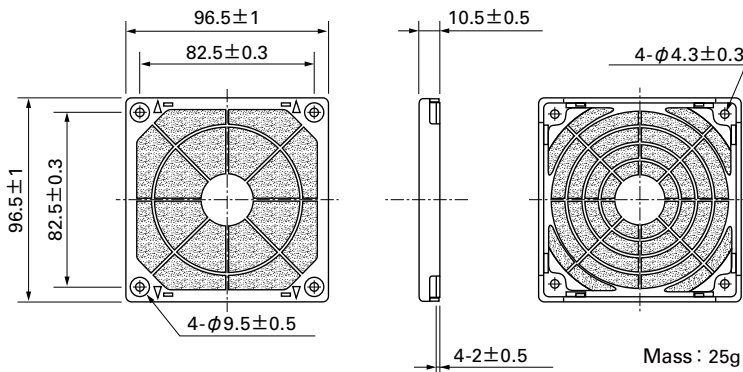

Mass : 25g

Airflow - Static Pressure Characteristics

PWM Duty Cycle

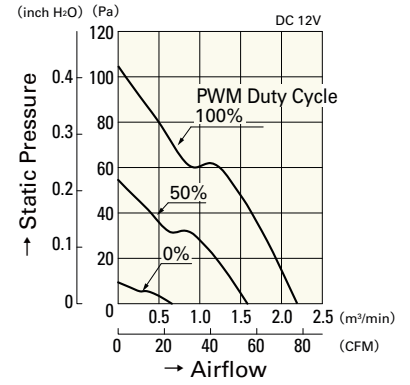

9GA0912P4J03

Operating Voltage Range

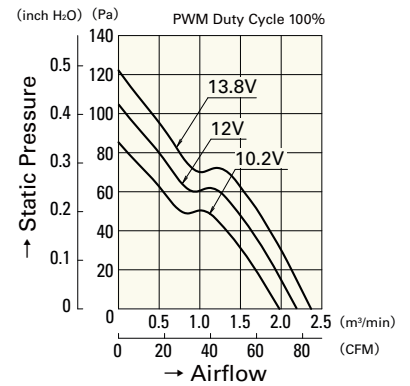

9GA0912P4J03

PWM Duty - Speed Characteristics Example

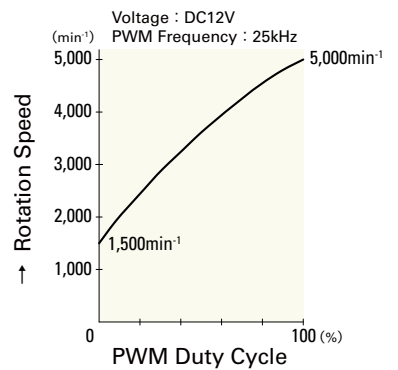

9GA0912P4J03

DC

DC Fan 92mm

92mm sq.

San Ace 92

92×92×25mm [Mass : 125g]

Airflow - Static Pressure Characteristics

PWM Duty Cycle

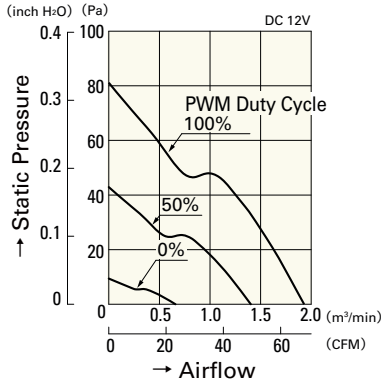

9GA0912P4G03

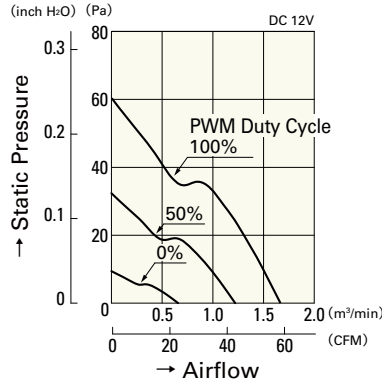

9GA0912P4S03

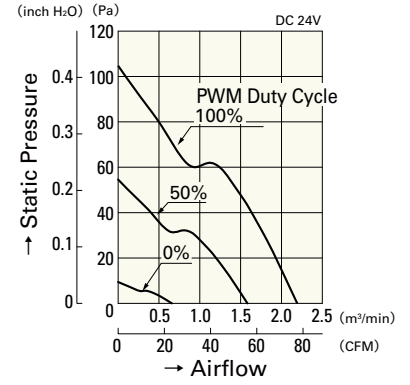

9GA0924P4J03

Operating Voltage Range

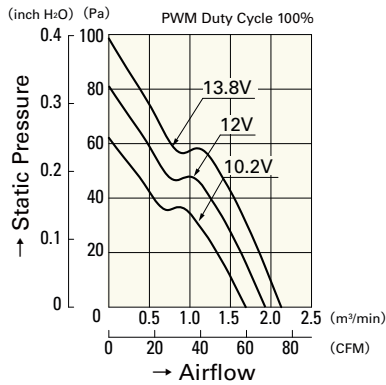

9GA0912P4G03

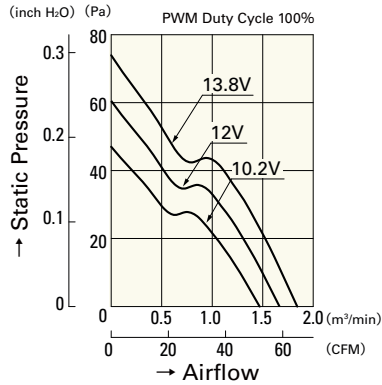

9GA0912P4S03

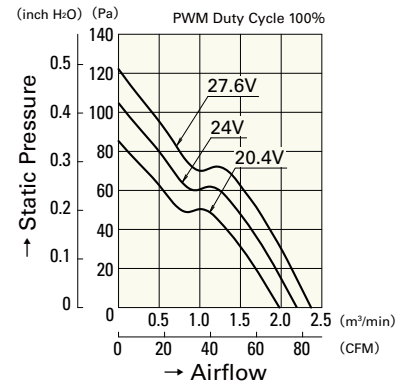

9GA0924P4J03

PWM Duty - Speed Characteristics Example

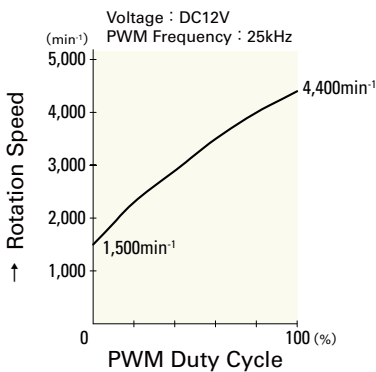

9GA0912P4G03

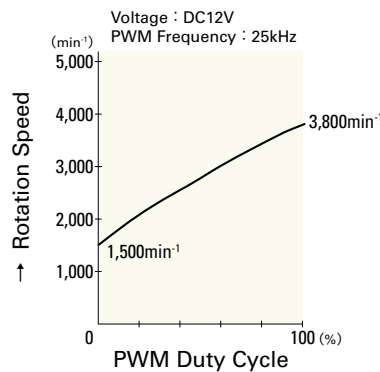

9GA0912P4S03

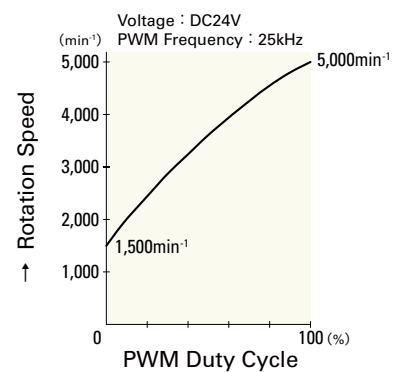

9GA0924P4J03

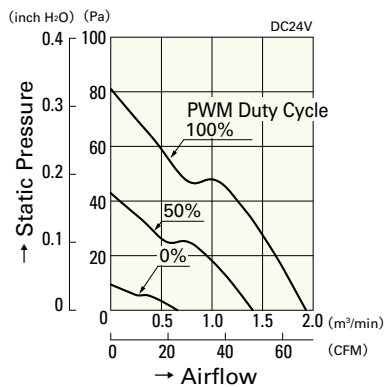

9GA0924P4G03

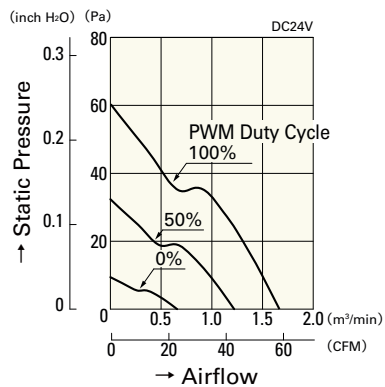

9GA0924P4S03

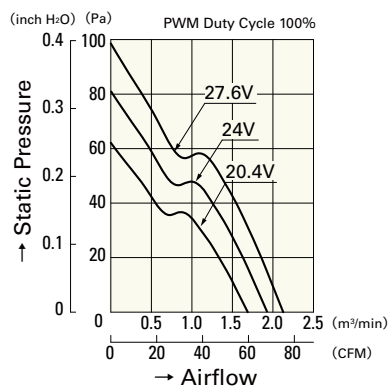

9GA0924P4G03

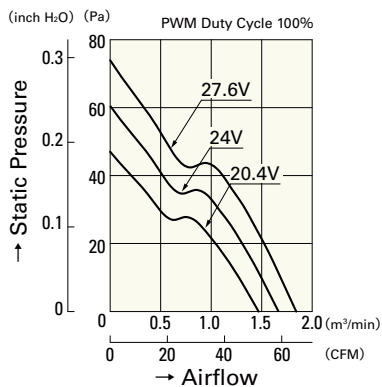

9GA0924P4S03

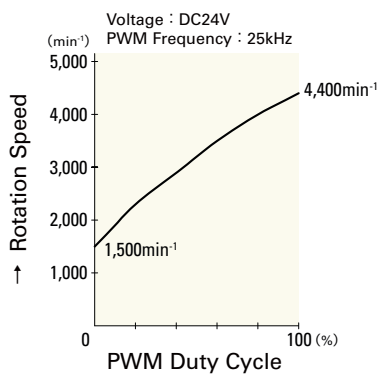

9GA0924P4G03

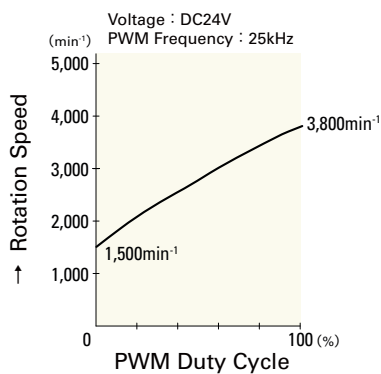

9GA0924P4S03