

L-15210-6

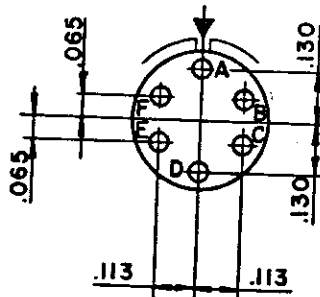

6 SIZE 20 CONTACTS

REL	WAS	DATE	D'MAN	APPD.
1	51710-1	REDRAWN TO STANDARD AA SIZE FORM.	1-3-57	GREER
2	52525-449	ADD SERVICE RATING: TYPE I	9-12-57	F. GEORGE
3	35525-822	20 M (2 PLACES); ADD ALT POS NOTE	7-13-59	LAMBERT
A1	43531-66	STD PRACTICE	7-22-65	Handwritten initials

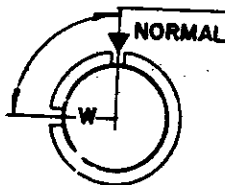

CONSIDER INSERT POSITION FIXED WITH SHELL ROTATING TO ALTERNATE POSITION

3

ARR NO.	ALTERNATE KEYWAY POS	
-6	W	90°

NOTE:

1. FRONT FACE OF PIN. INSERT SHOWN.

3

SERVICE RATING: TYPE I

MATERIAL SPEC.	PROCESS SPEC.	SCINTILLA DIVISION BENDIX AVIATION CORPORATION SIDNEY, N. Y., U.S.A.					TOLERANCES UNLESS OTHERWISE SPECIFIED						
HEAT TREAT SPEC.	FINISH SPEC.						FRACTIONS ± ~		DECIMALS ± ~		ANGLES ± ~		
NAME INSERT ARRANGEMENT, SIZE 10-620		CONCENTRICITY TIR ~			SURFACE ROUGHNESS MICRO-IN RMS MAX. ~								
		NEXT ASSEMBLY		WEIGHT - LBS.									
D'MAN GREER 7:13-56		CHECKER		MAT.		ST'DG.		CH. D'MAN		APPROVED		SCALE	
		7:14-57								NONE		SUPERSEDES AND IS NOT INTERCHANGEABLE L-15210-6	