

THIS DRAWING IS UNPUBLISHED.

RELEASED FOR PUBLICATION

12JUN2012

© COPYRIGHT 2012

BY Tyco Electronics Japan G.K.

ALL RIGHTS RESERVED.

LOC J DIST -

REVISIONS

P	LTR	DESCRIPTION	DATE	DWN	APVD
A		RELEASED	06DEC2013	T.S	N.Y
B		ADD ITEM	18NOV2014	T.S	N.Y
BI		NEW PN 9--2 ADDED	09NOV2020	SS	JDB

- 1. -1 : TYPE I , INSULATION DIAMETER 1.05-1.15mm
- 1- -1 : TYPE II, INSULATION DIAMETER 1.05-1.15mm
- 2 : TYPE I , INSULATION DIAMETER 0.93-1.05mm
- 1- -2 : TYPE II, INSULATION DIAMETER 0.93-1.05mm
- 3 : TYPE I , INSULATION DIAMETER 0.93-1.05mm IPC, 1.05-1.15mm IPC
- 4 : TYPE I , INSULATION DIAMETER 1.1-1.2mm

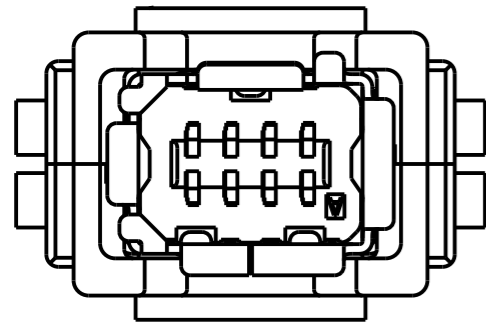
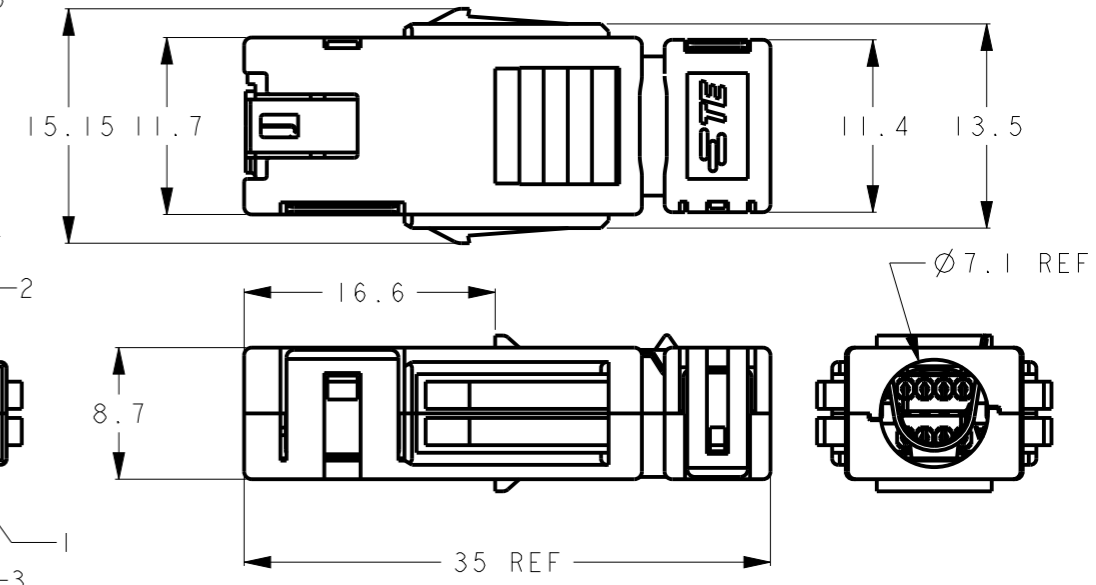
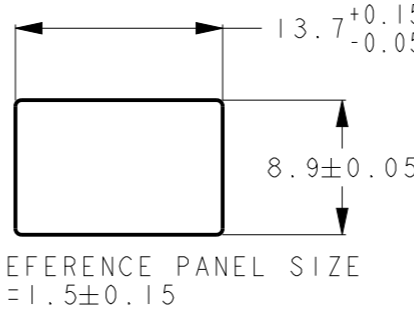

MATING SHAPE : TYPE I
2201864-1/-2-3
SCALE 4:1

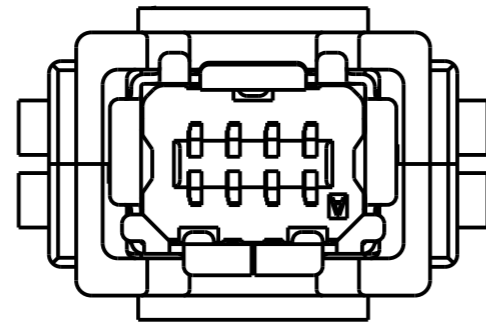

MATING SHAPE : TYPE II
1-2201864-1/-2
SCALE 4:1

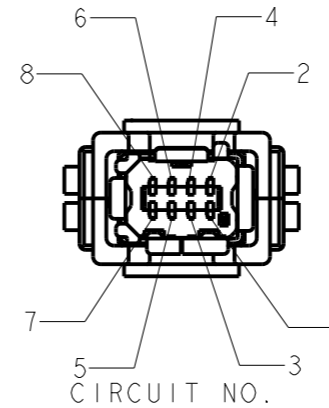

CIRCUIT NO.

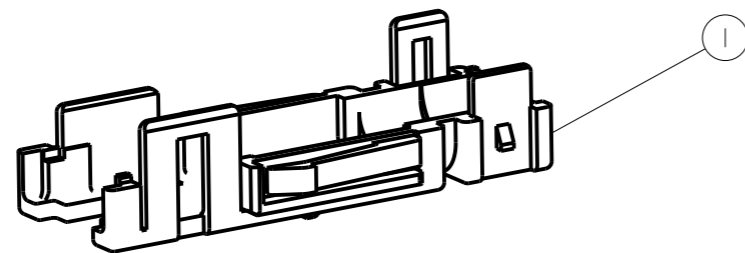
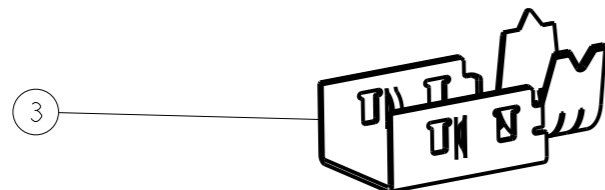
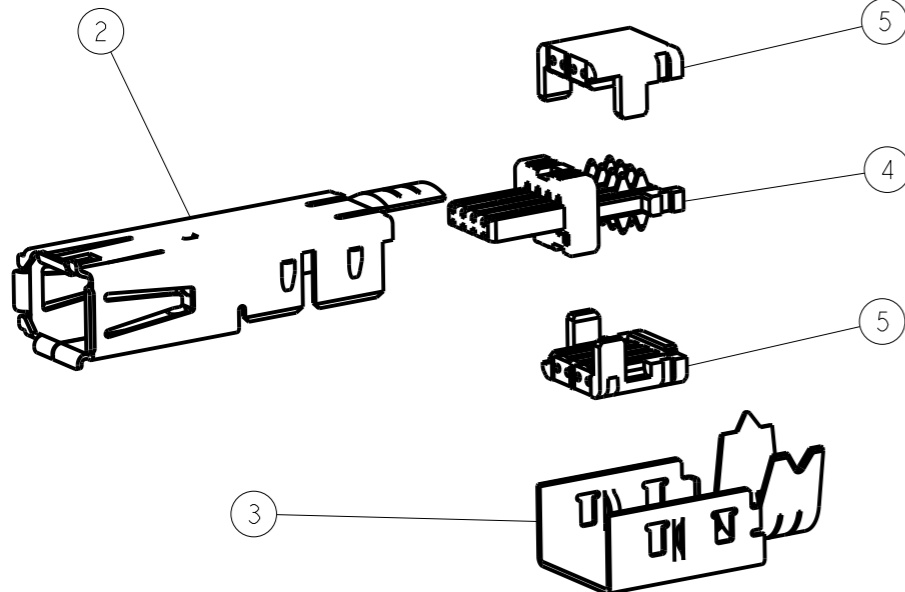
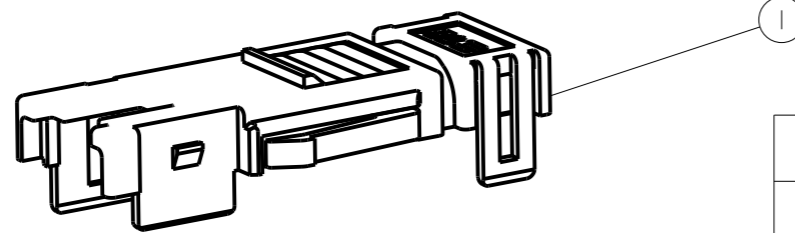

	2	-	-	-	-	-			
	2	-	1	2	2	-	THERMO PLASTIC	CABLE HSG Ø1.1-1.2 COLOR : GREEN	5
	-	-	1	-	-	2		CABLE HSG Ø0.93-1.05 COLOR : RED	
								CABLE HSG Ø1.05-1.15 COLOR : BLUE	
	1	1	1	1	1	1	HSG MATERIAL:THERMO PLASTIC	REC SUB ASSY	4
	1	1	1	1	1	1	CONTACT MATERIAL:COPPER ALLOY FINISH:Ni PLATING ALL OVER CONTACT AREA Au PLATING TERMINATION AREA Au PLATING	BOTTOM SHELL	3
	-	-	-	1	-	1	MATERIAL:COPPER ALLOY FINISH:NICKEL PLATING	REC TOP SHELL TYPE II	2
	1	1	1	-	1	-	MATERIAL:COPPER ALLOY FINISH:NICKEL PLATING	REC TOP SHELL TYPE I	
	2	2	2	2	2	2	THERMO PLASTIC	REC COVER HSG	1
	9--2	-4	-3	1--2	-2	1--1	MATERIAL/FINISH	PART NAME	ITEM

THIS DRAWING IS A CONTROLLED DOCUMENT.

DIMENSIONS: mm	TOLERANCES UNLESS OTHERWISE SPECIFIED: ± 0.5
	Ø PLC ±
	1 PLC ±0.5
	2 PLC ±0.13
	3 PLC ±0.013
	4 PLC ±0.0001
	ANGLES ±
MATERIAL -	FINISH -

DWN	06DEC2013
T. SHIMOYASU	
CHK	06DEC2013
M. HARASAWA	
APVD	06DEC2013
N. YAMASAKI	
PRODUCT SPEC	108-78955
APPLICATION SPEC	114-5506
WEIGHT	-
CUSTOMER DRAWING	

STE TE Connectivity

INDUSTRIAL MINI I/O PIERCING
REC CONNECTOR KIT

SIZE	CAGE CODE	DRAWING NO	RESTRICTED TO
A3	00779	C-2201864	
SCALE	SHEET	OF	REV
2:1	1	1	BI