

PART NUMBER CODING

MATERIAL (INSULATOR / CONTACT)

E = BLACK PBT/PHOSPHOR BRONZE

OPERATING TEMP: -65°C TO +125°C

PROCESSING TEMP: WAVE SOLDERING ONLY

O = BROWN PPS/HIGH CONDUCTIVITY COPPER ALLOY

OPERATING TEMP: -65°C TO +125°C

PROCESSING TEMP: 260°C MAX FOR 20 SECONDS

(AVAILABLE WITH 'C' PLATING CODE ONLY)

MODIFICATION

OMIT FOR STANDARD, EX: 'EBM15DKKH'

S# FOR MOLDED KEY (SEE DRAWING C13556 FOR S#, DIMENSION 'G' & 'H')

MOUNTING STYLE

H = .125" DIA. CLEARANCE HOLES (PAGE 1)

N = NO MOUNTING EARS (PAGE 2)

I = #4-40 THREADED INSERT (PAGE 2)

NUMBER OF POSITIONS (CONTACTS PER ROW)

PLATING

ALL PLATINGS ARE LEAD FREE AND HAVE .000050" NICKEL UNDERPLATE

CONTACT SURFACE

B = .000010" GOLD
 C = .000030" GOLD
 G = .000010" GOLD
 Y = .000030" GOLD
 S = .000010" GOLD OVERALL
 M = .000030" GOLD
 E = .000100" PURE TIN, MATTE OVERALL

TERMINATION

.000100" PURE TIN, MATTE
 .000100" PURE TIN, MATTE
 .000005" GOLD
 .000005" GOLD
 .000010" GOLD OVERALL

REVISIONS				
REV.	ECO. NO	DESCRIPTION	DATE	BY
A	2440	INITIAL RELEASE	09/01/2011	JH
B	4125	CHANGE CONTACT GAP DIM TO REF (WAS ±.010), UPDATE NOTE 5 & 7, ADD KEY OPTION	11/8/2019	JH
C	4576	UPDATE NOTE 8 (REMOVE 'PER CONTACT'), ADD 'O' MATERIAL	1/9/2023	MM

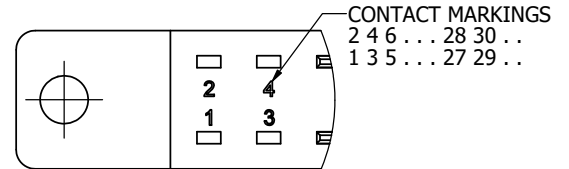

CONTACT ID (CONTACT PINS OMITTED FOR CLARITY)

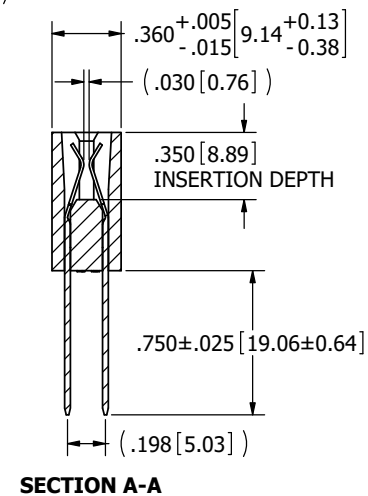
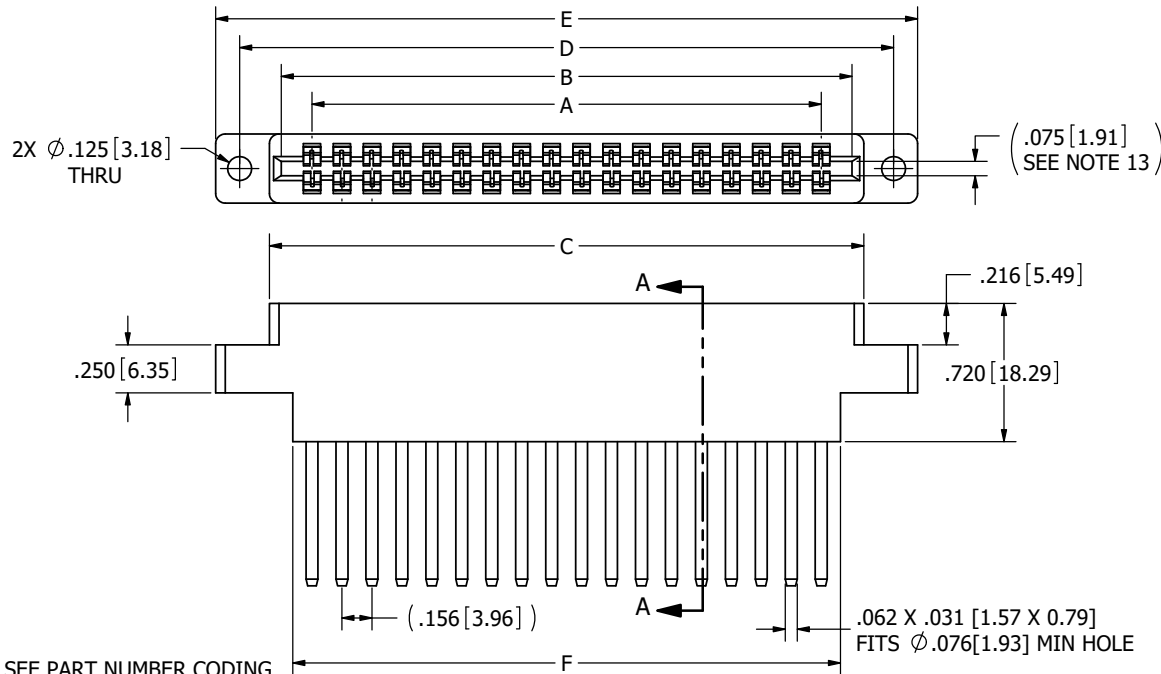

NOTES:

- INSULATOR MATERIAL: SEE PART NUMBER CODING
- CONTACT MATERIAL: SEE PART NUMBER CODING
- PLATING: SEE PART NUMBER CODING
- OPERATING TEMPERATURE: SEE PART NUMBER CODING
- PROCESSING TEMP: SEE PART NUMBER CODING
- UL FLAMMABILITY RATING: 94V-0
- OPERATING VOLTAGE: 950 VAC
- CURRENT RATING: 5 AMP
- CONTACT RESISTANCE: 30 MILLI OHMS MAX
- INSULATION RESISTANCE: 5000 MEGA OHMS
- DURABILITY: 500 CYCLES MINIMUM
- CONNECTOR IDENTIFICATION: THE PART SHALL BE MARKED WITH A PART NUMBER AND LOT CODE
- BOARD THICKNESS ACCOMMODATED: .062 ±.008 [1.57 ±0.20]
- INSERTION FORCE: 8 OZ MAX PER CONTACT PAIR WHEN USING A .062 [1.57] TEST BLADE
INTERNAL INSPECTION TO BE PER SULLINS WORK INSTRUCTION WI-8.6-03
- WITHDRAWAL FORCE: 1 OZ MIN PER CONTACT PAIR USING .062 [1.57] TEST BLADE
- MODIFICATION: SEE PART NUMBER CODING

__M__DKKH



RoHS COMPLIANT

UNLESS OTHERWISE SPECIFIED:
 DIMENSIONS ARE IN INCHES (MM)

TOLERANCES:
 ANGULAR: ± 1°

DECIMALS
 .XX = ± .02 [5]
 .XXX = ± .005 [13]
 .XXXX = ± .0005 [013]

DRAWN	DATE	NAME	SULLINS CONNECTOR SOLUTIONS	
JH	9/1/2011	JH	TITLE	
THE INFORMATION HEREIN CONTAINS PROPRIETARY INFORMATION OF SULLINS ELECTRONICS AND IS NOT TO BE REPRODUCED, USED OR DISCLOSED TO OTHERS FOR ANY PURPOSE EXCEPT AS SPECIFICALLY AUTHORIZED IN WRITING BY AN OFFICER OF SULLINS ELECTRONICS.			EDGECARD, .156 CC, HP	
PART NUMBER			M DKK	
SIZE	CAGE CODE	DWG. NO.	REV	
C	54453	C11660	C	
SCALE: 2:1		SHEET 1 OF 2		

CUSTOMER COPY

PART NUMBER	NO. OF POS.	INCHES						MILLIMETERS					
		A±.008	B±.008	C±.015	D±.010	E±.020	F±.015	A±0.20	B±0.20	C±0.38	D±0.25	E±0.51	F±0.38
__M06DKK__	6	0.780	1.100	1.224	1.534	1.784	0.980	19.81	27.94	31.09	38.96	45.31	24.89
__M10DKK__	10	1.404	1.724	1.848	2.158	2.408	1.604	35.66	43.79	46.94	54.81	61.16	40.74
__M12DKK__	12	1.716	2.036	2.160	2.470	2.720	1.916	43.59	51.71	54.86	62.74	69.09	48.67
__M15DKK__	15	2.184	2.504	2.628	2.938	3.188	2.384	55.47	63.60	66.75	74.63	80.98	60.55
__M18DKK__	18	2.652	2.972	3.096	3.406	3.656	2.852	67.36	75.49	78.64	86.51	92.86	72.44
__M20DKK__	20	2.964	3.284	3.408	3.718	3.968	3.164	75.29	83.41	86.56	94.44	100.79	80.37
__M22DKK__	22	3.276	3.596	3.720	4.030	4.280	3.476	83.21	91.34	94.49	102.36	108.71	88.29
__M25DKK__	25	3.744	4.064	4.188	4.498	4.748	3.944	95.10	103.23	106.38	114.25	120.60	100.18
__M28DKK__	28	4.212	4.532	4.656	4.966	5.216	4.412	106.98	115.11	118.26	126.14	132.49	112.06
__M30DKK__	30	4.524	4.844	4.968	5.278	5.528	4.724	114.91	123.04	126.19	134.06	140.41	119.99
__M31DKK__	31	4.680	5.000	5.124	5.434	5.684	4.880	118.87	127.00	130.15	138.02	144.37	123.95
__M36DKK__	36	5.460	5.780	5.904	6.214	6.464	5.660	138.68	146.81	149.96	157.84	164.19	143.76
__M43DKK__	43	6.552	6.872	6.996	7.306	7.556	6.752	166.42	174.55	177.70	185.57	191.92	171.50
__M50DKK__	50	7.644	7.964	8.088	8.398	8.648	7.844	194.16	202.29	205.44	213.31	219.66	199.24

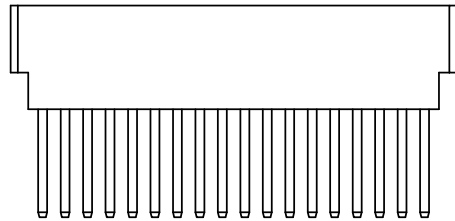
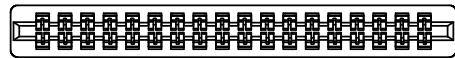

__M__DKKN

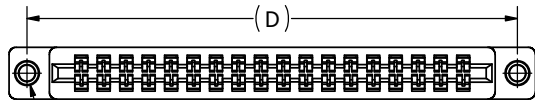

2X #4-40 THREADED INSERT

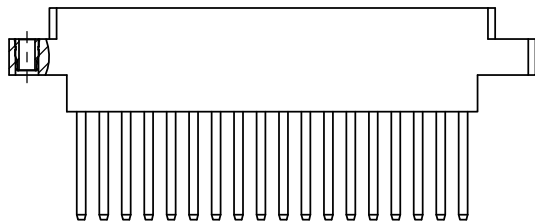

__M__DKKI

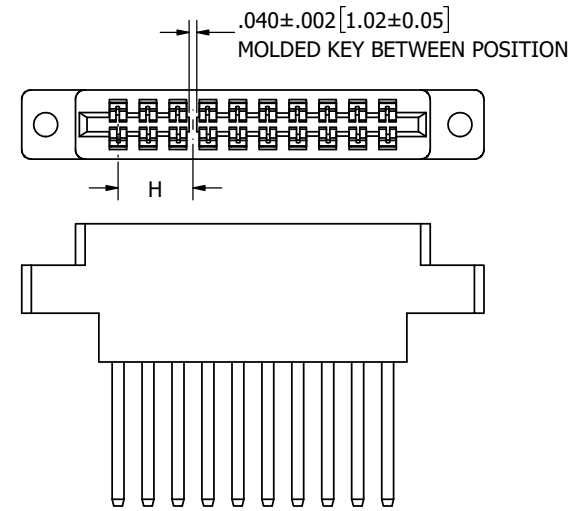
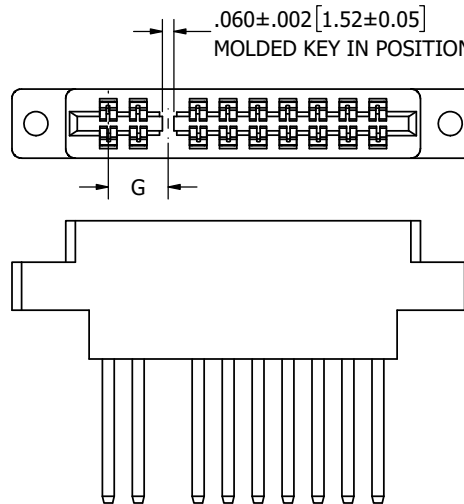

('H' MOUNTING AS SHOWN FOR EXAMPLE)

CUSTOMER COPY



RoHS COMPLIANT

UNLESS OTHERWISE SPECIFIED:
DIMENSIONS ARE IN INCHES (MM)

TOLERANCES:
ANGULAR: ± 1°
DECIMALS
.XX = ± .02 [5]
.XXX = ± .005 [13]
.XXXX = ± .0005 [013]

DRAWN	DATE	NAME
	9/1/2011	JH
<small>THE INFORMATION HEREIN CONTAINS PROPRIETARY INFORMATION OF SULLINS ELECTRONICS AND IS NOT TO BE REPRODUCED, USED OR DISCLOSED TO OTHERS FOR ANY PURPOSE EXCEPT AS SPECIFICALLY AUTHORIZED IN WRITING BY AN OFFICER OF SULLINS ELECTRONICS.</small>		

SULLINS CONNECTOR SOLUTIONS			
TITLE EDGE CARD, .156 CC, HP			
PART NUMBER __M__DKK__			
SIZE C	CAGE CODE 54453	DWG. NO. C11660	REV C
SCALE: 2:1		SHEET 2 OF 2	