

Switchable Circuit Breaker

Small Package

UL489 Listed

Cadmium - Free

High Capacity 5000AIC



Series 07

Raising the Bar

MP - Count on it



Mechanical Products Company

Series 07 Overview

MP Series 07 includes Models 752, 762, and 772 Switchable circuit breakers. A distinctive characteristic of this design is its double-break contact mechanism. This configuration allows some models in this family to withstand short circuit conditions as high as 5,000A and continue to function. Model 752 (Switchable) and Model 252 (push-to-reset) are the smallest devices available that are capable of withstanding a 5,000A short circuit.

Series 07 offers:

- AC/DC ratings from 5 to 40A
- UL, CSA, VDE, CCC
- ROHS Compliance - Cd Free
- Superior Interrupt Capacity
- High Capacity in a Small Package

Series 07 Specifications

Standard Amp Ratings

Model 752 is offered in ratings of 15A & 20A

Model 762 is offered in ratings of 5A*, 7A*, 10A, 15A, and 20A

Model 772 is offered in ratings of 30A* and 40A*

*Consult factory for amperage ratings 5-7A & 30-40A

Minimum Ultimate Trip

Model 752, 762, 772 offer a minimum ultimate trip of 100% of rated current at 25°C / 77°F

Voltage Ratings

Model 752

120VAC per UL, CSA & CCC

277VAC / 48VDC per VDE

Model 762

120VAC (5-20A) per UL, CSA, CCC

277VAC (5-9A) per UL, CCC

277VAC / 48VDC (10-20A) per VDE

Model 772

277VAC per CCC

Interrupt Capacity (UL489 and UL1077)

Model 752

5,000A/120VAC per UL489

Model 762

5,000A/120VAC per UL1077

1,000A/120VAC per UL1077

Model 772

1,000A/120VAC per UL1077

Ambient Temperature Correction Factor

Current Rating	°F	32	77	104	122	140
	°C	0	25	40	50	60
5 & 7A		0.84	1.00	1.15	1.3	1.53
10 to 30A		0.88	1.00	1.11	1.2	1.32

Overload Trip Time Data (in seconds)

Model	Current Rating	200%	300%	400%	500%	600%	800%	1000%
762	5 - 7 A	5 - 20	1.7 - 6.4	0.9 - 3.1	0.5 - 1.9	0.35 - 1.4	0.2 - 0.76	0.17 - 0.53
752 / 762 / 772	10 - 40 A	5 - 30	1.8 - 10	0.9 - 5	0.5 - 3.3	0.38 - 2.3	0.2 - 1.3	0.15 - 0.9

Dielectric Strength

Series 07 Models have a dielectric strength rating of 1,500VAC.

Inrush Capacity

Series 07 models will not trip at 35X rated current for 1/2 cycle (0.008 sec.)

Maximum Ultimate Trip

Model 752, 762, and 772 have a maximum ultimate trip of 135% of rated current at 25°C/77°F.

Regulatory Approvals

Model 752

UL - Listed per UL489 (File #50952)

suitable for branch circuit protection

CSA -Certified per C22.2 No. 5 (File #2696722)

VDE -Licensed to IEC STD 60934 (License #40011788)

CCC - CQC STD GB17701-2008 (Certificate #2005010307139109)

Model 762

UL -Recognized per UL1077 (File #E27727)

CSA -Certified (File#1258916)

VDE -Licensed to IEC STD 60934 (License #40011788)

CCC - CQC STD GB17701-2008 (Certificate #2005010307139109)

Model 772

UL -Recognized per UL1077 (File #E27727)

CCC - CQC STD GB17701-2008 (Certificate #2005010307139109)

Voltage Drop

Model	Ampere Range	Voltage Drop
752	15 & 20A	0.25V
762	5 & 7A	0.35V
	10A	0.25V
	15 & 20A	0.25V
772	30 & 40A	0.15V

Factors are typical for amperages listed



Mechanical Products Company

1112 Garfield St. Lombard, IL 60148 helpme@mechprod.com phone 630 | 953 | 4100 fax 630 | 953 | 4110 www.mechprod.com

Specifications Subject to Change

QC-4002-B

Series 07 Operating Characteristics

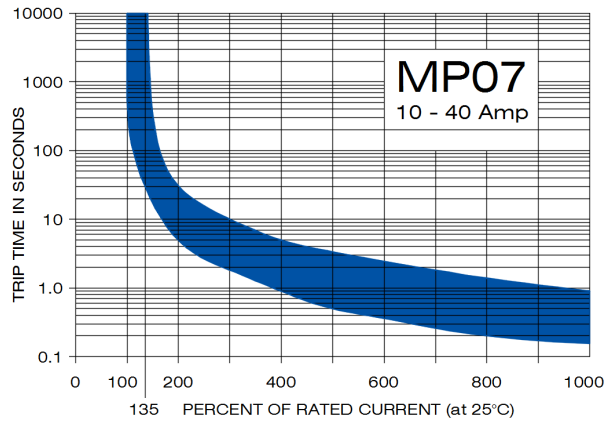
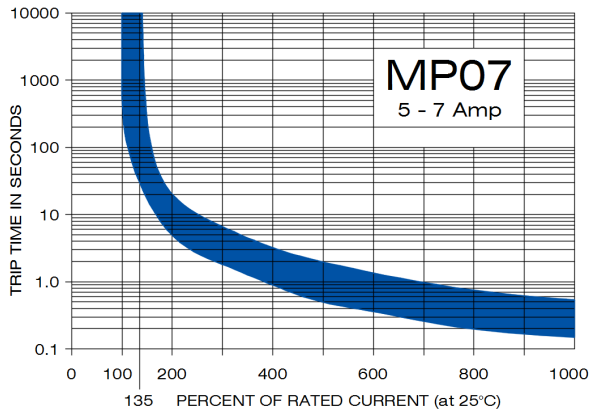

Trip curves presented are based on typical samples and are for reference. Please consult the factory for more specific application information. Trip curves are specified at 25°C / 77°F

Series 07 Physical Configuration

Case Sizes: Models 752 - 762

(See Part Numbering Guide)

Models 752 and 762 offer single-pole switchable protection in a compact package size. Standard 0.250" quick-connect terminals are available, as is a "push-pull" actuator with imprinted amp rating. Through-the-panel mounting is facilitated by a 3/8"-27 diameter threaded bushing with a D-shaped flat for anti-rotational requirements.

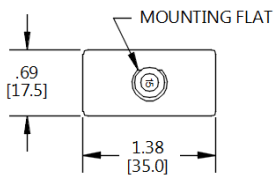

Amp stamp and flat on bushing may be rotated 180° from that shown.

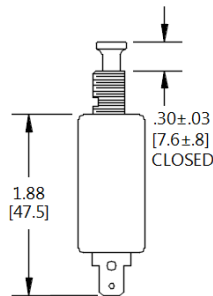
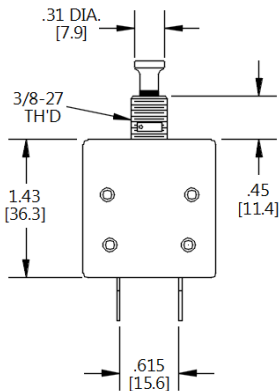

$.331 +.004 -.000$
[8.41 +.10 -0]

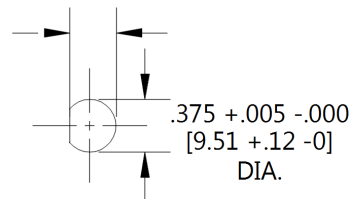

SUGGESTED PANEL MOUNTING HOLE

All Series 07 Models have the actuator button imprinted with the amp rating. The flat area on the panel cutout should be to the left of the actuator in vertical orientation.

Mounting Hardware

(See Part Numbering Guide)

Note: All dimensions are in inches [mm]

Standard terminals on Model 772

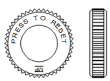

Knurlnut (Nylon)

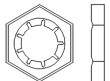

Palnut



Knurlnut



Hexnut

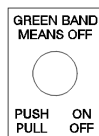

Instruction Plate

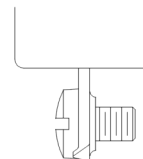

Model 772, Rated at 30A and 40A, comes with standard #10-32 screw terminals



Mechanical Products Company

1112 Garfield St. Lombard, IL 60148 helpme@mechprod.com phone 630 | 953 | 4100 fax 630 | 953 | 4110 www.mechprod.com

Specifications Subject to Change

QC-4002-B

Series 07 Part Numbering Guide

P/N:

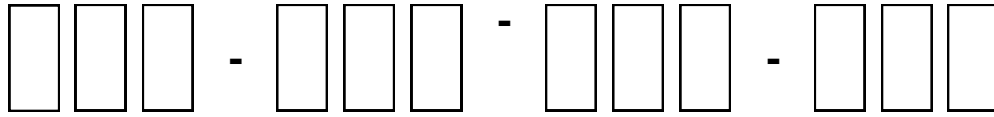

Code	Model	Code	Variation	Code	Amp Ratings	Code	Hardware
752	UL489 listed CSA certified 5,000A interrupt @ 120VAC	001	3/8"-27 dia. Threaded mounting bushing w/ anti-rotation flat. 0.250" quick-connect terminals. White Actuator with trip indicator. Black ampere rating marking on actuator.	150	15.0A	051	Palnut / Knurlnut
		002	3/8"-27 dia. Threaded mounting bushing w/ anti-rotation flat. 0.250" quick-connect terminals. Terminals bent outbound 45 degrees White Actuator with trip indicator. Black ampere rating marking on actuator.	200	20.0A	054	Hexnut / Hexnut
762	UL1077 recognized CSA certified: 10 to 20A 5,000A interrupt @ 120VAC 5 & 7A 1,000A interrupt @ 277VAC	001	3/8"-27 dia. Threaded mounting bushing w/ anti-rotation flat. 0.250" quick-connect terminals. White Actuator with trip indicator. Black ampere rating marking on actuator.	050	5.0A*	087	Knurlnut / Hexnut / Instruction Plate
		012	3/8"-27 dia. Threaded mounting bushing w/ anti-rotation flat. 0.250" quick-connect terminals. Black actuator with trip indicator. White ampere rating marking on actuator.	070	7.0A*		
772	1,000 interrupt @ 120VAC	001	3/8"-27 dia. Threaded mounting bushing w/ anti-rotation flat. #10-32 UNF screw terminals. White Actuator with trip indicator. Black ampere rating marking on actuator.	100	10.0A	098	Palnut / Knurlnut / Instruction Plate
				150	15.0A		
				200	20.0A		
				300	30.0A*		
				400	40.0A*		

*Consult factory for amperage ratings 5-7A & 30-40A



WARNING: CANCER & REPRODUCTIVE HARM – www.P65Warnings.Ca.Gov/

• For More Information visit www.mechprod.com/MP_Prop_65



Mechanical Products Company

1112 Garfield St. Lombard, IL 60148 helpme@mechprod.com phone 630 | 953 | 4100 fax 630 | 953 | 4110 www.mechprod.com

Specifications subject to change

QC-4002-B