

Data sheet | Item number: 2065-133

Board-to-Board Link; Pin spacing 6.5 mm; Length: 17.6 mm; silver-colored

www.wago.com/2065-133

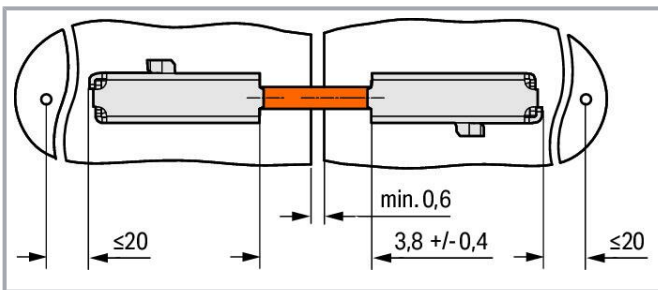
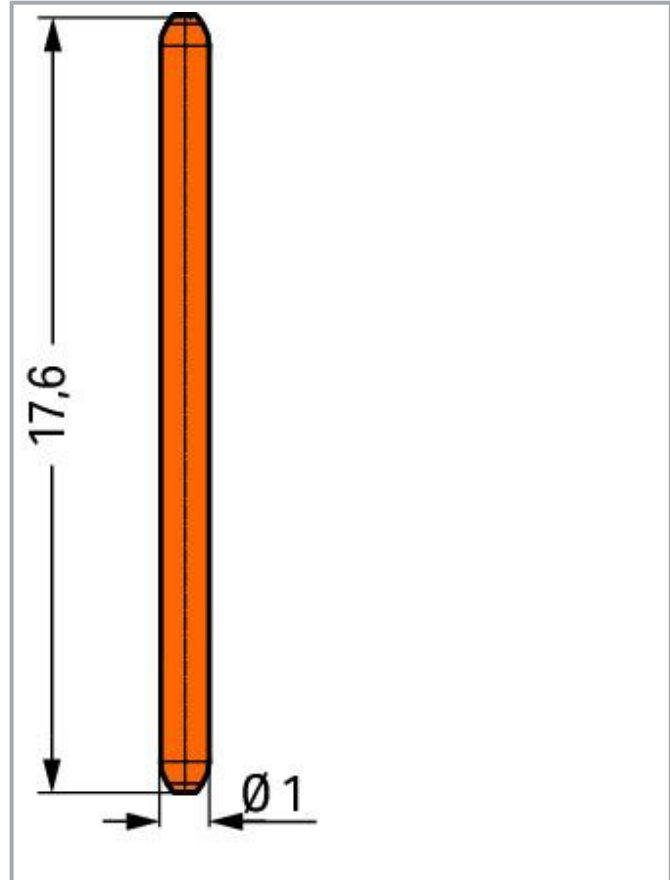
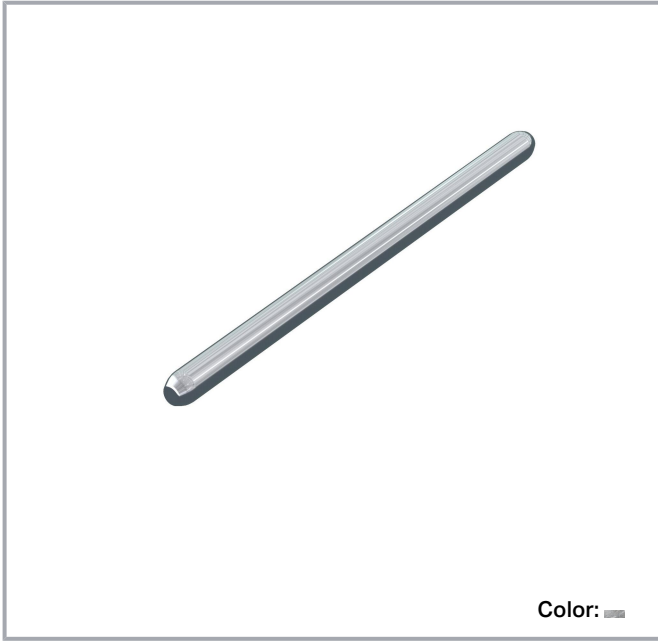

Item description

- Board-to-board links simplify in-line assembly of LED modules
- Space saving connection of PCBs

Subject to changes. Please also observe the further product documentation!

WAGO GmbH & Co. KG

Hansastr. 27

32423 Minden

Phone: +49571 887-0 | Fax: +49571 887-169

Email: info.de@wago.com | Web: www.wago.com

Do you have any questions about our products?

We are always happy to take your call at +49 (571) 887-44222.



Data

Notes

Safety information

Notice:

Terminal block without insulation housing! Protection against accidental contact must be provided at voltages higher than low voltages (e.g., SELV/PELV) for the relevant application.

Note	The layout must meet the requirements of the insulation coordination standard EN/IEC 60664-1 and applicable end product standards. When using board-to-board links, please note the potentially reduced clearances (e.g., with metal core boards).
------	--

Electrical data

Ratings per IEC/EN

Ratings per	IEC/EN 60664-1
Nominal voltage (III/3)	250 V
Rated impulse voltage (III/3)	4 kV
Rated voltage (III/2)	320 V
Rated impulse voltage (III/2)	4 kV
Nominal voltage (II/2)	630 V
Rated surge voltage (II/2)	4 kV
Rated current	9 A
Legend (ratings)	(III / 2) ≙ Overvoltage category III / Pollution degree 2

Physical data

Depth	17.6 mm / 0.693 inches
Length	17.6 mm
Diameter	1 mm

Mechanical Data

Mating cycles (max.)	10
Number of mating cycles	10 connections/disconnections (max.)
Suitable	for SMD PCB terminal blocks; 2065 Series

Subject to changes. Please also observe the further product documentation!

Material Data

Note (material data)

Information on material specifications can be found here

Color	silver-colored
Contact material	Copper alloy
Contact plating	Silver
Weight	0.1 g

Environmental requirements

Limit temperature range	-60 ... +120 °C
-------------------------	-----------------

Commercial data

ETIM 8.0	EC002848
ETIM 7.0	EC002848
PU (SPU)	1500 pcs
Packaging type	box
Country of origin	DE
GTIN	4055143862738
Customs tariff number	8536901000

Environmental Product Compliance

RoHS Compliance Status	Compliant, No Exemption
------------------------	-------------------------

Counterpart



Item no.2065-100/998-403

SMD PCB terminal block; push-button; 0.75 mm²; Pin spacing 6.5 mm; 1-pole; Push-in CAGE CLAMP®; in tape-and-reel packaging; Without housing; 0,75 mm²; silver-colored

www.wago.com/2065-100/998-403



Item no.2065-101/998-403

SMD PCB terminal block; 0.75 mm²; Pin spacing 6 mm; 1-pole; PUSH WIRE®; in tape-and-reel packaging; Without housing; 0,75 mm²; silver-colored

www.wago.com/2065-101/998-403

Downloads

Documentation

Additional Information

Subject to changes. Please also observe the further product documentation!

WAGO GmbH & Co. KG

Hansastr. 27

32423 Minden

Phone: +49571 887-0 | Fax: +49571 887-169

Email: info.de@wago.com | Web: www.wago.com

Do you have any questions about our products?

We are always happy to take your call at +49 (571) 887-44222.

Technical Section
Technical explanations

2019 Apr 3

pdf
2.0 MB

[Download](#)

CAD/CAE-Data

CAD data

2D/3D Models 2065-133

[URL](#)

[Download](#)

CAE data

ZUKEN Portal 2065-133

[URL](#)

[Download](#)

Environmental Product Compliance

Compliance Search

Environmental Product Compliance 2065-133

[URL](#)

[Download](#)

Board-to-Board Link; Pin spacing 6.5 mm; Length: 17.6 mm; silver-colored

Installation Notes

Installation

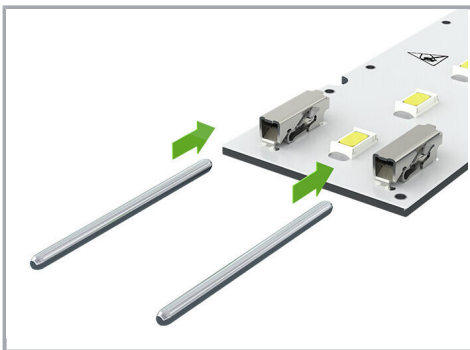

Insert the board-to-board links into the terminal blocks.

Installation

Subject to changes. Please also observe the further product documentation!

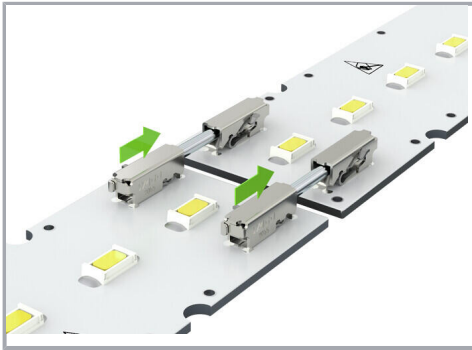

Assembly: Place PCBs on a flat surface and insert links into terminal blocks on adjoining PCBs. Disassembly: Open the terminal blocks with an operating tool. (max. 5 connections /disconnections)

Installation

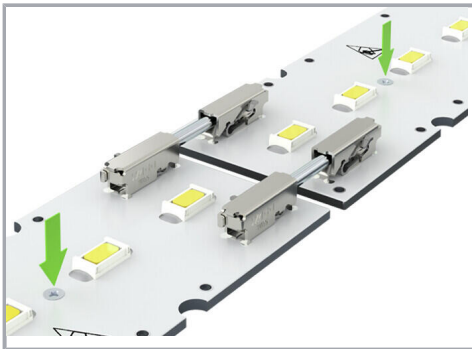

The PCBs must be secured.

Subject to changes. Please also observe the further product documentation!