

**Male**

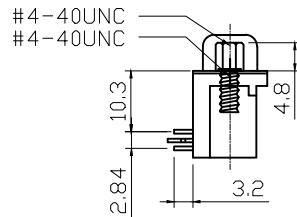
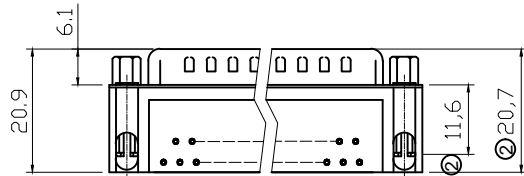
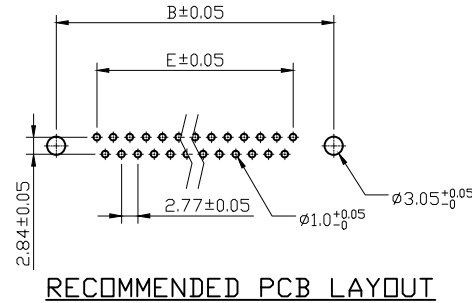
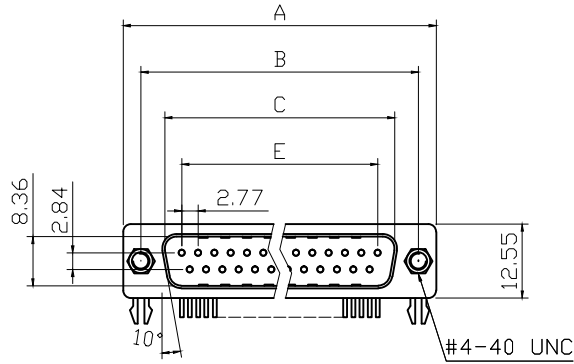

④ Product Specification

Material

Insulator: Glass-Filled thermoplastic PBT, UL94V-0  
 Shell: Steel 7439-89-6  
 100µ" Tin over 80µ" min copper  
 Clinch Nut: Copper alloy, Nickel plated  
 Boardlock: Brass, Tin plated  
 Screwlock: Brass, Nickel plated  
 Contact: Phosphor bronze  
 Contact plating: Gold flash full gold

Electrical

Contact Resistance: 20mΩ/contact max at 1AMP/DC  
 Insulation Resistance: 1000MΩ at 500VDC  
 Dielectric Withstanding Voltage: 1000VAC/rms 60Hz for 1 minute  
 Current Rating: 3AMP  
 Voltage Rating: 250VAC/rms 60Hz

⑥ Temperature Range: -55°C ~ 105°C

① Solder temp for wave soldering: 220°C ±5°C, 3-5sec.

Order Code:

A-Dx xx A/KG-xx \* on request  
 Contact style: F - Female, S - Male  
 Version: T1 - with locking bolts UNC, T3 - without locking bolts \*  
 No. of Contacts: 09 / 15 / 25 / 37  
 Standard: Quality class III

Dimensions

Positions	A	B	C	E
9	30.81	24.99	16.92	11.08
15	39.20	33.30	25.25	19.39
25	53.05	47.04	38.96	33.24
37	69.40	63.50	55.42	49.86

9.4mm Footprint

**RoHS compliant**

Unit:mm



Scale	Free	⑥	Update temperature range	20.11.2020	Luca	Date	Name	Description:	D-sub connector	
TOLERANCE		⑤	Add UL logo	27.02.2020	Winnie	Drawn	15.08.2012	Lucas	Male/Right Angel	
X.	±0.38	④	Edit Product Specification	28.06.2018	S.Bölling	Approved	20.11.2020	Luca	ASSMANN WSW-No. <b>A-Dx xx A/KG-T1/T3</b>	
X.X	±0.25	③	Add the UL number	11.12.2015	Winnie			Drawing-No.		
X.XX	±0.13	②	Update the dimension	27.02.2015	Winnie				ASS 4889 CO	rev06
DIM	TOL	①	Add the soldering temperature	24.01.2014	Winnie				Customer-No.	Sheet
X.°	±3°	Id.	Modification	Date	Name			1/2		
X.X°	±1.0°									
Angle	TOL									

**Female**

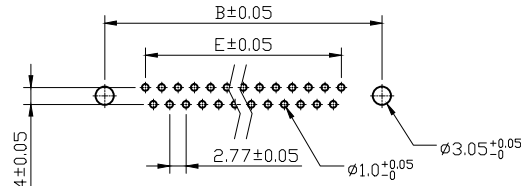
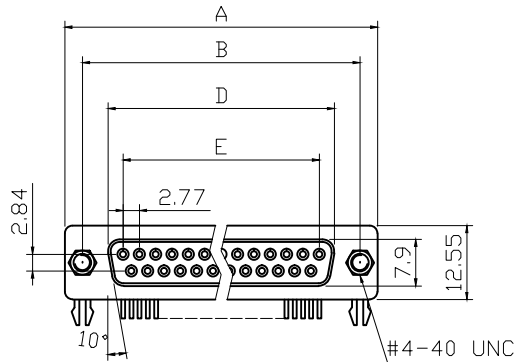

**RECOMMENDED PCB LAYOUT  
FEMALE \ MALE**

④ Product Specification

Material

- Insulator: Glass-Filled thermoplastic PBT, UL94V-0
- Shell: Steel 7439-89-6  
100µ" Tin over 80µ" min copper
- Clinch Nut: Copper alloy, Nickel plated
- Boardlock: Brass, Tin plated
- Screwlock: Brass, Nickel plated
- Contact: Phosphor bronze
- Contact plating: Gold flash full gold

Electrical

- Contact Resistance: 20mΩ/contact max at 1AMP/DC
- Insulation Resistance: 1000MΩ at 500VDC
- Dielectric Withstanding Voltage: 1000VAC/rms 60Hz for 1 minute
- Current Rating: 3AMP
- Voltage Rating: 250VAC/rms 60Hz

⑥ Temperature Range: -55°C ~ 105°C

① Solder temp for wave soldering: 220°C ±5°C, 3~5sec.

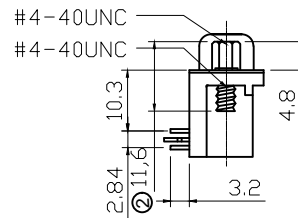
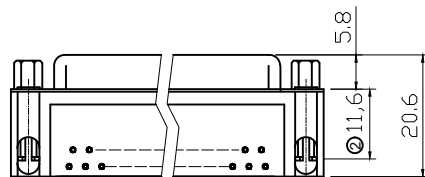

Dimensions

Positions	A	B	D	E
9	30.81	24.99	16.33	11.08
15	39.20	33.30	24.70	19.39
25	53.05	47.04	38.40	33.24
37	69.40	63.50	54.80	49.86

9.4mm Footprint

**RoHS compliant**

Unit:mm



Scale	Free	⑥	Update temperature range	20.11.2020	Luca		Date	Name
TOLERANCE		⑤	Add UL logo	27.02.2020	Winnie	Drawn	15.08.2012	Lucas
X.	±0.38	④	Edit Product Specification	28.06.2018	S.Bölling	Approved	20.11.2020	Luca
X.X	±0.25	③	Add the UL number	11.12.2015	Winnie			
X.XX	±0.13	②	Update the dimension	27.02.2015	Winnie			
DIM	TOL	①	Add the soldering temperature	24.01.2014	Winnie			
X.°	±3°	Id.	Modification	Date	Name			
X.X°	±1.0°							
Angle	TOL							



Description: D-sub connector

Female/Right Angel

ASSMANN WSW-No.  
**A-Dx xx A/KG-T1/T3**

Drawing-No.

**ASS 4889 CO**

rev06

Customer-No.

Sheet  
2/2