

REV.	DESCRIPTION	DATE
A	RELEASE	2016.06.08

RoHS

**MATERIAL&FINISH**

Insulator: PBT Glass Fiber(UL94V-0)  
 Contact Material: Terminal Brass.  
 Contact Plating : Terminal Shell  
 Spec. Gold-Plated Over Nickel.

**SPECIFICATIONS**

Current Rating :1A AC, DC  
 Voltage Rating : 250V AC, DC  
 Temperature Range:-40° C To+105° C  
 Contact Resistance:20MΩ Max  
 Insulation Resistance:1000MΩ Min  
 Withstanding Voltage:500V AC/Min

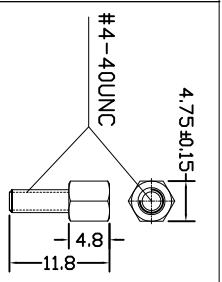
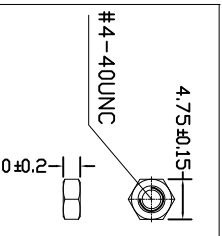
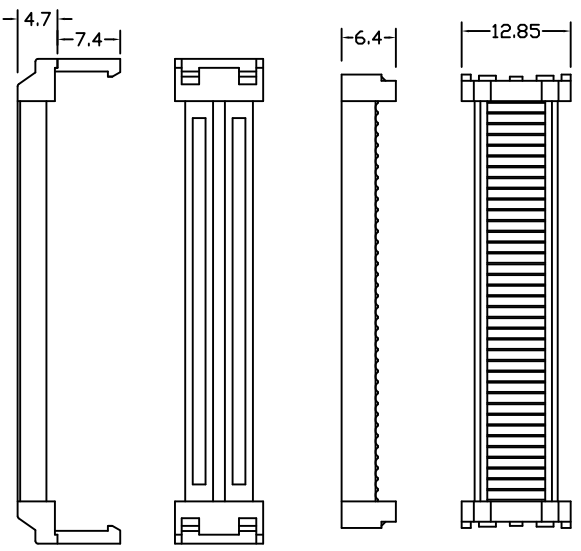
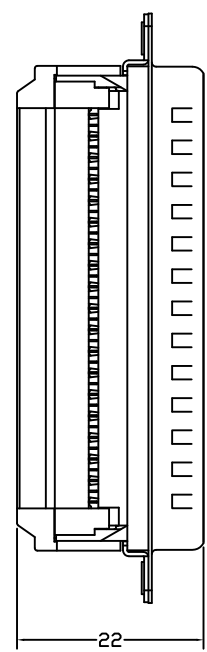
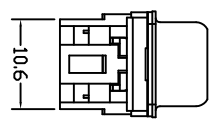
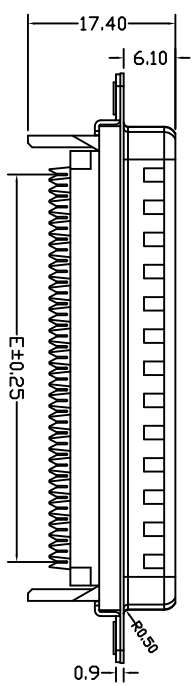
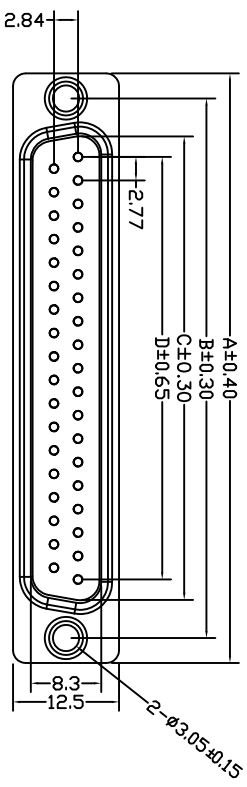

NUMBER OF POSITIONS	DIMENSION				
	A	B	C	D	E
9	30.80	25.00	16.95	11.08	10.16
15	39.14	33.30	25.3	19.39	17.78
25	53.05	47.04	38.96	33.24	30.48
37	69.32	63.50	55.42	49.86	45.72

UNLESS TOLERANCE		DRAW BY
GENERAL	ANGLE	
X. ± 0.30	X°. ± 3.0°	DESIGN BY
.XX ± 0.20	.XX' ± 2.0'	CHECK BY
.XXX ± 0.15	.XXX' ± 1.0'	APPROVE BY
.XXX ± 0.08	.XXX ± 0.5'	

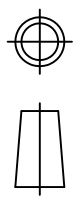

SCALE	SHEET	UNIT
1:1	1/1	MM

**CnC Tech,LLC**

Part NO. 400MD-XX-1-004S  
 DRAW NO: REV: A