

PART NO.  
**SEE CHART**  
 DWG. NO.  
**SDA-90533**

TAB APPEARS AT FIRST & LAST CIRCUIT POSITIONS ONLY.

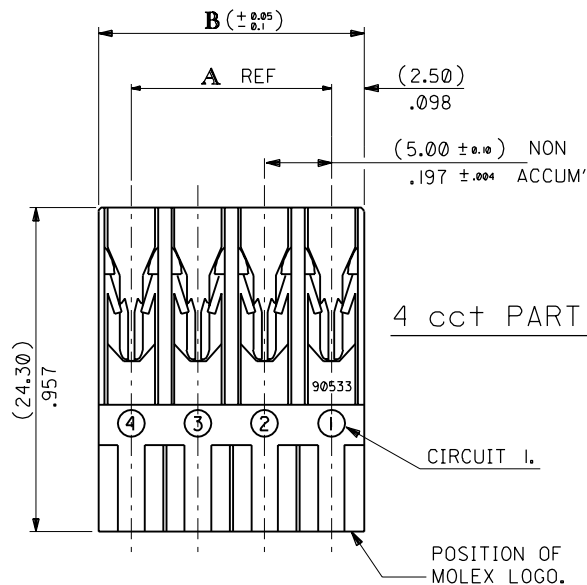

TOOLING STATUS	CCT SIZE	PART No.	DIMn. A	DIMn. B
TOOLED	2	90533 - 0052	(5.00)/.194	(10.00)/.394
TOOLED	3	90533 - 0053	(10.00)/.394	(15.00)/.591
TOOLED	4	90533 - 0054	(15.00)/.591	(20.00)/.787
NOT TOOLED	6	90533 - 0056	(25.00)/.984	(30.00)/1.181

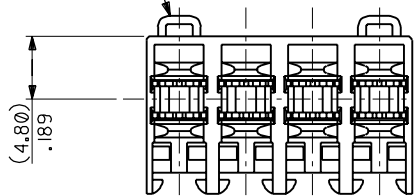
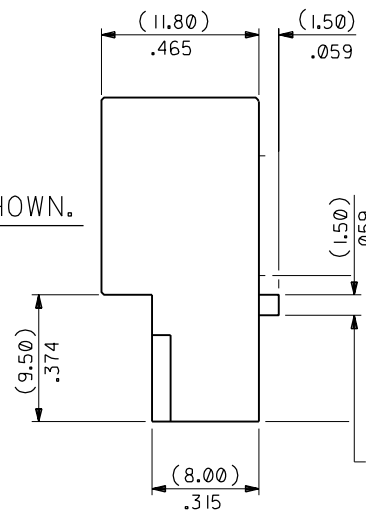

**NOTES:**

- MATERIAL: HOUSING NYLON 66, 25% GLASS FILLED 94V-0  
 COLOUR: BRICK RED  
 CONTACT: BRASS - TIN PLATED.
- WIRE RANGE: 0.50<sup>2</sup> mm - 1.50<sup>2</sup> mm MAX INSULATION DIA 3.20mm.
- ACCEPTS 6.30mm TAB TO DIN 46244 OR BS 5057
- BOSS NOT PRESENT AFTER TERMINATION
- PARTS STACKABLE AT (5.00)/.197 PITCH
- FOR PARTS SUPPLIED ON TAPE - SEE SUBSEQUENT SHEETS.
- POSITION OF TAPE (WHERE APPLICABLE)
- FOR PRODUCT SPECIFICATION SEE PS 99020-0005.

FOR PREVIOUS DRAWING ISSUES SEE MRI.

ADD SHEET 4 ECN: E40177 94 FEB. 17 FM	DRWG BY <b>MOS</b>
LTR REVISIONS	CHK'D BY
DESIGN DIMENSION (PRIMARY) <input checked="" type="checkbox"/> (MM)	APP'D BY
EQUIVALENT DIMENSION (SECONDARY) <input type="checkbox"/> (MM)	SCALE <b>3:1</b>

<b>REVISE ONLY ON CAD SYSTEM</b>		CAD/CAM FILENAME SA90533X1.DGN THIS DRAWING CONTAINS INFORMATION THAT IS PROPRIETARY TO MOLEX INC. & SHOULD NOT BE USED WITHOUT WRITTEN PERMISSION
<b>TITLE</b> MULTIWAY M.W.G. ASSEMBLY		
<b>MOLEX EUROPE</b>		SHEET NO. DATE <b>10F4 22/01/89</b>
PART NO. <b>SEE CHART</b>	DWG NO. <b>SDA-90533</b>	SIZE <b>B</b>

4	E
3	E
2	E
1	E
SH.	REV.