

BWHH Series



Due to accurate wire winding technology, these chip inductors are designed for filtering, impedance matching, resonance and choke circuits for RF designer. Both standard series custom designs are available.

Features

- RoHS Compliant and Halogen Free
- Ceramic body and wire wound construction provide high Q and SRFs
- Higher Q and lower DCR than other inductors
- Exceptional current handling capability
- HPH series is for high power and high frequency application

Applications

- Wireless embedded portable devices
- GPS receiver
- Base Station
- Repeater
- Set Top Box
- Cable / IP Modem
- Security system and other RF modules

Product Identification

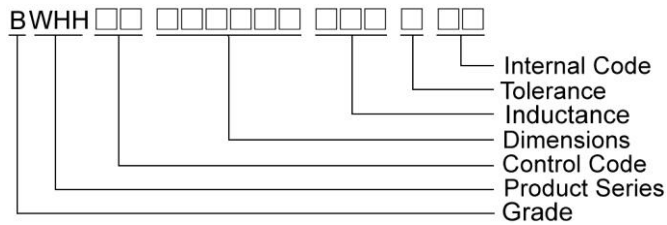

Shape and Dimensions / Recommended Pattern

BWHH00161108

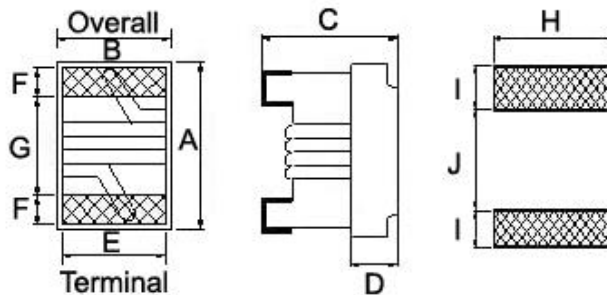

Dimensions

| | A | B | C | D | E | F | G | H | I | J |
|---------------------|-------------------------------------|----------|--------------------------------------|------|------|------|------|------|------|------|
| BWHH00161108 | 1.6 ^{+0.2} _{-0.1} | 1.12±0.1 | 0.82 ^{+0.2} _{-0.1} | 0.30 | 0.70 | 0.30 | 0.95 | 1.02 | 0.64 | 0.64 |

SMD Wire Wound Ceramic Chip Inductors - BWHH Series

Electrical Characteristics

| Part Number | Inductance (nH) | Tolerance (±%) | Test Frequency (MHz) | Q Typ. | Test Frequency (MHz) | SRF (GHz) Typ. | RDC (Ω) Max | Irms (mA) Max | Color Code |
|--------------------|-----------------|----------------|----------------------|--------|----------------------|----------------|-------------|---------------|------------|
| BWHH001611083N3□00 | 3.3 | 5 / 3 | 250 | 36 | 250 | 9.6 | 0.034 | 1900 | Black |
| BWHH001611083N6□00 | 3.6 | 5 / 3 | 250 | 28 | 250 | 9.7 | 0.040 | 1900 | Brown |
| BWHH001611085N1□00 | 5.1 | 5 / 3 | 250 | 38 | 250 | 8.9 | 0.042 | 1700 | Red |
| BWHH001611085N6□00 | 5.6 | 5 / 3 | 250 | 35 | 250 | 6.6 | 0.042 | 1700 | Orange |
| BWHH001611086N0□00 | 6.0 | 5 / 3 | 250 | 49 | 250 | 6.0 | 0.042 | 1700 | Yellow |
| BWHH001611088N2□00 | 8.2 | 5 / 3 | 250 | 40 | 250 | 5.9 | 0.054 | 1400 | Green |
| BWHH001611088N7□00 | 8.7 | 5 / 3 | 250 | 46 | 250 | 5.5 | 0.054 | 1400 | Blue |
| BWHH001611089N1□00 | 9.1 | 5 / 3 | 250 | 40 | 250 | 5.1 | 0.052 | 1400 | Violet |
| BWHH001611089N5□00 | 9.5 | 5 / 3 | 250 | 42 | 250 | 4.9 | 0.054 | 1400 | Gray |
| BWHH0016110810N□00 | 10 | 5 / 3 | 250 | 44 | 250 | 4.3 | 0.054 | 1400 | White |
| BWHH0016110812N□00 | 12 | 5 / 3 | 250 | 40 | 250 | 4.1 | 0.088 | 1100 | Black |
| BWHH0016110818N□00 | 18 | 5 / 3 | 250 | 45 | 250 | 3.3 | 0.082 | 1200 | Brown |

Note: When ordering, please specify tolerance code. Tolerance : H=±3% , J=±5%

- Operating temperature range—40°C ~ 125°C (Including self - temperature rise)
- I_{rms} for a 15°C temperature rise from 25°C ambient with current
- Measure Equipment :
 L & Q : Agilent E4991A+Agilent HP16197A
 SRF : Agilent E5071C
 RDC : Chroma 16502
 I_{rms} : HP4284A+HP42841A/HP4285A+HP42841A

Typical **L** vs. **F** Frequency

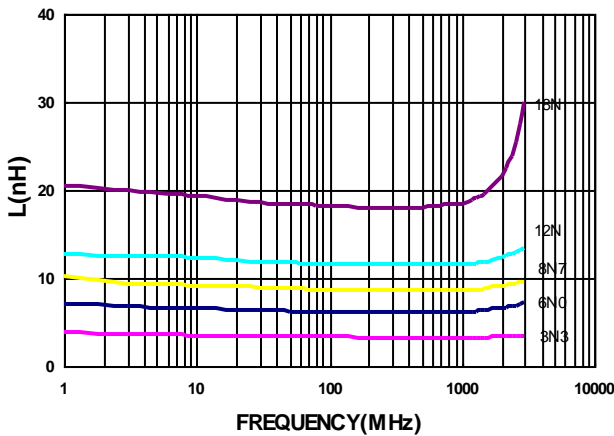

Typical **Q** vs. **F** Frequency

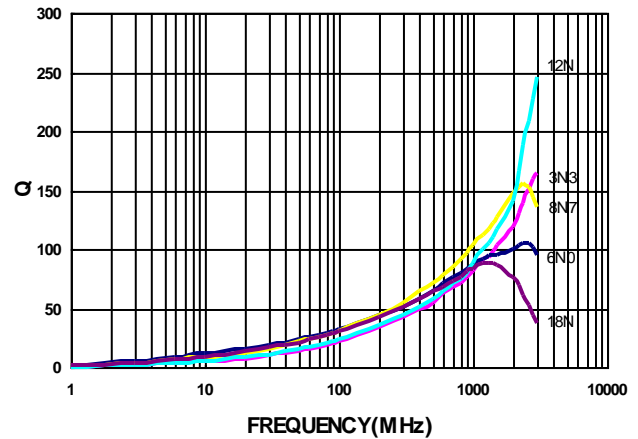

SMD Wire Wound Ceramic Chip Inductors - BWHH Series

Packaging Specifications

Tape Dimensions

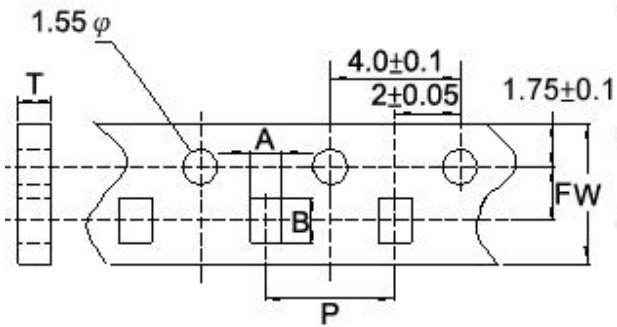

Tape Material

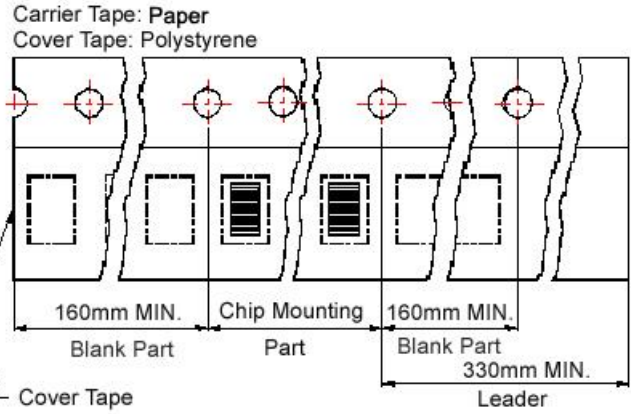

Reel Dimensions

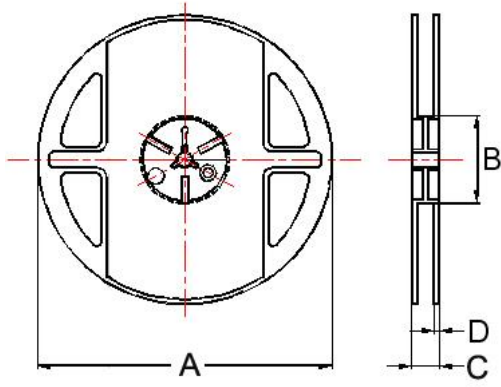

Dimensions in mm

| TYPE | Tape Dimensions | | | | | | Reel Dimensions | | | | Quantity PCS / Reel |
|--------------|-----------------|------|------|---|---|-----|-----------------|----|----|-----|------------------------|
| | A | B | T | W | P | F | A | B | C | D | |
| BWHH00161108 | 1.25 | 1.90 | 1.05 | 8 | 4 | 3.5 | 178 | 60 | 12 | 1.5 | 4000 |