

### Flange, 482.6 mm (19")



To fit all Ripac Vario, Ripac Vario EMC, Ripac Compact and Ripac Vario Mobile subracks. With integral channel to accommodate EMC gaskets.

**Material:**  
Extruded aluminum section

**Surface finish:**  
Clear-chromated

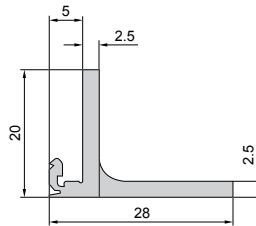
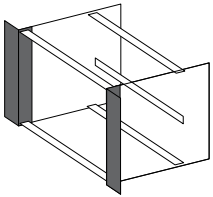

U	Packs of	Order No.	
		with handle holes	without handle holes
2	1	–	<b>3684.614</b>
3	1	<b>3684.622</b>	<b>3684.615</b>
4	1	<b>3684.623</b>	<b>3684.616</b>
6	1	<b>3684.624</b>	<b>3684.617</b>
7	1	<b>3684.625</b>	<b>3684.618</b>
9	1	–	<b>3684.619</b>
10	1	–	<b>3684.620</b>
11	1	–	<b>3684.621</b>

#### + Accessories:

Handles for subrack,  
see page 104  
EMC gaskets, vertical,  
see page 116

### Flange, 482.6 mm (19")



**Set-back**  
To fit all Ripac Vario, Ripac Vario EMC and Ripac Vario Mobile subracks.

**Material:**  
Extruded aluminum section

**Surface finish:**  
Clear-chromated

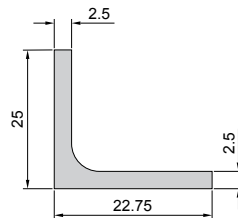
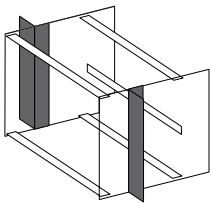

U	Packs of	Order No.
3	1	<b>3684.626</b>
4	1	<b>3684.627</b>
6	1	<b>3684.628</b>
7	1	<b>3684.629</b>
9	1	<b>3684.630</b>
10	1	<b>3684.631</b>
11	1	<b>3684.632</b>

#### ! Also required:

Assembly screws, nuts and washers,  
packs of 4 sets, order no. 3687.015,  
see page 165

### Side panels



#### For Ripac EASY

- Mounting holes on a 60 mm pitch pattern as long holes
- Drill holes for mounting telescopic slides

#### Material:

1.5 mm aluminum, noncorrosive

D mm	L2	n	n1	Packs of	Max. board depth mm	Order No.	
						3 U	6 U
175	–	–	–	2	160	<b>3634.695</b>	<b>3634.720</b>
235	60	–	–	2	220	<b>3634.700</b>	<b>3634.725</b>
295	60	2	2	2	280	<b>3634.705</b>	<b>3634.730</b>
355	60	3	3	2	340	<b>3634.710</b>	<b>3634.735</b>
415	60	4	3	2	400	<b>3634.715</b>	<b>3634.740</b>

#### + Accessories:

Flanges for Ripac EASY  
see page 104

- 1** Mounting holes suitable for threaded insert PEM-FM4-1

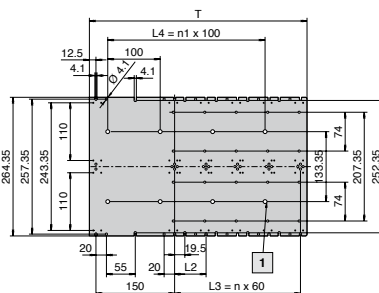
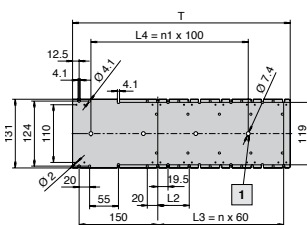

T = Depth