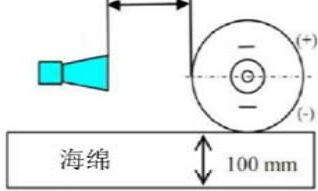

Quality Control Standard

出货品质标准

Valued customer 客户名称 :	Customer Product Name/No. (客户产品名称/编号):	打印机	
Model No 机种编号 :	Swatch No.: 样品编号	Date作成日: 2023/1/17	Rev.
Our Code No. 仕样编号 :	(Please Use Our Code No. To Order) (订货时请用此仕样编号)	Rev. Date修订日:	
RS645-ST-3255	EOA231-0013		
RS645-ST-00002A		备注	ROHS
陈礼云2023.02.01			

1. Conditions of Standard Operation / 工作条件

1- 1)Driving Voltage 驱动电压	: 18 V	DC Constant between motor terminals. 马达端子电压 18 V 直流恒压。	
1- 2)Direction of Rotation 回转方向	: CCW	viewing from metal housing. 面对马达金属外壳时。	
1- 3)Position of Motor 马达放置状态	: To be placed horizontally when measuring. 测试时水平放置。		
1- 4)Operating Temperature工作温度	: -10 °C to 60 °C		噪音测试示意图 
1- 5)Operating Humidity工作湿度	: 30%RH to 95%RH		

2. Conditions of Standard Test / 测试条件

2- 1)Testing Temperature测试温度	: 10°C to 30°C		
2- 2)Testing Humidity测试湿度	: 30%RH to 95%RH		

3. Initial Electrical Characteristics / 初期特性

3- 1) No Load Speed 无负荷转速	: 8200 ± 1200 rpm		
	: 8200 ± 1200 转/分		
3- 2) No Load Current 无负荷电流	: 280 mA max.		
	: 最大 280 毫安培		
3- 3) Stall Torque 堵转扭力	At Load 13.0 & 82.0 mNm	: 162 mNm min.	
	在负载点 13.0 & 82.0 mNm	: 最小 162 mNm	
3- 4) Stall Current 堵转电流		: 14.4 A max.	
		: 最大 14.4 安培	
3- 5) Mechanical Noise(vertical from housing side 30 cm Background noise 30dB Max) 机械噪音(距离铁壳侧 30 cm, 环境噪音30dB Max)	: 65	dB Or below(RMS)JIS-A Characteristics dB 以下(RMS)JIS-A特性	
3- 6) Reference Performance Curve 参考性能曲线	: As per attached Sheet : 所附图表为	RS645-ST-3255 RS645-ST-3255	
3- 7) Dimensions 外形尺寸	: As per Drawing attached : 所附图面为	WG- R645T-Y05 WG- R645T-Y05	
3- 8) End play of Shaft 虚位	: 0.05 ~ 0.50 mm		
	: 0.05 ~ 0.50 毫米		

For & on behalf of Customer

For & on behalf of Standard Motor Co., Ltd.

Jack Lee 2023/01/17



As a reminder, the specification should be signed and returned within two weeks, or it will be considered as acceptable by the customer. 如果客户两周内不签字确认并返回, 将被视为已认可此规格。

性能表只供参考
马达实际参数请以马达出货标准为主



STANDARD MOTOR 標準微型摩打有限公司

两点法: 132.6 g.cm & 836.2 g.cm

Model/Winding 型号/卷线	Voltage 电压 V	No Load 无负荷		At Maximum Efficiency 最大效率点				At Maximum Output 最大功率点				Stall 停止	
		Current 电流 A	Speed 转速 rpm	Current 电流 A	Speed 转速 rpm	Torque 扭矩 g.cm	Efficiency 效率 %	Current 电流 A	Speed 转速 rpm	Torque 扭矩 g.cm	Output 功率 W	Current 电流 A	Torque 扭矩 g.cm
RS645-ST-3255	18.0	0.214	8176	1.547	7182	271.2	71.7	5.696	4088	1115.5	46.77	11.179	2231.0

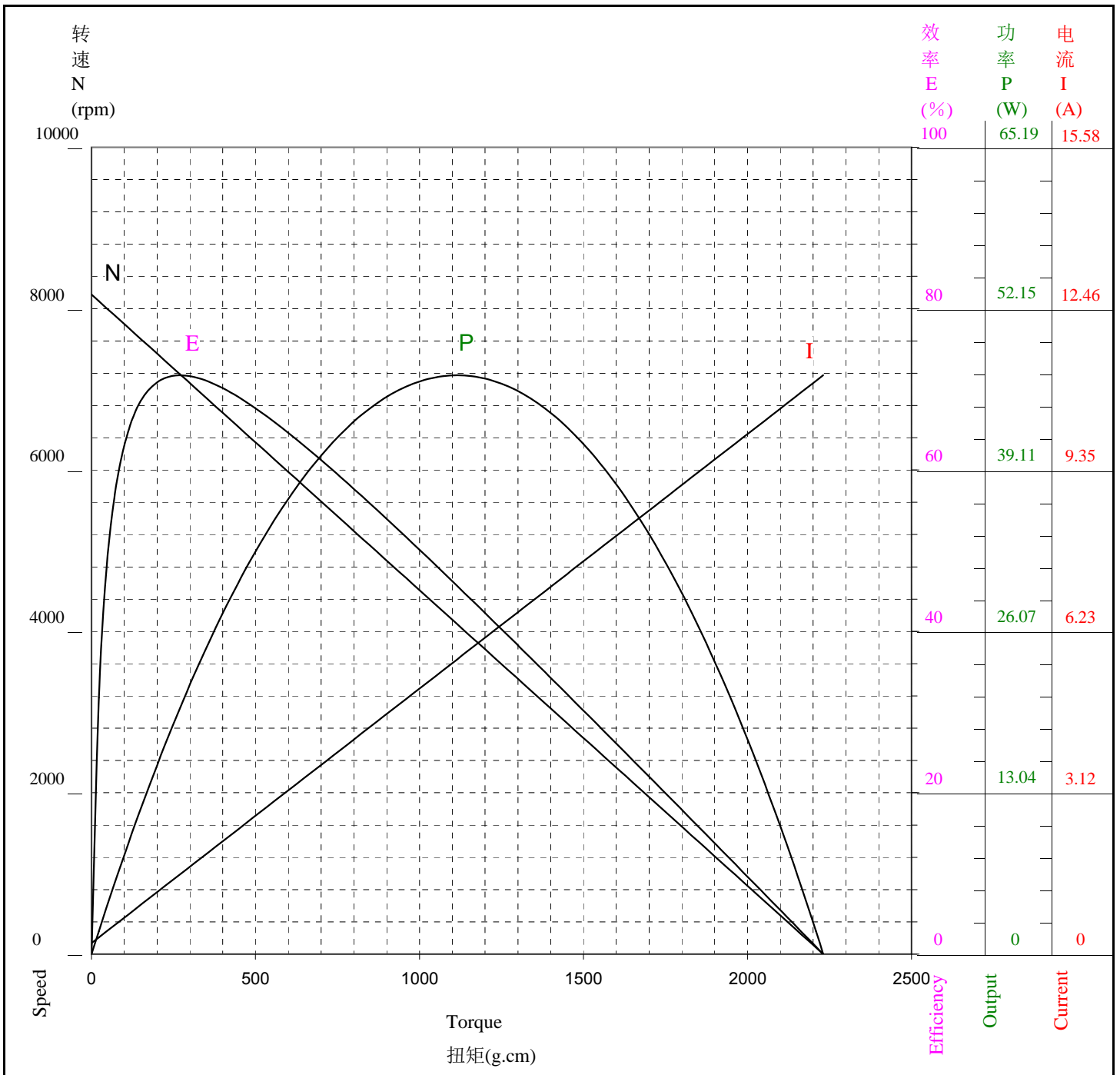

MARK	POSITION	DESCRIPTION	DATE	BY

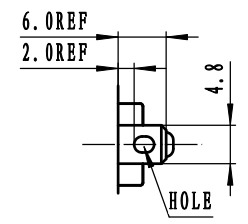
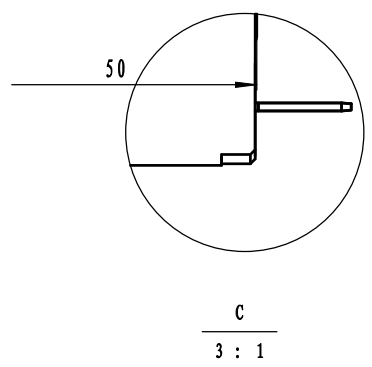
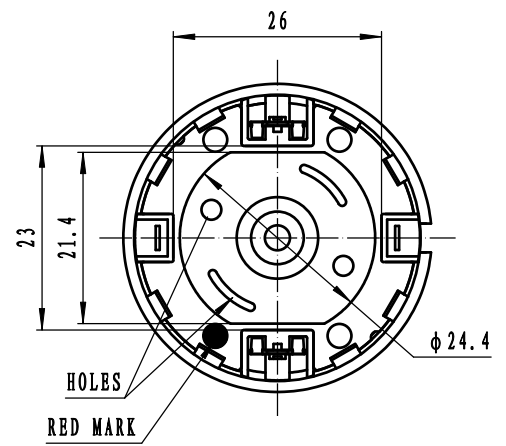
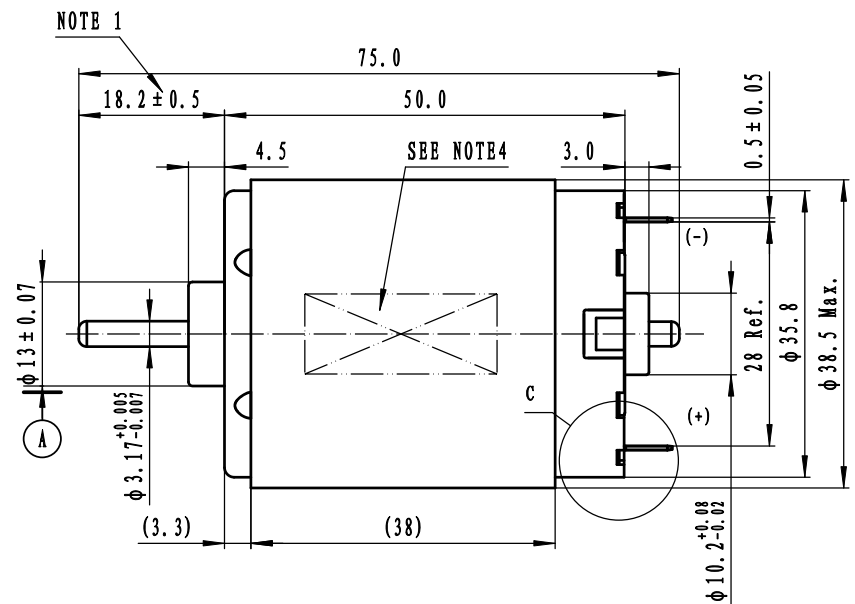
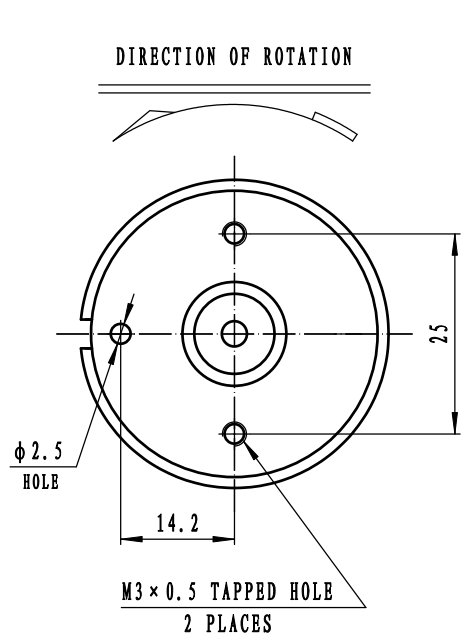

- NOTES (备注):
- THIS DIM APPLIES ONLY WHEN MOTOR SHAFT IS IN EXTREME LEFT POSITION
该尺寸适用于将轴压于左侧时
 - SHAFT END PLAY 0.05 ~ 0.5mm
马达虚位(轴向串动) 0.05 ~ 0.5mm
 - USABLE MACHINE SCREW LENGTH 4.0mm MAX.
FROM MOTOR MOUNTING SURFACE
从大壳外端面开始, 可用螺钉长度4.0mm MAX
 - SPECIFIED CONTENT WILL BE TYPBGRAPHICALED
IN CONFORMITY TO GETUP BOOK OF MOTOR
按马达仕样书印刷指定内容

Characteristic	DWN. BY	Li Jiang	DWN. DATE	19.01.19	TITLE	Motor Outline Drawing
Cpk > 1.33	CHK. BY		CHK. DATE		DWG. No.	WG-R645T-Y05
Quality control	APP. BY		APP. DATE		Undeclared tolerance	± 0.3 Angle tolerance $\pm 3^\circ$
Not mark Not required	SCALE	STANDARD MOTOR 标准微型马达有限公司	SCALE	1.5:1	Rev.	- A3