

Bore for socket cap screw
#10 / 1/4" or
DIN 912-M5 / M6

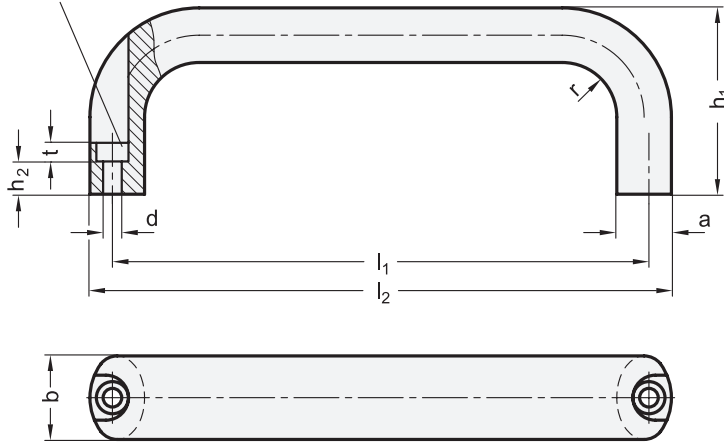

Universal table

Dimensions in: millimeters - inches

b	l ₁ ±0.25	a	d	h ₁	h ₂	l ₂	r	t
20 .79	100 3.94	13 .51	5.4 .21	49 1.93	13.5 .53	112 4.41	13 .51	5.5 .22
20 .79	112 4.41	13 .51	5.4 .21	49 1.93	13.5 .53	124 4.88	13 .51	5.5 .22
20 .79	120 4.72	13 .51	5.4 .21	51 2.01	13.5 .53	132 5.20	13 .51	5.5 .22
20 .79	128 5.04	13 .51	5.4 .21	51 2.01	13.5 .53	140 5.51	13 .51	5.5 .22
20 .79	160 6.30	13 .51	5.4 .21	51 2.01	13.5 .53	172 6.77	13 .51	5.5 .22
26 1.02	116 4.57	17 .67	6.4 .25	55 2.17	11 .43	130 5.12	17 .67	6 .24
26 1.02	120 4.72	17 .67	6.4 .25	55 2.17	11 .43	134 5.28	17 .67	6 .24
26 1.02	132 5.20	17 .67	6.4 .25	55 2.17	11 .43	146 5.75	17 .67	6 .24
26 1.02	164 6.46	17 .67	6.4 .25	57 2.24	11 .43	178 7.01	17 .67	6 .24
26 1.02	179 7.05	17 .67	6.4 .25	57 2.24	11 .43	193 7.60	17 .67	6 .24
26 1.02	196 7.72	17 .67	6.4 .25	57 2.24	11 .43	210 8.27	17 .67	6 .24

Specification

- Aluminum
 - Powder coated
 - Black, RAL 9005, textured finish **SW**
 - Black, RAL 9005, textured finish, UV-resistant **SWU**
 - Red, RAL 3000, textured finish **RS**
 - Silver, RAL 9006, textured finish **SR**
 - Anodized finish, natural color **EL**
 - Blank, tumbled finish **BL**
- Mounting holes
 - Counterbored for inch or metric socket cap screws
- RoHS compliant

Information

GN 565.1 cabinet "U" handles are manufactured from a bent aluminum profile and have excellent stability and ergonomic design. The manufacturing process allows the production of special designs (especially extra long versions) in relatively small quantities.

In addition to the standard finishes, these cabinet "U" handles are also available with a functional coating: The **SWU** version is coated with a highly weather-resistant and UV-protective powder coating system, making this version excellent for outdoor use.

On request

- Special designs
- Various inch and metric size fasteners and kit packaging

How to order GN 565.1-26-132-SW	1	Handle width b
	2	Length l ₁
	3	Finish