

PART NUMBERS	CKT SIZE	VOID POSITION	DIMENSION		PACKAGING TYPE
			A	B	
87759-0028	20	----	19.90	18.00	WITHOUT CAP IN TUBE
87759-0029	20	----	19.90	18.00	WITH CAP IN TUBE
87759-0030	20	----	19.90	18.00	WITH CAP IN TAPE & REEL

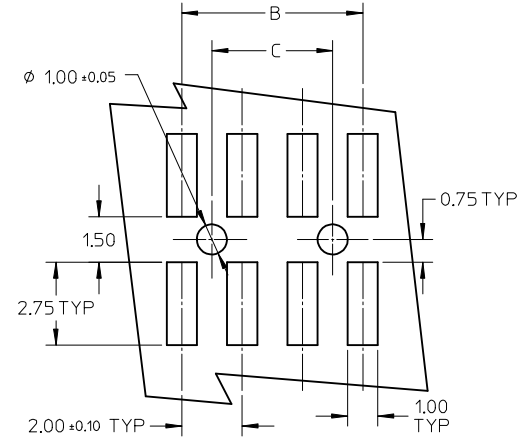

RECOMMENDED PCB PATTERN

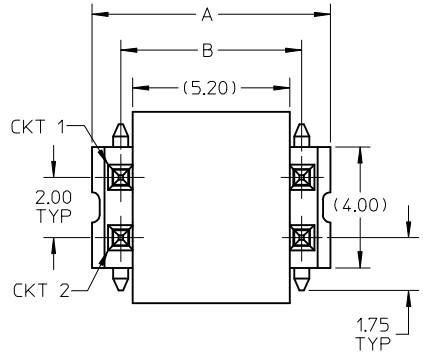
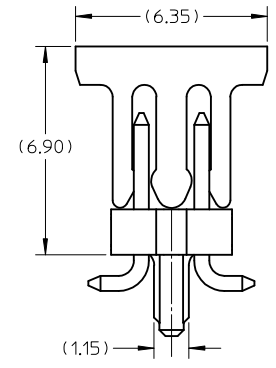
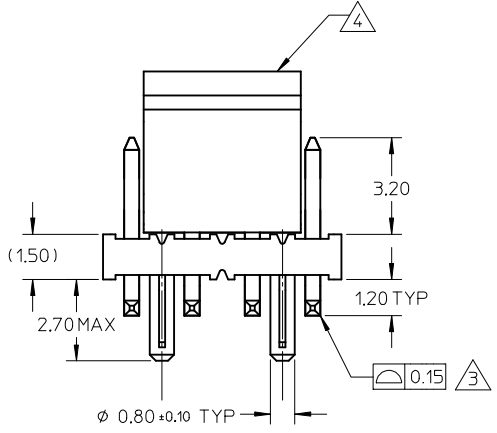

NOTES:

- MATERIAL: HOUSING: NYLON (4/6), 30% G.F., UL94V-0, COLOR: BLACK  
PIN: COPPER ALLOY, SQ, 0.5mm
- PLATING FINISH: 154n MIN GOLD PLATE IN SELECTED AREA AND 754n MIN TIN ON SOLDER TAIL OVER 504n MIN NICKEL UNDERPLATE OVERALL.
- COPLANARITY IS TO BE MEASURED BY RESTING THE SOLDER TAIL ON A FLAT SURFACE
- CAP TO BE LOCATED AS CENTRAL OF PART AS POSSIBLE
- TUBE LENGTH : 560mm REF.
- THE ABOVE 8CKTS SHOWN IS FOR ILLUSTRATION ONLY.
- PRODUCT SPECIFICATION: PS-87761-100

REVISED EC NO: S2007-0829 DRW:SKL IM01 CHKD: CWLAM APPR: KWLEE	REV DESCRIPTION	2007/04/10	2007/04/12	2007/04/17	QUALITY SYMBOLS ▽=0 ◻=0	GENERAL TOLERANCES (UNLESS SPECIFIED)		DIMENSION STYLE MM ONLY	SCALE NTS	DESIGN UNITS METRIC	THIRD ANGLE PROJECTION				
							mm	INCH	DRAWN BY KCHO	DATE 2004/08/23	TITLE CUSTOM HEADER MGRID, 2.00MM PITCH, HDR DUAL ROW S/W W/PEG, SMT				
							4 PLACES ± --- ± ---	3 PLACES ± --- ± ---	2 PLACES ± 0.20 ± ---	1 PLACE ± --- ± ---	CHECKED BY PTLIM	DATE 2004/08/24	APPROVED BY SCLOW		DATE 2004/08/25
							ANGULAR ± 3 °		DRAFT WHERE APPLICABLE MUST REMAIN WITHIN DIMENSIONS		MATERIAL NO. SEE TABLE	DOCUMENT NO. SD-87759-226	SHEET NO. 1 OF 2		

PART NUMBERS WITH CAP IN TAPE & REEL	CKT SIZE	F	Bo	So	W
87759-0030	20	20.20	20.50	40.40	44.00

WITH CAP IN TAPE & REEL PACKAGING

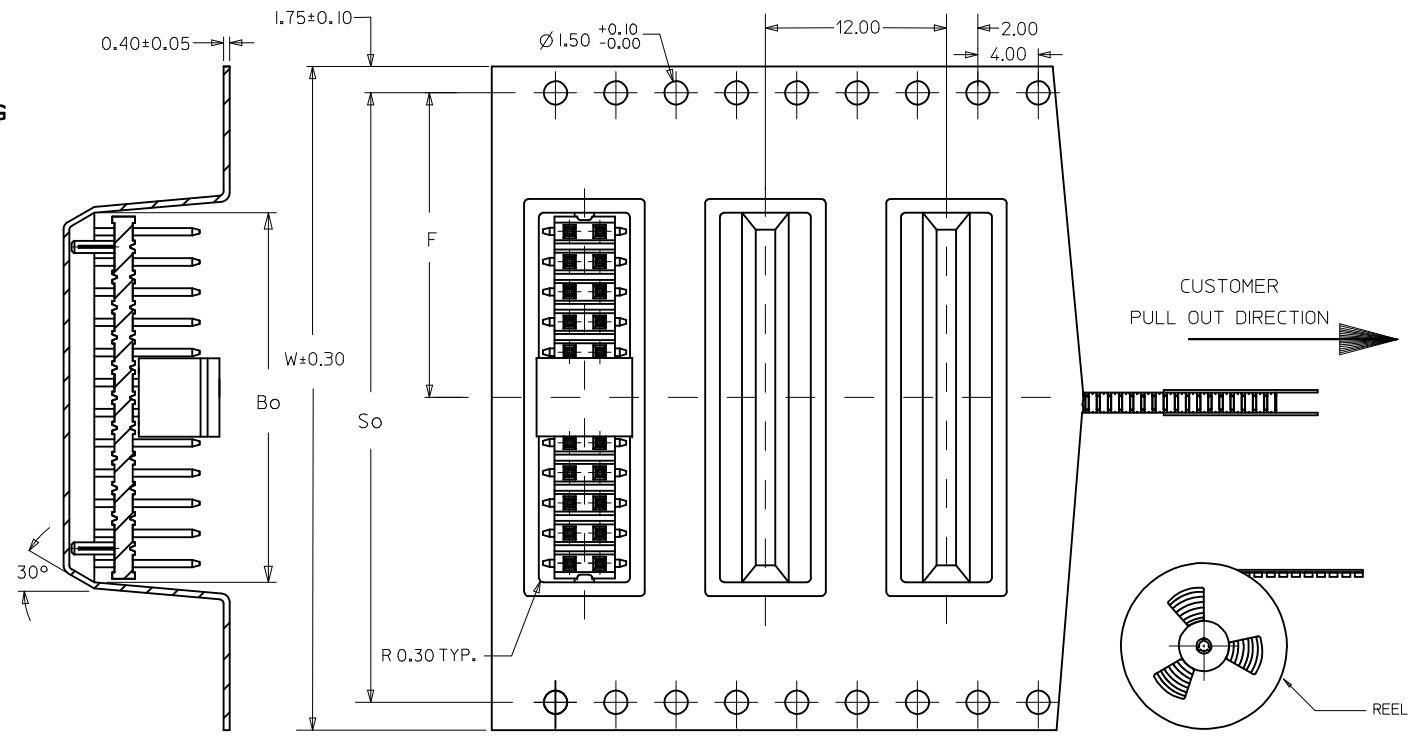

NOTES:

1. LEADER AND TRAILER TAPE

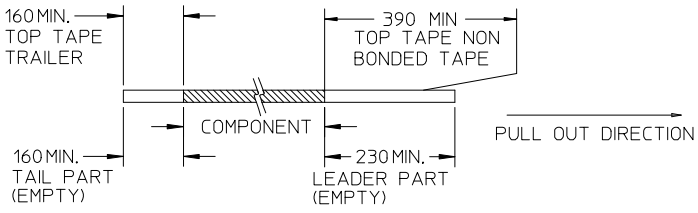

2. PEELING OFF FORCE OF THE TOP TAPE: 20-80gf. (PEELING DIRECTION AS SHOWN IN FOLLOWING FIGURE)

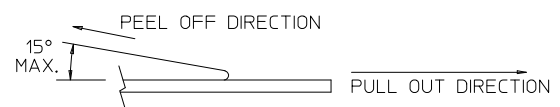

- 3. TAPE AND REEL SPECIFICATION IS AS PER EIA-481.
- 4. TAPE AND REEL QUANTITY : 500PCS/ REEL.
- 5. THE TAPE IS TREATED FOR ANTI-STATIC.

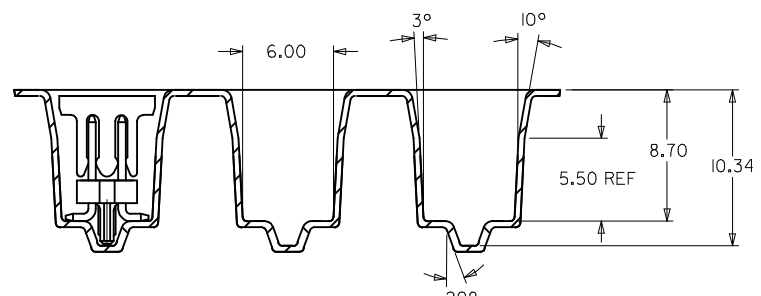

REVISED EC NO: S2007-0829 DRWN: SKL/IM01 CHKD: CWL/M APPR: KWLEE 2007/04/10 2007/04/12 2007/04/17	QUALITY SYMBOLS	GENERAL TOLERANCES (UNLESS SPECIFIED)	DIMENSION STYLE	SCALE	DESIGN UNITS	THIRD ANGLE PROJECTION																								
	$\nabla = 0$ $\square = 0$	<table border="1"> <thead> <tr> <th></th> <th>mm</th> <th>INCH</th> </tr> </thead> <tbody> <tr> <td>4 PLACES</td> <td>± ---</td> <td>± ---</td> </tr> <tr> <td>3 PLACES</td> <td>± ---</td> <td>± ---</td> </tr> <tr> <td>2 PLACES</td> <td>± 0.20</td> <td>± ---</td> </tr> <tr> <td>1 PLACE</td> <td>± ---</td> <td>± ---</td> </tr> </tbody> </table>		mm	INCH	4 PLACES	± ---	± ---	3 PLACES	± ---	± ---	2 PLACES	± 0.20	± ---	1 PLACE	± ---	± ---	MM ONLY	NTS	METRIC										
		mm	INCH																											
	4 PLACES	± ---	± ---																											
3 PLACES	± ---	± ---																												
2 PLACES	± 0.20	± ---																												
1 PLACE	± ---	± ---																												
DESCRIPTION	<table border="1"> <thead> <tr> <th>DRAWN BY</th> <th>DATE</th> <th>TITLE</th> </tr> </thead> <tbody> <tr> <td>KCHO</td> <td>2004/08/23</td> <td>CUSTOM HEADER</td> </tr> <tr> <th>CHECKED BY</th> <th>DATE</th> <th></th> </tr> <tr> <td>PTLIM</td> <td>2004/08/24</td> <td>MGRID, 2.00MM PITCH, HDR</td> </tr> <tr> <th>APPROVED BY</th> <th>DATE</th> <th></th> </tr> <tr> <td>SCLOW</td> <td>2004/08/25</td> <td>DUAL ROW S/W W/PEG, SMT</td> </tr> </tbody> </table>	DRAWN BY	DATE	TITLE	KCHO	2004/08/23	CUSTOM HEADER	CHECKED BY	DATE		PTLIM	2004/08/24	MGRID, 2.00MM PITCH, HDR	APPROVED BY	DATE		SCLOW	2004/08/25	DUAL ROW S/W W/PEG, SMT	<table border="1"> <tr> <td>MATERIAL NO.</td> <td>DOCUMENT NO.</td> </tr> <tr> <td>SEE TABLE</td> <td>SD-87759-226</td> </tr> </table>	MATERIAL NO.	DOCUMENT NO.	SEE TABLE	SD-87759-226	<table border="1"> <tr> <td colspan="2">MOLEX INCORPORATED</td> </tr> <tr> <td>SHEET NO.</td> <td>2 OF 2</td> </tr> </table>		MOLEX INCORPORATED		SHEET NO.	2 OF 2
DRAWN BY	DATE	TITLE																												
KCHO	2004/08/23	CUSTOM HEADER																												
CHECKED BY	DATE																													
PTLIM	2004/08/24	MGRID, 2.00MM PITCH, HDR																												
APPROVED BY	DATE																													
SCLOW	2004/08/25	DUAL ROW S/W W/PEG, SMT																												
MATERIAL NO.	DOCUMENT NO.																													
SEE TABLE	SD-87759-226																													
MOLEX INCORPORATED																														
SHEET NO.	2 OF 2																													
B	DRAFT WHERE APPLICABLE MUST REMAIN WITHIN DIMENSIONS	SIZE A3 THIS DRAWING CONTAINS INFORMATION THAT IS PROPRIETARY TO MOLEX INCORPORATED AND SHOULD NOT BE USED WITHOUT WRITTEN PERMISSION																												