

1.00mm CENTER FLAT FLEX CABLE (FFC) (105°C, Au PLATING)

| "L" DIM. →   | 30 ± 2 MM   |           | 51 ± 2 MM  |           | 76 ± 3 MM  |           | 102 ± 3 MM |           | 127 ± 4 MM |           | 152 ± 4 MM |           | 178 ± 4 MM |           | 203 ± 4 MM |           | 229 ± 5 MM |           | 254 ± 5 MM  |           | 305 ± 5 MM  |           |
|--------------|-------------|-----------|------------|-----------|------------|-----------|------------|-----------|------------|-----------|------------|-----------|------------|-----------|------------|-----------|------------|-----------|-------------|-----------|-------------|-----------|
| REF DIM →    | (1.18 INCH) |           | (2 INCHES) |           | (3 INCHES) |           | (4 INCHES) |           | (5 INCHES) |           | (6 INCHES) |           | (7 INCHES) |           | (8 INCHES) |           | (9 INCHES) |           | (10 INCHES) |           | (12 INCHES) |           |
| CABLE TYPE → | A           | D         | A          | D         | A          | D         | A          | D         | A          | D         | A          | D         | A          | D         | A          | D         | A          | D         | A           | D         | A           | D         |
| CIRCUITS ↓   |             |           |            |           |            |           |            |           |            |           |            |           |            |           |            |           |            |           |             |           |             |           |
| 4            | 150390701   | 150390700 | 150390703  | 150390702 | 150390705  | 150390704 | 150390707  | 150390706 | 150390709  | 150390708 | 150390711  | 150390710 | 150390713  | 150390712 | 150390715  | 150390714 | 150390717  | 150390716 | 150390719   | 150390718 | 150390721   | 150390720 |
| 6            | 150390201   | 150390202 | 150390203  | 150390204 | 150390205  | 150390206 | 150390207  | 150390208 | 150390209  | 150390210 | 150390211  | 150390212 | 150390213  | 150390214 | 150390215  | 150390216 | 150390217  | 150390218 | 150390219   | 150390220 | 150390221   | 150390222 |
| 8            | 150390223   | 150390224 | 150390225  | 150390226 | 150390227  | 150390228 | 150390229  | 150390230 | 150390231  | 150390232 | 150390233  | 150390234 | 150390235  | 150390236 | 150390237  | 150390238 | 150390239  | 150390240 | 150390241   | 150390242 | 150390243   | 150390244 |
| 10           | 150390245   | 150390246 | 150390247  | 150390248 | 150390249  | 150390250 | 150390251  | 150390252 | 150390253  | 150390254 | 150390255  | 150390256 | 150390257  | 150390258 | 150390259  | 150390260 | 150390261  | 150390262 | 150390263   | 150390264 | 150390265   | 150390266 |
| 12           | 150390267   | 150390268 | 150390269  | 150390270 | 150390271  | 150390272 | 150390273  | 150390274 | 150390275  | 150390276 | 150390277  | 150390278 | 150390279  | 150390280 | 150390281  | 150390282 | 150390283  | 150390284 | 150390285   | 150390286 | 150390287   | 150390288 |
| 14           | 150390289   | 150390290 | 150390291  | 150390292 | 150390293  | 150390294 | 150390295  | 150390296 | 150390297  | 150390298 | 150390299  | 150390300 | 150390301  | 150390302 | 150390303  | 150390304 | 150390305  | 150390306 | 150390307   | 150390308 | 150390309   | 150390310 |
| 16           | 150390311   | 150390312 | 150390313  | 150390314 | 150390315  | 150390316 | 150390317  | 150390318 | 150390319  | 150390320 | 150390321  | 150390322 | 150390323  | 150390324 | 150390325  | 150390326 | 150390327  | 150390328 | 150390329   | 150390330 | 150390331   | 150390332 |
| 18           | 150390333   | 150390334 | 150390335  | 150390336 | 150390337  | 150390338 | 150390339  | 150390340 | 150390341  | 150390342 | 150390343  | 150390344 | 150390345  | 150390346 | 150390347  | 150390348 | 150390349  | 150390350 | 150390351   | 150390352 | 150390353   | 150390354 |
| 20           | 150390355   | 150390356 | 150390357  | 150390358 | 150390359  | 150390360 | 150390361  | 150390362 | 150390363  | 150390364 | 150390365  | 150390366 | 150390367  | 150390368 | 150390369  | 150390370 | 150390371  | 150390372 | 150390373   | 150390374 | 150390375   | 150390376 |
| 22           | 150390377   | 150390378 | 150390379  | 150390380 | 150390381  | 150390382 | 150390383  | 150390384 | 150390385  | 150390386 | 150390387  | 150390388 | 150390389  | 150390390 | 150390391  | 150390392 | 150390393  | 150390394 | 150390395   | 150390396 | 150390397   | 150390398 |
| 24           | 150390399   | 150390400 | 150390401  | 150390402 | 150390403  | 150390404 | 150390405  | 150390406 | 150390407  | 150390408 | 150390409  | 150390410 | 150390411  | 150390412 | 150390413  | 150390414 | 150390415  | 150390416 | 150390417   | 150390418 | 150390419   | 150390420 |
| 26           | 150390421   | 150390422 | 150390423  | 150390424 | 150390425  | 150390426 | 150390427  | 150390428 | 150390429  | 150390430 | 150390431  | 150390432 | 150390433  | 150390434 | 150390435  | 150390436 | 150390437  | 150390438 | 150390439   | 150390440 | 150390441   | 150390442 |
| 28           | 150390443   | 150390444 | 150390445  | 150390446 | 150390447  | 150390448 | 150390449  | 150390450 | 150390451  | 150390452 | 150390453  | 150390454 | 150390455  | 150390456 | 150390457  | 150390458 | 150390459  | 150390460 | 150390461   | 150390462 | 150390463   | 150390464 |
| 30           | 150390465   | 150390466 | 150390467  | 150390468 | 150390469  | 150390470 | 150390471  | 150390472 | 150390473  | 150390474 | 150390475  | 150390476 | 150390477  | 150390478 | 150390479  | 150390480 | 150390481  | 150390482 | 150390483   | 150390484 | 150390485   | 150390486 |
| 32           | 150390487   | 150390488 | 150390489  | 150390490 | 150390491  | 150390492 | 150390493  | 150390494 | 150390495  | 150390496 | 150390497  | 150390498 | 150390499  | 150390500 | 150390501  | 150390502 | 150390503  | 150390504 | 150390505   | 150390506 | 150390507   | 150390508 |
| 34           | 150390509   | 150390510 | 150390511  | 150390512 | 150390513  | 150390514 | 150390515  | 150390516 | 150390517  | 150390518 | 150390519  | 150390520 | 150390521  | 150390522 | 150390523  | 150390524 | 150390525  | 150390526 | 150390527   | 150390528 | 150390529   | 150390530 |
| 36           | 150390531   | 150390532 | 150390533  | 150390534 | 150390535  | 150390536 | 150390537  | 150390538 | 150390539  | 150390540 | 150390541  | 150390542 | 150390543  | 150390544 | 150390545  | 150390546 | 150390547  | 150390548 | 150390549   | 150390550 | 150390551   | 150390552 |
| 38           | 150390553   | 150390554 | 150390555  | 150390556 | 150390557  | 150390558 | 150390559  | 150390560 | 150390561  | 150390562 | 150390563  | 150390564 | 150390565  | 150390566 | 150390567  | 150390568 | 150390569  | 150390570 | 150390571   | 150390572 | 150390573   | 150390574 |
| 40           | 150390575   | 150390576 | 150390577  | 150390578 | 150390579  | 150390580 | 150390581  | 150390582 | 150390583  | 150390584 | 150390585  | 150390586 | 150390587  | 150390588 | 150390589  | 150390590 | 150390591  | 150390592 | 150390593   | 150390594 | 150390595   | 150390596 |

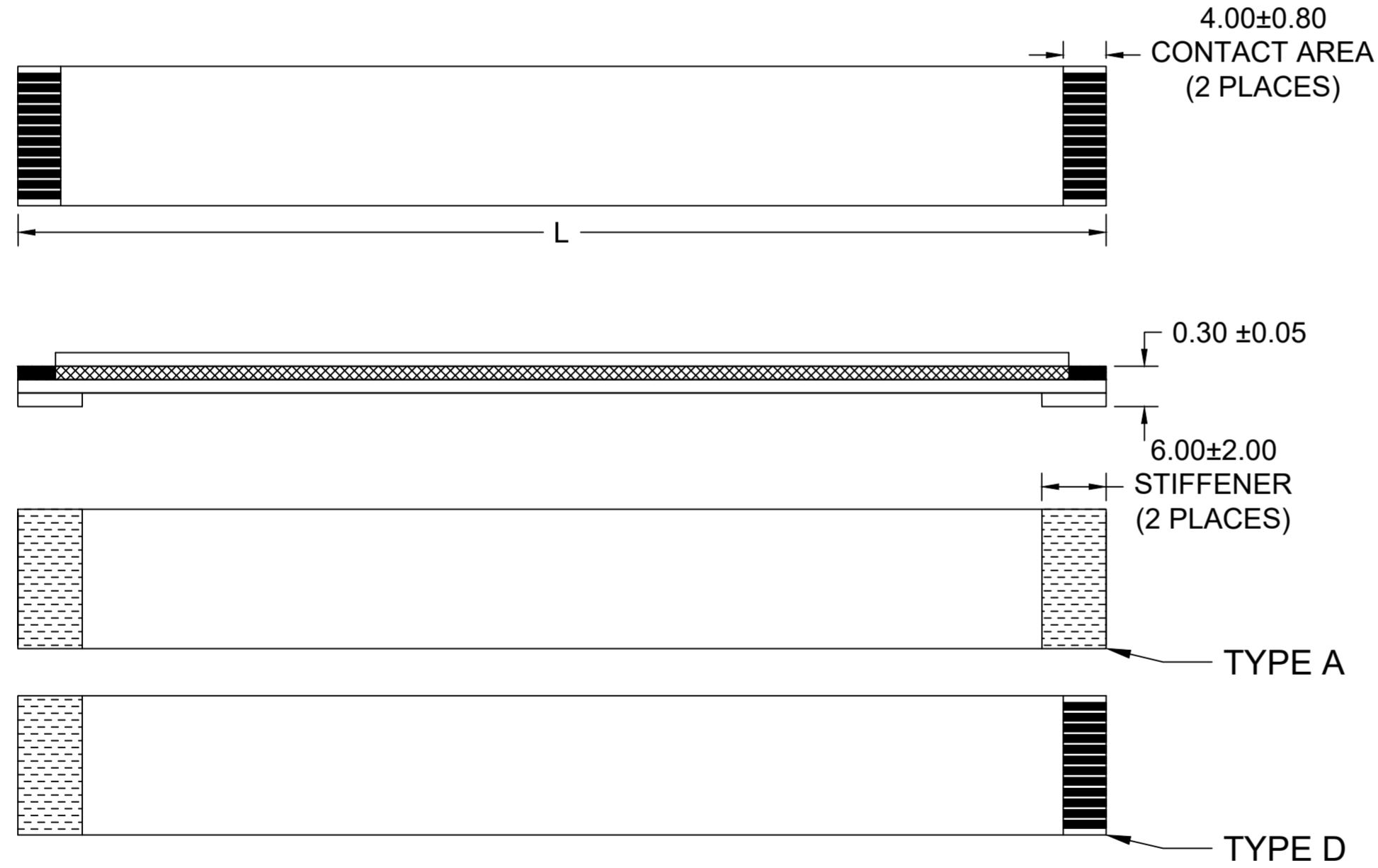

- NOTES:**
- NO PRINTING ON JUMPER CABLE UNLESS OTHERWISE SPECIFIED. IF PRINTING IS REQUIRED, THEN IT WOULD BE CONSIDERED A SPECIAL JUMPER CABLE.
  - FOR ODD CIRCUIT COUNT, CROSS-SECTION AND END-TAIL DETAIL REFER TO SHEET # 2

THIS DRAWING CONTAINS INFORMATION THAT IS PROPRIETARY TO MOLEX ELECTRONIC TECHNOLOGIES, LLC AND SHOULD NOT BE USED WITHOUT WRITTEN PERMISSION

|  |       |                                      |                   |               |            |
|--|-------|--------------------------------------|-------------------|---------------|------------|
| DIMENSION UNITS                                      | SCALE | CURRENT REV DESC: DRAWING CORRECTION |                   |               |            |
| MM   | 2:1   |                                      |                   |               |            |
| GENERAL TOLERANCES (UNLESS SPECIFIED)                |       |                                      |                   |               |            |
|  | mm    | INCH                                 | EC NO: 728054     | DRWN: DIEGOG7 | 2022/11/10 |
| 4 PLACES   | ±---- | ±----                                | CHK'D: JSMITH11   | 2022/11/14    |            |
| 3 PLACES   | ±---- | ±----                                | APPR: JSMITH11    | 2022/11/14    |            |
| 2 PLACES   | ±---- | ±----                                | INITIAL REVISION: |               |            |
| 1 PLACE  | ±---- | ±----                                | DRWN: DIEGOG7     | 2022/06/01    |            |
| 0 PLACES   | ±---- | ±----                                | APPR: JSMITH11    | 2022/11/03    |            |
| ANGULAR TOL ± 0.5 °                                  |       | THIRD ANGLE PROJECTION               |                   | DRAWING       | SERIES     |
| DRAFT WHERE APPLICABLE MUST REMAIN WITHIN DIMENSIONS |       |                                      |                   | C-SIZE        | 15039      |
| DOCUMENT NUMBER                                      |       |                                      | DOC TYPE          | DOC PART      | REVISION   |
| 150390001  |       |                                      | PSD               | 000           | B          |
| MATERIAL NUMBER                                      |       | CUSTOMER                             |                   | SHEET NUMBER  |            |
| SEE CHART  |       | GENERAL MARKET                       |                   | 1 OF 2        |            |

1.00mm CENTER FLAT FLEX CABLE (FFC) (105°C, Au PLATING)

| "L" DIM. →   | 30 ± 2 MM   |           | 51 ± 2 MM  |           | 76 ± 3 MM  |           | 102 ± 3 MM |           | 127 ± 4 MM |           | 152 ± 4 MM |           | 178 ± 4 MM |           | 203 ± 4 MM |           | 229 ± 5 MM |           | 254 ± 5 MM  |           | 305 ± 5 MM  |           |
|--------------|-------------|-----------|------------|-----------|------------|-----------|------------|-----------|------------|-----------|------------|-----------|------------|-----------|------------|-----------|------------|-----------|-------------|-----------|-------------|-----------|
| REF DIM →    | (1.18 INCH) |           | (2 INCHES) |           | (3 INCHES) |           | (4 INCHES) |           | (5 INCHES) |           | (6 INCHES) |           | (7 INCHES) |           | (8 INCHES) |           | (9 INCHES) |           | (10 INCHES) |           | (12 INCHES) |           |
| CABLE TYPE → | A           | D         | A          | D         | A          | D         | A          | D         | A          | D         | A          | D         | A          | D         | A          | D         | A          | D         | A           | D         | A           | D         |
| CIRCUITS ↓   |             |           |            |           |            |           |            |           |            |           |            |           |            |           |            |           |            |           |             |           |             |           |
| 5            | 150390723   | 150390722 | 150390725  | 150390724 | 150390727  | 150390726 | 150390729  | 150390728 | 150390731  | 150390730 | 150390733  | 150390732 | 150390735  | 150390734 | 150390737  | 150390736 | 150390739  | 150390738 | 150390741   | 150390740 | 150390743   | 150390742 |
| 7            | 150390745   | 150390744 | 150390747  | 150390746 | 150390749  | 150390748 | 150390751  | 150390750 | 150390753  | 150390752 | 150390755  | 150390754 | 150390757  | 150390756 | 150390759  | 150390758 | 150390761  | 150390760 | 150390763   | 150390762 | 150390765   | 150390764 |
| 9            | 150390767   | 150390766 | 150390769  | 150390768 | 150390771  | 150390770 | 150390773  | 150390772 | 150390775  | 150390774 | 150390777  | 150390776 | 150390779  | 150390778 | 150390781  | 150390780 | 150390783  | 150390782 | 150390785   | 150390784 | 150390787   | 150390786 |
| 11           | 150390789   | 150390788 | 150390791  | 150390790 | 150390793  | 150390792 | 150390795  | 150390794 | 150390797  | 150390796 | 150390799  | 150390798 | 150390801  | 150390800 | 150390803  | 150390802 | 150390805  | 150390804 | 150390807   | 150390806 | 150390809   | 150390808 |
| 13           | 150390811   | 150390810 | 150390813  | 150390812 | 150390815  | 150390814 | 150390817  | 150390816 | 150390819  | 150390818 | 150390821  | 150390820 | 150390823  | 150390822 | 150390825  | 150390824 | 150390827  | 150390826 | 150390829   | 150390828 | 150390831   | 150390830 |
| 15           | 150390833   | 150390832 | 150390835  | 150390834 | 150390837  | 150390836 | 150390839  | 150390838 | 150390841  | 150390840 | 150390843  | 150390842 | 150390845  | 150390844 | 150390847  | 150390846 | 150390849  | 150390848 | 150390851   | 150390850 | 150390853   | 150390852 |
| 17           | 150390855   | 150390854 | 150390857  | 150390856 | 150390859  | 150390858 | 150390861  | 150390860 | 150390863  | 150390862 | 150390865  | 150390864 | 150390867  | 150390866 | 150390869  | 150390868 | 150390871  | 150390870 | 150390873   | 150390872 | 150390875   | 150390874 |
| 19           | 150390877   | 150390876 | 150390879  | 150390878 | 150390881  | 150390880 | 150390883  | 150390882 | 150390885  | 150390884 | 150390887  | 150390886 | 150390889  | 150390888 | 150390891  | 150390890 | 150390893  | 150390892 | 150390895   | 150390894 | 150390897   | 150390896 |
| 21           | 150390899   | 150390898 | 150390901  | 150390900 | 150390903  | 150390902 | 150390905  | 150390904 | 150390907  | 150390906 | 150390909  | 150390908 | 150390911  | 150390910 | 150390913  | 150390912 | 150390915  | 150390914 | 150390917   | 150390916 | 150390919   | 150390918 |
| 23           | 150390921   | 150390920 | 150390923  | 150390922 | 150390925  | 150390924 | 150390927  | 150390926 | 150390929  | 150390928 | 150390931  | 150390930 | 150390933  | 150390932 | 150390935  | 150390934 | 150390937  | 150390936 | 150390939   | 150390938 | 150390941   | 150390940 |
| 25           | 150390943   | 150390942 | 150390945  | 150390944 | 150390947  | 150390946 | 150390949  | 150390948 | 150390951  | 150390950 | 150390953  | 150390952 | 150390955  | 150390954 | 150390957  | 150390956 | 150390959  | 150390958 | 150390961   | 150390960 | 150390963   | 150390962 |
| 27           | 150390965   | 150390964 | 150390967  | 150390966 | 150390969  | 150390968 | 150390971  | 150390970 | 150390973  | 150390972 | 150390975  | 150390974 | 150390977  | 150390976 | 150390979  | 150390978 | 150390981  | 150390980 | 150390983   | 150390982 | 150390985   | 150390984 |
| 29           | 150390987   | 150390986 | 150390989  | 150390988 | 150390991  | 150390990 | 150390993  | 150390992 | 150390995  | 150390994 | 150390997  | 150390996 | 150390999  | 150390998 | 150391001  | 150391000 | 150391003  | 150391002 | 150391005   | 150391004 | 150391007   | 150391006 |
| 31           | 150391009   | 150391008 | 150391011  | 150391010 | 150391013  | 150391012 | 150391015  | 150391014 | 150391017  | 150391016 | 150391019  | 150391018 | 150391021  | 150391020 | 150391023  | 150391022 | 150391025  | 150391024 | 150391027   | 150391026 | 150391029   | 150391028 |
| 33           | 150391031   | 150391030 | 150391033  | 150391032 | 150391035  | 150391034 | 150391037  | 150391036 | 150391039  | 150391038 | 150391041  | 150391040 | 150391043  | 150391042 | 150391045  | 150391044 | 150391047  | 150391046 | 150391049   | 150391048 | 150391051   | 150391050 |
| 35           | 150391053   | 150391052 | 150391055  | 150391054 | 150391057  | 150391056 | 150391059  | 150391058 | 150391061  | 150391060 | 150391063  | 150391062 | 150391065  | 150391064 | 150391067  | 150391066 | 150391069  | 150391068 | 150391071   | 150391070 | 150391073   | 150391072 |
| 37           | 150391075   | 150391074 | 150391077  | 150391076 | 150391079  | 150391078 | 150391081  | 150391080 | 150391083  | 150391082 | 150391085  | 150391084 | 150391087  | 150391086 | 150391089  | 150391088 | 150391091  | 150391090 | 150391093   | 150391092 | 150391095   | 150391094 |
| 39           | 150391097   | 150391096 | 150391099  | 150391098 | 150391101  | 150391100 | 150391103  | 150391102 | 150391105  | 150391104 | 150391107  | 150391106 | 150391109  | 150391108 | 150391111  | 150391110 | 150391113  | 150391112 | 150391115   | 150391114 | 150391117   | 150391116 |

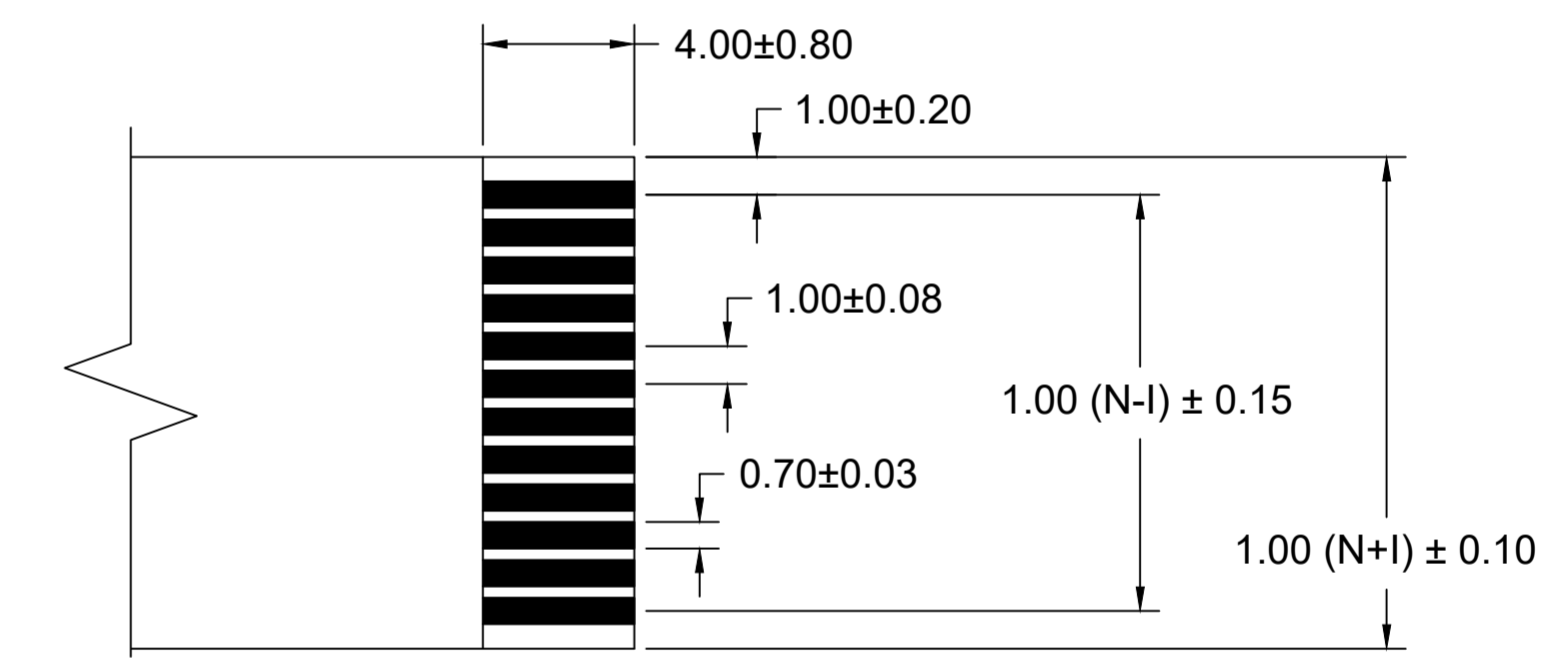
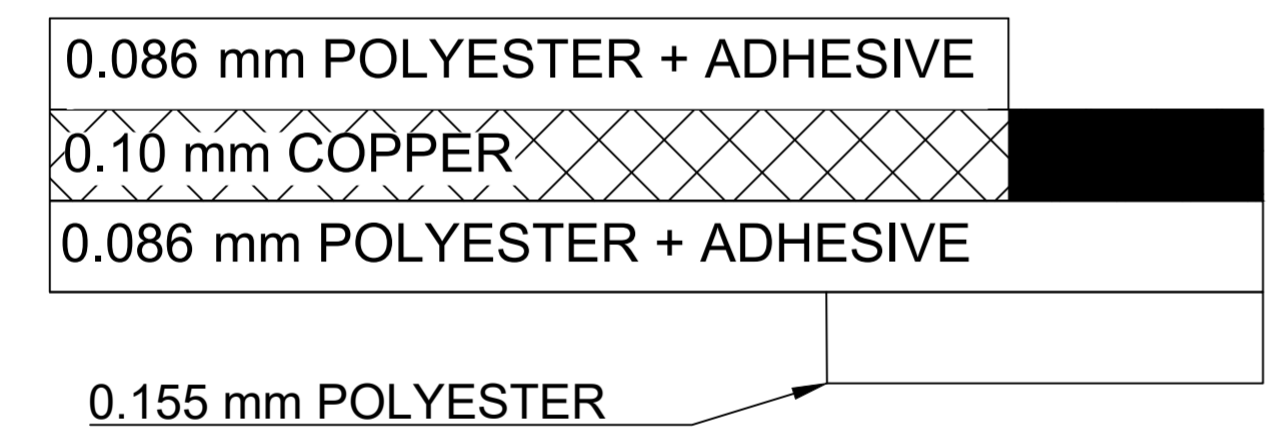

**NOTES:**  
1. NO PRINTING ON JUMPER CABLE UNLESS OTHERWISE SPECIFIED. IF PRINTING IS REQUIRED, THEN IT WOULD BE CONSIDERED A SPECIAL JUMPER CABLE.

|   |       |       |  |   |  |                |  |                 |  |
|---|-------|-------|--|---|--|----------------|--|-----------------|--|
| THIS DRAWING CONTAINS INFORMATION THAT IS PROPRIETARY TO MOLEX ELECTRONIC TECHNOLOGIES, LLC AND SHOULD NOT BE USED WITHOUT WRITTEN PERMISSION |       |       |  |   |  |                |  |                 |  |
| DIMENSION UNITS   |       | SCALE |  | CURRENT REV DESC: DRAWING CORRECTION  |  |                |  |                 |  |
| MM  |       | NA    |  | <p><b>molex</b></p> <p>1.00MM CENTER FLAT FLEX CABLE (FFC)<br/>(105°C, AU PLATED) SALES DRAWING</p> <p>PRODUCT CUSTOMER DRAWING</p> <p>DOCUMENT NUMBER: 150390001   DOC TYPE: PSD   DOC PART: 000   REVISION: B</p> |  |                |  |                 |  |
| GENERAL TOLERANCES (UNLESS SPECIFIED)   |       |       |  |   |  |                |  |                 |  |
|   | mm    | INCH  |  |   |  |                |  |                 |  |
| 4 PLACES  | ±---- | ±---- |  |   |  |                |  |                 |  |
| 3 PLACES  | ±---- | ±---- |  |   |  |                |  |                 |  |
| 2 PLACES  | ±---- | ±---- |  |   |  |                |  |                 |  |
| 1 PLACE   | ±---- | ±---- |  |   |  |                |  |                 |  |
| 0 PLACES  | ±---- | ±---- |  |   |  |                |  |                 |  |
| ANGULAR TOL ± 0.5 °   |       |       |  | EC NO: 728054   |  | DRWN: DIEGOG7  |  | 2022/11/10      |  |
| DRAFT WHERE APPLICABLE MUST REMAIN WITHIN DIMENSIONS  |       |       |  | THIRD ANGLE PROJECTION  |  | APPR: JSMITH11 |  | 2022/11/14      |  |
|   |       |       |  | DRAWING   |  | SERIES         |  | MATERIAL NUMBER |  |
|   |       |       |  | C-SIZE  |  | 15039          |  | SEE CHART       |  |
|   |       |       |  |   |  | CUSTOMER       |  | SHEET NUMBER    |  |
|   |       |       |  |   |  | GENERAL MARKET |  | 2 OF 2          |  |

# 1.00MM CENTER FFC JUMPER CABLE (HIGH TEMPERATURE) CHART

| "A" DIM. | 1.18 ± .079 INCHES<br>30 ± 2.00 |           | 2 ± .079 INCHES<br>51 ± 2.00 MM |           | 3 ± .118 INCHES<br>76 ± 3.00 MM |           | 4 ± .118 INCHES<br>102 ± 3.00 MM |           | 5 ± .157 INCHES<br>127 ± 4.00 MM |           | 6 ± .157 INCHES<br>152 ± 4.00 MM |           | 7 ± .157 INCHES<br>178 ± 4.00 MM |           | 8 ± .157 INCHES<br>203 ± 4.00 MM |           | 9 ± .197 INCHES<br>229 ± 5.00 MM |           | 10 ± .197 INCHES<br>254 ± 5.00 MM |           | 12 ± .197 INCHES<br>305 ± 5.00 MM |           |
|----------|---------------------------------|-----------|---------------------------------|-----------|---------------------------------|-----------|----------------------------------|-----------|----------------------------------|-----------|----------------------------------|-----------|----------------------------------|-----------|----------------------------------|-----------|----------------------------------|-----------|-----------------------------------|-----------|-----------------------------------|-----------|
|          | STIFFENER                       | TYPE "A"  | TYPE "D"                        | TYPE "A"  | TYPE "D"                        | TYPE "A"  | TYPE "D"                         | TYPE "A"  | TYPE "D"                         | TYPE "A"  | TYPE "D"                         | TYPE "A"  | TYPE "D"                         | TYPE "A"  | TYPE "D"                         | TYPE "A"  | TYPE "D"                         | TYPE "A"  | TYPE "D"                          | TYPE "A"  | TYPE "D"                          | TYPE "A"  |
| CKTS: 4  | 150390701                       | 150390700 | 150390703                       | 150390702 | 150390705                       | 150390704 | 150390707                        | 150390706 | 150390709                        | 150390708 | 150390711                        | 150390710 | 150390713                        | 150390712 | 150390715                        | 150390714 | 150390717                        | 150390716 | 150390719                         | 150390718 | 150390721                         | 150390720 |
| CKTS: 6  | 150390201                       | 150390202 | 150390203                       | 150390204 | 150390205                       | 150390206 | 150390207                        | 150390208 | 150390209                        | 150390210 | 150390211                        | 150390212 | 150390213                        | 150390214 | 150390215                        | 150390216 | 150390217                        | 150390218 | 150390219                         | 150390220 | 150390221                         | 150390222 |
| CKTS: 8  | 150390223                       | 150390224 | 150390225                       | 150390226 | 150390227                       | 150390228 | 150390229                        | 150390230 | 150390231                        | 150390232 | 150390233                        | 150390234 | 150390235                        | 150390236 | 150390237                        | 150390238 | 150390239                        | 150390240 | 150390241                         | 150390242 | 150390243                         | 150390244 |
| CKTS: 10 | 150390245                       | 150390246 | 150390247                       | 150390248 | 150390249                       | 150390250 | 150390251                        | 150390252 | 150390253                        | 150390254 | 150390255                        | 150390256 | 150390257                        | 150390258 | 150390259                        | 150390260 | 150390261                        | 150390262 | 150390263                         | 150390264 | 150390265                         | 150390266 |
| CKTS: 12 | 150390267                       | 150390268 | 150390269                       | 150390270 | 150390271                       | 150390272 | 150390273                        | 150390274 | 150390275                        | 150390276 | 150390277                        | 150390278 | 150390279                        | 150390280 | 150390281                        | 150390282 | 150390283                        | 150390284 | 150390285                         | 150390286 | 150390287                         | 150390288 |
| CKTS: 14 | 150390289                       | 150390290 | 150390291                       | 150390292 | 150390293                       | 150390294 | 150390295                        | 150390296 | 150390297                        | 928670298 | 150390299                        | 150390300 | 150390301                        | 150390302 | 150390303                        | 150390304 | 150390305                        | 150390306 | 150390307                         | 150390308 | 150390309                         | 150390310 |
| CKTS: 16 | 150390311                       | 150390312 | 150390313                       | 150390314 | 150390315                       | 150390316 | 150390317                        | 150390318 | 150390319                        | 150390320 | 150390321                        | 150390322 | 150390323                        | 150390324 | 150390325                        | 150390326 | 150390327                        | 150390328 | 150390329                         | 150390330 | 150390331                         | 150390332 |
| CKTS: 18 | 150390333                       | 150390334 | 150390335                       | 150390336 | 150390337                       | 150390338 | 150390339                        | 150390340 | 150390341                        | 150390342 | 150390343                        | 150390344 | 150390345                        | 150390346 | 150390347                        | 150390348 | 150390349                        | 150390350 | 150390351                         | 150390352 | 150390353                         | 150390354 |
| CKTS: 20 | 150390355                       | 150390356 | 150390357                       | 150390358 | 150390359                       | 150390360 | 150390361                        | 150390362 | 150390363                        | 150390364 | 150390365                        | 150390366 | 150390367                        | 150390368 | 150390369                        | 150390370 | 150390371                        | 150390372 | 150390373                         | 150390374 | 150390375                         | 150390376 |
| CKTS: 22 | 150390377                       | 150390378 | 150390379                       | 150390380 | 150390381                       | 150390382 | 150390383                        | 150390384 | 150390385                        | 150390386 | 150390387                        | 150390388 | 150390389                        | 150390390 | 150390391                        | 150390392 | 150390393                        | 150390394 | 150390395                         | 150390396 | 150390397                         | 150390398 |
| CKTS: 24 | 150390399                       | 150390400 | 150390401                       | 150390402 | 150390403                       | 150390404 | 150390405                        | 150390406 | 150390407                        | 150390408 | 150390409                        | 150390410 | 150390411                        | 150390412 | 150390413                        | 150390414 | 150390415                        | 150390416 | 150390417                         | 150390418 | 150390419                         | 150390420 |
| CKTS: 26 | 150390421                       | 150390422 | 150390423                       | 150390424 | 150390425                       | 150390426 | 150390427                        | 150390428 | 150390429                        | 150390430 | 150390431                        | 150390432 | 150390433                        | 150390434 | 150390435                        | 150390436 | 150390437                        | 150390438 | 150390439                         | 150390440 | 150390441                         | 150390442 |
| CKTS: 28 | 150390443                       | 150390444 | 150390445                       | 150390446 | 150390447                       | 150390448 | 150390449                        | 150390450 | 150390451                        | 150390452 | 150390453                        | 150390454 | 150390455                        | 150390456 | 150390457                        | 150390458 | 150390459                        | 150390460 | 150390461                         | 150390462 | 150390463                         | 150390464 |
| CKTS: 30 | 150390465                       | 150390466 | 150390467                       | 150390468 | 150390469                       | 150390470 | 150390471                        | 150390472 | 150390473                        | 150390474 | 150390475                        | 150390476 | 150390477                        | 150390478 | 150390479                        | 150390480 | 150390481                        | 150390482 | 150390483                         | 150390484 | 150390485                         | 150390486 |
| CKTS: 32 | 150390487                       | 150390488 | 150390489                       | 150390490 | 150390491                       | 150390492 | 150390493                        | 150390494 | 150390495                        | 150390496 | 150390497                        | 150390498 | 150390499                        | 150390500 | 150390501                        | 150390502 | 150390503                        | 150390504 | 150390505                         | 150390506 | 150390507                         | 150390508 |
| CKTS: 34 | 150390509                       | 150390510 | 150390511                       | 150390512 | 150390513                       | 150390514 | 150390515                        | 150390516 | 150390517                        | 150390518 | 150390519                        | 150390520 | 150390521                        | 150390522 | 150390523                        | 150390524 | 150390525                        | 150390526 | 150390527                         | 150390528 | 150390529                         | 150390530 |
| CKTS: 36 | 150390531                       | 150390532 | 150390533                       | 150390534 | 150390535                       | 150390536 | 150390537                        | 150390538 | 150390539                        | 150390540 | 150390541                        | 150390542 | 150390543                        | 150390544 | 150390545                        | 150390546 | 150390547                        | 150390548 | 150390549                         | 150390550 | 150390551                         | 150390552 |
| CKTS: 38 | 150390553                       | 150390554 | 150390555                       | 150390556 | 150390557                       | 150390558 | 150390559                        | 150390560 | 150390561                        | 150390562 | 150390563                        | 150390564 | 150390565                        | 150390566 | 150390567                        | 150390568 | 150390569                        | 150390570 | 150390571                         | 150390572 | 150390573                         | 150390574 |
| CKTS: 40 | 150390575                       | 150390576 | 150390577                       | 150390578 | 150390579                       | 150390580 | 150390581                        | 150390582 | 150390583                        | 150390584 | 150390585                        | 150390586 | 150390587                        | 150390588 | 150390589                        | 150390590 | 150390591                        | 150390592 | 150390593                         | 150390594 | 150390595                         | 150390596 |

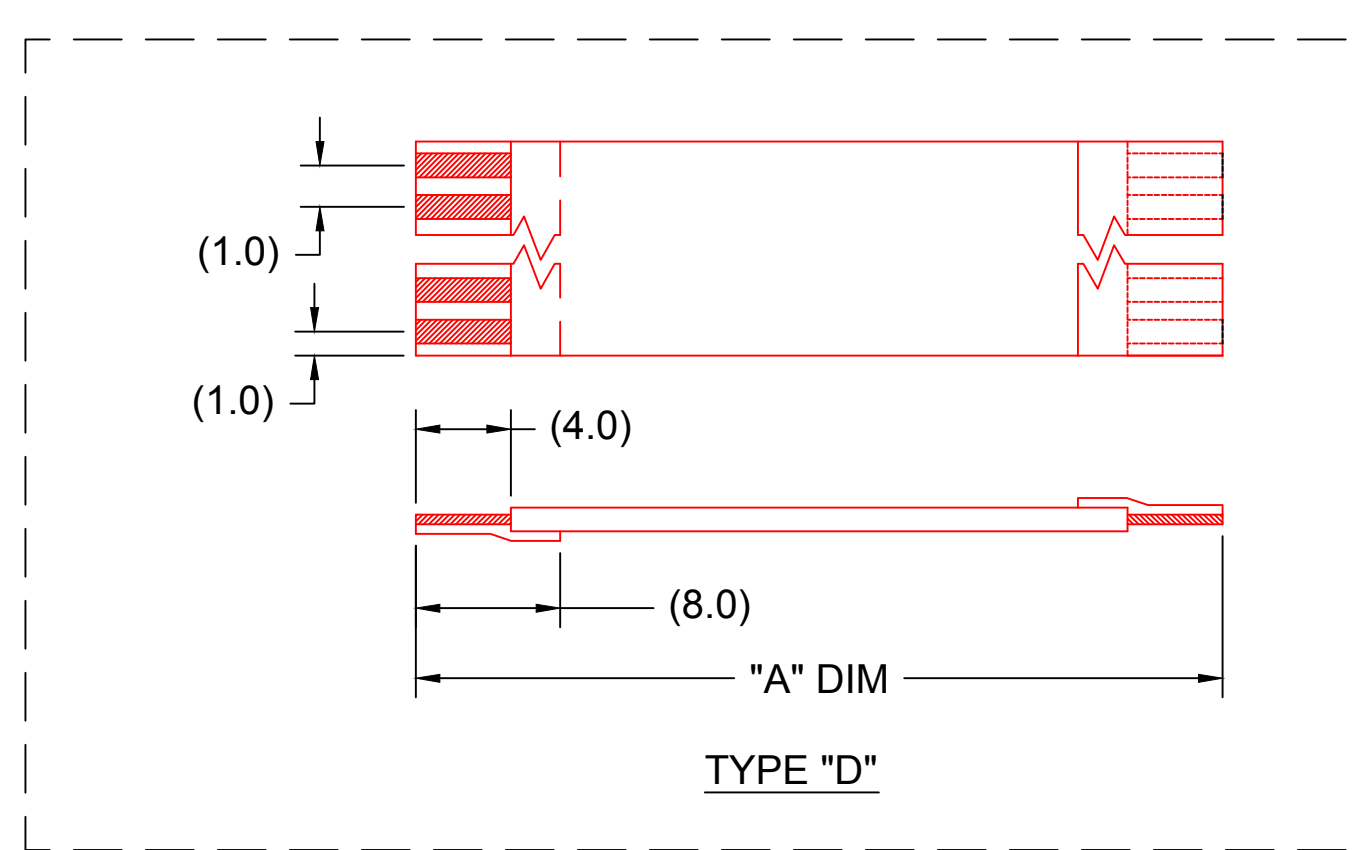
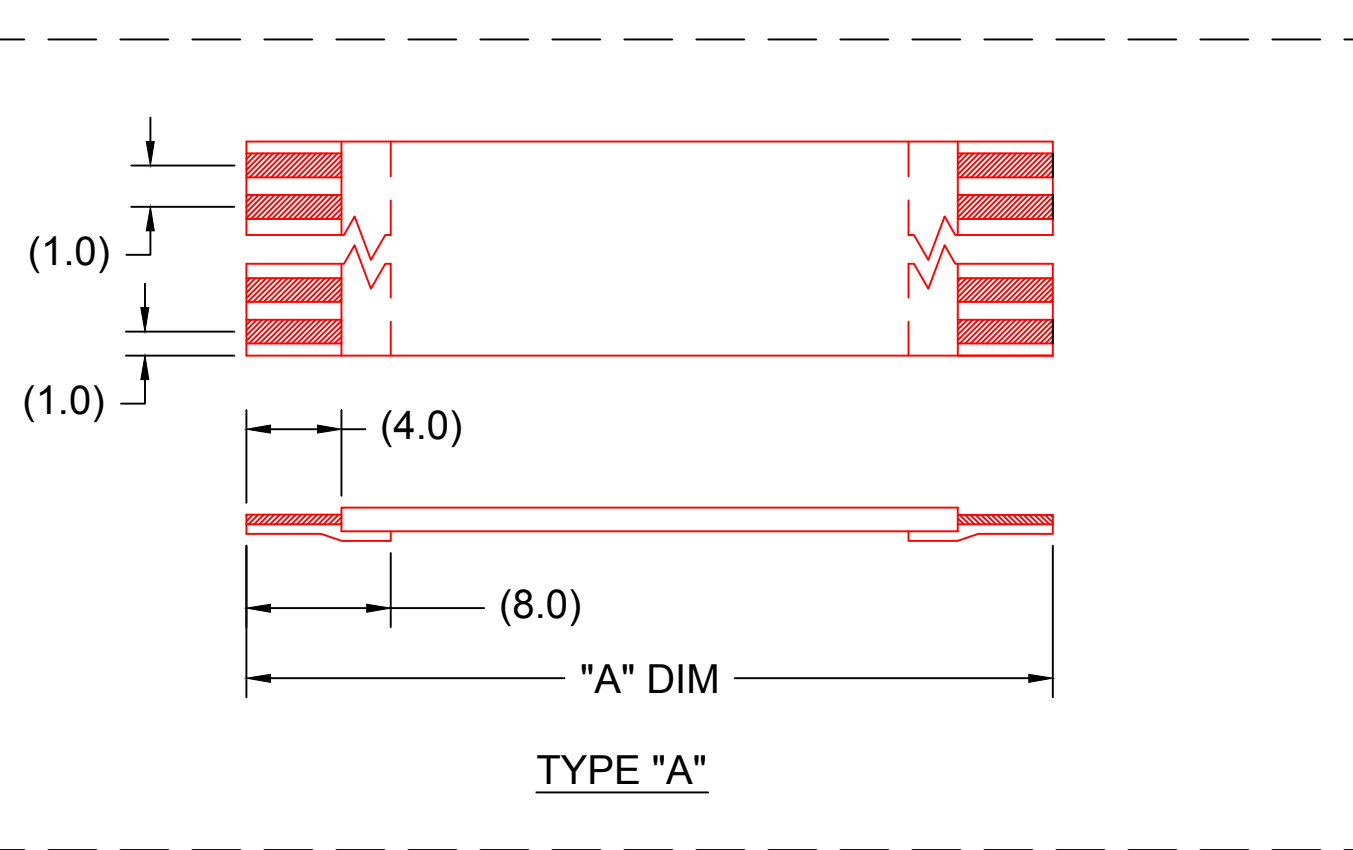

**NOTES:**  
 1. NO PRINTING ON JUMPER CABLE UNLESS OTHERWISE SPECIFIED. IF PRINTING IS REQUIRED, THEN IT WOULD BE CONSIDERED A SPECIAL JUMPER CABLE.

|   |                               |   |                                  |   |                        |                            |  |
|---|-------------------------------|---|----------------------------------|---|------------------------|----------------------------|--|
| RELEASED<br>EC NO: USW2011-0065<br>DRWN: JLW 2010/09/30 | QUALITY SYMBOL<br>▽=0<br>▽C=0 | GENERAL TOLERANCES<br>(UNLESS SPECIFIED)  | DIMENSION STYLE<br>MM            | SCALE<br>---  | DESIGN UNITS<br>METRIC | THIRD ANGLE<br>PROJECTION  |  |
|   |                               | 4 PLACES ±--- ±---<br>3 PLACES ±--- ±---<br>2 PLACES ±--- ±---<br>1 PLACE ±--- ±--- | DRAWN BY DATE<br>---             | TITLE<br><b>1.00MM CENTER FFC JUMPER CABLE AU PLATING</b>   |                        |                            |  |
|   |                               | ANGULAR ±1/2°   | CHECKED BY DATE<br>---           | APPROVED BY DATE<br>SFULTON 2011/03/23  |                        |                            |  |
|   |                               | DRAFT WHERE APPLICABLE<br>MUST REMAIN WITHIN DIMENSIONS                             | MATERIAL NO.<br><b>SEE CHART</b> | DOCUMENT NO.<br><b>SD-15039-001</b>   |                        | SHEET NO.<br><b>1 OF 2</b> |  |
|   | 1                             |   | SIZE<br><b>C</b>                 | THIS DRAWING CONTAINS INFORMATION THAT IS PROPRIETARY TO MOLEX INCORPORATED AND SHOULD NOT BE USED WITHOUT WRITTEN PERMISSION |                        |                            |  |

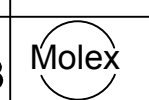

# 1.00MM CENTER FFC JUMPER CABLE (HIGH TEMPERATURE) CHART

| "A" DIM.  | 1.18 ± .079 INCHES<br>30 ± 2.00 |           | 2 ± .079 INCHES<br>51 ± 2.00 MM |           | 3 ± .118 INCHES<br>76 ± 3.00 MM |           | 4 ± .118 INCHES<br>102 ± 3.00 MM |           | 5 ± .157 INCHES<br>127 ± 4.00 MM |           | 6 ± .157 INCHES<br>152 ± 4.00 MM |           | 7 ± .157 INCHES<br>178 ± 4.00 MM |           | 8 ± .157 INCHES<br>203 ± 4.00 MM |           | 9 ± .197 INCHES<br>229 ± 5.00 MM |           | 10 ± .197 INCHES<br>254 ± 5.00 MM |           | 12 ± .197 INCHES<br>305 ± 5.00 MM |           |
|-----------|---------------------------------|-----------|---------------------------------|-----------|---------------------------------|-----------|----------------------------------|-----------|----------------------------------|-----------|----------------------------------|-----------|----------------------------------|-----------|----------------------------------|-----------|----------------------------------|-----------|-----------------------------------|-----------|-----------------------------------|-----------|
| STIFFENER | TYPE "A"                        | TYPE "D"  | TYPE "A"                        | TYPE "D"  | TYPE "A"                        | TYPE "D"  | TYPE "A"                         | TYPE "D"  | TYPE "A"                         | TYPE "D"  | TYPE "A"                         | TYPE "D"  | TYPE "A"                         | TYPE "D"  | TYPE "A"                         | TYPE "D"  | TYPE "A"                         | TYPE "D"  | TYPE "A"                          | TYPE "D"  | TYPE "A"                          | TYPE "D"  |
| CKTS: 5   | 150390723                       | 150390722 | 150390725                       | 150390724 | 150390727                       | 150390726 | 150390729                        | 150390728 | 150390731                        | 150390730 | 150390733                        | 150390732 | 150390735                        | 150390734 | 150390737                        | 150390736 | 150390739                        | 150390738 | 150390741                         | 150390740 | 150390743                         | 150390742 |
| CKTS: 7   | 150390745                       | 150390744 | 150390747                       | 150390746 | 150390749                       | 150390748 | 150390751                        | 150390750 | 150390753                        | 150390752 | 150390755                        | 150390754 | 150390757                        | 150390756 | 150390759                        | 150390758 | 150390761                        | 150390760 | 150390763                         | 150390762 | 150390765                         | 150390764 |
| CKTS: 9   | 150390767                       | 150390766 | 150390769                       | 150390768 | 150390771                       | 150390770 | 150390773                        | 150390772 | 150390775                        | 150390774 | 150390777                        | 150390776 | 150390779                        | 150390778 | 150390781                        | 150390780 | 150390783                        | 150390782 | 150390785                         | 150390784 | 150390787                         | 150390786 |
| CKTS: 11  | 150390789                       | 150390788 | 150390791                       | 150390790 | 150390793                       | 150390792 | 150390795                        | 150390794 | 150390797                        | 150390796 | 150390799                        | 150390798 | 150390801                        | 150390800 | 150390803                        | 150390802 | 150390805                        | 150390804 | 150390807                         | 150390806 | 150390809                         | 150390808 |
| CKTS: 13  | 150390811                       | 150390810 | 150390813                       | 150390812 | 150390815                       | 150390814 | 150390817                        | 150390816 | 150390819                        | 150390818 | 150390821                        | 150390820 | 150390823                        | 150390822 | 150390825                        | 150390824 | 150390827                        | 150390826 | 150390829                         | 150390828 | 150390831                         | 150390830 |
| CKTS: 15  | 150390833                       | 150390832 | 150390835                       | 150390834 | 150390837                       | 150390836 | 150390839                        | 150390838 | 150390841                        | 150390840 | 150390843                        | 150390842 | 150390845                        | 150390844 | 150390847                        | 150390846 | 150390849                        | 150390848 | 150390851                         | 150390850 | 150390853                         | 150390852 |
| CKTS: 17  | 150390855                       | 150390854 | 150390857                       | 150390856 | 150390859                       | 150390858 | 150390861                        | 150390860 | 150390863                        | 150390862 | 150390865                        | 150390864 | 150390867                        | 150390866 | 150390869                        | 150390868 | 150390871                        | 150390870 | 150390873                         | 150390872 | 150390875                         | 150390874 |
| CKTS: 19  | 150390877                       | 150390876 | 150390879                       | 150390878 | 150390881                       | 150390880 | 150390883                        | 150390882 | 150390885                        | 150390884 | 150390887                        | 150390886 | 150390889                        | 150390888 | 150390891                        | 150390890 | 150390893                        | 150390892 | 150390895                         | 150390894 | 150390897                         | 150390896 |
| CKTS: 21  | 150390899                       | 150390898 | 150390901                       | 150390900 | 150390903                       | 150390902 | 150390905                        | 150390904 | 150390907                        | 150390906 | 150390909                        | 150390908 | 150390911                        | 150390910 | 150390913                        | 150390912 | 150390915                        | 150390914 | 150390917                         | 150390916 | 150390919                         | 150390918 |
| CKTS: 23  | 150390921                       | 150390920 | 150390923                       | 150390922 | 150390925                       | 150390924 | 150390927                        | 150390926 | 150390929                        | 150390928 | 150390931                        | 150390930 | 150390933                        | 150390932 | 150390935                        | 150390934 | 150390937                        | 150390936 | 150390939                         | 150390938 | 150390941                         | 150390940 |
| CKTS: 25  | 150390943                       | 150390942 | 150390945                       | 150390944 | 150390947                       | 150390946 | 150390949                        | 150390948 | 150390951                        | 150390950 | 150390953                        | 150390952 | 150390955                        | 150390954 | 150390957                        | 150390956 | 150390959                        | 150390958 | 150390961                         | 150390960 | 150390963                         | 150390962 |
| CKTS: 27  | 150390965                       | 150390964 | 150390967                       | 150390966 | 150390969                       | 150390968 | 150390971                        | 150390970 | 150390973                        | 150390972 | 150390975                        | 150390974 | 150390977                        | 150390976 | 150390979                        | 150390978 | 150390981                        | 150390980 | 150390983                         | 150390982 | 150390985                         | 150390984 |
| CKTS: 29  | 150390987                       | 150390986 | 150390989                       | 150390988 | 150390991                       | 150390990 | 150390993                        | 150390992 | 150390995                        | 150390994 | 150390997                        | 150390996 | 150390999                        | 150390998 | 150391001                        | 150391000 | 150391003                        | 150391002 | 150391005                         | 150391004 | 150391007                         | 150391006 |
| CKTS: 31  | 150391009                       | 150391008 | 150391011                       | 150391010 | 150391013                       | 150391012 | 150391015                        | 150391014 | 150391017                        | 150391016 | 150391019                        | 150391018 | 150391021                        | 150391020 | 150391023                        | 150391022 | 150391025                        | 150391024 | 150391027                         | 150391026 | 150391029                         | 150391028 |
| CKTS: 33  | 150391031                       | 150391030 | 150391033                       | 150391032 | 150391035                       | 150391034 | 150391037                        | 150391036 | 150391039                        | 150391038 | 150391041                        | 150391040 | 150391043                        | 150391042 | 150391045                        | 150391044 | 150391047                        | 150391046 | 150391049                         | 150391048 | 150391051                         | 150391050 |
| CKTS: 35  | 150391053                       | 150391052 | 150391055                       | 150391054 | 150391057                       | 150391056 | 150391059                        | 150391058 | 150391061                        | 150391060 | 150391063                        | 150391062 | 150391065                        | 150391064 | 150391067                        | 150391066 | 150391069                        | 150391068 | 150391071                         | 150391070 | 150391073                         | 150391072 |
| CKTS: 37  | 150391075                       | 150391074 | 150391077                       | 150391076 | 150391079                       | 150391078 | 150391081                        | 150391080 | 150391083                        | 150391082 | 150391085                        | 150391084 | 150391087                        | 150391086 | 150391089                        | 150391088 | 150391091                        | 150391090 | 150391093                         | 150391092 | 150391095                         | 150391094 |
| CKTS: 39  | 150391097                       | 150391096 | 150391099                       | 150391098 | 150391101                       | 150391100 | 150391103                        | 150391102 | 150391105                        | 150391104 | 150391107                        | 150391106 | 150391109                        | 150391108 | 150391111                        | 150391110 | 150391113                        | 150391112 | 150391115                         | 150391114 | 150391117                         | 150391116 |

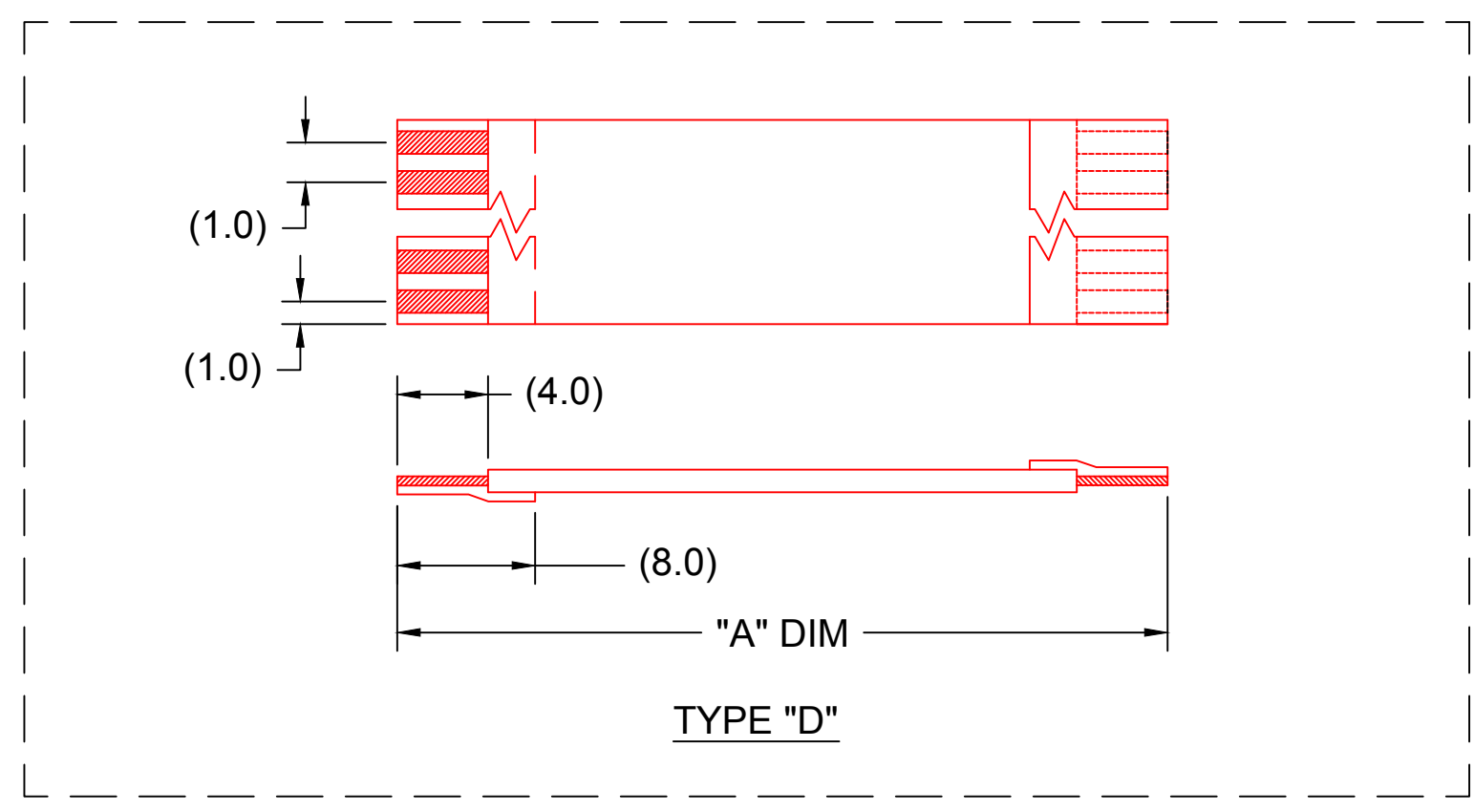
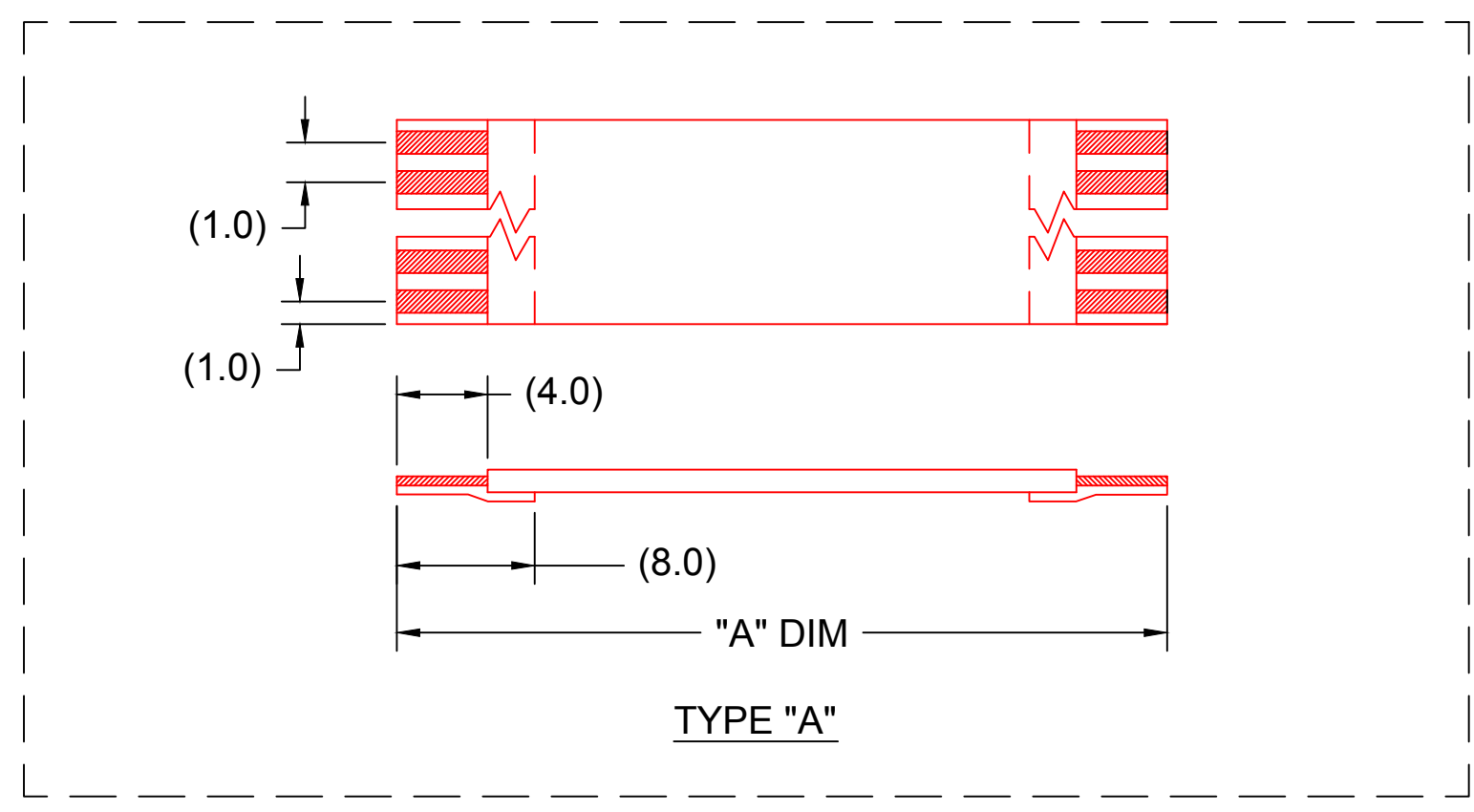

**NOTES:**  
 1. NO PRINTING ON JUMPER CABLE UNLESS OTHERWISE SPECIFIED. IF PRINTING IS REQUIRED, THEN IT WOULD BE CONSIDERED A SPECIAL JUMPER CABLE.

|             |                        |             |                |   |  |                    |              |  |
|-------------|------------------------|-------------|----------------|---|--|--------------------|--------------|--|
| SEE SHEET 1 | EC NO:<br>DRWN:<br>REV | DESCRIPTION | QUALITY SYMBOL | GENERAL TOLERANCES (UNLESS SPECIFIED)   | DIMENSION STYLE                                      | SCALE              | DESIGN UNITS | THIRD ANGLE PROJECTION                       |
|             |                        |             | ▽=0            | mm INCH   | MM   | ---                | METRIC       | 1.00MM CENTER FFC JUMPER CABLE<br>AU PLATING |
|             |                        |             | ▽C=0           | 4 PLACES ±--- ±---<br>3 PLACES ±--- ±---<br>2 PLACES ±--- ±---<br>1 PLACE ±--- ±--- | DRAWN BY DATE<br>CHECKED BY DATE<br>APPROVED BY DATE | TITLE              |              |  |
|             |                        |             | 1              | DRAFT WHERE APPLICABLE MUST REMAIN WITHIN DIMENSIONS                                | SFULTON 2011/03/23                                   | MOLEX INCORPORATED | SD-15039-001 | SHEET NO. 2 OF 2                             |

THIS DRAWING CONTAINS INFORMATION THAT IS PROPRIETARY TO MOLEX INCORPORATED AND SHOULD NOT BE USED WITHOUT WRITTEN PERMISSION