

LOC	DIST	REVISIONS			
P	LTN	DESCRIPTION	DATE	DWN	APVD
A		ECR-11-018212	26MAR2012	DZ	AC
B			18JUN2013	CW	SH

- MATERIAL:
 HOUSING: BLACK, THERMOPLASTIC, RATED UL 94V-0.
 SHIELD: COPPER ALLOY WITH NICKEL PLATING.
 CONTACTS: PHOSPHER BRONZE.
 CONTACT PLATING: 0.05um MIN GOLD OVER
 0.76um MIN PALLADIUM-NICKEL, AT MATING
 INTERFACE CONTACT AREA.
- DATE CODE SHOWN APPROXIMATE AREA.
- LIGHT PIPE MATERIAL: CLEAR POLYCARBONATE
- RECOMMENDED MIN PCB THICKNESS 1.5mm (.062").
- DATUM AND BASIC DIMENSION ESTABLISHED BY CUSTOMER
- FOR HOLE SIZE AND PLATINGS, SEE SHEET 3.
- ISOLATION VOLTAGE: 2250VDC(MAX) FOR 60 SECONDS WITH
 A RISE TIME OF 500V/SEC.
- RECOMMENDED SMT LED MANUFACTURERS AND PN:
 EVERLIGHT P/N: 18-225/R6G6C-A01/3T OR
 PARALIGHT P/N: L-CI85KFKGWT

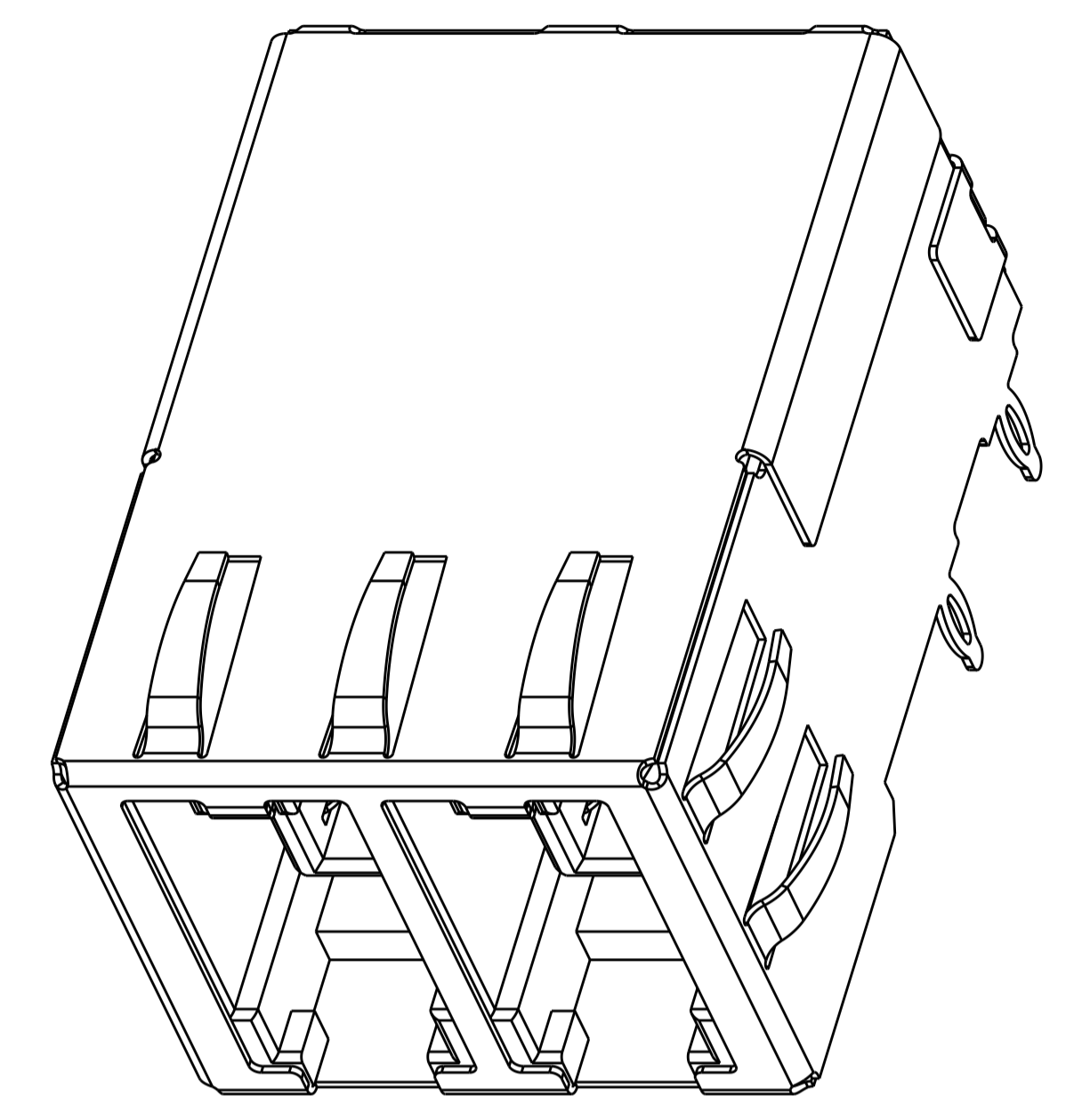

SCALE 6:1

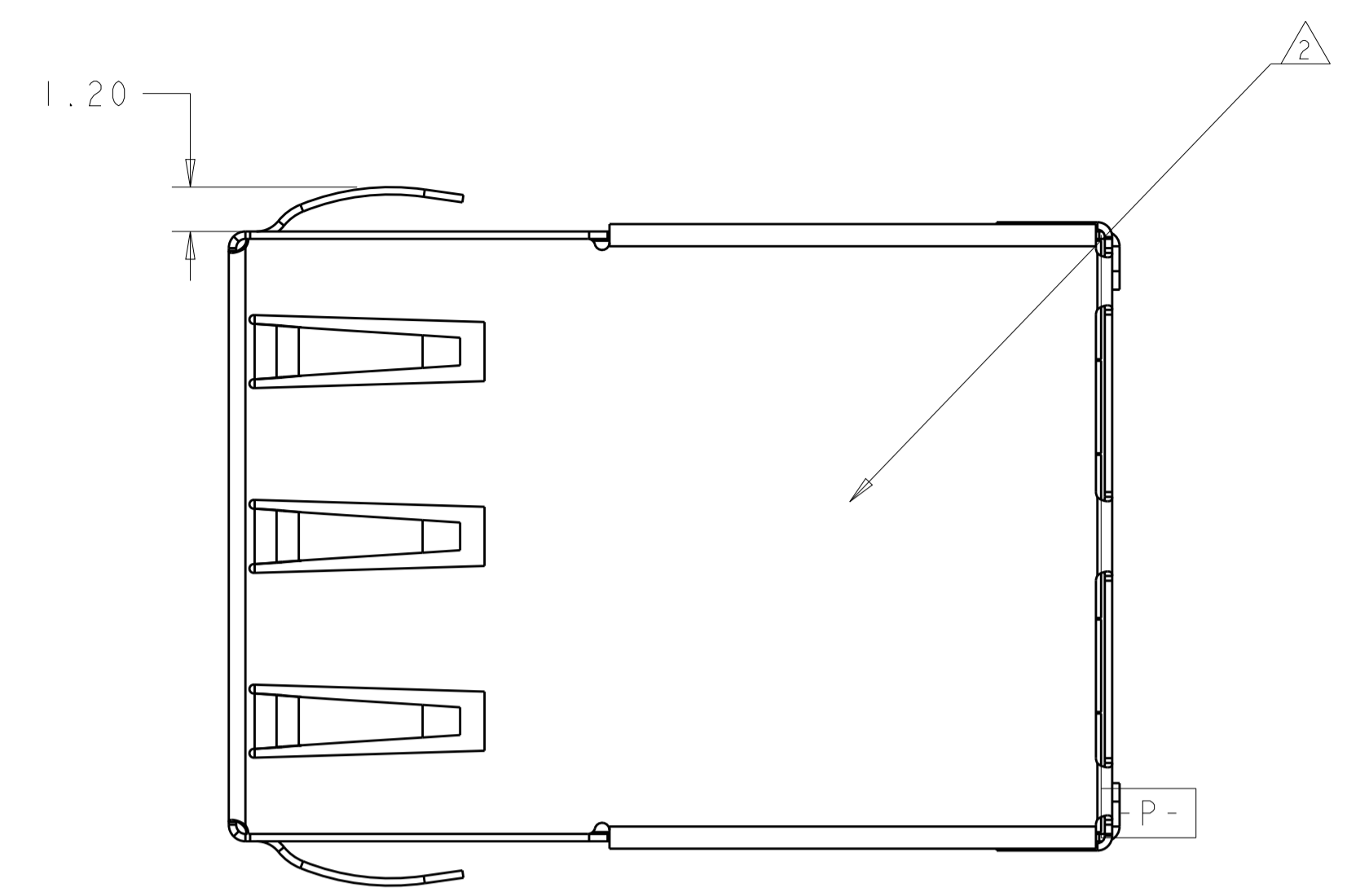
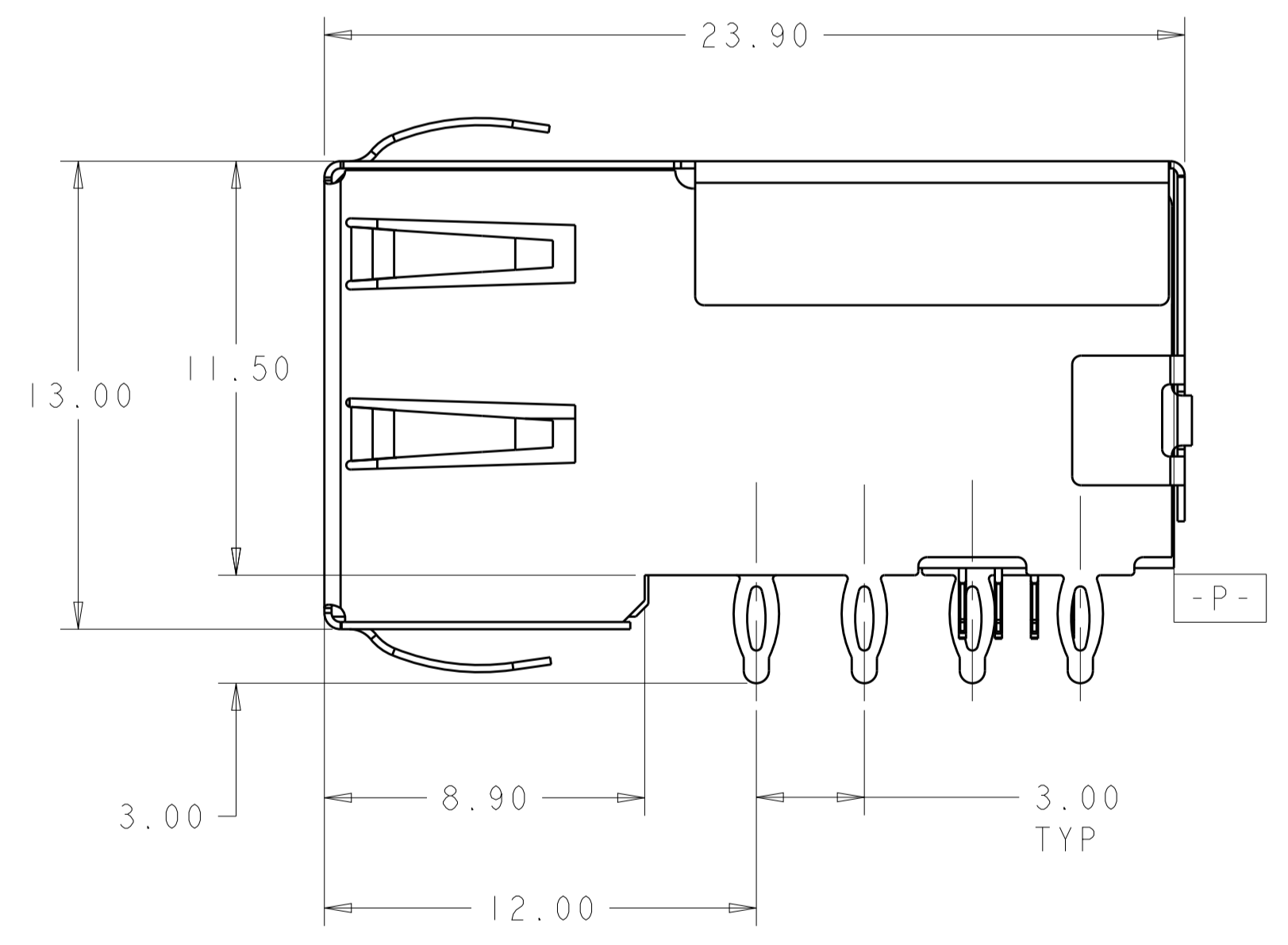
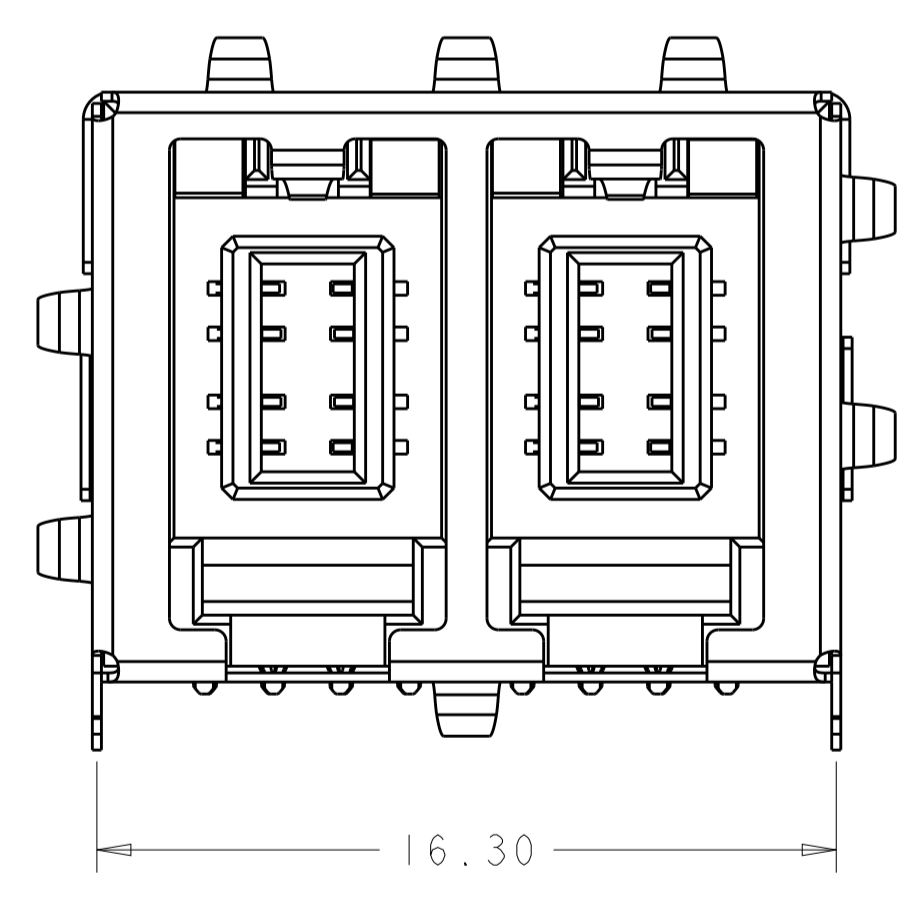

SCALE 6:1

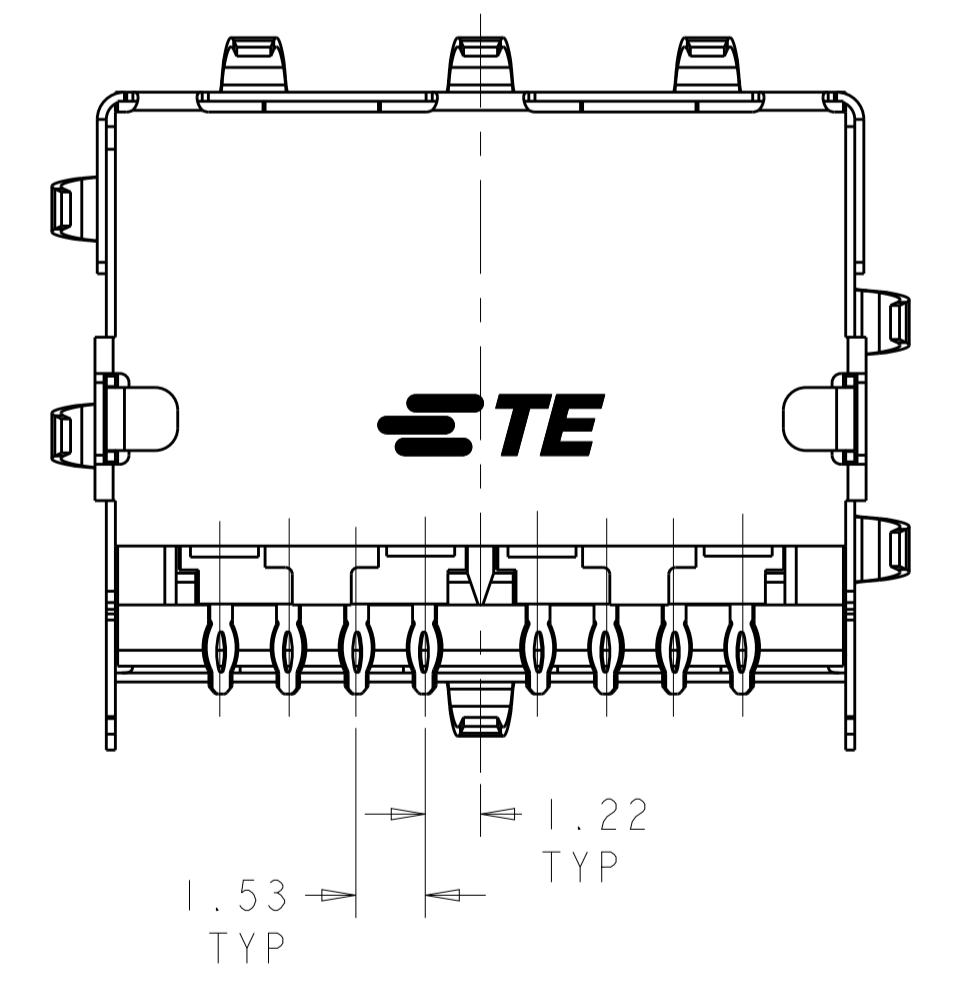

2170129-1 P/N

THIS DRAWING IS A CONTROLLED DOCUMENT.		DWN D. ZHU 15MAY2011	2170129-1 P/N	
DIMENSIONS:		CHK MANOJIAN.W 15MAY2011	STE TE Connectivity	
TOLERANCES UNLESS OTHERWISE SPECIFIED:		APVD MANOJIAN.W 15MAY2011	NAME RECEPTACLE ASSEMBLY 1X2 OFFSET, NON MAGNETICS RJ POINT FIVE	
mm	0 PLC ±	PRODUCT SPEC	SIZE CAGE CODE DRAWING NO RESTRICTED TO	
	1 PLC ±0.25	108-60097	A100779C=2170129	
	3 PLC ±	APPLICATION SPEC	SCALE 1:1 SHEET 1 OF 3 REV B	
	4 PLC ±	114-60014		
	ANGLES ±2°	WEIGHT		
MATERIAL	FINISH	Customer Drawing		

LOC	DIST	REV	DATE	BY	APPV
AG	00				

REVISIONS			DATE	BY	APPV
		SEE SHEET 1			

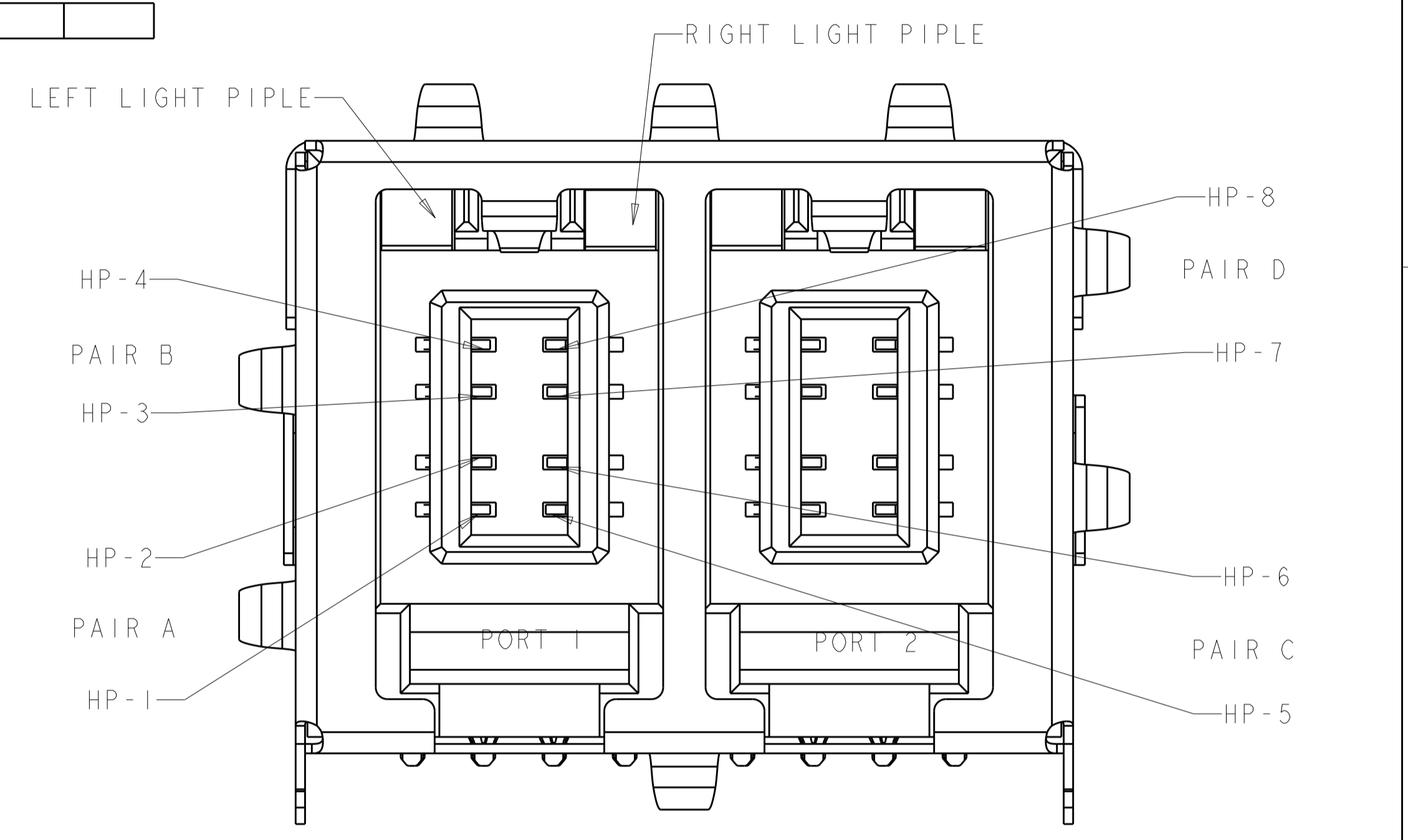
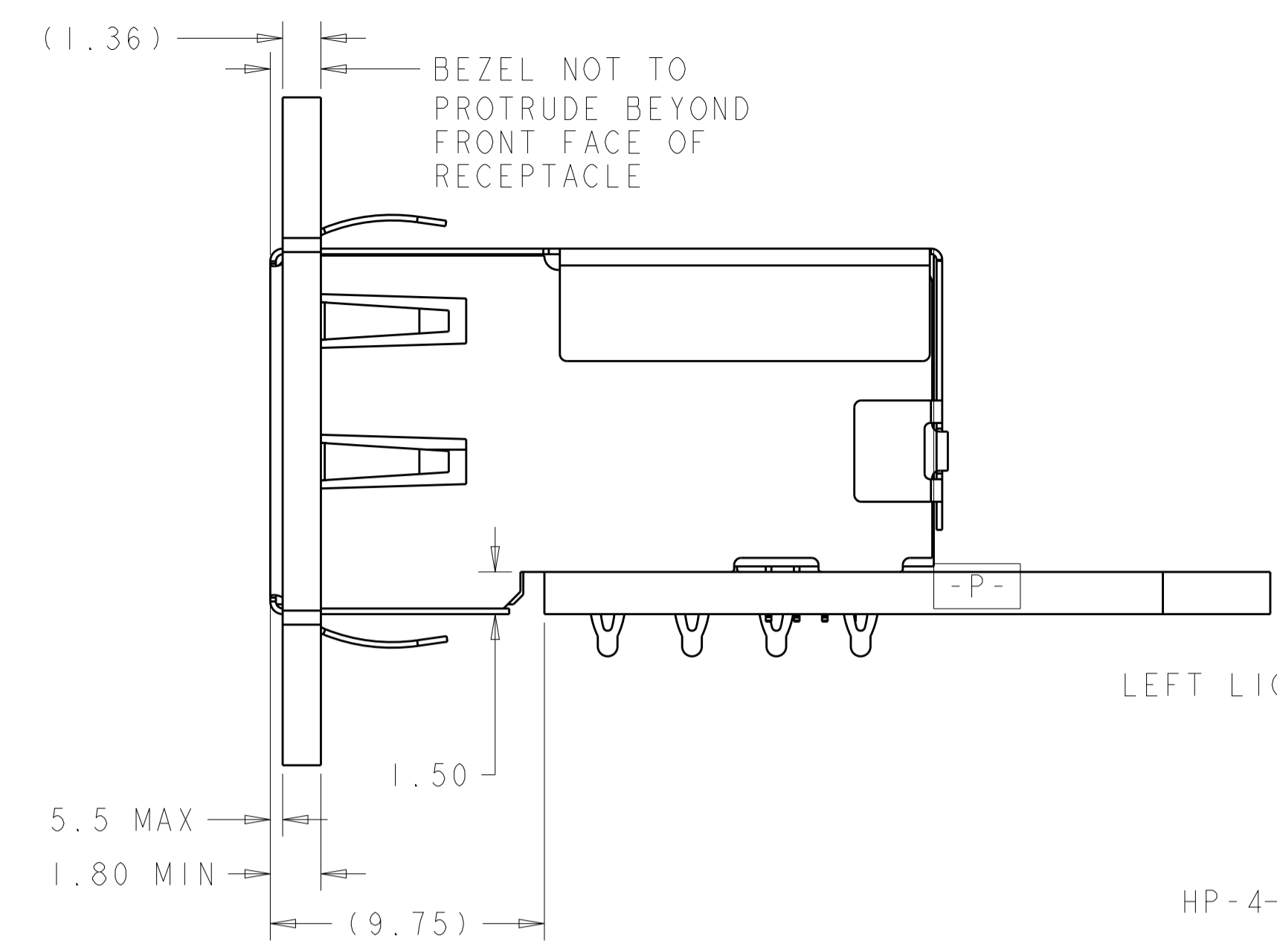
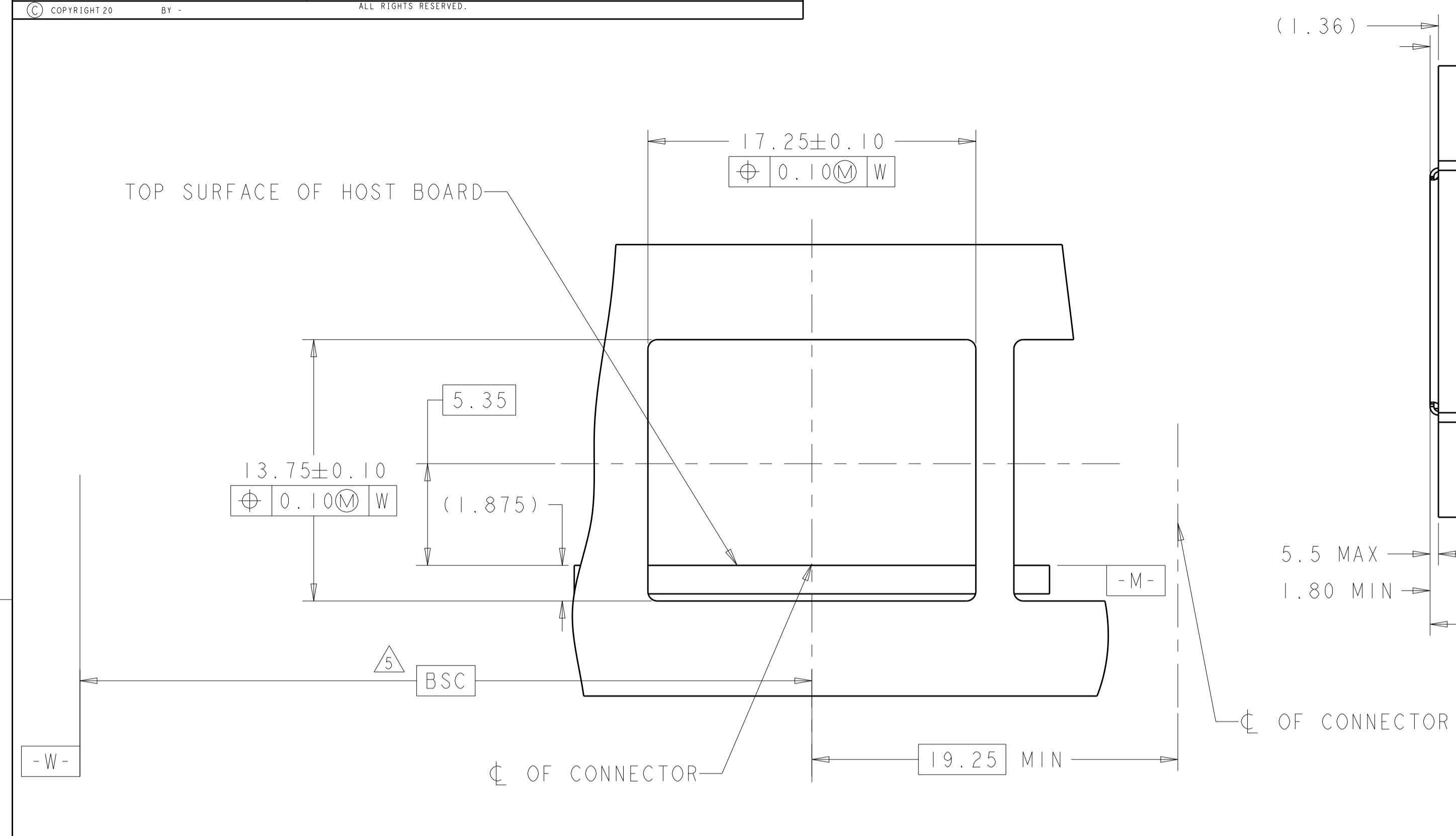

RECOMMENDED PANEL CUTOUT
 SCALE 5:1

SCALE 10:1

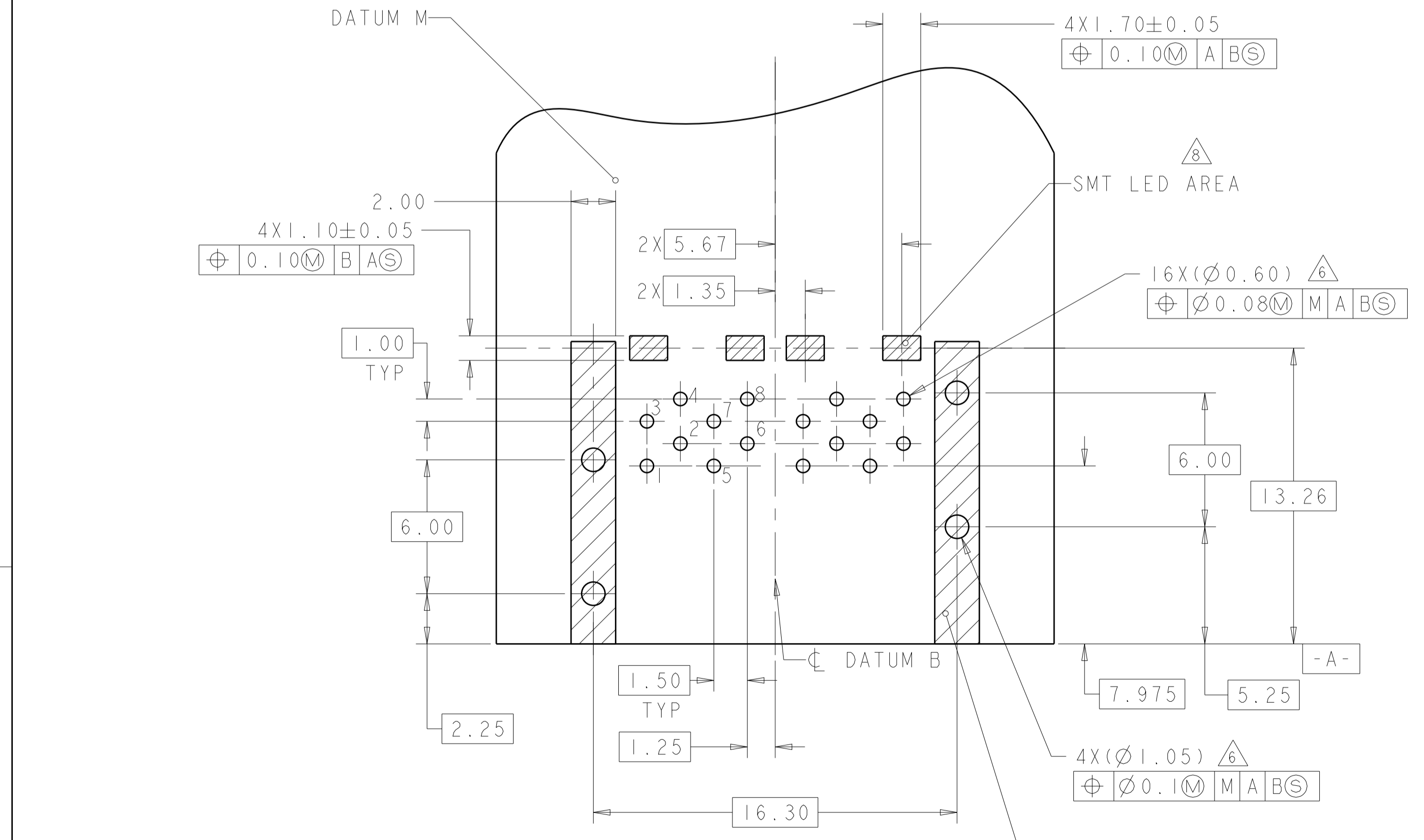

CROSS-HATCHED AREA DENOTES COMPONENT AND TRACE KEEP-OUT (EXCEPT CHASSIS GROUND)

RECOMMENDED PCB LAYOUT VIEWED FROM COMPONENT SIDE
 SCALE 6:1

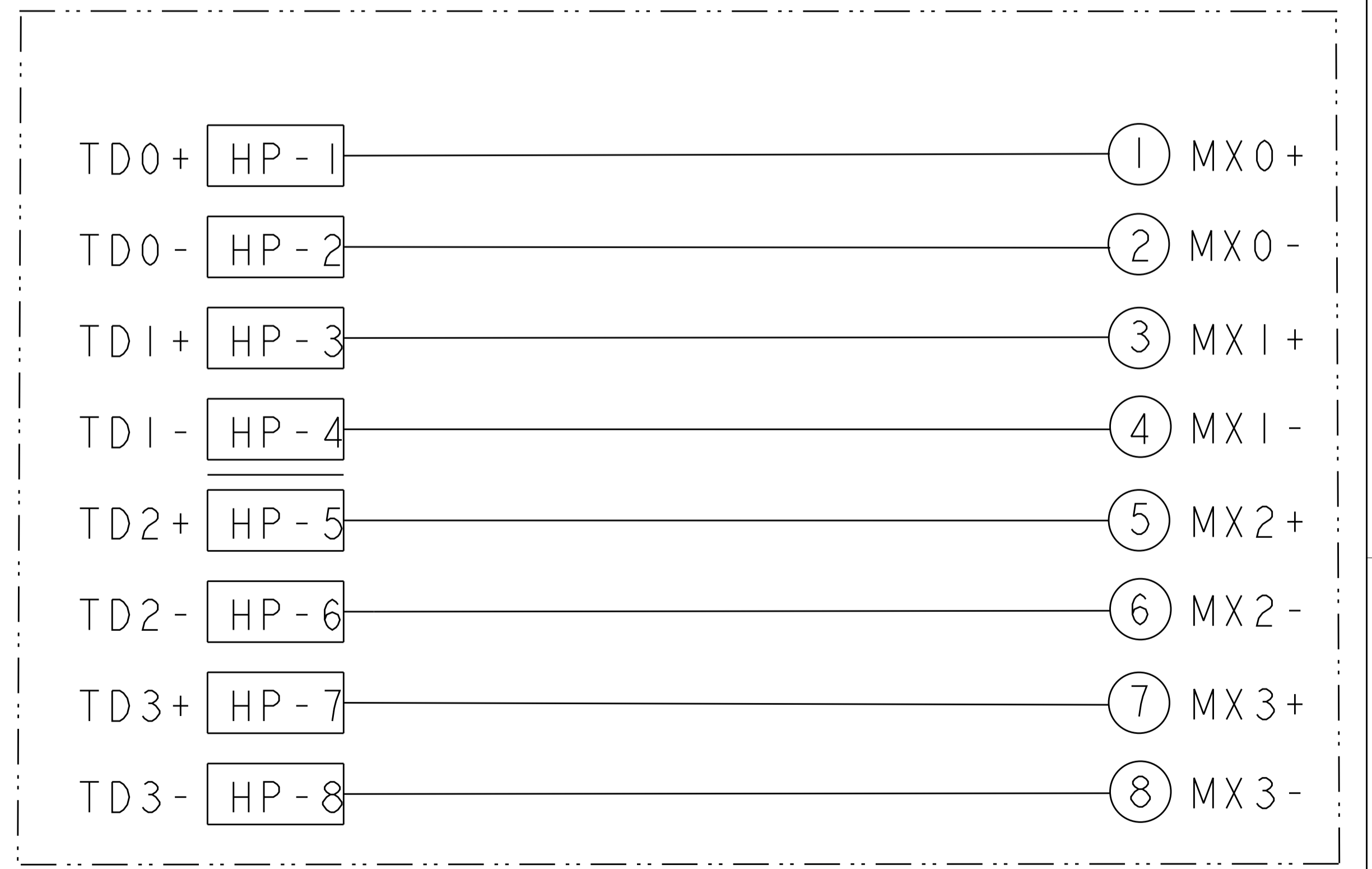

THIS DRAWING IS A CONTROLLED DOCUMENT.

DIMENSIONS:	TOLERANCES UNLESS OTHERWISE SPECIFIED:	OWN: D. ZHU 15MAY2011	CHK: MANOJAN. W 15MAY2011	APV: MANOJAN. W 15MAY2011
mm	0 PLC ±	NAME: RECEPTACLE ASSEMBLY 1X2 OFFSET, NON MAGNETICS RJ POINT FIVE		
	1 PLC ±0.25	PRODUCT SPEC: 108-60097		
	2 PLC ±	APPLICATION SPEC: 114-60014		
	3 PLC ±	SIZE: A1		
	4 PLC ±	CAGE CODE: 2170129		
	ANGLES ±	WEIGHT: -		
MATERIAL:	FINISH:	Customer Drawing		

TE Connectivity

SCALE 1:1 SHEET 2 OF 3 REV B

LOC		DIST		REVISIONS			
AG	00	P	LTN	DESCRIPTION	DATE	DMN	APVD
-	-	-	-	SEE SHEET 1	-	-	-

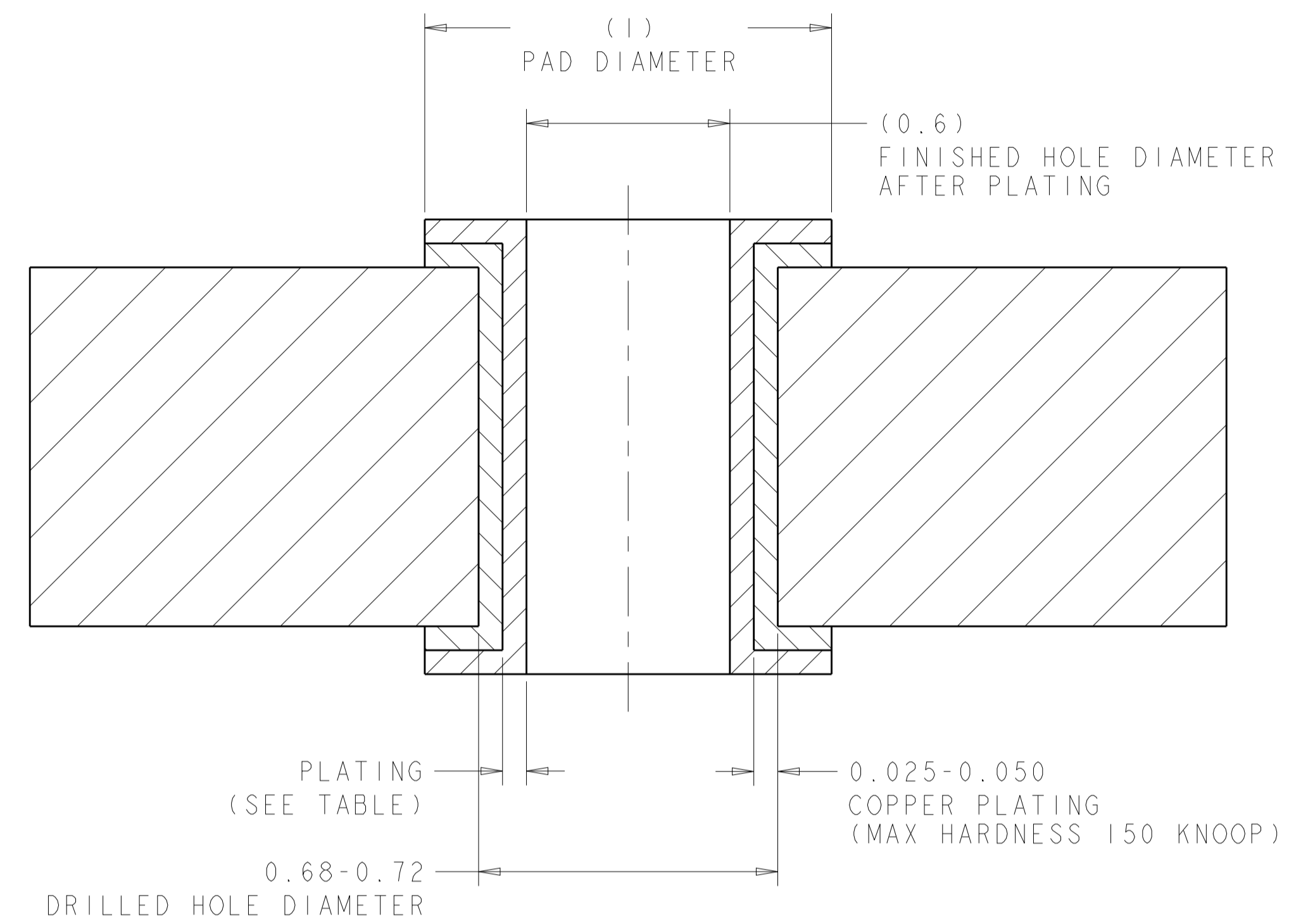

RECOMMENDED HOLE DIMENSIONS FOR SIGNAL CONTACTS

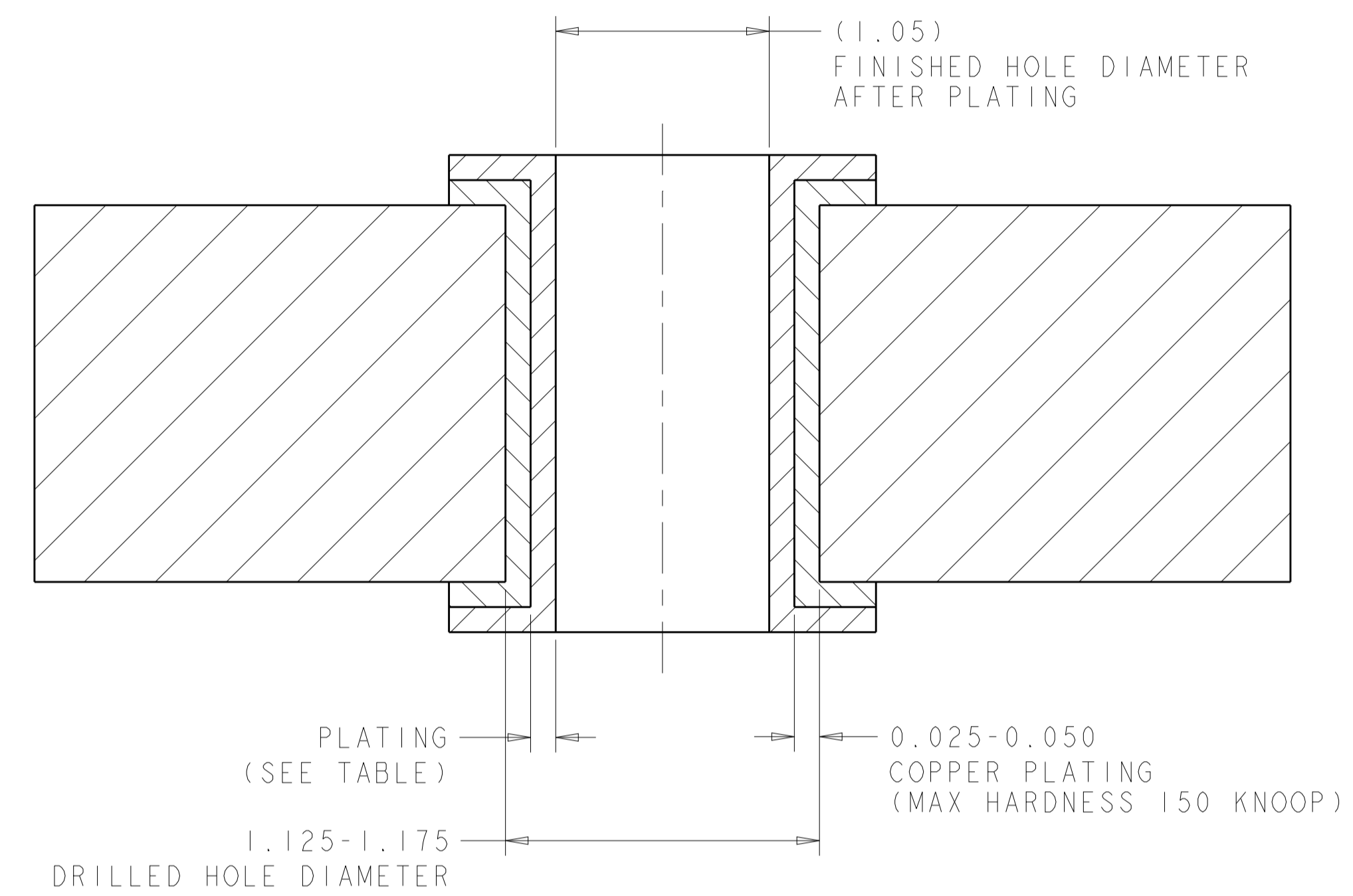

RECOMMENDED HOLE DIMENSIONS FOR SHIELD PINS

THICKNESS	PLATING
0.004-0.010	HOT AIR SOLDER LEVELING (HASL) TIN-LEAD (Sn Pb)
0.0005-0.001	IMMERSION TIN (Sn)
0.0002-0.0005	ORGANIC SOLDERABILITY PRESERVATIVE (OSP)
0.0001-0.0005 Au, 0.004-0.0076 Ni	IMMERSION GOLD (Au) OVER NICKEL (Ni) (ENIG)
0.010-0.025	TIN LEAD PLATING (Sn Pb)
0.0001-0.00015	IMMERSION SILVER (Ag)

THIS DRAWING IS A CONTROLLED DOCUMENT.

DIMENSIONS:	TOLERANCES UNLESS OTHERWISE SPECIFIED:	DMN: D. ZHU 15MAY2011	TE Connectivity NAME: RECEPTACLE ASSEMBLY 1X2 OFFSET, NON MAGNETICS RJ POINT FIVE
mm	0 PLC ±	CHK: MANOJAN. W 15MAY2011	
	1 PLC ±0.25	APVD: MANOJAN. W 15MAY2011	
	2 PLC ±	PRODUCT SPEC	
MATERIAL	FINISH	108-60097	SIZE: CAGE CODE DRAWING NO
		114-60014	RESTRICTED TO
		Customer Drawing	A100779C=2170129
			SCALE: 4:1 SHEET 3 OF 3 REV B