

Housing - HC-B 10-TFQ-N-M1PG16S - 1460065

Please be informed that the data shown in this PDF Document is generated from our Online Catalog. Please find the complete data in the user's documentation. Our General Terms of Use for Downloads are valid (<http://phoenixcontact.com/download>)



HEAVYCON B10 sleeve housing, for double locking latch, height: 56 mm, with 1 x Pg16 screw connection, lateral cable outlet

Key Commercial Data

| | |
|--------------|---------------|
| Packing unit | 10 pc |
| GTIN | |
| GTIN | 4046356793308 |

Technical data

Dimensions

| | |
|-------------------------|------------------|
| Height | 56 mm |
| Width | 43 mm |
| Length | 73 mm |
| Wrench size, union nut | 22 mm |
| External cable diameter | 7.5 mm ... 15 mm |

Ambient conditions

| | |
|--------------------------------------|-------------------|
| Degree of protection of housing (IP) | IP65 |
| Ambient temperature (operation) | -40 °C ... 125 °C |

General

| | |
|------------------------------|--------------------------------------------------|
| Note | For contact inserts HC-B10, BB18, DD42, M, K8/24 |
| Size | B10 |
| Locking type | for double locking latch |
| No. of cable outlets | 1 |
| Cable outlet | lateral |
| Screw connection | with |
| Type of the screw connection | 1x Pg16 |
| Housing material | Aluminum die-cast |

Housing - HC-B 10-TFQ-N-M1PG16S - 1460065

Technical data

General

| | |
|--------------------------|---------------------|
| Housing surface material | Powder-coated, gray |
| Cable gland material | Nickel-plated brass |
| Cable seal material | NBR |

Environmental Product Compliance

| | |
|------------|---------------------------------------------------------|
| China RoHS | Environmentally friendly use period: unlimited = EFUP-e |
| | No hazardous substances above threshold values |

Drawings

Dimensional drawing

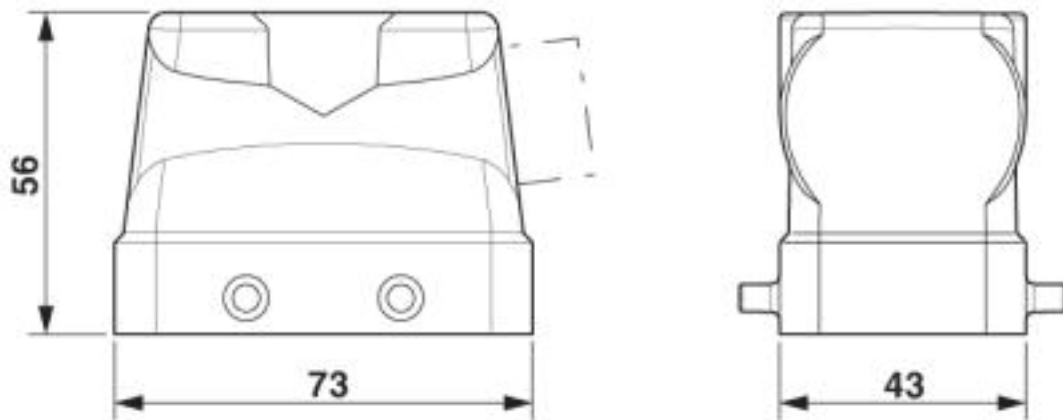

Dimensional drawing

Approvals

Approvals

Approvals

EAC

Ex Approvals

Approval details

| | | |
|-----|--|--------------------------|
| EAC | | RU C- DE.AI30.B.01102 |
|-----|--|--------------------------|

Phoenix Contact 2019 © - all rights reserved
<http://www.phoenixcontact.com>

PHOENIX CONTACT GmbH & Co. KG
Flachmarktstr. 8
32825 Blomberg
Germany
Tel. +49 5235 300
Fax +49 5235 3 41200
<http://www.phoenixcontact.com>