

REV.	EN. NO.	DESCRIPTION	SIGN	DATE
C1	N/A	INITIAL DRAWING	Liu	2019/08/13

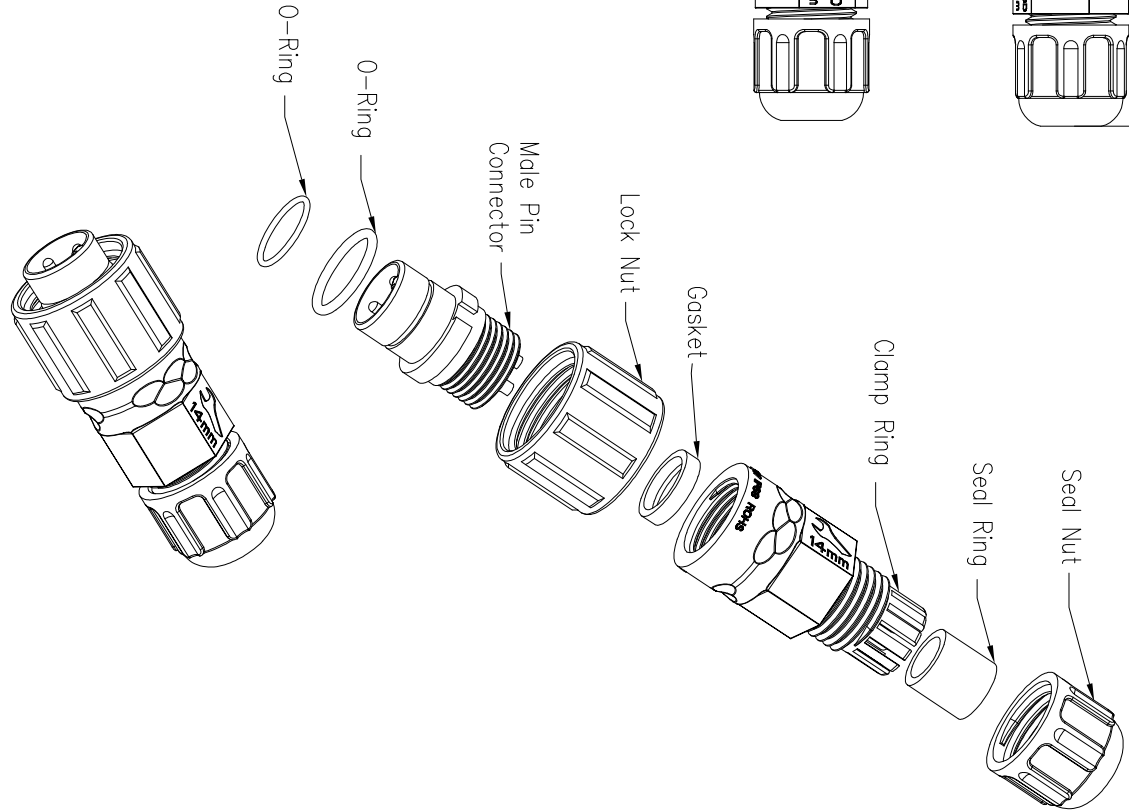
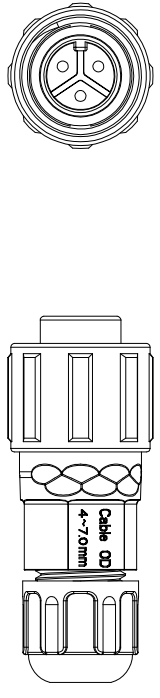
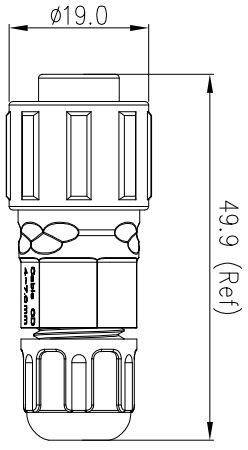

- Specification:
1. Operation Temperature: -45°C~105°C.
 2. Insulation Resistance: 100MΩ at DC500V.
 3. Contact Resistance: <10mΩ.
 4. Withstand Voltage: 2000V AC
 5. Operating Current: 10A
 6. Operating Voltage: AC 300V
 7. Waterproof Rate: IP67 (Mated)
 8. Seal Nut: Nylon, Black
 9. Seal Ring: Silicon, Black
 10. Clamp Ring: Nylon, Black
 11. Gasket: Silicon, Red
 12. Lock Nut: Nylon, Black
 13. Male Pin: Copper Alloy, Gold Plated
 14. Connector: Nylon+GF, Black
 15. O-Ring: Silicon, Red
 16. RoHS Compliant.
 17. UL Compliant.
 18. Cable Range OD: φ3.5mm~φ6.8mm
 19. Mating Cap: 806-00032-00

1	2	3	4	5	6	7	8
P/N: 22002111-01 P/N: 22003111-01							
UNIT: mm							
TOLERANCE: X ±0.25, XX ±0.15, XXX ±0.05, ANGLES ±1°							
DESCRIPTION: Standard Series Screw Male Plug With Male Pin							
SCALE: 1:1 SHEET: 1 OF 1							
REV: C1 SIZE: A4 * : Inspection Item							

CHOGORI

PART NO	22XXX111-01	DRAWN BY	Liu	DATE	2019/08/13
DWG NO		CHECKED BY	Mo	DATE	2019/08/13
CUSTOMER		APPROVED BY	Pinson	DATE	2019/08/13