

THIS COPY IS PROVIDED ON A RESTRICTED BASIS AND IS NOT TO BE USED IN ANY WAY DETRIMENTAL TO THE INTERESTS OF PANDUIT CORP.

PANDUIT PART #	STUD SIZE	DIMENSIONS in. [mm]					TOOLS
		L ± .03 [0,8]	W ± .01 [0,3]	C ± .02 [0,5]	M ± .03 [0,8]	H ± .01 [0,3]	
PV10-6LF	#6	1.03 [26,2]	.30 [7,6]	.23 [5,8]	.80 [20,3]	.14 [3,6]	CT-100A CT-600A (CT-550CH) CT-1550 CT-1551 CT-2500 (CT-2550CH)
PV10-8LF	#8	1.05 [26,7]	.30 [7,6]	.23 [5,8]	.80 [20,3]	.16 [4,1]	
PV10-10LF	#10	1.04 [26,4]	.34 [8,6]	.23 [5,8]	.80 [20,3]	.19 [4,8]	
PV10-14LF	1/4"	1.19 [30,2]	.46 [11,7]	.36 [9,1]	.90 [22,9]	.25 [6,4]	

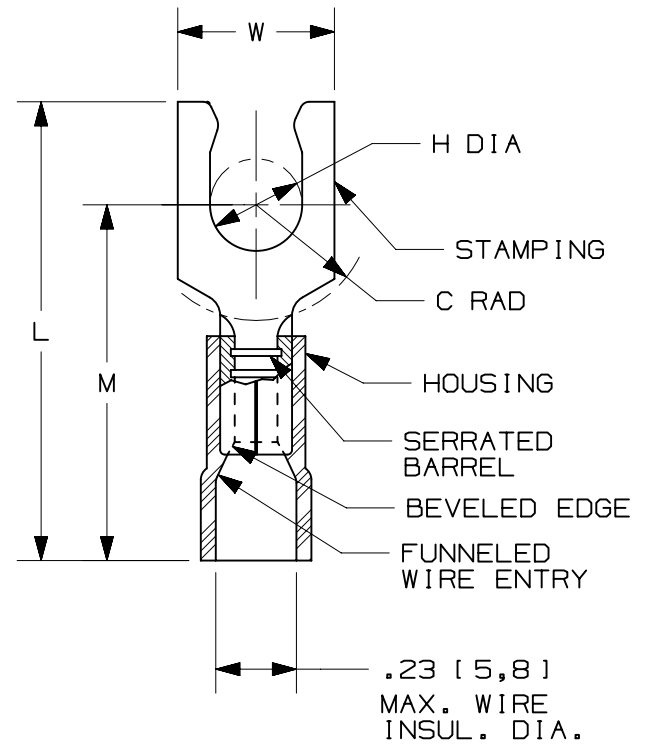

NOTES:

- cULus LISTED FOR:
 - A. #12-10 AWG [4,0-6,0 mm²] STRANDED COPPER WIRE
 - B. 221°F [105°C] MAX. OPERATING TEMPERATURE
 - C. 600 V. MAX. VOLTAGE RATING (1000 V. IN SIGNS, FIXTURES & LUMINARIES)
2. SEE www.panduit.com FOR PACKAGE QUANTITIES
3. MATERIAL:
 - A. STAMPING: .04" [1,0] THK COPPER, TIN PLATED
 - B. HOUSING: VINYL, YELLOW
4. DIMENSIONS IN BRACKETS ARE METRIC EQUIVALENT
5. WIRE STRIP LENGTH: 5/16" ^{+1/32}₀ [7,9^{+0,8}₀]



REV	DATE	BY	CHK	APR	DESCRIPTION	ECN
12	07/14	MBY	JHNU	RGB	REVISED NOTES, MOVED TOOLS TO TABLE, REVISED CERTIFICATION	N41226BA-A41226
11	10.17.12	JBN	LSM	VMB	REVISED NOTES. UPDATED DRAWING TO CURRENT STANDARDS.	A41226

TITLE LOCKING FORK TERMINALS, NON- INSULATED, #12-10	
CUSTOMER DRAWING	
ITEM REVISION NAME N41226BA/12	PANDUIT TM
DATASET FILE NAME N41226BA_DC/12A	
UNLESS OTHERWISE SPECIFIED, DIMENSIONAL TOLERANCES ARE: IN [mm]	
MATERIAL: SEE NOTES	
DRAWING NUMBER: A41226	
DRAWN BY DAW	DATE -
CHK LA	SCALE N.T.S.
SHEET 1 OF 1	
SIZE A	

D101000A/12