

## TRS1-115BPR002

Aliases (USEP115BPR0020)

KEMET, TRS-P, Thermal Reed Switch, Screw-In, 3C Temperature Accuracy, High Reliability, High-Speed Response, Long Operational Life, Excellent Environmental Durability, High Temperature Accuracy, 115°C, Break

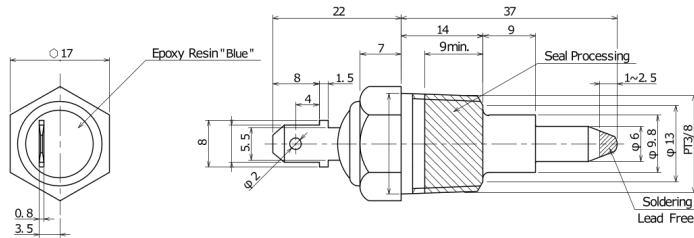

Click [here](#) for the 3D model.

### Dimensions

|   |          |
|---|----------|
| L | 37mm NOM |
| W | 17mm NOM |

### Packaging Specifications

|                    |      |
|--------------------|------|
| Packaging Quantity | 100  |
| Component Weight   | 34 g |

### General Information

|             |   |
|-------------|---|
| Series      | TRS-P   |
| Type        | Thermal Reed Switch   |
| Style       | Screw-In  |
| Description | Thermal Reed Switch   |
| Features    | High Reliability, High-Speed Response, Long Operational Life, Excellent Environmental Durability, High Temperature Accuracy |
| RoHS        | Yes   |
| REACH       | Yes   |

### Specifications

|                             |  |
|-----------------------------|--|
| Switching Temperature       | 115C +/-3C   |
| Temperature Range           | -20/+130°C   |
| Contact Type                | Break  |
| Voltage DC                  | 100 VDC MAX (Opening/Closing)  |
| Current                     | 0.5 Amps DC MAX (Opening/Closing), 5 mAmps MIN (1VDC, Opening/Closing) |
| Resistance                  | 500 mOhms MAX (Contact Resistance)                                     |
| Max Opening/Closing Power   | 10 W (DC)  |
| Max Opening/Closing Voltage | 100 V (DC)   |
| Differential Temperature    | 10C Maximum  |