

THIS DOCUMENT IS THE PROPERTY OF  
KEYSTONE ELECTRONICS CORP. AND  
SHALL NOT BE REPRODUCED, DISTRIBUTED  
OR USED AS A BASIS FOR MANUFACTURE  
WITHOUT PRIOR WRITTEN PERMISSION  
FROM KEYSTONE ELECTRONICS CORP.

ACTUAL SIZE

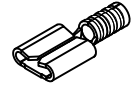

Ø.080 [2.03] I.D.

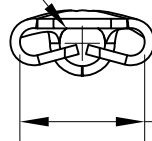

MATES WITH  
.250 [6.4] x .032 [0.81]  
MALE TAB

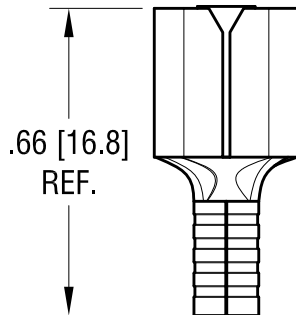

.66 [16.8]  
REF.

**NOTE:**

1. TERMINAL: BRASS, TIN PLATE
2. ACCOMMODATES WIRE RANGE 16/14 AWG

8.04.21	TERMINAL MAT'L WAS COPPER CHANGE AS PER ECN 21-076	A
DATE	DESCRIPTION	REV.

<b>KEYSTONE ELECTRONICS CORP.</b>			
www.keyelco.com • NEW HYDE PARK, NY 11040 • Tel (516) 328-7500			
PART NAME			
SOLDERLESS QUICK-FIT TERMINAL			
MATERIAL			
AS NOTED			
FINISH		DRN BY	DATE
AS NOTED		NT	8.19.08
		APP'D	SCALE
		LN	2.5X
TOLERANCES	INCH [MM]	CODE	DWG NO.
DECIMAL	± .010 [± 0.25]	C	<b>8275</b>
ANGULAR	± 1°		
UNLESS OTHERWISE SPECIFIED			