

PLEASE CHECK WWW.MOLEX.COM FOR LATEST PART INFORMATION

Part Number: **0638139500**
Status: **Active**
Overview: [Application Tooling](#)
Description: Extractor Tool for MOX 0.635mm Receptacle Crimp Terminals

Documents:
[RoHS Certificate of Compliance \(PDF\)](#)

General

Product Family	Application Tooling
Series	207121
Comments	See Tooling Specification (PDF) Above, See Tooling Specification (PDF) Above
Function	Extraction
Geographic Area	Global
Level of Automation	Manual
More Detailed Tech Information	applicationtooling@molex.com
Overview	Application Tooling
Product Name	MOX
Tool Type	Extraction Hand Tool
UPC	884982407350
Warranty Disclaimer	CAUTION: Molex tooling crimp specifications are valid only when used with Molex terminals and tooling manufactured by Molex and sold by Molex or authorized distributors ("Molex Tooling"). When using tooling other than Molex Tooling with Molex specific connector systems listed in our ATS documents, the Molex tooling qualification does not apply and the responsibility for full qualification of the connector system is that of the customer. Molex accepts no liability for connector performance or tooling support where tooling other than Molex Tooling is used or where Molex Tooling is modified.

Material Info

Reference - Drawing Numbers
[Application Tooling Documents](#) [ATS-638139500](#)

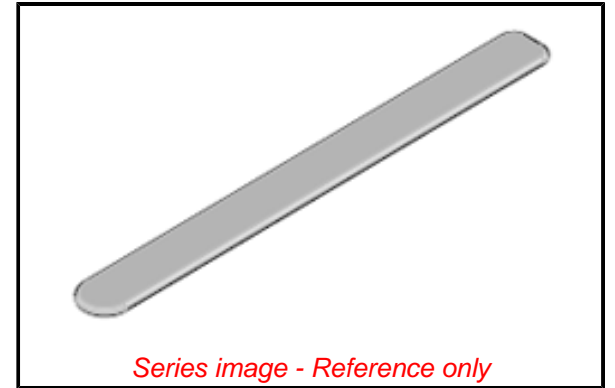

Series image - Reference only

EU ELV

Not Reviewed

EU RoHS

Not Reviewed

REACH SVHC

Not Reviewed

Halogen-Free

Status

Not Reviewed

For more information, please visit [Contact US](#)

China ROHS

Not Reviewed

ELV

Not Reviewed

RoHS Phthalates

Not Reviewed

Search Parts in this Series

[207121](#) Series

Use With

[98495](#) 35 Circuit Hybrid Female Receptacle Housing

Application Tooling | [FAQ](#)

Description	Product #
2.54mm Pitch MOX FFC/FPC Crimp Terminal, Female, 0.635mm , Reel, Tin (Sn), Crimp NSCC Receptacle	981941211
Terminal Size 1.5, Wire Size 0.22 up to 0.44mm ²	988971109
NSCC Receptacle Terminal Size 1.5, Wire Size 0.49 up to 0.94mm ²	988971119
NSCC Receptacle Terminal Size 1.5, Wire Size 0.95 up to 1.87mm ²	988971129

This document was generated on 03/28/2019

PLEASE CHECK WWW.MOLEX.COM FOR LATEST PART INFORMATION