

PART NUMBER	DIM A	DIM B	DIM C	PACKAGING
47053-1000	3.50	13.50	7.50	470530000-PK
47053-3000	4.00	13.84	7.34	470530000-PK
47053-5000	3.50	13.50	7.50	470535000-PK

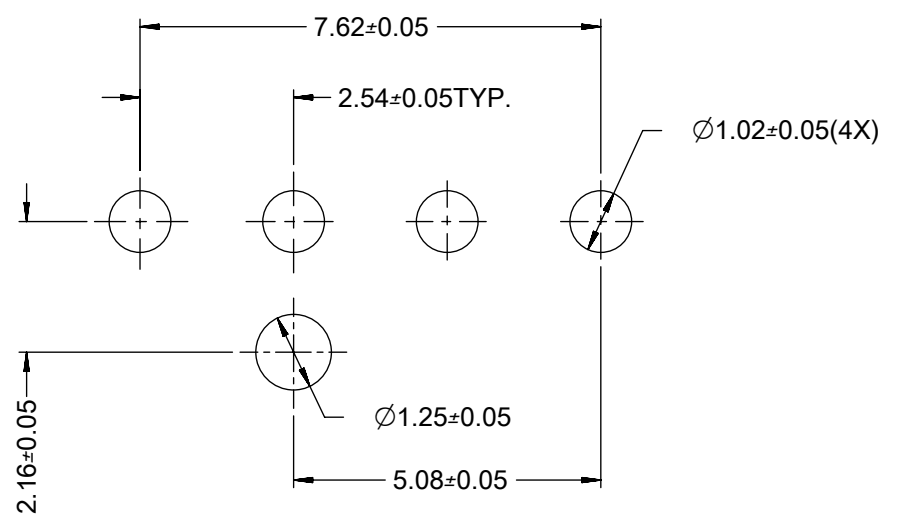
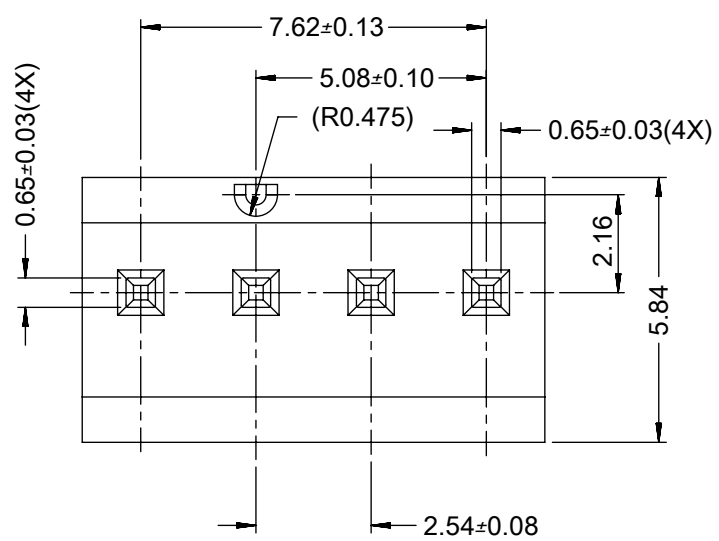

RECOMMENDER PCB LAYOUT

- NOTES:
- MATERIAL: HOUSING: NYLON, UL94V-0. COLOR: NATURAL (WHITE). PIN: COPPER ALLOY.
 - PLATING: 0.00254 MIN. MATTE TIN OVER 0.00127 MIN. NICKEL
 - PACKAGING SPECIFICATION: SEE TABLE
 - PARTS CONFORM TO PRODUCT SPEC PS-47053-001.
 - MATES WITH 47054 SERIES.
 - THIS PART CONFORMS TO CLASS B REQUIREMENTS OF COSMETIC SPECIFICATION PS-45499-002
 - PIN PUSH OUT FORCE: 0.91KgF.
 - SOLDERABILITY: PER SMES-152

PENDING APPROVAL

THIS DRAWING CONTAINS INFORMATION THAT IS PROPRIETARY TO MOLEX ELECTRONIC TECHNOLOGIES, LLC AND SHOULD NOT BE USED WITHOUT WRITTEN PERMISSION																	
SYMBOLS		DIMENSION UNITS		SCALE		CURRENT REV DESC: ADDED 470535000											
▽ = 0 ▽ = 0 ▽ = 0 ▽ = 0 ▽ = 0 ▽ = 0 ▽ = 0 ▽ = 0 ▽ = 0 ▽ = 0 ▽ = 0		mm										4 PIN HEADER HOUSING WITH FRICTION LOCK					
GENERAL TOLERANCES (UNLESS SPECIFIED)		ANGULAR TOL		± 3.0°		EC NO: 620463		PRODUCT CUSTOMER DRAWING									
4 PLACES ±		3 PLACES ±		2 PLACES ± 0.2		DRWN: SS06						DOCUMENT NUMBER: SD-47053-001					
1 PLACE ± 0.25		0 PLACES ±		DRAFT WHERE APPLICABLE MUST REMAIN WITHIN DIMENSIONS		THIRD ANGLE PROJECTION		DRAWING		SERIES		MATERIAL NUMBER		CUSTOMER		SHEET NUMBER	
						B-SIZE		47053		SEE TABLE		GENERAL MARKET		1 OF 1			

DOCUMENT STATUS	RQ	RELEASE DATE	
-----------------	----	--------------	--