

DO NOT SCALE FROM THIS PRINT

Pb THIS PRODUCT MANUFACTURED WITH LEAD-FREE PROCESSING

DESIGNED & DIMENSIONED IN MILLIMETERS [INCHES]

MMCX-P-C-X-RA-CA1

GENDER
-P: PLUG

TERMINATION
-CA1: CABLE
(RG174 OR RG316)

TYPE
-C: CABLE

ORIENTATION
-RA: RIGHT ANGLE

PLATING SPECIFICATION
-H: 30μ" GOLD CENTER CONTACT,
3μ" GOLD OUTER CONTACT
(SEE TABLE 1)

TABLE 1		
ITEM	COMPONENT	-H
1	SUB ASSEMBLY	SUB-MMCX-P-C-HF-RA-CA1
2	FERRULE	MCX-FER-002-F
3	INSULATOR	MMCX-INS-001
4	CAP	MMCX-CAP-001-F

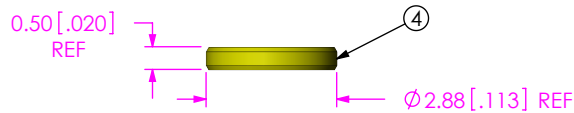
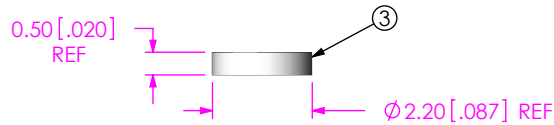
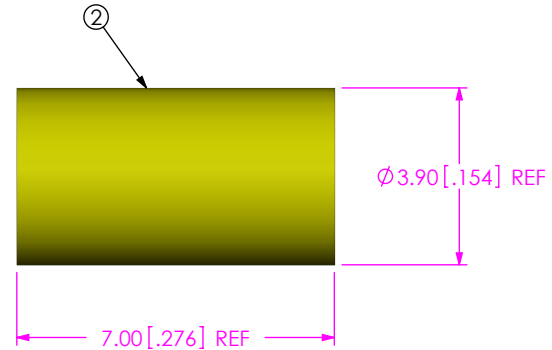
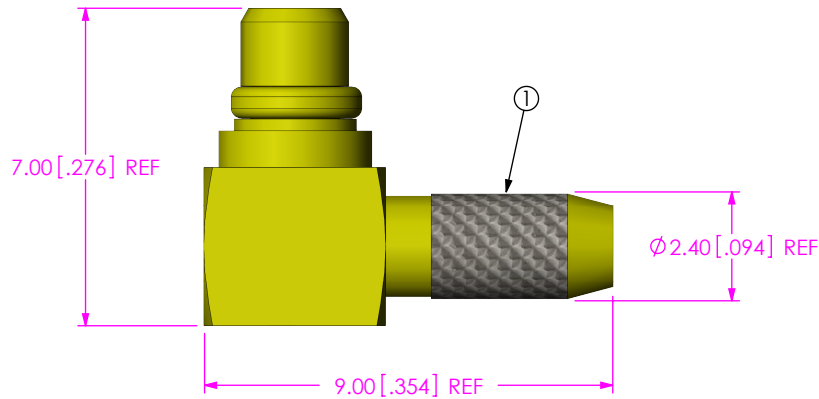

NOTES:

- ① REPRESENTS A CRITICAL DIMENSION.
- CENTER CONTACT PUSHOUT FORCE: 26.69 N [6LB] MIN
- NOTE DELETED.
- NOTE DELETED.
- PRODUCT TO BE PACKAGED PER PACKAGING STANDARD CO-RF-WI-3040-M.
- NOTE DELETED.
- NOTE DELETED.
- NOTE DELETED.

F:\DWG\MISC\MKTG\MMCX-P-C-X-RA-CA1-MKT.SLDDRW

<p>UNLESS OTHERWISE SPECIFIED, DIMENSIONS ARE IN MILLIMETERS [INCHES]. TOLERANCES ARE: DECIMALS ANGLES .X: ±0.3 [0.1] 5° .XX: ±0.13 [0.05] .XXX: ±0.051 [0.020]</p>	<p>PROPRIETARY NOTE THIS DOCUMENT CONTAINS CONFIDENTIAL AND PROPRIETARY INFORMATION AND ALL DESIGN, MANUFACTURING, REPRODUCTION, USE, PATENT RIGHTS AND SALES RIGHTS ARE EXPRESSLY RESERVED BY SAMTEC, INC. THIS DOCUMENT SHALL NOT BE DISCLOSED, IN WHOLE OR PART, TO ANY UNAUTHORIZED PERSON OR ENTITY NOR REPRODUCED, TRANSFERRED OR INCORPORATED IN ANY OTHER PROJECT IN ANY MANNER WITHOUT THE EXPRESS WRITTEN CONSENT OF SAMTEC, INC.</p>	 <p>520 PARK EAST BLVD, NEW ALBANY, IN 47150 PHONE: 812-944-6733 FAX: 812-948-5047 e-Mail info@SAMTEC.com code 55322</p> <p>DESCRIPTION: MMCX R/A CABLE PLUG, RG174 & RG316- 50 OHM DWG. NO. MMCX-P-C-X-RA-CA1 BY: R MUSSER 02/06/2008 SHEET 1 OF 2</p>
<p>MATERIAL: DO NOT SCALE DRAWING SHEET SCALE: 6:1 SHELL, FERRULE, CAP: BRASS CONTACT: BRASS DIELECTRIC: PTFE</p>		



1.50±0.30 [.059±.012]



2.70±0.30 [.106±.012]



7.60±0.30 [.299±.012]

RG174 OR RG316 CABLE



IN-PROCESS 1
STRIP AND TIN INNER CONDUCTOR

0.05 [.002] REF
TO CENTER CONTACT

Ø0.41 [.016] REF

1.70 [.067] REF
TO INSULATOR

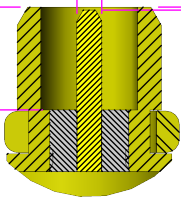

DETAIL 'A'
SCALE 8:1

END OF CABLE DIELECTRIC
SHOULD NOT SEAT AGAINST
CONTACT CUP

CABLE CENTER CONDUCTOR
SHOULD NOT PROTRUDE
OUTSIDE CONTACT CUP AFTER
FERRULE IS CRIMPED

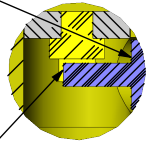

DETAIL 'C'



0.00±0.10 [.000±.004]

DETAIL 'B'
SCALE 5:1



Ø2.40 [.094]
(MIN. FLARED ID)

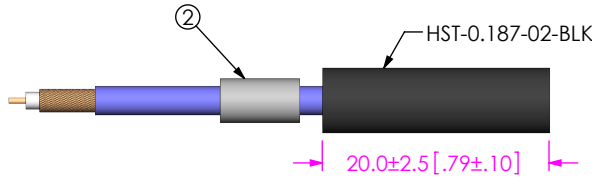

IN-PROCESS 2
ADD HEAT SHRINK TUBE AND FERRULE

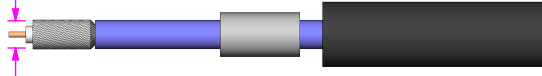

IN-PROCESS 3
FLARE SHIELD

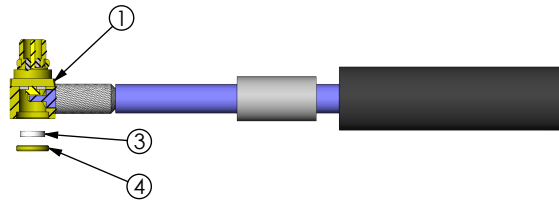

IN-PROCESS 4
ADD SUB ASSEMBLY

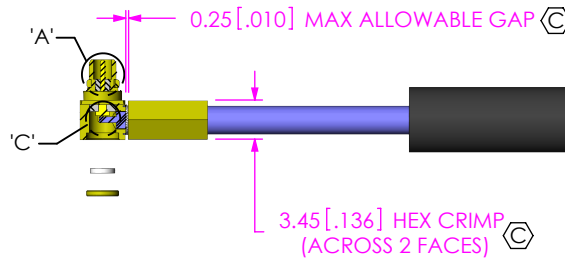

IN-PROCESS 5
CRIMP FERRULE & SOLDER SIGNAL PIN
(USE RF CRIMP HAND TOOL #CAT-RF-FER-001 AND 0.128" DIE SIZE)



IN-PROCESS 6
INSERT INSULATOR AND CAP



IN-PROCESS 7
APPLY HEAT SHRINK TUBING

F:\DWG\MISC\MKTG\MMCX-P-C-X-RA-CA1-MKT.SLDDRW

PROPRIETARY NOTE

THIS DOCUMENT CONTAINS CONFIDENTIAL AND PROPRIETARY INFORMATION AND ALL DESIGN, MANUFACTURING, REPRODUCTION, USE, PATENT RIGHTS AND SALES RIGHTS ARE EXPRESSLY RESERVED BY SAMTEC, INC. THIS DOCUMENT SHALL NOT BE DISCLOSED, IN WHOLE OR PART, TO ANY UNAUTHORIZED PERSON OR ENTITY NOR REPRODUCED, TRANSFERRED OR INCORPORATED IN ANY OTHER PROJECT IN ANY MANNER WITHOUT THE EXPRESS WRITTEN CONSENT OF SAMTEC, INC.

DO NOT SCALE DRAWING

SHEET SCALE: 6:1



520 PARK EAST BLVD, NEW ALBANY, IN 47150
PHONE: 812-944-6733 FAX: 812-948-5047
e-Mail info@SAMTEC.com code 55322

DESCRIPTION:
MMCX R/A CABLE PLUG, RG174 & RG316- 50 OHM

DWG. NO.
MMCX-P-C-X-RA-CA1

BY: R MUSSER 02/06/2008 SHEET 2 OF 2