

REVISIONS					
P	LTR	DESCRIPTION	DATE	DWN	APVD
A		REVISED PER ECN-22-182178	02NOV2022	PT	SZ

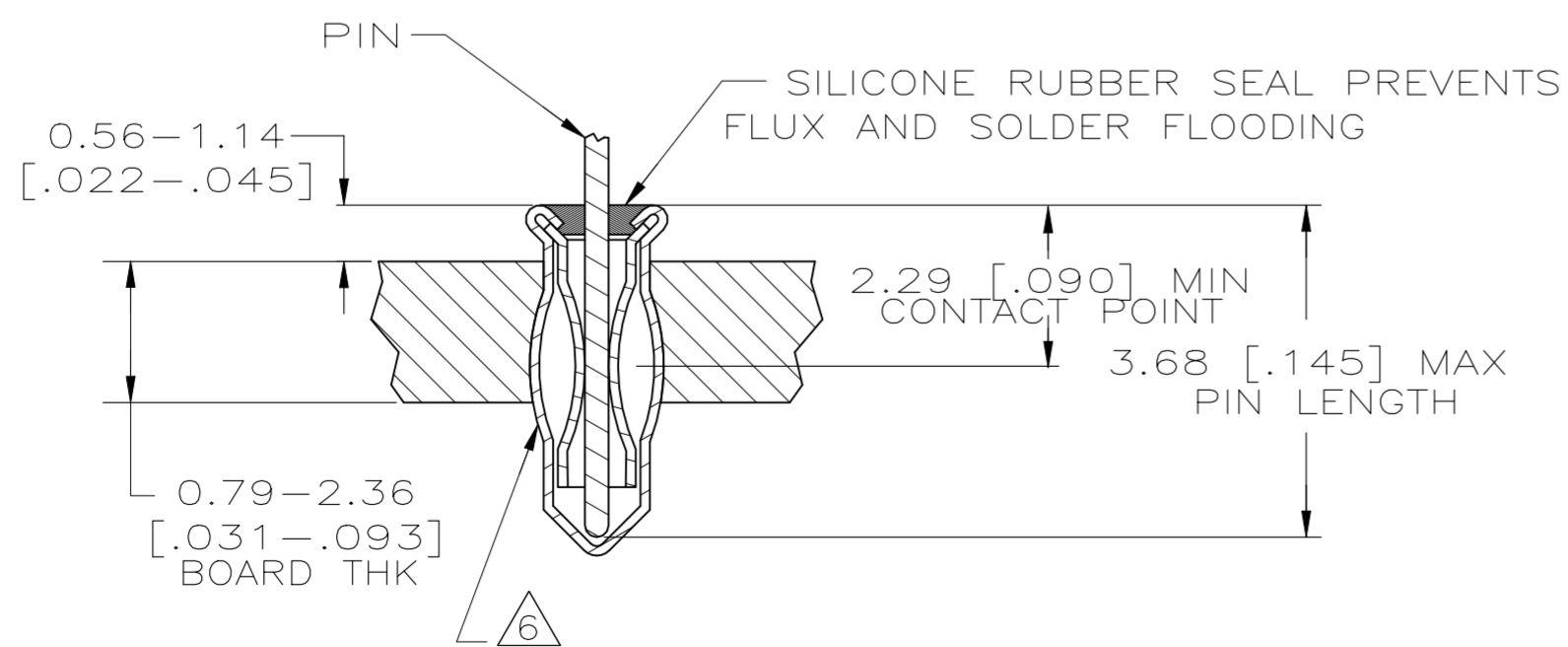
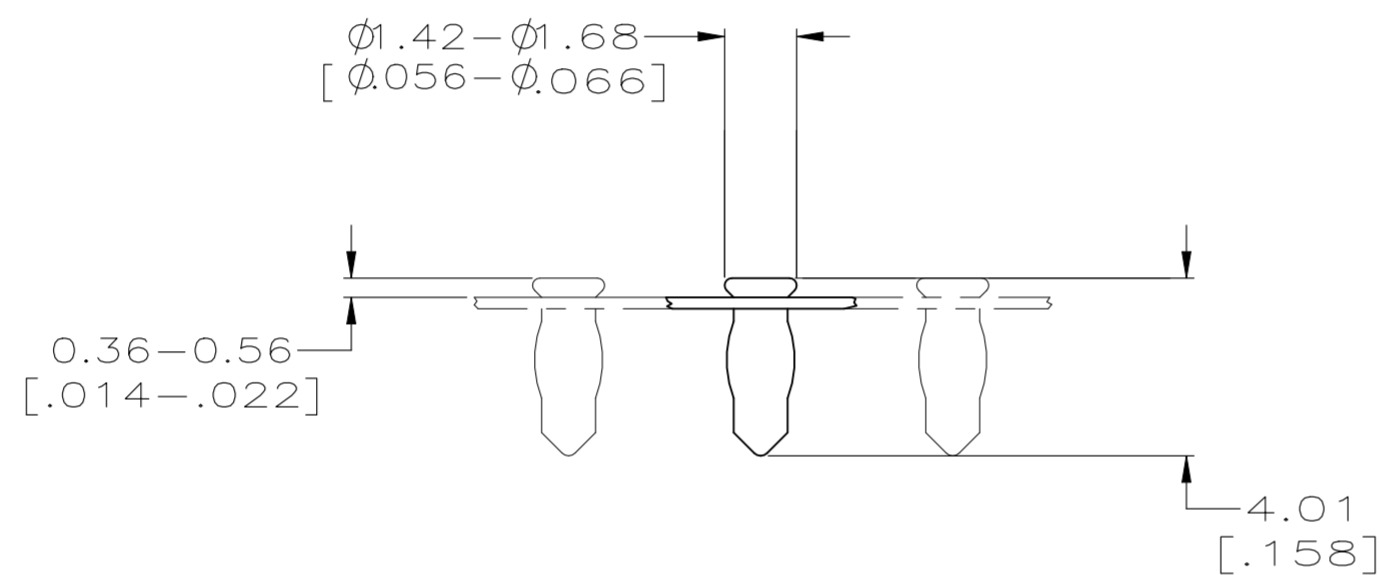
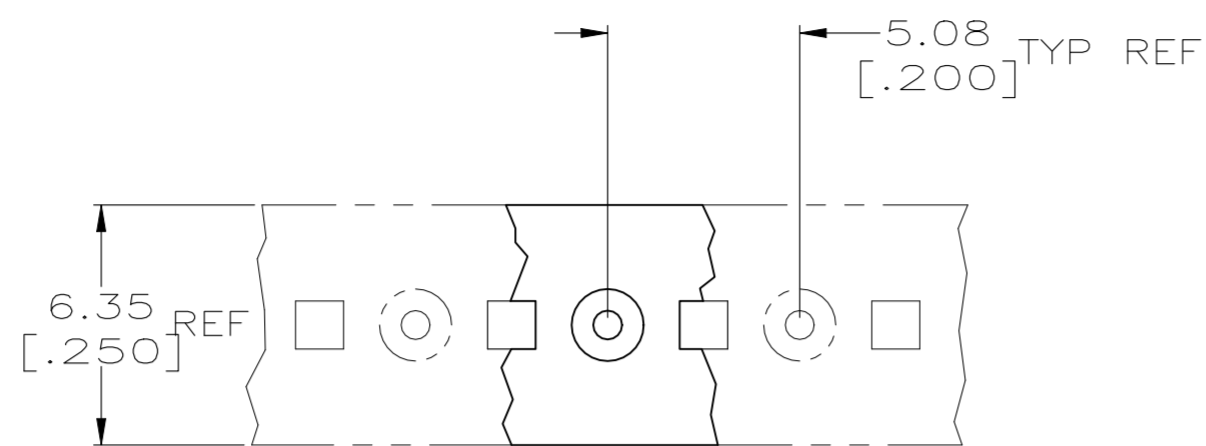

- 1 MATERIAL:  
EYELET - COPPER PER ASTM B 152  
SPRING - BERYLLIUM COPPER PER ASTM B 194  
SEALANT - SILICONE RUBBER
- 2 TIN PLATE PER ASTM B 545, [.000100] MIN THK.
- 3 GOLD PLATE PER ASTM B 488, 0.00076 [.000030] MIN THK ON CONTACT AREA.
- 4 PACKAGED 50,000 PER REEL
- 5 TO INSURE 1/2 OZ MIN RETENTION DO NOT EXCEED 0.10 [.004] DIFFERENCE IN PIN DIA WHEN CHANGING TO A SMALLER DIA PIN
- 6 PRODUCT IS OVALIZED FOR RETENTION IN THE P.C. BOARD. THE RECOMMENDED HOLE DIAMETER IS  $\phi 1.07$  [ $\phi 042$ ] MINIMUM, +0.08 [.003] MAX. PRIOR TO SOLDERING.
- 7 PACKAGED 10,000 PER REEL
- 8 OBSOLETE PARTS: OBSOLETE CIS STREAMLINING PER D.RENAUD/D.SINISI

8 OBSOLETE	2.29-3.68 [.090-.145]	$\phi 0.38-\phi 0.53$ [.015-.021]	GOLD 3	TIN 2	7	1-5645947-6
	2.29-3.68 [.090-.145]	$\phi 0.30-\phi 0.46$ [.012-.018]	GOLD 3	TIN 2	7	1-5645947-5
	2.29-3.68 [.090-.145]	$\phi 0.38-\phi 0.53$ [.015-.021]	GOLD 3	TIN 2	7	1-5645947-2
	2.29-3.68 [.090-.145]	$\phi 0.38-\phi 0.53$ [.015-.021]	GOLD 3	TIN 2	4	5645947-2
	2.29-3.68 [.090-.145]	$\phi 0.38-\phi 0.53$ [.015-.021]	TIN 2	TIN 2	4	5645947-1
	LENGTH	DIA	FINISH		PART NO	

THIS DRAWING IS A CONTROLLED DOCUMENT.

DIMENSIONS: mm [INCHES]	TOLERANCES UNLESS OTHERWISE SPECIFIED: 0 PLC ± - 1 PLC ± - 2 PLC ± - 3 PLC ± 0.20[.008] 4 PLC ± - ANGLES ± -	DWN J. POLIGNONE 26JAN06 CHK J. HAVENER 26JAN06 APVD J. HAVENER 26JAN06		
MATERIAL 1	FINISH SEE TABLE	PRODUCT SPEC 108-14008 APPLICATION SPEC 114-26004	NAME MINIATURE SPRING SOCKET ASSY SERIES 1 SHORT WITH SEALANT	
CUSTOMER DRAWING		WEIGHT 0.000000	SIZE A2	CAGE CODE 00779
		SCALE 10:1	DRAWING NO C=5645947	RESTRICTED TO -
		SHEET 1 of 1	REV A	