

MTG. EAR NOT SHOWN FOR CKT. I.D. CLARITY

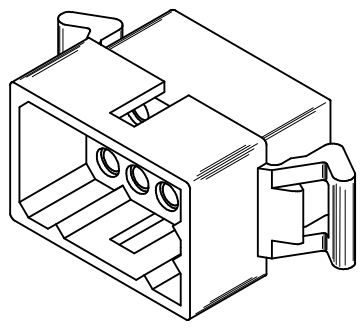

PLUG HOUSING

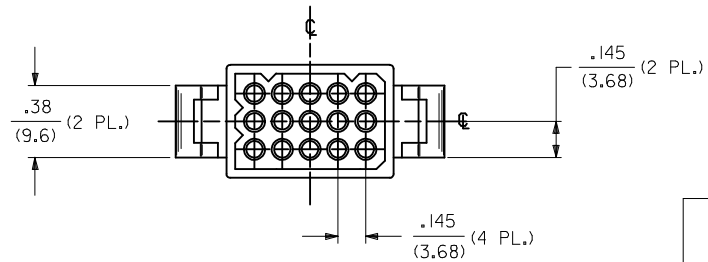

<b>PK SPEC</b> EC NO: UCP2015-0466 DRWN: JDFOX CHKD: MKIPPER APPR: FSMITH	2014/08/05 2014/08/05 2014/08/14	DESCRIPTION REV	QUALITY SYMBOLS	GENERAL TOLERANCES (UNLESS SPECIFIED)	DIMENSION STYLE	SCALE	DESIGN UNITS	THIRD ANGLE PROJECTION
			$\nabla = 0$ $\nabla = 0$ $\nabla = 0$	± mm    ± INCH 4 PLACES ± --- ± --- 3 PLACES ± --- ± .010 2 PLACES ± 0.25 ± .014 1 PLACE ± 0.35 ± --- 0 PLACE ± --- ± ---	IN/MM DRAWN BY DATE JDFOX 2014/08/05 CHECKED BY DATE MKIPPER 2014/08/05 APPROVED BY DATE FSMITH 2014/08/14	2:1 INCH	TITLE .062 HOUSING, PLUG AND RECEPTACLE, 15 CIRCUIT, .145 CENTERS <b>molex</b>	
			ANGULAR ±1/2° DRAFT WHERE APPLICABLE MUST REMAIN WITHIN DIMENSIONS	MATERIAL NO. <b>SEE CHART</b>	DOCUMENT NO. SD-1625-15*	SHEET NO. 1 OF 3		
			SIZE THIS DRAWING CONTAINS INFORMATION THAT IS PROPRIETARY TO MOLEX INCORPORATED AND SHOULD NOT BE USED WITHOUT WRITTEN PERMISSION					

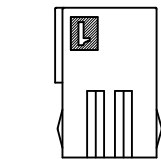
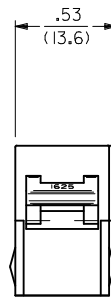
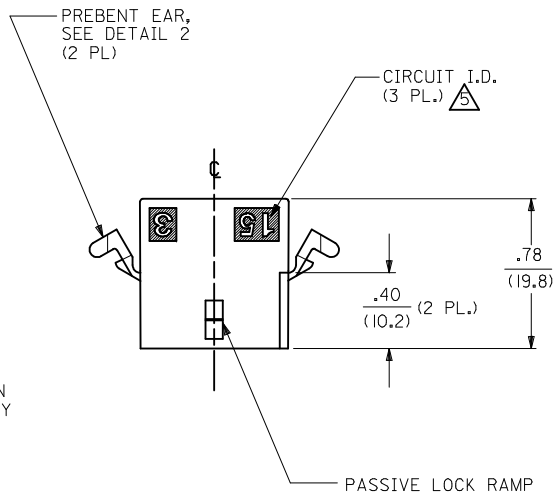
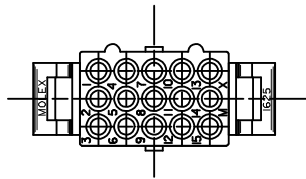

MTG. EAR NOT SHOWN FOR CKT. I.D. CLARITY

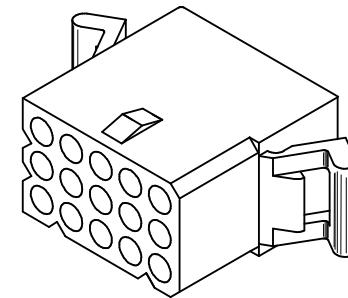
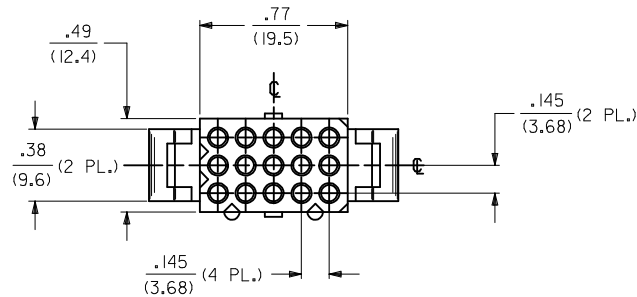

RECEPTACLE HOUSING

<b>SEE SHEET 1</b> IEC NO: UCP2015-0466 2014/08/05 DRWN:IDFOX 2014/08/05 CHKD:MKIPPER 2014/08/14 APPR:FSMITH	DESCRIPTION Q3	QUALITY SYMBOLS ▽=0 ▽=0 ▽=0	GENERAL TOLERANCES (UNLESS SPECIFIED)		DIMENSION STYLE IN/MM		SCALE 2:1	DESIGN UNITS INCH	THIRD ANGLE PROJECTION		
				DRAWN BY JDFOX	DATE 2014/08/05			TITLE .062 HOUSING, PLUG AND RECEPTACLE, 15 CIRCUIT, .145 CENTERS			
				CHECKED BY MKIPPER	DATE 2014/08/05			MATERIAL NO. SEE CHART			
				APPROVED BY FSMITH	DATE 2014/08/14			DOCUMENT NO. SD-1625-15*		SHEET NO. 2 OF 3	
DRAFT WHERE APPLICABLE MUST REMAIN WITHIN DIMENSIONS			ANGULAR ±1/2°		SIZE C		THIS DRAWING CONTAINS INFORMATION THAT IS PROPRIETARY TO MOLEX INCORPORATED AND SHOULD NOT BE USED WITHOUT WRITTEN PERMISSION				

PLUG	
PART NO.	ENG. NO.
03-06-2151	1625-15P
03-06-7155	1625-15P IBN
03-06-7152	1625-15P IBK
03-06-2152	1625-15P I
03-06-7151	1625-15PBK
03-06-7153	1625-15PBN
03-06-7154	1625-15PBU

RECEPTACLE	
PART NO.	ENG. NO.
03-06-1152	1625-15R I
03-06-6152	1625-15R IBK
03-06-6155	1625-15R2
NOT TOOLED	1625-15R2BK

**RECEPTACLE LEGEND:**

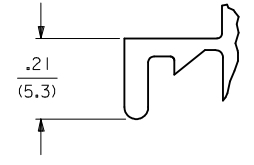
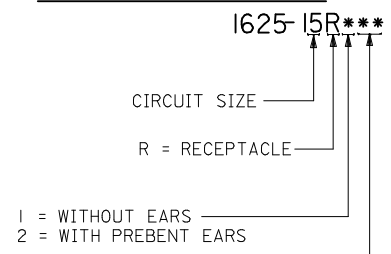

**DETAIL 1**  
STANDARD MOUNTING EAR  
SCALE 4:1

**PLUG LEGEND:**

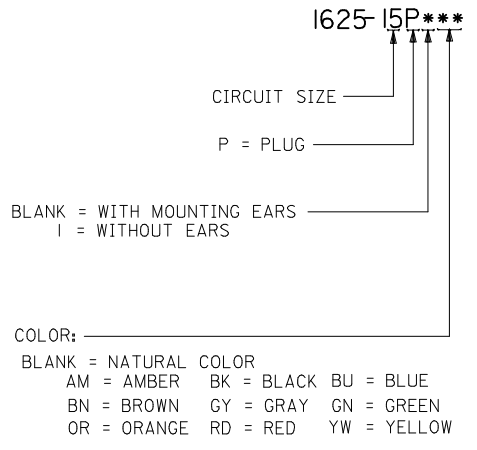

COLOR: \_\_\_\_\_  
BLANK = NATURAL COLOR  
AM = AMBER BK = BLACK BU = BLUE  
BN = BROWN GY = GRAY GN = GREEN  
OR = ORANGE RD = RED YW = YELLOW

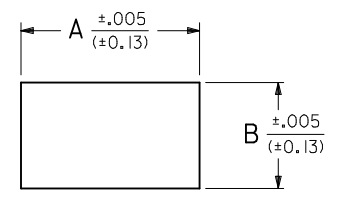
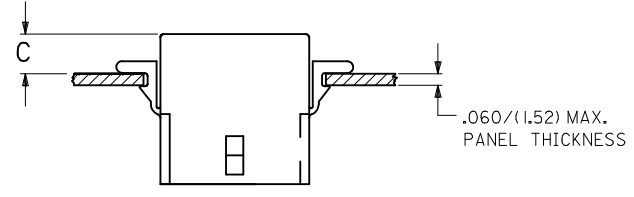

**RECOMMENDED HOLE PATTERN**

RECEP.	.930 (23.62)	.569 (14.45)		.22 (5.6)
PLUG	1.032 (26.21)	.620 (15.75)	.20 (5.1)	.21 (5.3)
PART	DIM. A	DIM. B	DIM. C (STANDARD EAR)	DIM. C (PREBENT EAR)

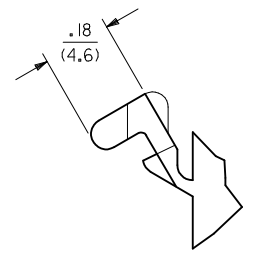
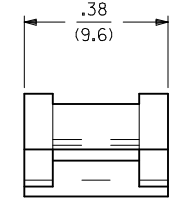

**DETAIL 2**  
.062/(1.57)PREBENT MOUNTING EAR  
(SCALE 4:1)

**NOTES:**

1. MATERIAL: NYLON TYPE 6/6, UL94V-2, COLOR: SEE LEGEND
2. FINISH: NONE
3. THIS PART COMPLIES WITH MOLEX PRODUCT SPEC. PS-02-06.
4. PACKAGING SPECIFICATION: PK-1625-003.
5. CIRCUIT I.D. NUMBERS ON HOUSING APPEAR ON PART FROM TOOLS BUILT AFTER 1/15/94.
6. THIS HOUSING FOR USE WITH .062/(1.57) DIA. TERMINALS.
7. WHERE DENOTED IN CHART, TOOLS ARE BUILT WITH PREBENT MOUNTING EARS PER DETAIL 2 AND SUPERSEDE ALL TOOLS PREVIOUSLY BUILT WITH THE STANDARD MOUNTING EARS.
8. PARTS CONFORM TO CLASS B REQUIREMENTS OF COSMETIC SPECIFICATION PS-45499-002.

REV	DESCRIPTION	QUALITY SYMBOLS
Q3	SEE SHEET 1 EC NO: UCP2015-0466 DRWN: JDFOX 2014/08/05 CHKD: MKIPPER 2014/08/05 APPR: FSMITH 2014/08/14	

GENERAL TOLERANCES (UNLESS SPECIFIED)

	mm	INCH
4 PLACES	± .---	± .---
3 PLACES	± .---	± .010
2 PLACES	± 0.25	± .014
1 PLACE	± 0.35	± .---
0 PLACE	± .---	± .---

ANGULAR ±1/2°  
DRAFT WHERE APPLICABLE MUST REMAIN WITHIN DIMENSIONS

DIMENSION STYLE		SCALE	DESIGN UNITS	THIRD ANGLE PROJECTION
IN/MM		2:1	INCH	
DRAWN BY	DATE	TITLE		
JDFOX	2014/08/05	.062 HOUSING, PLUG AND RECEPTACLE, 15 CIRCUIT, .145 CENTERS		
CHECKED BY	DATE	<b>molex</b>		
MKIPPER	2014/08/05			
APPROVED BY	DATE	DOCUMENT NO. SD-1625-15*		
FSMITH	2014/08/14	SHEET NO. 3 OF 3		

THIS DRAWING CONTAINS INFORMATION THAT IS PROPRIETARY TO MOLEX INCORPORATED AND SHOULD NOT BE USED WITHOUT WRITTEN PERMISSION