

PART NUMBER	REV	TERMINATOR	FEED TYPE	DESCRIPTION
1530490-1	1	LEADMAKER	PNEUMATIC FEED	CUTS CARRIER
1530490-2	1	BENCH	PNEUMATIC FEED	CUTS CARRIER
1530490-6	1	LEADMAKER	PNEUMATIC FEED	CONTINUOUS CARRIER
7-1530490-1	1	LEADMAKER	PNEUMATIC FEED	-1 AND SPARE PARTS
7-1530490-2	1	BENCH	PNEUMATIC FEED	-2 AND SPARE PARTS
7-1530490-6	1	LEADMAKER	PNEUMATIC FEED	-6 AND SPARE PARTS
7-1530490-7	1	-	-	SPARE PARTS KIT

CRIMP DATA		TE TERMINAL	TE CRIMP SPECS
TERMINAL NAME: FEMALE TERMINAL 0.50/0.75mm ²			
CRIMP	SIZE	TYPE	RANGE
WIRE	1.78 [.070 IN]	F	0.50-0.75mm ²
INSUL	1.73 [.068 IN]	S	Ø1.60-1.90 [.063-.075 IN]
WIRE STRIP LENGTH 4.40 [.173 IN]		APPL INSTRUCTIONS 411-3283	
TERMINAL APPL SPEC 114-13060		FEED 8.00 [.315 IN]	
TERMINALS APPLIED			
TE PN			
1393365-1	1438299-3	-	-
1393365-2	1438299-4	-	-
1393366-1	-	-	-
1393366-2	-	-	-
WIRE SIZE	CRIMP HEIGHT	REF SETTING	
0.75mm ²	1.10 ±0.05 [.043 ±.002 IN]	B1	
0.50mm ²	1.02 ±0.05 [.040 ±.002 IN]	B8	

- △ RECOMMENDED SPARE PARTS.
- △ GREASE RAM, CAM, CAM FOLLOWER AND FEED ROD LIGHTLY.
- △ CERTAIN TERMINALS REQUIRE LUBRICATION. REFER TO THE APPLICATOR INSTRUCTIONS SHEET FOR MORE INFORMATION.
- 4. LUBRICATE DAILY PER THE APPLICATOR INSTRUCTION SHEET SUPPLIED WITH THE APPLICATOR.
- △ INSULATION CRIMP HEIGHT NOT TO EXCEED 2.10mm FOR ALL WIRE SIZES.
- △ WIDTH OF TERMINAL, ALONG ITS ENTIRE LENGTH, MUST NOT EXCEED 2.05mm.

* WARNING
ON INSTALLATION, SET WIRE DISC TO LARGEST WIRE SIZE SETTING. USE OF SETTINGS BELOW MIN. REQUIRED CRIMP HEIGHT SETTING WILL CAUSE DAMAGE TO CRIMP TOOLING.

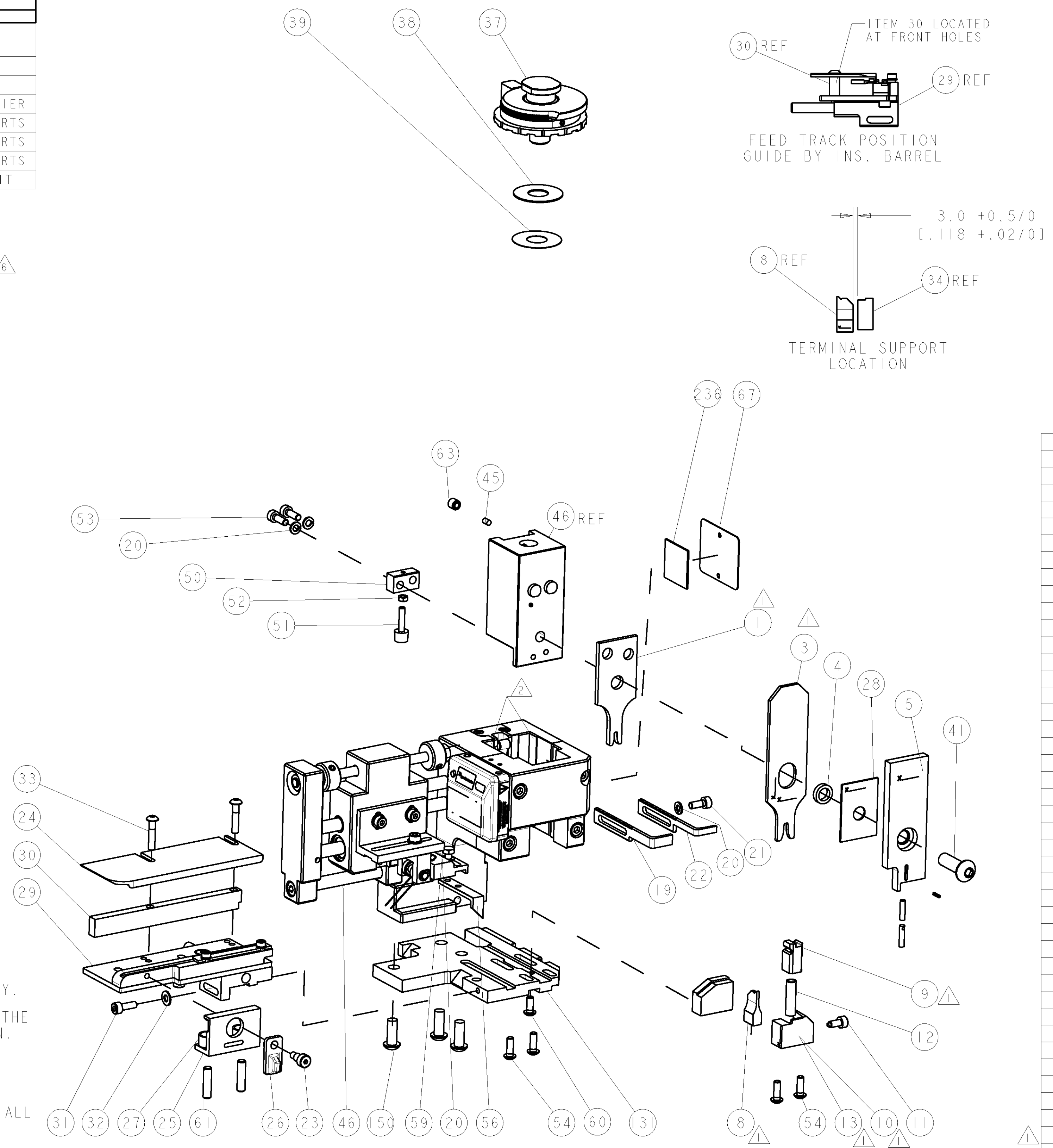

LOC	DIST	REV	DATE	BY	APPD
A	66	1	23FEB2011	RS	SX

QTY	AR	AR	AR	AR	AR	AR	AR	PART NO	DESCRIPTION	ITEM NO
-	3	3	3	3	3	3	3	982057-2	TAPE, FOAM	236
-	-	-	-	-	-	-	-	994988-1	SCR, BTN SKT HD CAP M6X16.0 W/NYLOK	150
-	-	-	-	-	-	-	-	1320992-1	PLATE, BASE	131
-	-	-	-	-	-	-	-	1-22278-0	SPRING, COMPRESSION	77
-	-	-	-	-	-	-	-	854769-1	HOLDER, INS	74
-	-	-	-	-	-	-	-	1338705-8	DOCUMENTATION PACKAGE	71
-	-	-	-	-	-	-	-	1-461264-0	PLATE, IDENTIFICATION	67
-	-	-	-	-	-	-	-	3-18031-0	SCR, SET, CUP POINT M6 X 6.0	63
-	2	2	2	2	2	2	2	2-18032-5	SCR, SET, FLT POINT M5 X 20.0	61
-	-	-	-	-	-	-	-	18024-7	SCR, BTN SKT HD CAP (M4 X 10.0)	60
-	-	-	-	-	-	-	-	5-18022-2	SCR, HEX HD CAP M4 X 8.0	59
-	-	-	-	-	-	-	-	21028-2	PIN, SLOTTED SPRING .062 X .250	58
-	-	-	-	-	-	-	-	1338685-1	PAWL, FEED	56
-	4	4	4	4	4	4	4	18024-8	SCR, BTN SKT HD CAP (M4 X 12.0)	54
-	2	2	2	2	2	2	2	1-18023-2	SCR, SKT HD CAP M4 X 12.0	53
-	-	-	-	-	-	-	-	18030-1	NUT, HEX, REG M3	52
-	-	-	-	-	-	-	-	811242-5	BUMPER, HOLD DOWN	51
-	-	-	-	-	-	-	-	690753-2	SPACER, TONKER	50
-	-	-	-	-	-	-	-	1333303-1	ASSEMBLY, AIR FEED	46
-	-	-	-	-	-	-	-	690191-1	PLUG, NYLON	45
-	-	-	-	-	-	-	-	-	-	44
-	-	-	-	-	-	-	-	2-18024-6	SCR, BTN SKT HD CAP (M8 X 25.0)	41
-	-	-	-	-	-	-	-	690125-1	SHIM SUB-ASSY	39
-	-	-	-	-	-	-	-	469367-8	SHIM	38
-	-	-	-	-	-	-	-	879103-3	FINE ADJUST HEAD ASSEMBLY	37
-	-	-	-	-	-	-	-	1333246-2	SUPPORT, TERMINAL	34
-	2	2	2	2	2	2	2	1-18024-0	SCR, BTN SKT HD CAP (M4 X 20.0)	33
-	-	-	-	-	-	-	-	18027-2	WASHER, FLAT, REG M4	32
-	-	-	-	-	-	-	-	1-18023-2	SCR, SKT HD CAP M4 X 12.0	31
-	-	-	-	-	-	-	-	1320908-4	SPACER, STRIP GUIDE	30
-	-	-	-	-	-	-	-	1-1633073-7	STRIP GUIDE ASSEMBLY	29
-	-	-	-	-	-	-	-	455888-8	SPACER, CRIMPER	28
-	2	2	2	2	2	2	2	1-22284-0	SPRING, COMPRESSION	27
-	-	-	-	-	-	-	-	356835-1	LEVER, DRAG RELEASE	26
-	-	-	-	-	-	-	-	240792-1	DRAG, TERMINAL	25
-	-	-	-	-	-	-	-	1320928-3	PLATE, STRIP GUIDE	24
-	-	-	-	-	-	-	-	980371-4	SCR, SKT HD SHLDR 5.0 DIA X 6.0	23
-	-	-	-	-	-	-	-	690472-2	STRIPPER	22
-	-	-	-	-	-	-	-	1-18023-1	SCR, SKT HD CAP M4 X 10.0	21
-	4	4	4	4	4	4	4	18025-2	WASHER, SPRG LOCK, REG M4	20
-	-	-	-	-	-	-	-	690472-1	STRIPPER	19
-	-	-	-	-	-	-	-	1338684-1	SHEAR HOLDER, FRONT	13
-	-	-	-	-	-	-	-	3-22280-3	SPRING, COMPRESSION	12
-	-	-	-	-	-	-	-	356885-4	STOP, SHEAR	11
-	-	-	-	-	-	-	-	1320921-1	SHEAR HOLDER, FRONT, CUT	10
-	-	-	-	-	-	-	-	454276-1	FLOATING SHEAR, FRONT	9
-	1	2	2	2	1	1	1	1333231-1	ANVIL, COMBINATION, SPECIAL	8
-	-	-	-	-	-	-	-	-	-	7
-	-	-	-	-	-	-	-	-	-	6
-	-	-	-	-	-	-	-	854772-1	DEPRESSOR, SHEAR	5
-	-	-	-	-	-	-	-	4-238011-0	BLOCK, CRIMPER SPACER	4
-	1	2	2	2	1	1	1	9-683453-9	CRIMPER, INSULATION PREMIUM	3
-	-	-	-	-	-	-	-	-	-	2
-	1	2	2	2	1	1	1	5-562108-2	CRIMPER, WIRE, F	1

PROTOTYPE DESIGN NOT RELEASED FOR PRODUCTION

DIMENSIONS:	TOLERANCES UNLESS OTHERWISE SPECIFIED:	DRAWN	DATE	REV	DESCRIPTION	ITEM NO
mm [IN]	0 PLC ± 1 PLC ± 3 PLC ± 4 PLC ± ANGLES ±	SHEN	23FEB2011		TE CONNECTIVITY	
		CHK	23FEB2011		Harrisburg, PA 17105-3608	
		APPD	23FEB2011		NAME	
					PRODUCT SPEC	
					APPLICATION SPEC	
					See Table	
					SIZE	
					00779	
					1530490	
					CUSTOMER ACCESSIBLE PRODUCTION DRAWING	
					SCALE	
					3:5	
					SHEET	
					1	
					OF	
					REV	