

4

3

2

1

THIS DRAWING IS UNPUBLISHED. RELEASED FOR PUBLICATION. ALL RIGHTS RESERVED. © COPYRIGHT - TE Connectivity

| REVISIONS | | | | | |
|-----------|-----|---------------------------|-----------|-----|------|
| P | LTR | DESCRIPTION | DATE | DWN | APVD |
| N | | REVISED PER ECO-17-011181 | 04AUG2017 | RS | MZ |
| P | | REVISED PER ECO-18-000443 | 19JAN2018 | RS | MZ |
| R | | REVISED PER ECO-20-001562 | 04FEB2020 | SG | MZ |

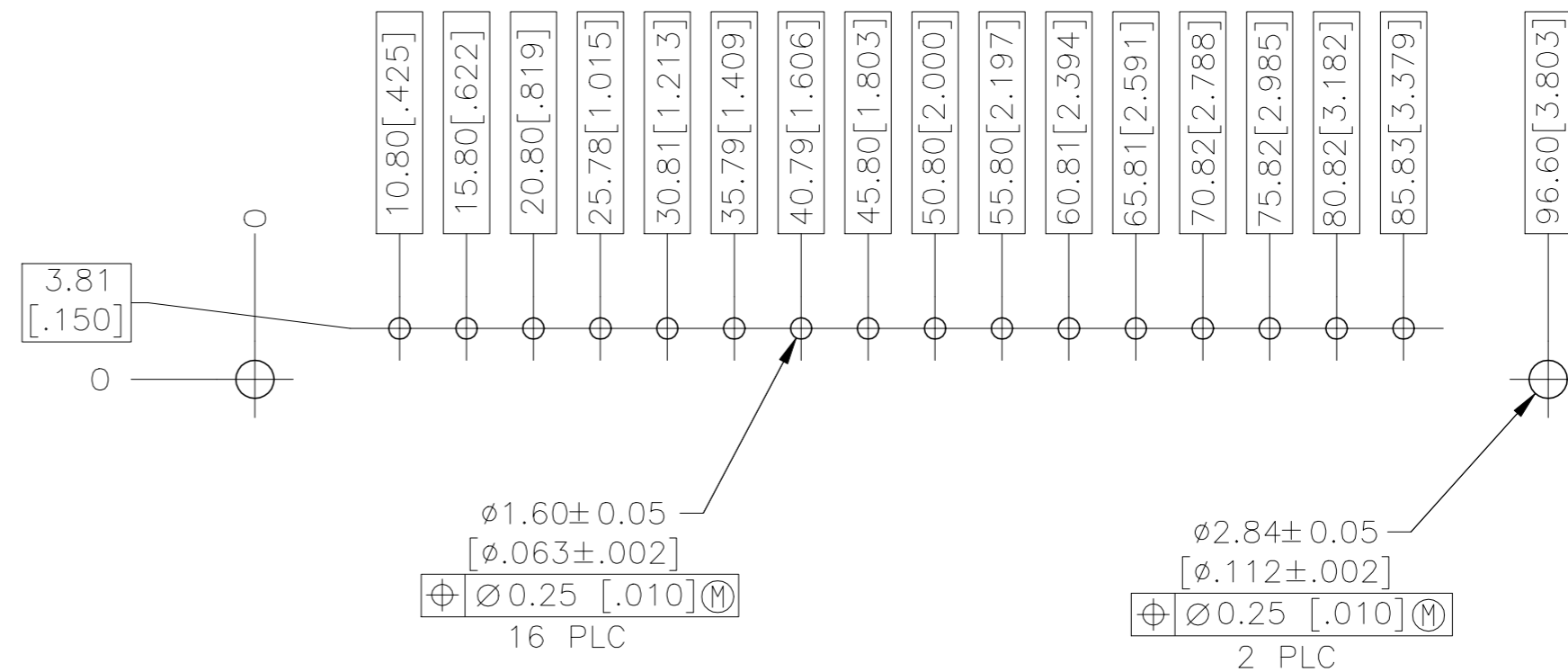
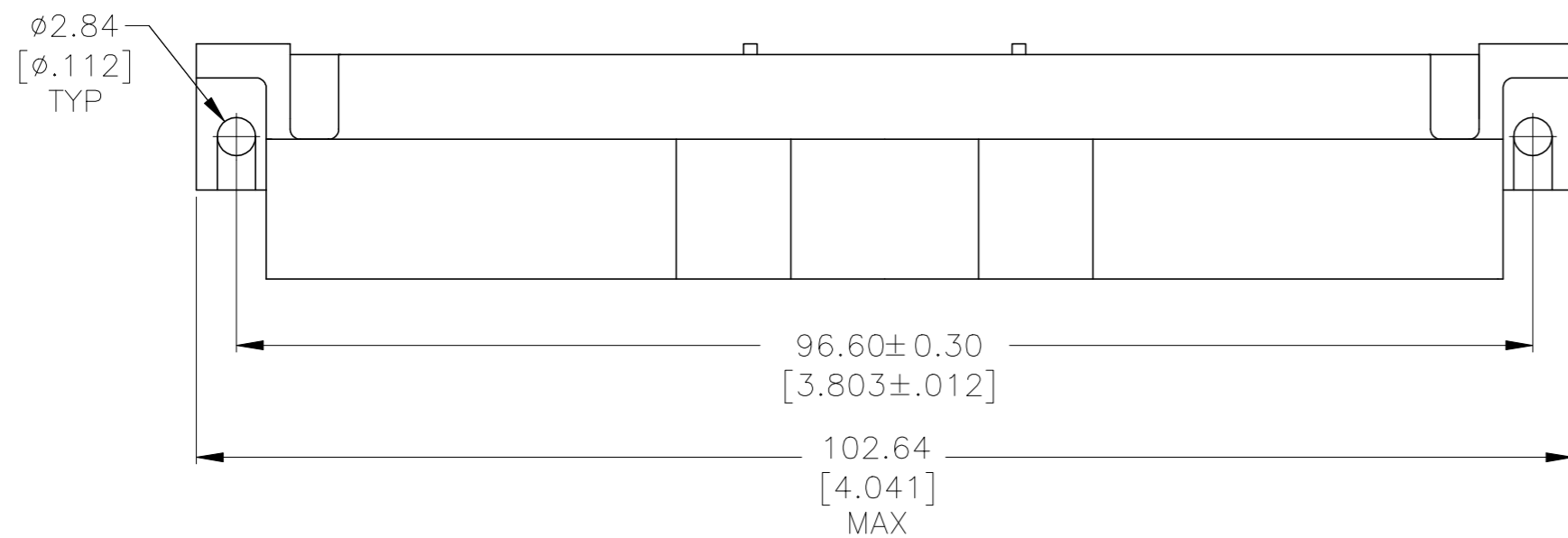

RECOMMENDED PC BOARD LAYOUT

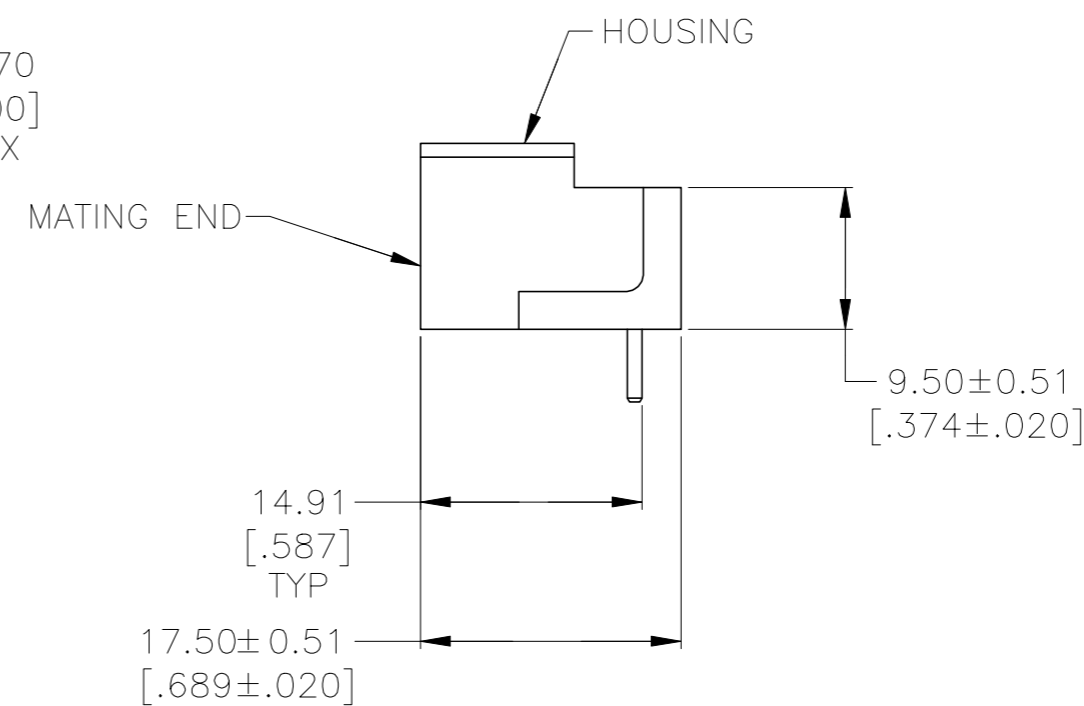
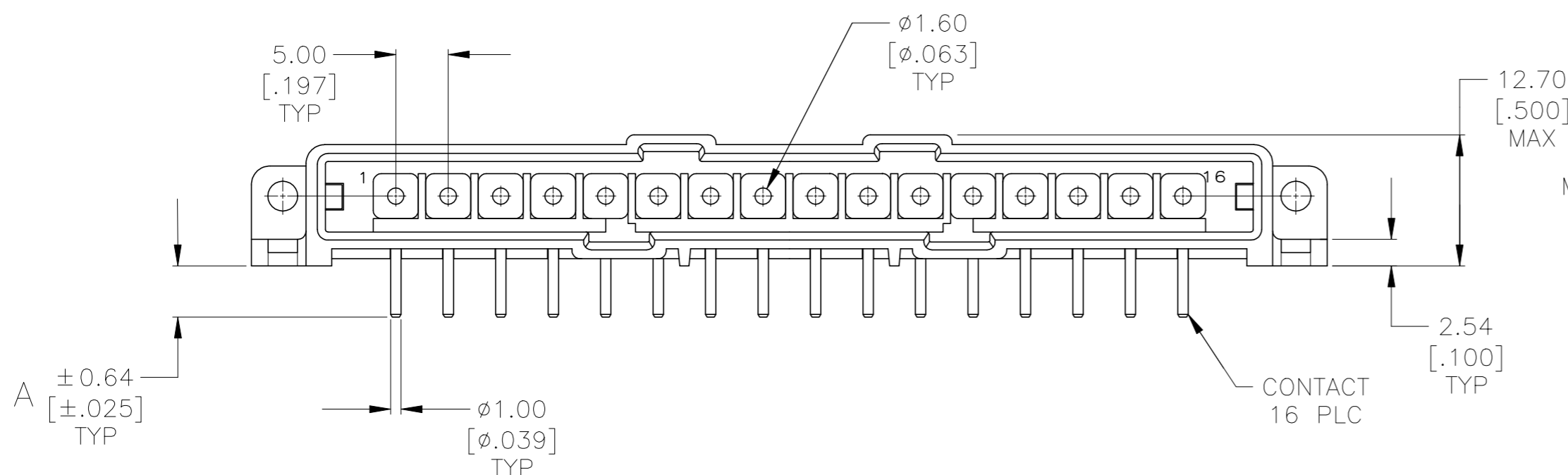

- 1 HOUSING MATERIAL: PA66, BLACK, UL 94 V-0 RATED.
- 2 BRASS PER ASTM B36.
- 3 3.81µm [.000150] MIN TIN-LEAD OVER 2.54µm [.000100] MIN COPPER OR 1.27µm [.000050] MIN NICKEL.
- 4 0.76µm [.000030] MIN GOLD FOR A LENGTH OF 5.08 [.200] MIN FROM MATING END, 3.81µm [.000150] MIN TIN-LEAD FOR A LENGTH OF 13.08 [.515] MIN FROM OPPOSITE END, BOTH OVER 1.27µm [.000050] MIN NICKEL.
- 5 0.76µm [.000030] MIN GOLD FOR A LENGTH OF 5.08 [.200] MIN FROM MATING END, 3.81µm [.000150] MIN TIN FOR A LENGTH OF 13.08 [.515] MIN FROM OPPOSITE END, BOTH OVER 1.27µm [.000050] MIN NICKEL.
- 6 .000150 MIN LEAD FREE TIN OVER .000100 MIN COPPER, OR .000050 MIN NICKEL.
- 7 PRELIMINARY PART NUMBER

| | | | |
|----------|------|--------|----------|
| OBSOLETE | .137 | 5 | 207544-9 |
| | .192 | 6 | 207544-8 |
| | .192 | 5 | 207544-7 |
| OBSOLETE | - | - | 207544-6 |
| OBSOLETE | .192 | 4 | 207544-3 |
| OBSOLETE | .192 | 3 | 207544-1 |
| | A | FINISH | PART NO |

| | | | | | | |
|--|--|-------------------|----------|---|----------------------|--|
| THIS DRAWING IS A CONTROLLED DOCUMENT. | | DWN | L.SIPE | 07/01/92 | TE Connectivity Ltd. | |
| DIMENSIONS: mm [INCHES] | | CHK | R.STONE | 7-8-92 | | |
| TOLERANCES UNLESS OTHERWISE SPECIFIED: | | APVD | A.TRAVIS | 7-8-92 | NAME | |
| 0 PLC ± - | | PRODUCT SPEC | | PIN HEADER ASSY, 16 POSN, IN-LINE, RIGHT ANG, SMALL METRIC CONNECTOR, METRIMATE | | |
| 1 PLC ± - | | APPLICATION SPEC | | SIZE | | |
| 2 PLC ± 0.25 [.010] | | FINISH | | CAGE CODE | | |
| 3 PLC ± - | | CONTACTS: SEE TBL | | DRAWING NO | | |
| 4 PLC ± - | | MATERIAL | | RESTRICTED TO | | |
| ANGLES ± - | | HOUSING: 1 | | A2 00779 C=207544 | | |
| MATERIAL | | WEIGHT | | CUSTOMER DRAWING | | |
| SCALE | | SHEET | | REV | | |
| 2:1 | | 1 of 1 | | R | | |