



ANATECH ELECTRONICS INC
RF & Microwave Filters & Products

800 MHz LC Bandpass Filter

Part Number: AE800B6360



Electrical Specifications

Center Frequency: 800 MHz
Bandwidth: 200 MHz
Passband Frequencies: 700 MHz to 900 MHz
Insertion loss: <3dB
VSWR: <1.5:1
Impedance: 50 Ohms
Rejection: >50dB @ 0- 400 MHz
Rejection2: >50dB @ 1100-1500 MHz
Rejection3: >60dB @ 1200 MHz

Mechanical

Mounting Method : Surface Mount
Connector Type: RF Pins 0.020 input pins
Dimensions: 1.5" X 0.5" x 0.4" in.

Environmental

Operating Temperature: -25°C to +70°C
Storage Temperature: -40°C to +90°C
Shock: 10 G. 11ms
Vibration: 10 G. 5 to 200Hz

Outline Drawing:

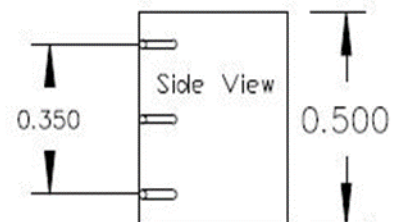
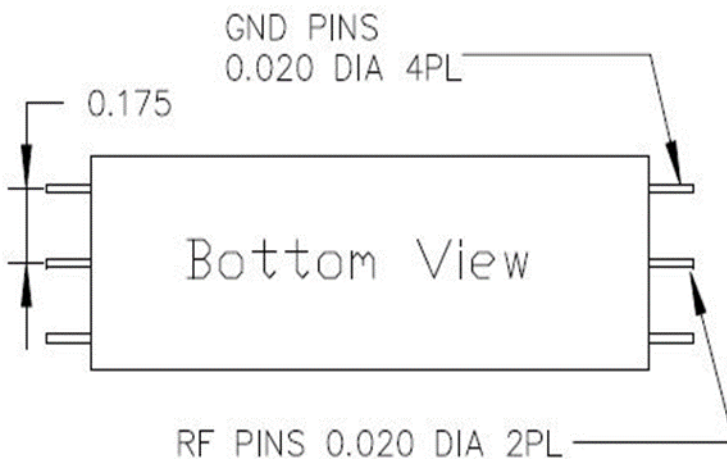
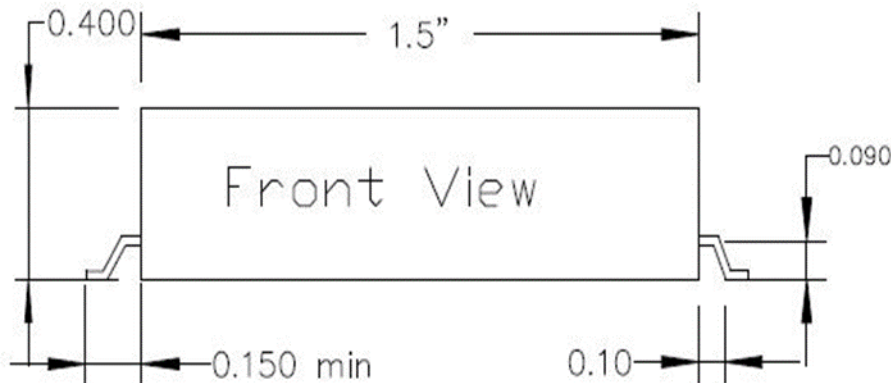



Response Plot:

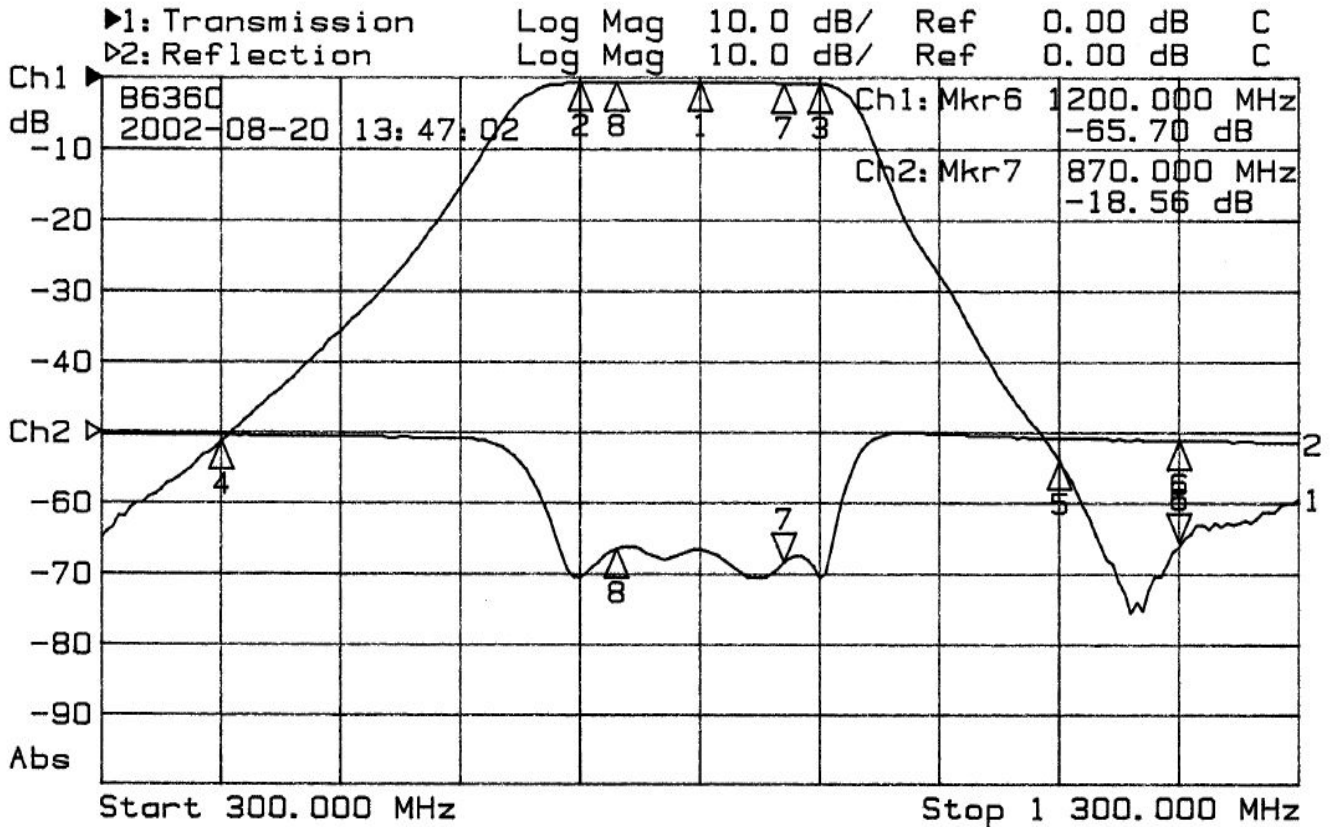

1: Mkr (MHz)	dB	2: Mkr (MHz)	dB
1: 800.00	-0.69		
2: 700.00	-0.72		
3: 900.00	-0.97		
4: 400.00	-51.31		
5: 1100.00	-54.07		
6> 1200.00	-65.70	6: 1200.00	-1.29
7: 870.00	-0.86	7> 870.00	-18.56
8: 730.00	-0.75	8: 730.00	-16.48